

## KEEP THE SAFETY HABIT

# CAR

# LOCATION

# INVENTORY

# CONTROL



INSTRUCTIONS — MAPS

INDUSTRIAL ZONE, TRACKS,

SPOT NUMBERS

Number **1**

ALBUQUERQUE

NEW MEXICO DIVISION

Instructions set forth below govern the operation of Car Location Inventory Control (CLIC) throughout the terminal of Albuquerque. The terminal is divided into nine zones with each zone having designated tracks and/or industries within its boundaries. Tracks are assigned specific numbers within the zones and spots on the tracks are given individual numbers. By using zone, track and spot numbers, we are able to print switch list which will reflect the exact location to which a car should be spotted.

A CLIC Spot Number will consist of six digits - the first two digits designate the zone to which the car is destined; the second two digits indicates the track number within the zone; the last two digits represent the actual spot along the track. Zone numbers will be preceded by a zero as there are less than ten zones.

### EXAMPLE OF CLIC SPOT NUMBER

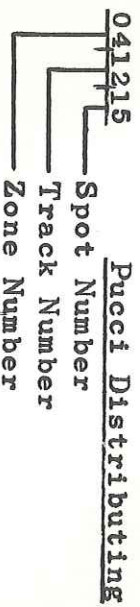

All industries will be referred to by CLIC Spot Number rather than by name.

Switches have been painted with zone and track number shown on either target or stand. Spot numbers have been painted on doors, docks, bldgs., gates etc., where possible; otherwise, the proper spot can be determined by noting spot descriptions that are found just opposite zone maps on the following pages in this book.

These maps are not drawn to scale but merely serve as a guide in locating proper tracks or spots.

Instructions below specifically pertain to the physical switching, spotting and pulling of cars and are called particularly to the attention of all yardmen for their compliance:

THE YARDMASTER WILL HAVE COMPLETE CONTROL AND KNOWLEDGE OF ALL SWITCHING OF CARS.

SWITCHING IN TRAIN YARD

(1) All switching in train yard will be performed by use of switch list unless otherwise instructed by yardmaster.

(2) Disposition of car will be shown on list by yardmaster just opposite car initial. This disposition will be indicated by means of track and/or spot number.

(3) Yardmaster will indicate on switch list at which end of yards switching is to be performed.

(4) Yardmaster will indicate on switch list where cuts, if any, are to be made, as follows:

1st Cut \_\_\_\_\_  
2nd Cut \_\_\_\_\_  
Etc.

(5) Engine Foreman will switch cars according to list marked by yardmaster. Should engine foreman switch or place car to some location other than that marked on list, or makes a cut different than marked by yardmaster, he must indicate so on switch list and advise yardmaster of this promptly.

(6) Engine Foreman will advise yardmaster of any car not shown on list and any disposition made of it.

(7) Engine Foreman must notify yardmaster of any exceptions taken to list, such as no car, car not on list or car out of line.

(8) Yardmaster should be aware of all switching moves made in the yard and engine foreman must advise yardmaster of any extra moves.

SWITCHING AT INDUSTRIES

(1) All switching at industries will be performed by use of switch list unless otherwise instructed by yardmaster.

(2) Disposition to be made of car will be shown on list by yardmaster just opposite car initial. This disposition will be indicated by track and/or spot number.

(3) Engine Foreman will switch cars according to list marked by yardmaster. Should engine foreman switch or place car to some location other than that marked on list, he must indicate so on list and advise yardmaster of change.

(4) If car is not actually spotted but left on that industry's track, foreman will indicate "On Track Not Placed" in the following manner OT N P. If car is placed on some other track foreman will indicate on list "Not Placed left on Track (Number)" in the following manner N P Track Number. (Example: ATSF 620510 N P 0535).

(5) Engine Foreman will advise yardmaster of disposition made of car or cars not shown on list.

(6) Engine Foreman must notify yardmaster of any exceptions taken to list, such as no car, car not on list, etc.

(7) If an industry request service not shown on foreman's list, engine foreman should obtain such request in writing and deliver to yardmaster after switching completed. If unable to obtain written request from industry foreman should record name of person requesting service on switch list showing service requested and performed

(8) If a car or cars other than ones ordered into industry by the yardmaster is spotted, engine foreman must indicate on switch list car number spotted and notify yardmaster of substitution.

(9) Engine Foreman will show on switch list time switching is completed at each industry.

(10) Yardmaster should be aware of all switching moves made at industries and engine foreman must advise yardmaster of any extra moves.

(11) After switching is completed engine foreman will indicate on switch list any work not completed, show time all switching on that list is completed, sign his name and return switch list to yardmaster.

For observation and guidance, the following codes may be shown on switch list preceding car initial:

B1 - Bad Order  
C1 - Condemned Car  
CU - Car completely unloads  
DN - Dangerous  
EP - Empty to be placed, or placed for loading  
EX - Explosive  
HB - Hold for billing  
HC - Hold for charges or permit  
HD - Hold for disposition  
HE - Head end movement only  
PU - Car partially unloads  
RE - Rear end movement only  
TU - Turn car and respot  
WH - Weigh  
XX - Do not move this car

Good communication is essential for a successful C L I C operation. The complete cooperation is solicited of every employee.

0101 Yard Track 1  
 0102 Yard Track 2  
 0103 Yard Track 3  
 0104 Yard Track 4  
 0105 Yard Track 5  
 0106 Yard Track 6  
 0107 Yard Track 7  
 0108 Yard Track 8  
 0109 Yard Track 9  
 0110 Yard Track 10  
 0111 Yard Track 11  
 0112 Yard Track 12  
 0113 Coen Rip 1  
 0114 Coen Rip 2  
 0115 Yard Track 13  
 0116 Coen Spur  
 0117 Old Cab  
 0126 Rail Yard East Track  
 0126 Rail Yard West Track

0130 Scale Track  
 0151 01 Hydro Conduit (Tellyer Spur)  
 0152 01 Hydro Conduit Unldg. Pit (Otto Spur)  
 0152 02 Otto Spur Open Area  
 0153 01 Linde Air South Spot  
 0153 02 Linde Air Middle Spot  
 0153 03 Linde Air North Spot  
 0154 01 Sandia Oil, Old Whse (Albuq. Waste)  
 0154 02 Albuq. Waste Mtls. (Bannar Prod.)  
 0154 03 J. G. Maloof Recycling Plant  
 0154 04 Faraone's Masonry Dock  
 0154 05 Southwest Ceramics Open Area  
 0154 06 Southwest Ceramics North Door  
 0154 07 Cooks Bldg. Specialities South Door  
 0154 08 Burr Oil, Open Area North of Bldg.  
 0154 09 Burr Oil, Door  
 0198 Main Track  
 0199 Main Old Main Track

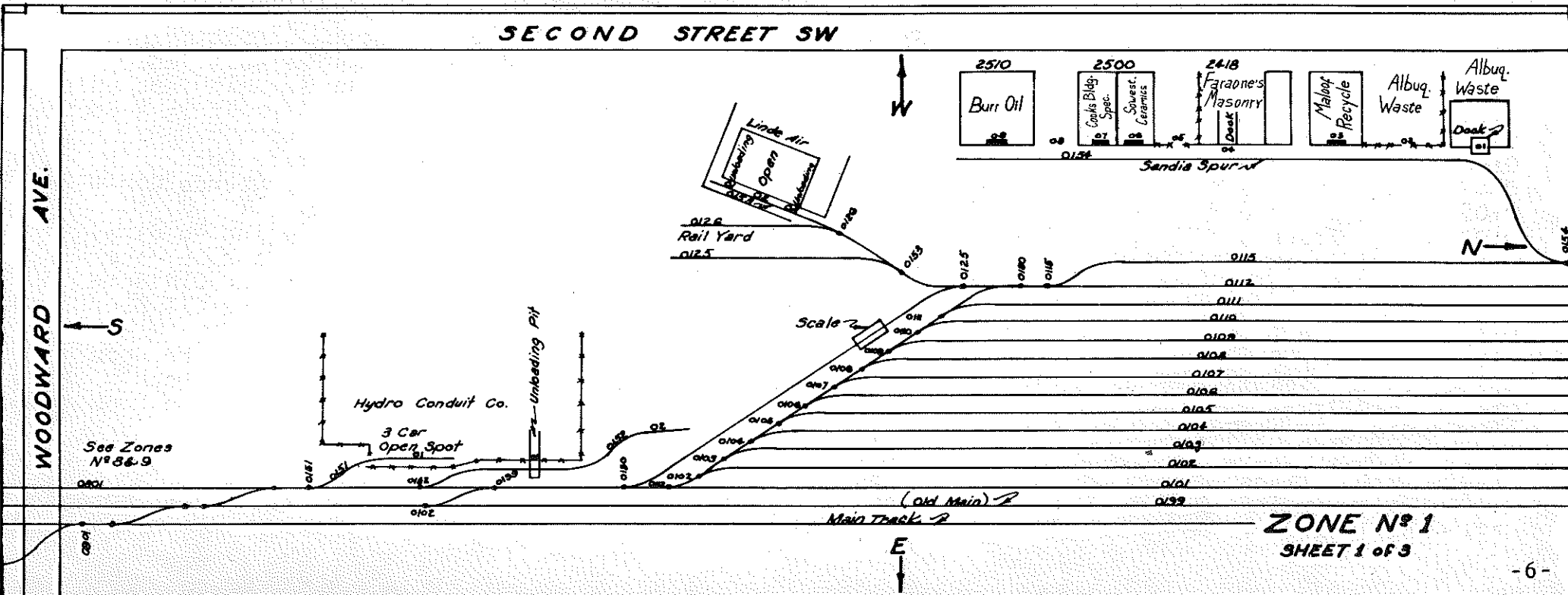

0101	Yard Track 1 (Middle)	0122	Shoo Fly	0162 01	Chevron Asphalt No Spot
0102	Yard Track 2 (Middle)	0123	Dismantle Trk, East Trk	0162 02	Chevron Asphalt Tank Spot
0103	Yard Track 3	0124	Dismantle Trk, West Trk	0162 03	Chevron Asphalt Tank Spot
0104	Yard Track 4	0161 01	Valley Welders No Door	0162 04	Chevron Asphalt Tank Spot
0105	Yard Track 5	0161 02	Valley Welders Mid Door	0162 05	Chevron Asphalt So Spot
0106	Yard Track 6	0161 03	Valley Welders So Door	0162 99	N Mex Forms, Dock
0107	Yard Track 7	0161 04	N M Selling Co Door 7	0163 01	Middle Rio Grande Con- servancy
0108	Yard Track 8	0161 05	N M Selling Co Door 6	0182 01	Allied Roofing No Gate
0109	Yard Track 9	0161 06	N M Selling Co Door 5	0182 02	Allied Roofing So Gate
0110	Yard Track 10	0161 07	N M Selling Co Dock 7	0183 01	Lydick Roofing Old Gate
0111	Yard Track 11	0161 08	N M Selling Door 9	0183 02	Lydick Roofing Old Door
0112	Yard Track 12	0161 09	N M Selling Co Door 10	0184 01	Quick Container
0113	Coen Rip 1	0161 10	N M Selling Co Dock 8	0185 01	Ever Ready Oil, No Door
0114	Coen Rip 2	0161 11	N M Selling Co Door 11	0185 02	Ever Ready Oil, Dock
0115	Yard Track 13	0161 12	N M Selling Co Door 12	0185 03	Ever Ready Oil, So Door
0116	Coen Spur	0161 21	Conservancy Oil Spot 1	0197	East Bound Main
0117	Old Caboose Track	0161 22	Conservancy Oil Spot 2	0198	West Bound Main
0118	Caboose Track	0161 23	Conservancy Oil Spot 3	0199	Old Main Track
0119	Lumber Track	0161 24	Conservancy Oil Spot 4	0211	Lead to Rip & Storehouse
0120	Rail Saw 1	0161 25	Conservancy Oil Spot 5		
0121	Rail Saw 2	0161 26	Conservancy Oil Spot 6		

- 7 -

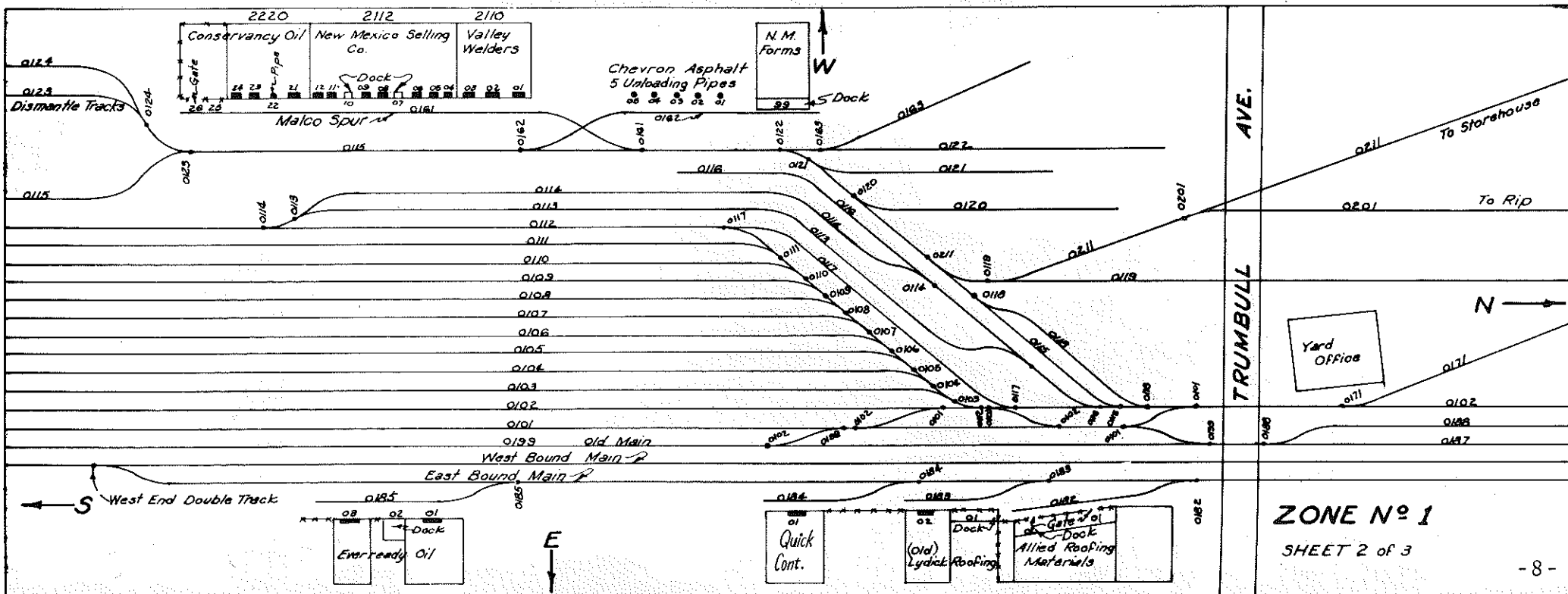

ZONE No 1

SHEET 2 of 3

- 0102 Yard Track 2 (Middle 2)
- 0171 Oak Spur
- 0172 Coal Storage
- 0172 11 Penick and Ford
- 0172 12 Standard Brands
- 0173 Roundhouse 1
- 0174 Roundhouse 2
- 0175 Roundhouse 3
- 0176 Roundhouse Sand Track
- 0177 Roundhouse 4
- 0178 Roundhouse Stall 26
- 0179 Slipping Track
- 0180 Power House, West Track
- 0180 01 Power House, Tank Unldg
- 0181 Power House, East Track
- 0181 01 Power House Tank Unldg
- 0186 01 Welfare Dept., Dock No. Bldg.
- 0186 02 Welfare Dept., North Spot
- 0186 03 Welfare Dept., Middle Spot
- 0186 04 Welfare Dept., South Spot

- 0187 Old Main by Shops
- 0188 Middle One by Shops
- 0197 East Bound Main
- 0198 West Bound Main

-9-

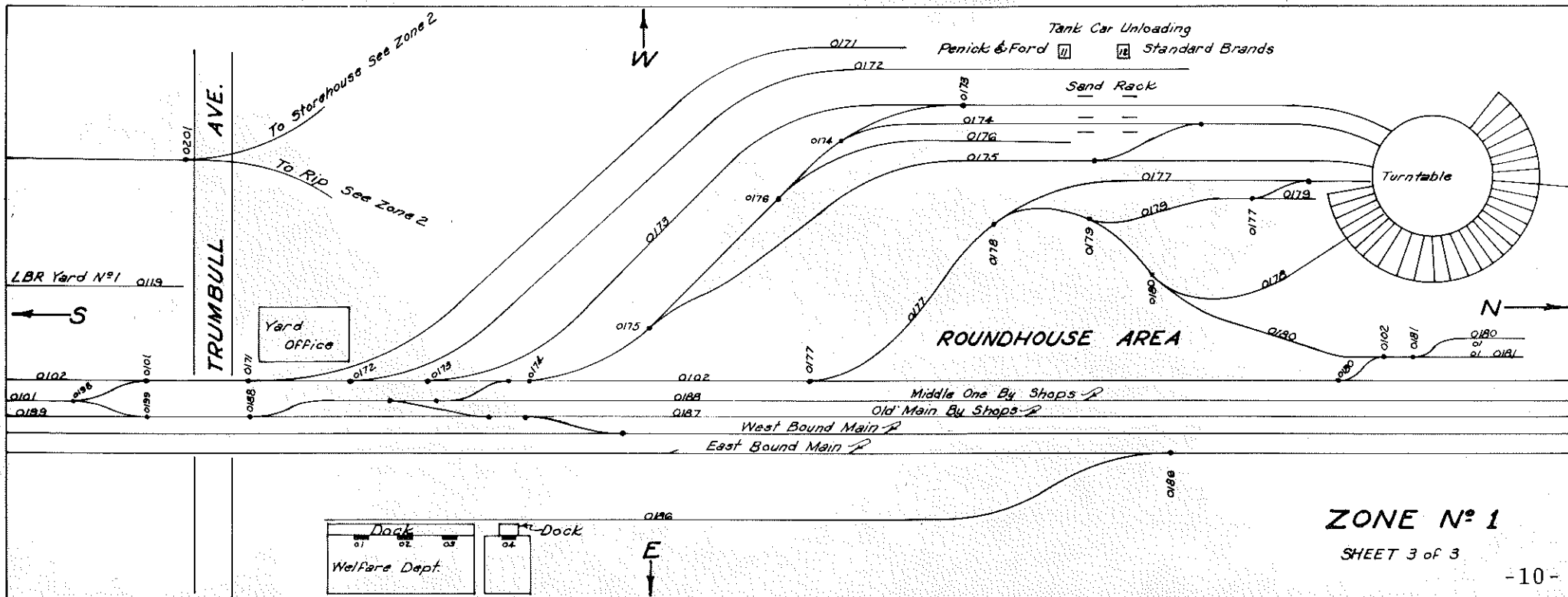

ZONE No 1

SHEET 3 of 3

- 0201 Rip Track 1
- 0202 Rip Track 2
- 0203 Rip Track 3
- 0204 Rip Track 4 & 1/2
- 0205 Rip Track 5
- 0206 Rip Track 6 & 1/2
- 0207 Rip Track 7
- 0208 Rip Track 7 & 1/2
- 0209 D.S.K. Track 9
- 0210 D.S.K. Track 10
- 0210 10 D.S.K. Diesel & Gaso Tank Unldg
- 0210 15 D.S.K. Kerosene Tank Unldg
- 0211 D.S.K. Track 11
- 0221 Scrap Bin East Track
- 0222 Scrap Bin West Track
- 0231 Steel Shed Track 1
- 0232 Steel Shed Track 2
- 0233 Steel Shed Track 3
- 0234 Steel Shed Track 4
- 0235 Steel Shed Track 11, West Side of Bldg.

-11-

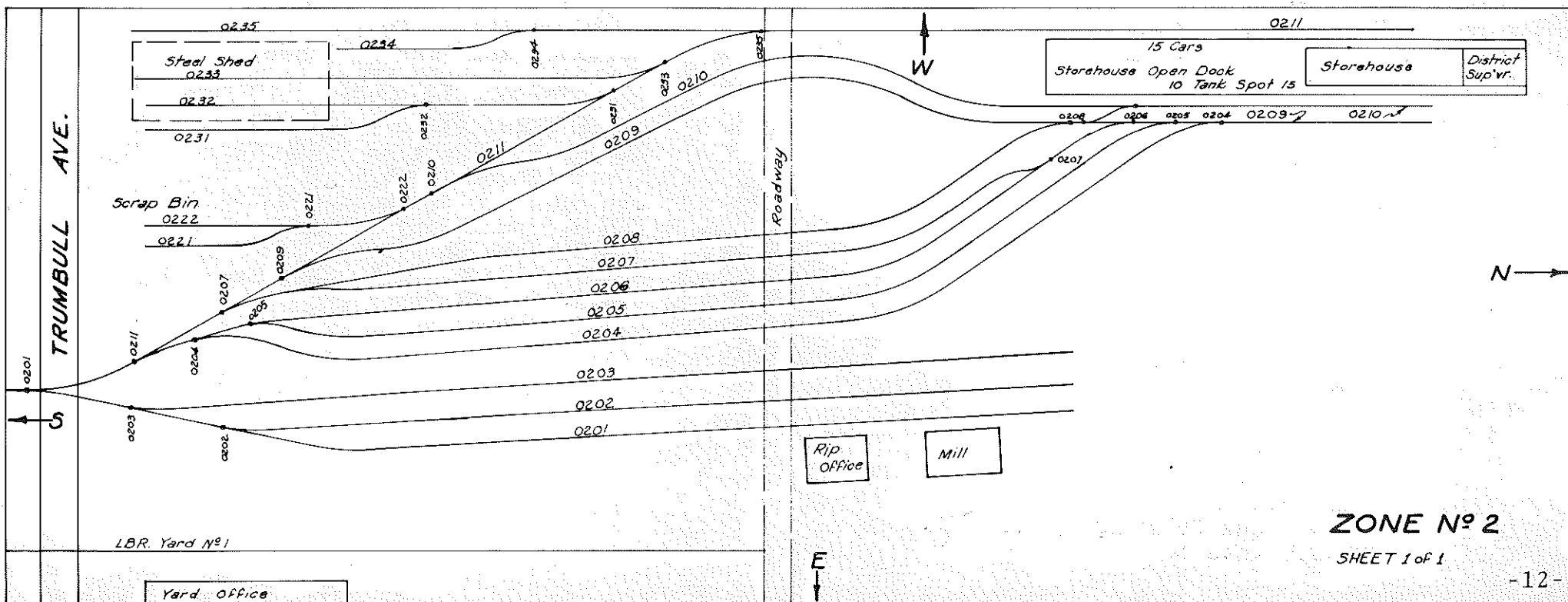

0102 Yard Track 2 (Middle 2)  
 0187 Old Main by Shop  
 0188 Middle 2 by Shops  
 0311 Lead to Long Team  
 0311 01 Long Team, Auto Unldg  
 0311 02 Long Team, Auto Unldg  
 0311 03 Mead Bakery, Hopper Unldg  
 0311 04 Baldrige Lbr, Open Spot  
 0311 05 Baldrige Lbr, Open Spot  
 0312 Coal Ave Team, Storage 1  
 0313 Coal Ave Team, Storage 2  
 0314 C.W.E. Blacksmith Shops  
 0315 Auto Dock, East Side  
 0316 Auto Dock, Rankin Spur  
 0317 Freight House, East Track  
 0318 Freight House, West Track  
 0319 C.W.E. Iron Track  
 0320 Auto Dock, Short Team  
 0321 Auto Dock, Middle Track  
 0321 Albuquerque Publishing Co.  
 0322 C.W.E., Lead to

0322 C.W.E. Track west of Canopy  
 0322 06 United Wholesale Liquor, Unldg Slab  
 0323 01 S.F.T.T. Tank Unloading  
 0324 C.W.E. Sand Blast Track  
 0325 C.W.E. Flue Rattler Track  
 0326 C.W.E. Sheet Track  
 0327 C.W.E. Short track of 0326  
 0328 C.W.E. Grand Canyon Track  
 0329 C.W.E. Tank Shop Track  
 0330 Welding Plant Track, Shop Extension  
 0331 C.W.E. Canopy Track #3  
 0332 C.W.E. Canopy Track #4  
 0336 Yardmaster's Spur

-13-

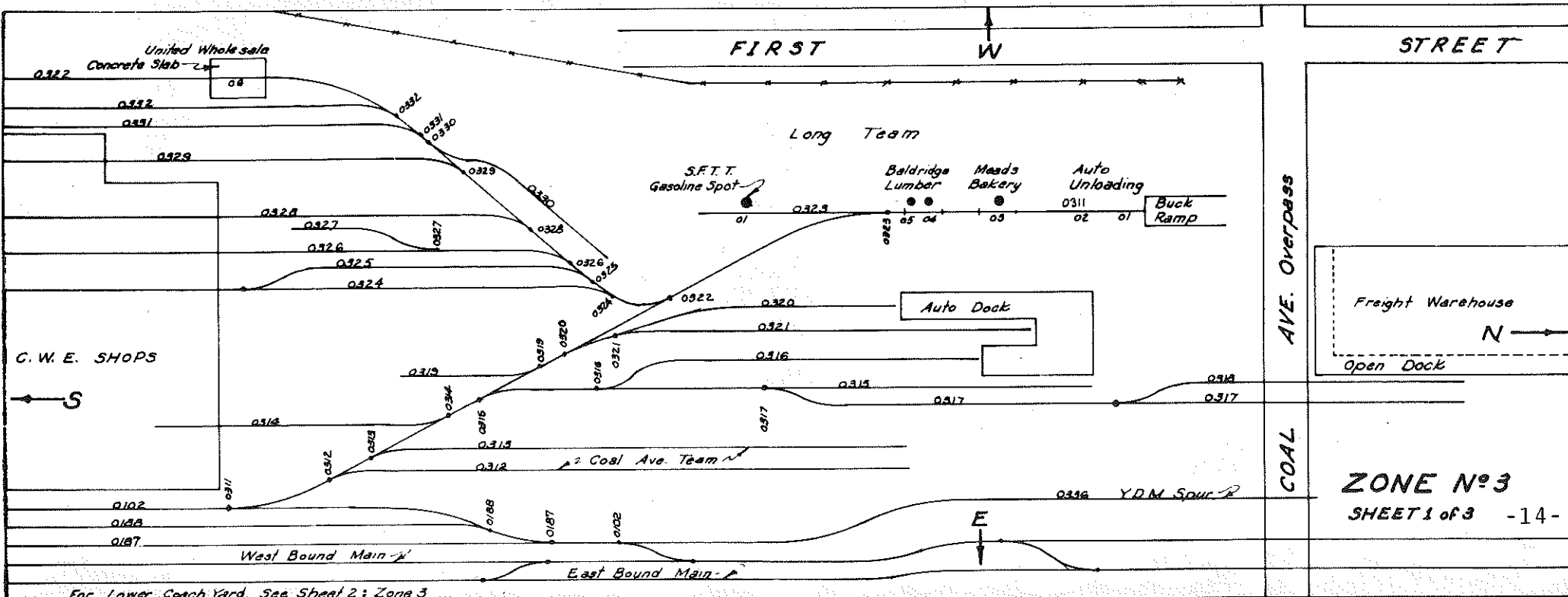

ZONE No 3  
 SHEET 1 of 3 -14-



0351 Lower Coach Yard, Lead to  
 0352 Long Wash, Lower Coach Yd  
 0353 No. 9, Lower Coach Yd Pocket  
 0360 Freight run-a-round  
 0361 Lower Coach Yard 1  
 0362 Lower Coach Yard 2  
 0363 Lower Coach Yard 3  
 0364 Lower Coach Yard 4  
 0365 Lower Coach Yard 5  
 0366 Lower Coach Yard 6  
 0367 Wheel Pit, Coach Yd  
 0368 Short Wash, Coach Yd  
 0369 Long Wash, Passenger Yd  
 0370 01 Hunter Lbr Co  
 0371 Foundry Spur, Old  
 0372 Mitchum Spur, Old

0373 01 Albuqr Gravel, Sand Unldg Pit  
 0373 02 Albuqr Gravel, Gate So End  
 0374 Fence Track  
 0375 01 Albuqr Gravel, Door NE Bldg.  
 0375 02 Albuqr Gravel, Cement Unldg Pit  
 0375 03 Albuqr Gravel, Gate  
 0375 04 Albuqr Gravel, Door SE Bldg  
 0376 01 Diesel Spur, North Unldg Pipe  
 0376 02 Diesel Spur, Unldg Pipe  
 0376 03 Diesel Spur, Unldg Pipe  
 0376 04 Diesel Spur, South Unldg Pipe  
 0383 Passenger Yd Track 3  
 0384 Passenger Yd Track 4  
 0385 Passenger Yd Track 5  
 0386 Passenger Yd Track 6

-15-

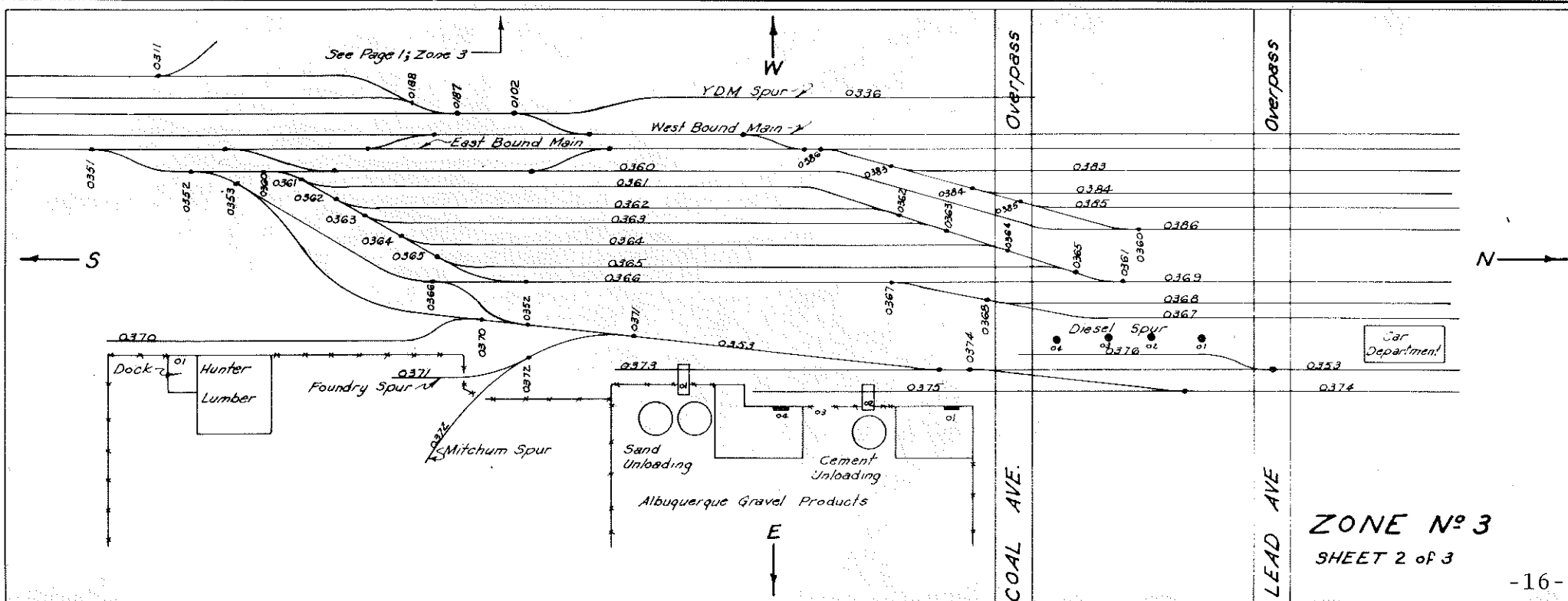

-16-

- 0367 Wheel Pit, Passenger Coach Yd
- 0368 Short Wash, Passenger Coach Yd
- 0369 Long Wash, Passenger Coach Yd
- 0374 Fence Track
- 0375 Albuqr Gravel Co
- 0376 Diesel Spur
- 0377 Gross Kelly Spur, Old
- 0378 01 Masterweave Carpet, Dock (Old Graham)
- 0383 Passenger Yard Track 3
- 0384 Passenger Yard Track 4
- 0385 Passenger Yard Track 5
- 0386 Passenger Yard Track 6
- 0391 01 American Furn, Dock (Ilfeld Bldg)
- 0391 02 American Furn, Dock (Ilfeld Bldg)
- 0391 03 American Furn, Dock (Ilfeld Bldg)
- 0397 East Bound Main
- 0398 West Bound Main

-17-

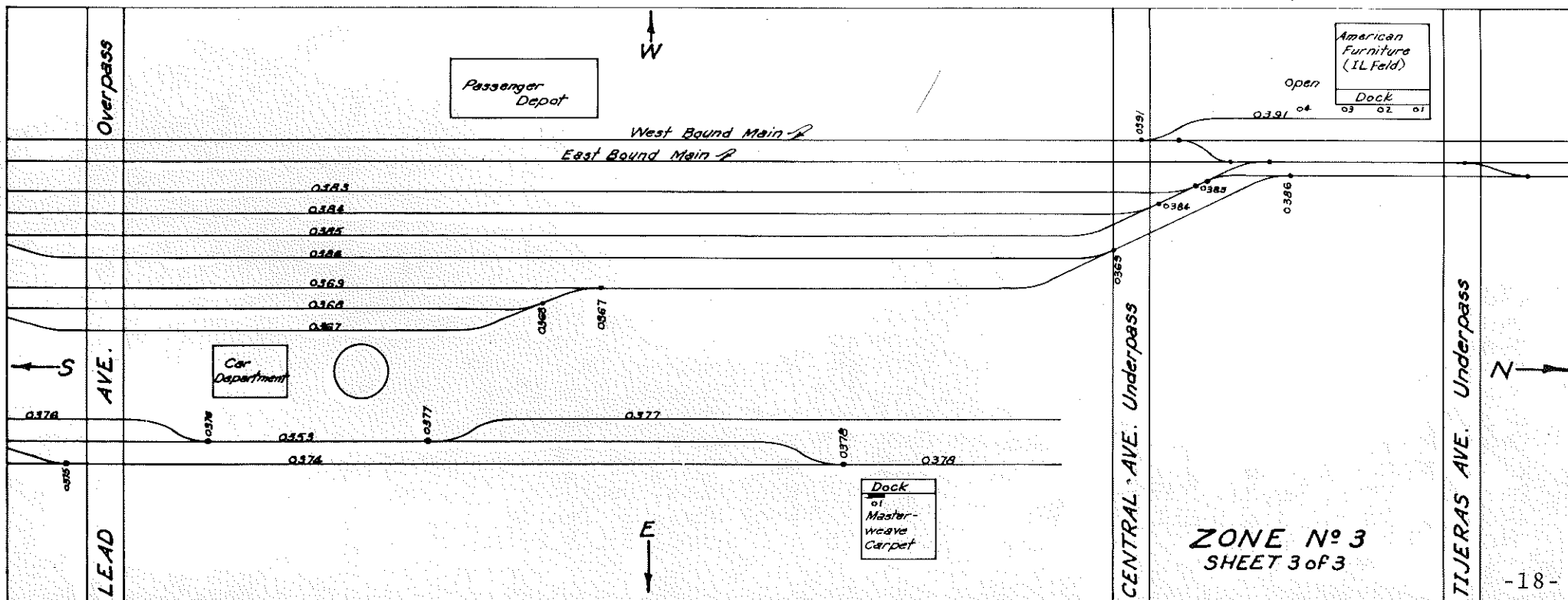

0401 Railway Ice, Spur  
 0401 01 Railway Ice, Gate  
 0401 02 Railway Ice, Open Dock  
 0401 03 Railway Ice, South Door  
 0401 04 Railway Ice, North Door  
 0401 05 Dixon Paper, South Door  
 0401 06 Dixon Paper, North Door  
 0401 07 Dixon Paper, Open Area North  
 0401 08 N M Tire & Battery, So Door  
 0401 09 N M Tire & Battery, No Door  
 0402 Swift Spur, Old Spur  
 0403 01 Springer Whse, Spot 1  
 0403 02 Springer Whse, Spot 2  
 0403 03 Springer Whse, Spot 3  
 0403 04 Springer Whse, Spot 4  
 0403 05 Morey Whse, Old South Dock  
 0403 06 Morey Whse, Old North Dock  
 0403 07 Morey Whse, Open Area North  
 0403 08 Door, Vacant Bldg  
 0403 09 Door, Vacant Bldg So Door  
 0403 10 Door, Vacant Bldg No Door

0404 01 Dillardards, No Door  
 0404 02 Dillardards, Mid Door  
 0404 03 Dillardards, So Door  
 0404 04 Cox Hide, No Door  
 0404 05 Cox Hide, Door  
 0404 06 Cox Hide, Door  
 0404 07 Cox Hide, So Door  
 0404 08 Mesa Metal, No Door  
 0404 09 Mesa Metal, So Door  
 0404 10 Crane Supply, Fruit St.  
 0404 11 Crane Supply, Door  
 0404 12 Crane Supply, Gate  
 0404 13 N M Produce, Door  
 0404 14 N M Produce, Dock  
 0404 15 N M Produce, Roma Ave  
 0404 16 Wool Whse, Dock  
 0404 17 Wool Whse, No Door  
 0404 18 Wool Whse, Door  
 0404 19 Wool Whse, Door  
 0404 20 Wool Whse, So Door  
 0404 21 N M School S'ply, Dock

0404 22 N. M. Sch Sply  
 0404 23 Ange Lbr. Dock  
 0404 24 Cultured Marble  
 0405 01 Maloof South Door  
 0405 02 Maloof North Door  
 0405 03 Nationwide paper  
 0405 04 Nationwide paper  
 0406 Crystal Ice Middle spur  
 0488 Old Main by Ice House  
 0497 East Bound Main  
 0498 West Bound Main

-19-

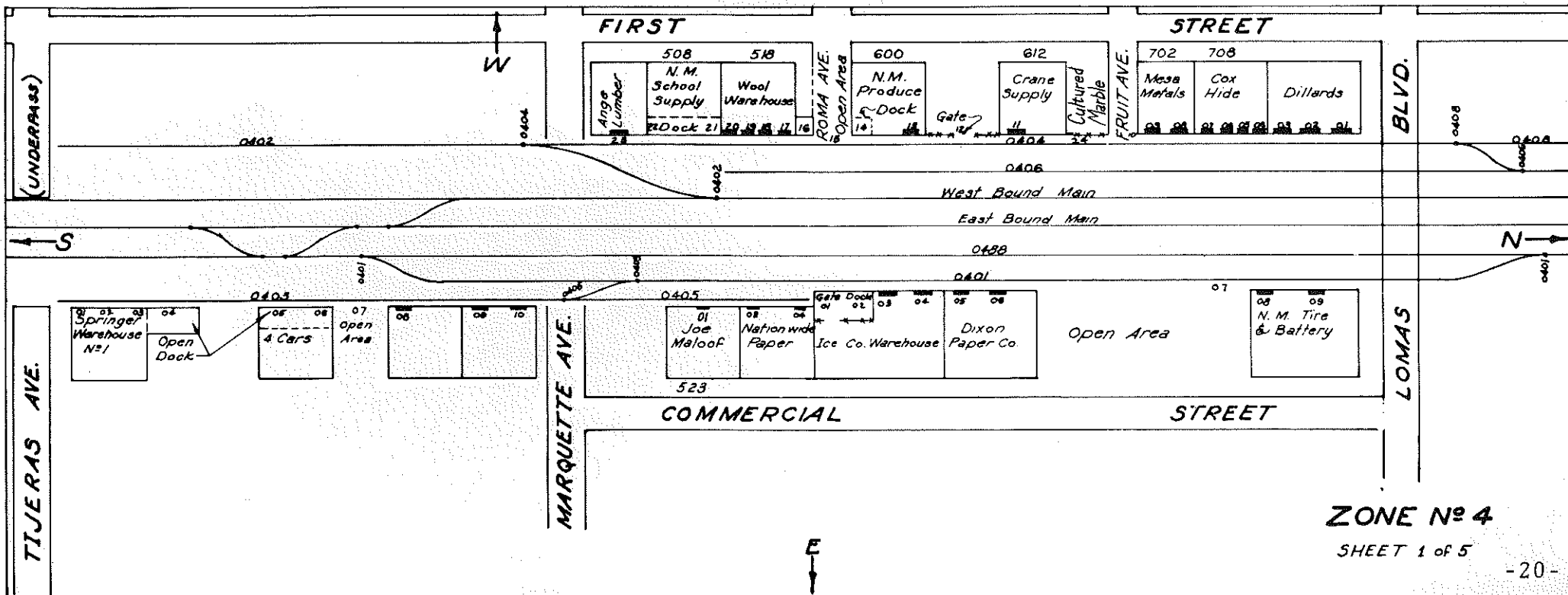

0406 Crystal Ice, Middle Spur  
 0407 U S Post Office Track (Out of Service)  
 0407 11 Star Oil, Old - Door (Out of Service)  
 0407 12 Star Oil, Old - Gate (Out of Service)  
 0408 01 Westinghouse, South Door  
 0408 02 Westinghouse, Middle Door  
 0408 03 Westinghouse, North Door  
 0408 04 Herbert Distr., Open Dock  
 0408 05 Slate Street, Open Area  
 0408 06 Carroll, Bill C., Open Spot  
 0408 07 Carroll, Bill C., Open Spot  
 0408 08 Carroll, Bill C., Door  
 0408 09 Carroll, Bill C., Door  
 0408 10 Carroll, Bill C., Door  
 0408 11 Carroll, Bill C., Door  
 0408 12 Carroll, Bill C., Door  
 0409 01 Southwest Distr., Tank Unldg  
 0409 02 Southwest Distr., Open Spot  
 0409 03 Southwest Distr., Open Spot  
 0409 04 Southwest Distr., Open Spot  
 0410 01 Cox Iron, Old Spur

0411 01 United Iron, Old Spur  
 0412 01 Rocky Mtn Whsle, South Door  
 0412 02 Rocky Mtn Whsle, Door  
 0412 03 Rocky Mtn Whsle, North Door  
 0412 04 Dow Supply, Door  
 0412 05 All Field Insulation, Door  
 0412 06 Aztec Spur, Open Area  
 0412 07 Aztec Spur, Open Area  
 0412 08 Aztec Spur, Open Area  
 0412 09 Aztec Spur, Open Area  
 0412 10 Aztec Spur, Open Area  
 0412 11 M & W Sptr Goods, Gate Spot  
 0412 11 Super Oil Co., Dock  
 0413 01 Woodpecker Spur, Old  
 0414 01 Eppsco Spur, Old Open Spot  
 0414 02 Eppsco Spur, Old Open Spot  
 0415 Springer Complex, Lead to  
 0416 01 Mobil Oil Whse, Dock (Out of Service)  
 0417 01 Springer Cmt Unldg Pit  
 0419 Springer Complex

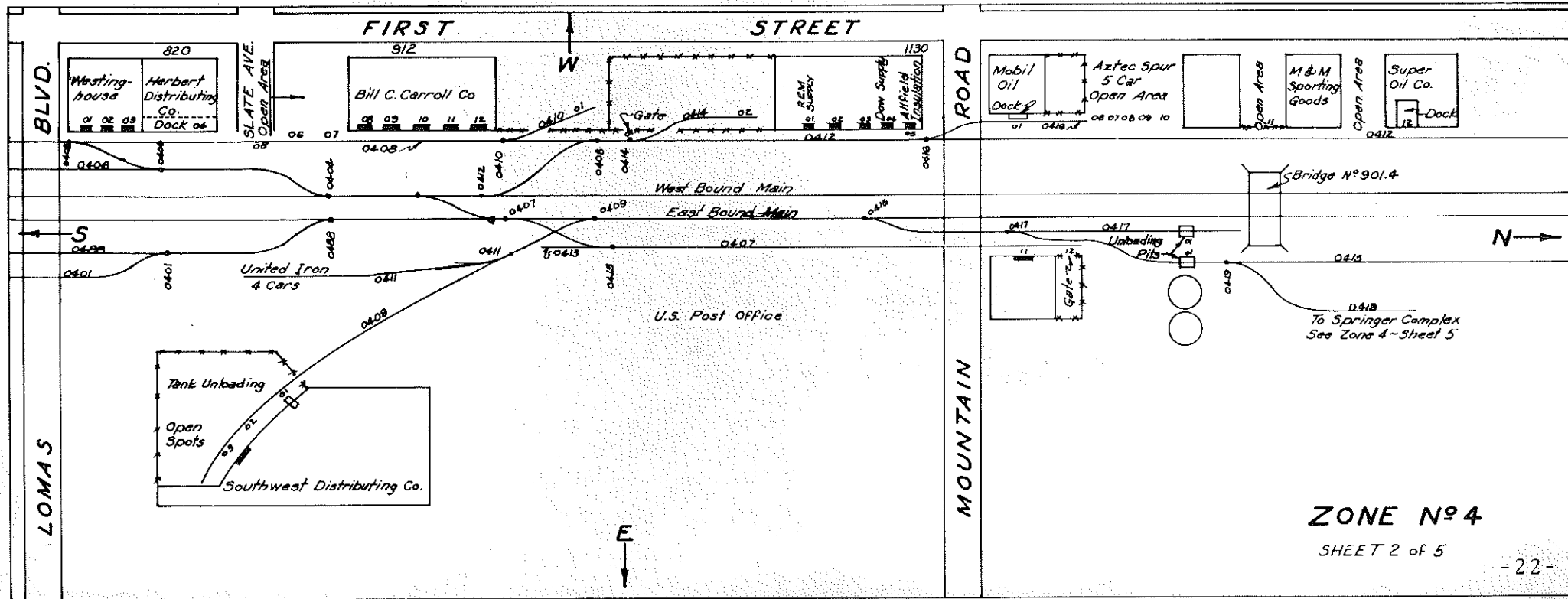

0412 12 Super Oil Co., Dock  
 0412 13 Summer St., Open Spot  
 0412 14 Pucci Distr., South Door  
 0412 15 Pucci Distr., Middle Coor  
 0412 16 Pucci Distr., North Door  
 0412 17 Nationwide Paper, South Door  
 0412 18 Nationwide Paper, North Door  
 0412 19 American Furn, Street South Bldg.  
 0412 20 American Furn, South Door 1  
 0412 21 American Furn, Door 2  
 0412 22 American Furn, Door 4  
 0412 23 American Furn, Door  
 0412 24 American Furn, Door  
 0412 25 American Furn, Door  
 0412 26 American Furn, Door  
 0412 27 American Furn, North Door  
 0412 28 American Furn, Open Area  
 0412 29 American Furn, Open Area  
 0412 30 American Furn, Open Area

0412 31 Artistic Furn, South Door  
 0412 32 Artistic Furn, North Door  
 0412 33 Artistic Furn, Gate at Dock  
 0420 Mountain Road Number 2  
 0422 Mountain Road Number 1  
 0430 01 Richard Distr, (Old) South Door  
 0430 02 Richard Distr, (Old) North Door  
 0431 01 Romney Produce, Old North Door  
 0431 02 Romney Produce, Old South Door  
 0433 01 Board of Education, Spot 1 at Dock  
 0433 02 Board of Education, Open Dock  
 0433 03 McIntock Paper, South Door  
 0433 04 Albuqr Public Schools, Spot 2 at Dock  
 0433 05 Albuqr Public Schools, Spot 3 at Dock  
 0497 East Bound Main  
 0498 West Bound Main  
 0501 Sawmill Area, Lead to  
 0502 Sutherland Lbr Co

-23-

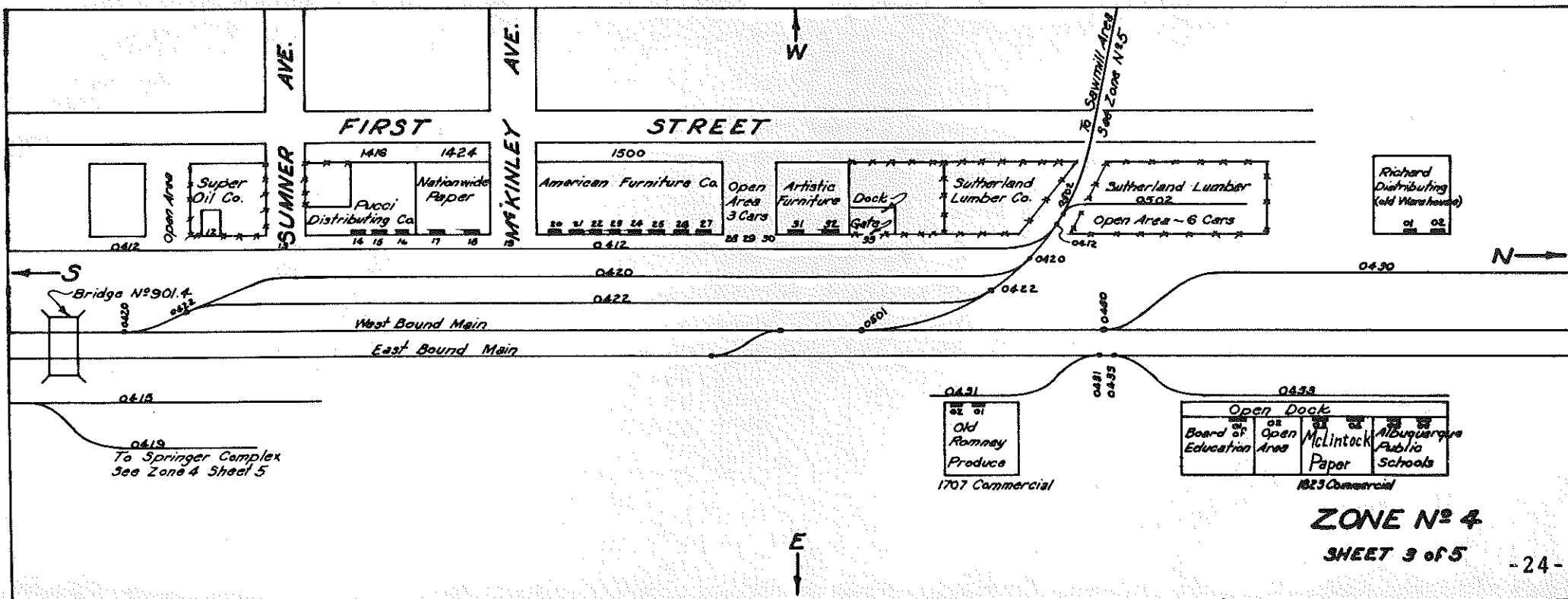

0430 01 Richard Distr, Old Whse South Door  
 0430 02 Richard Distr, Old Whse North Door  
 0430 04 Richard Distr Spur, Dock  
 0430 05 Richard Distr, New Whse South Door  
 0430 06 Richard Distr, New Whse North Door  
 0430 07 Gamble Rents  
 0435 01 Thunderbird Steel, South Door  
 0435 02 Thunderbird Steel, North Door  
 0435 03 Thunderbird Steel, South Gate  
 0435 04 Thunderbird Steel, Middle Gate  
 0435 05 Thunderbird Steel, North Gate  
 0435 06 Thunderbird Steel, Open Spot North End  
 0436 Kohlhass Spur  
 0436 01 Kohlhass Tank, Gate at Crane  
 0436 02 Diamond Transfer, Gate  
 0436 03 Diamond Transfer, Gate at Dock  
 0436 04 Duddy's Tire, South Door #4  
 0436 05 Duddy's Tire, North Door

0436 06 Duddy's Tire, Gate north side  
 0436 07 Hausman Corpn, Open Spot  
 0436 08 Hausman Corpn, Gate at Crane  
 0436 09 Hausman Corpn, Gate  
 0436 10 Kohlhass Spur, Jiffy Dely  
 0437 01 Commercial Whse, Open Dock north end  
 0437 02 Commercial Whse Spot 2  
 0437 03 Commercial Whse Spot 3  
 0437 04 Commercial Whse Spot 4  
 0437 05 Commercial Whse Spot 5  
 0437 06 Commercial Whse Spot 6  
 0437 07 Commercial Whse Spot 7  
 0437 08 Commercial Whse Spot 8 south of bldg  
 0437 98 Diamond Transfer, Door  
 0437 99 Diamond Transfer, Open Dock  
 0439 01 Marblecraft, Open Area between bldgs  
 0439 02 Masterweave Carpet, Door 2501 Commercial Ave

-25-

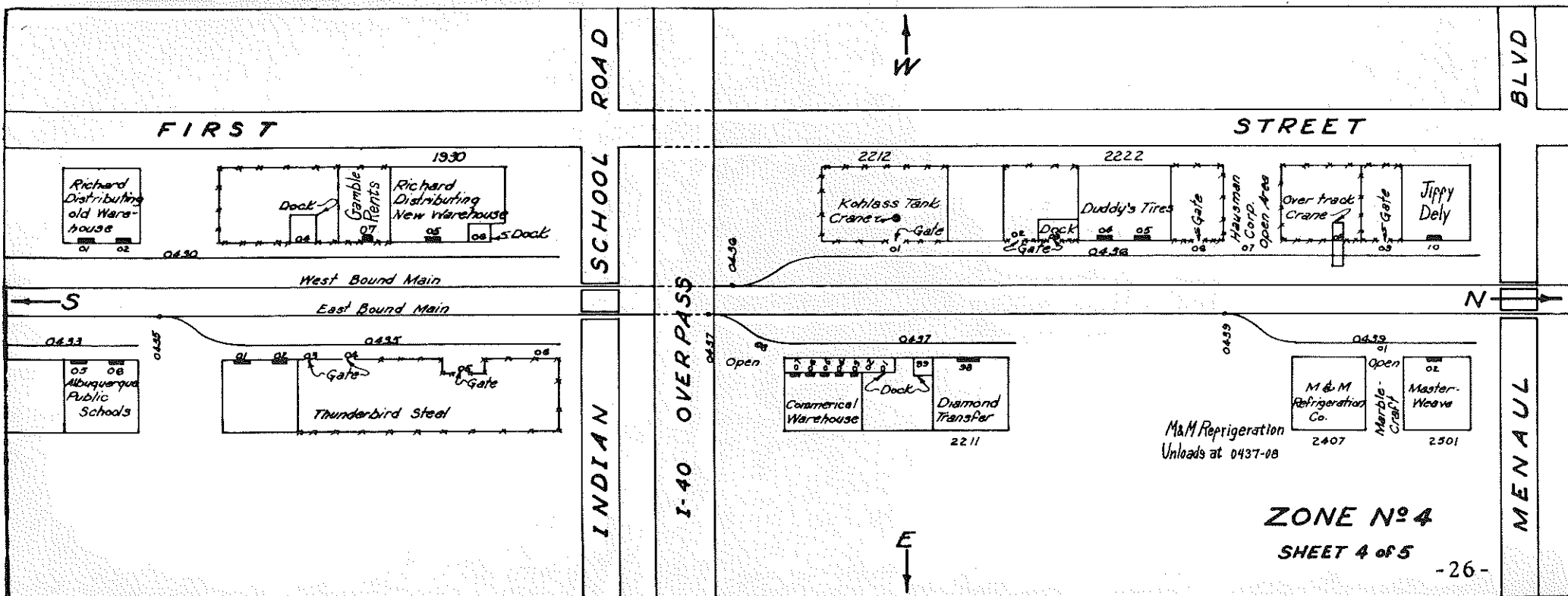

0415 Springer Complex, Lead to  
 0417 01 Springer Cemt Unloading  
 0419 Springer Lead  
 0421 01 Springer Plant 2 Dock  
 0423 02 Springer Whse 8 Door 1  
 0423 02 Springer Whse 8 Door 2  
 0423 03 Nobel Inc Whse 8 Door 3  
 0423 04 Springer Whse 8 Door 4  
 0423 05 Springer Whse 8 Door 5  
 0423 06 Shell Oil Whse 8 Door 6  
 0423 07 Sunshine Biscuit Whse 8 Door 7  
 0423 08 Thelander Sales, Tank Unldg  
 0423 09 Springer Open Track  
 0423 10 Springer Open Track  
 0423 11 Springer Open Track  
 0423 12 Springer Open Track  
 0423 13 Springer Open Track  
 0425 01 Sears Roebuck Door 1  
 0425 02 Sears Roebuck Door 2  
 0425 03 Sears Roebuck Door 3

0425 04 Sears Roebuck Door 4  
 0425 05 Sears Roebuck Door 5  
 0425 05 Springer Cinder Unldg Pit  
 0425 07 T. Crow Whirlpool  
 0427 01 Springer Whse 3 Door 1  
 0427 02 Springer Whse 3 Door 2  
 0427 03 Springer Whse 3 Door 3  
 0427 04 Springer Whse 3 Door 4  
 0427 05 Springer Whse 3 Door 5  
 0427 06 Ponca Whsle Whse 3 Door 6  
 0427 07 Ward Terry Whse 3 Door 7  
 0427 08 Ward Terry Whse 3 Door 8  
 0427 09 Wicker Inc Whse 3 Door 9  
 0429 01 Sun City 2 Whse 2 Spot 1  
 0429 02 Sun City 3 Whse 2 Spot 2  
 0429 03 Sun City 2 Whse 2 Spot 3  
 0429 04 Sun City 2 Whse 2 Spot 4  
 0429 05 Sun City 2 Whse 2 Spot 5  
 0429 06 Sun City 2 Whse 2 Spot 6  
 0429 07 Sun City 2 Whse 2 Spot 7  
 0429 08 J C Penney Whse 2 Spot 8  
 0429 09 J C Penney Whse 2 Spot 9

-27-

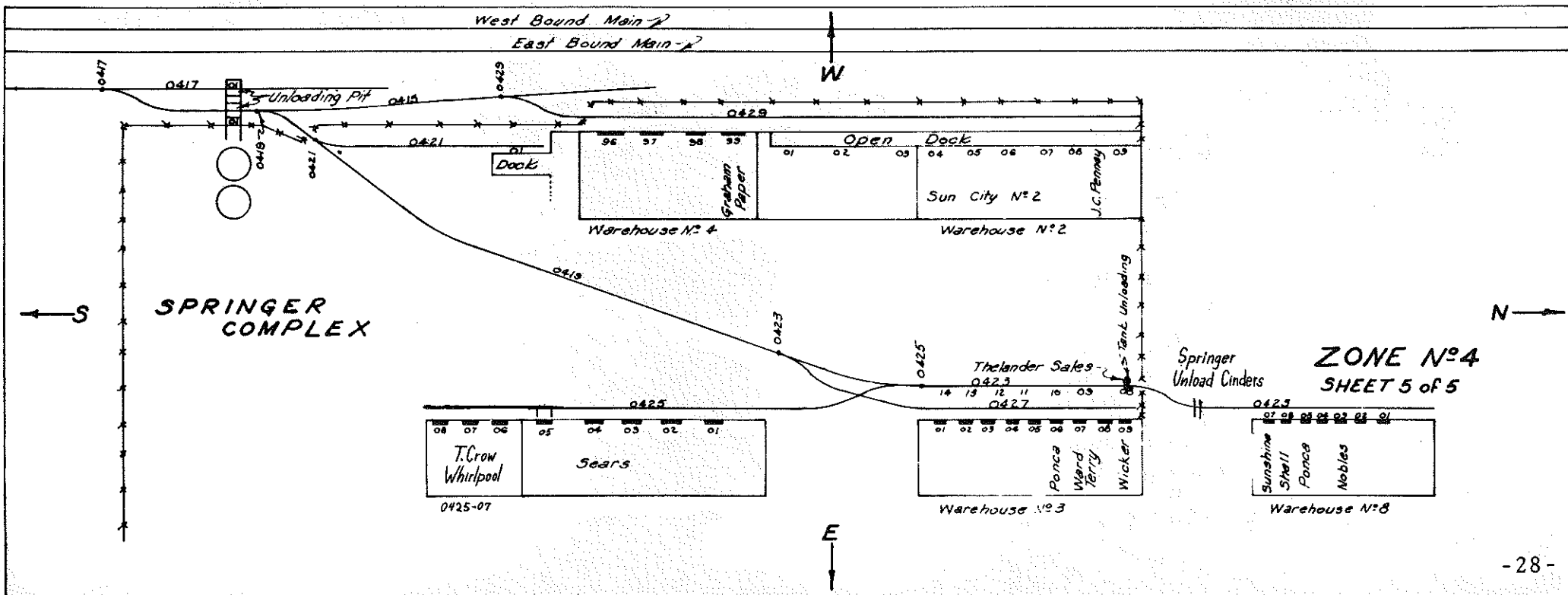

-28-

- 0501 Saw Mill Lead
- 0502 01 Sutherland Lbr Co North Track
- 0503 01 Sutherland Lbr Co South Track
- 0504 01 T & P Pipe Open Area
- 0505 01 Gillette Tire Door
- 0506 01 Ralston Oil Co Door
- 0507 01 Valley Gold Dairy East Door
- 0507 02 Valley Gold Dairy Door
- 0507 03 Valley Gold Dairy Door
- 0507 04 Valley Gold Dairy West Door
- 0508 01 Bell Tire, Dock
- 0508 02 Rust Tractor, Gate
- 0508 03 Rust Tractor, Door
- 0510 Santa Fe Builders Spur
- 0511 01 Rust Tractor Open Spot
- 0511 02 Rust Tractor Open Spot
- 0511 03 Rust Tractor Open Dock
- 0511 04 Bell Tire, West Door
- 0511 05 Bell Tire, Door
- 0511 06 Bell Tire, Gate East End

-29-

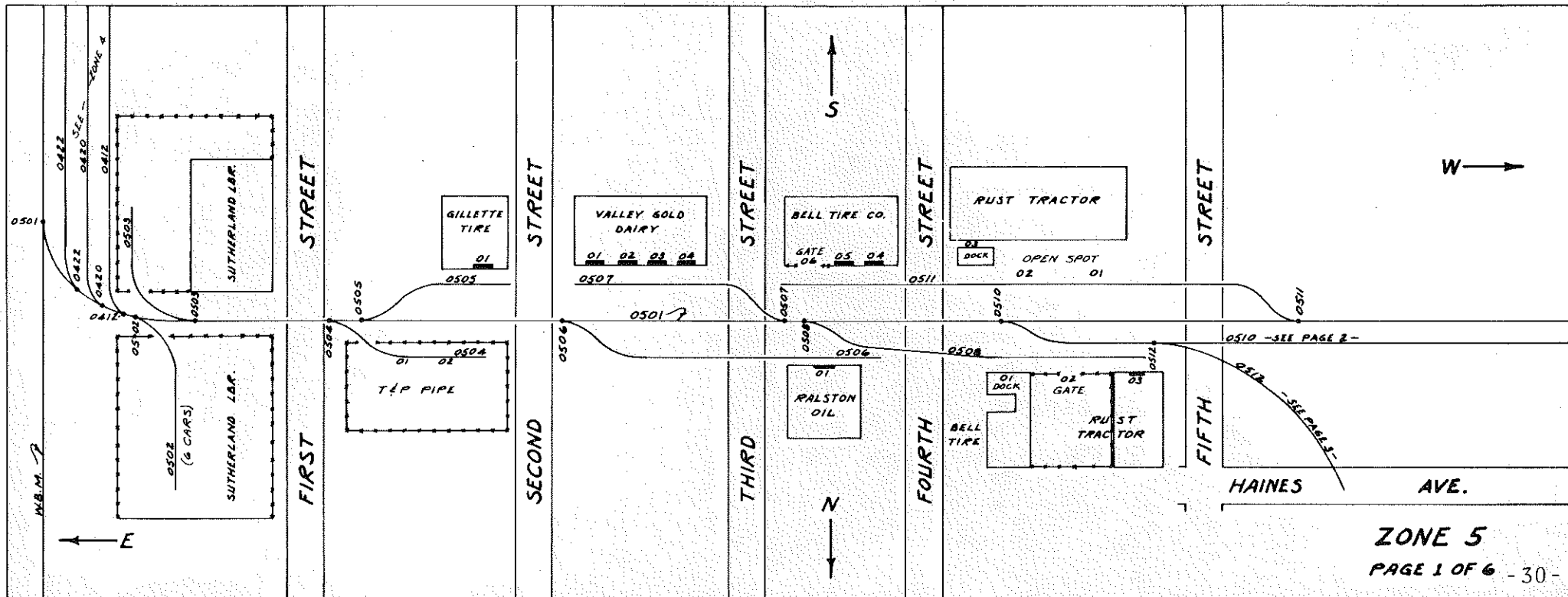



- |         |                                  |         |  |
|---------|----------------------------------|---------|--|
| 0510 01 | Wilger Tire East Door            | 0515 01 | Sun City Transfer, East Door 1         |
| 0510 02 | Architectural Systems, East Door | 0515 02 | Sun City Transfer, Door 2              |
| 0510 03 | Aardal Distr, Middle Door        | 0515 03 | Sun City Transfer, Door 3              |
| 0510 04 | Aardall Distr, West Door         | 0515 04 | Sun City Transfer, Door 4              |
| 0510 05 | Sanbusco, East Door 1            | 0515 05 | Sun City Transfer, West Door 5 at Dock |
| 0510 06 | Sanbusco, Middle Door 2          | 0516 06 | National Transfer, Open Dock           |
| 0510 07 | Sanbusco, West Door 3            | 0516 07 | National Transfer, Open Dock           |
| 0510 08 | Sanbusco, East Gate 4            | 0517 01 | Norva Corp (Big O) Door                |
| 0510 09 | Sanbusco, Middle Gate 5          | 0517 02 | Artistic Furn Door                     |
| 0510 10 | Sanbusco, West Gate 6 at Dock    | 0517 03 | Artistic Furn West Door                |
| 0513 01 | N M Tank & Culvert, Open Spot    |         |  |
| 0513 02 | N M Tank & Culvert, Open Spot    |         |  |
| 0513 03 | Lembke Constn, West Gate         |         |  |
| 0513 04 | Lembke Constn, Door              |         |  |
| 0513 05 | Lembke Constn, East Gate         |         |  |

-31-

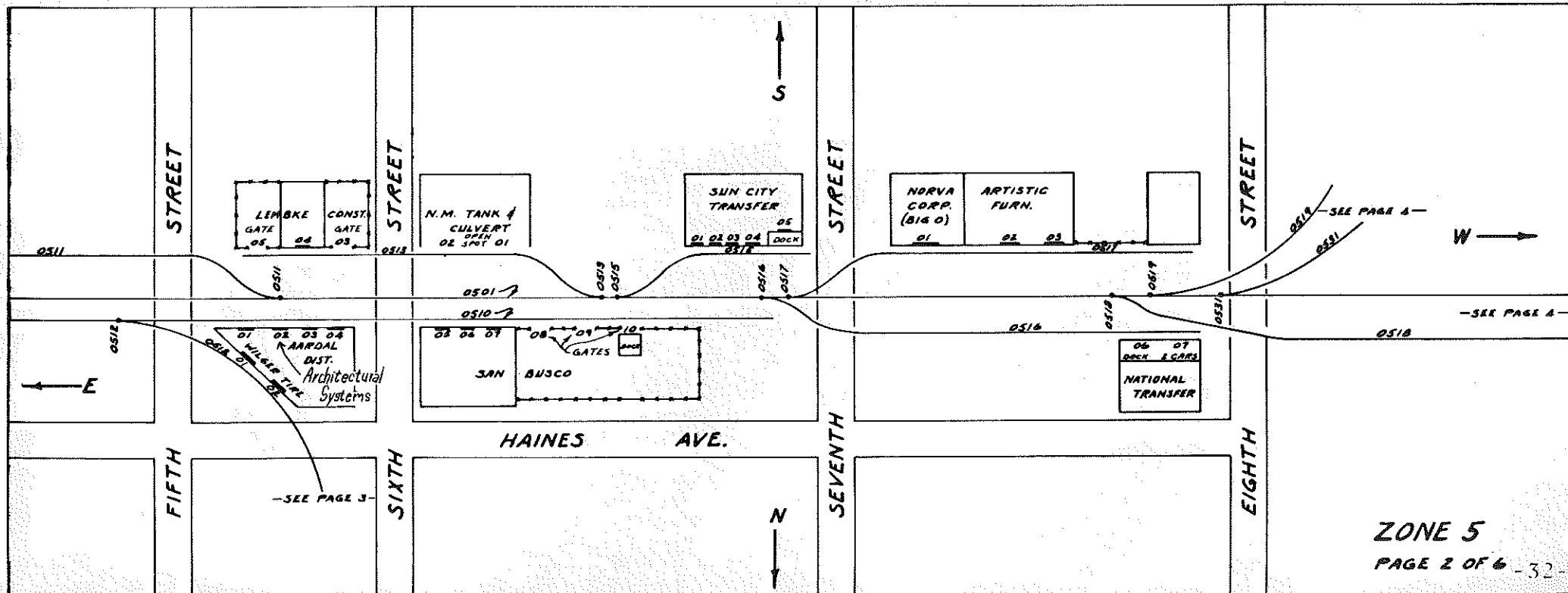

- 0512 Slaton Spur
- 0512 01 Wilger Tire, South Door
- 0512 02 Wilger Tire, North Door
- 0512 03 Desert Industries, Dock
- 0512 04 Sanbusco, Open Spot at Gate
- 0512 05 Pittsburgh Plate Glass, Crane
- 0512 06 Pittsburgh Plate Glass, Door
- 0512 07 Pittsburgh Plate Glass, Door
- 0512 08 Sanbusco, Open Spot at Gate
- 0512 09 Cunningham Distr., East Door
- 0512 10 Cunningham Distr., Middle Door

- 0512 11 Cunningham Distr., West Door
- 0512 12 Ideas Inc., East Door
- 0512 13 Ideas Inc., Middle Door
- 0512 14 Ideas Inc., West Door
- 0512 15 Albuqr Chemical East Door
- 0512 16 Albuqr Chemical West Door
- 0512 17 Calif Tire Co., Door at Open Dock
- 0512 18 Calif Tire Co., Gate at Open Dock
- 0512 19 M & W Appliance Co. Door
- 0512 20 National Biscuit East Door
- 0512 21 National Biscuit West Door

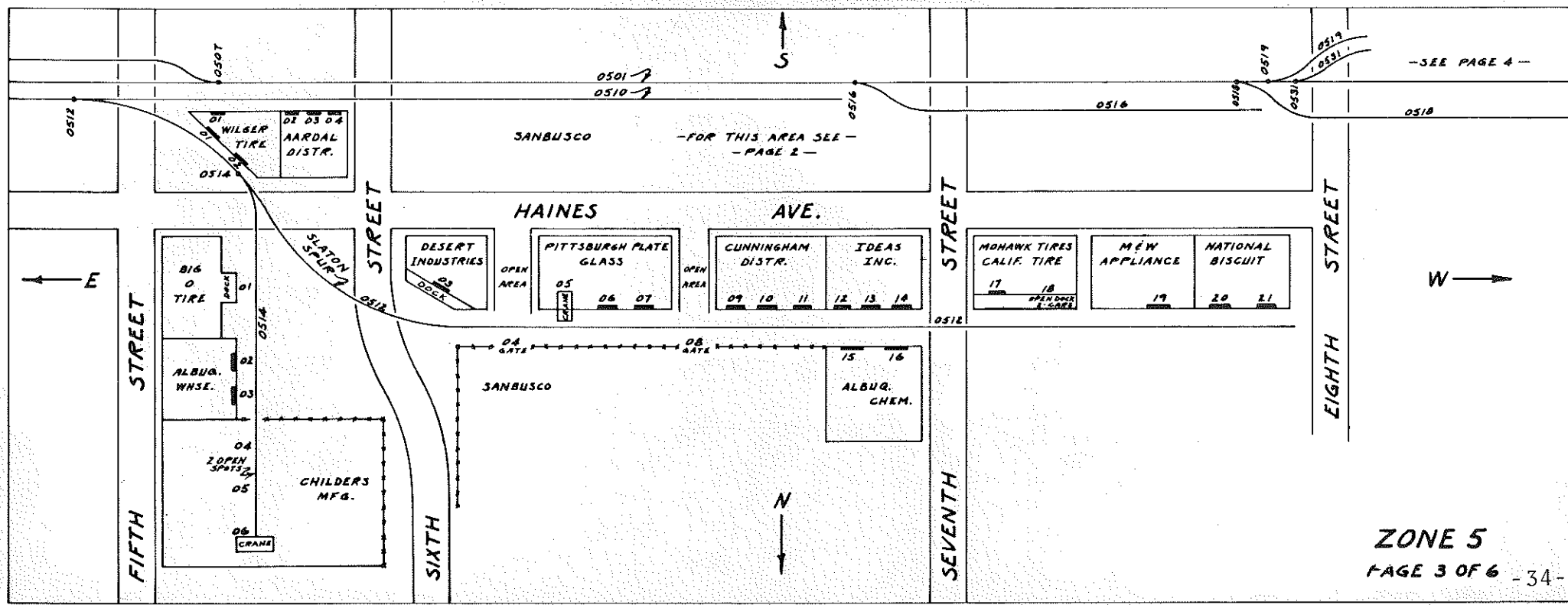

0518 01 Bureau of Indian Affairs, Dock  
 0518 02 G.S.A. Open Area East End  
 0518 03 G.S.A. Open Area East End  
 0518 04 G.S.A. Open Dock East End  
 0518 05 G.S.A. Open Dock by Door 9  
 0518 06 G.S.A. Open Dock  
 0518 07 G.S.A. Open Dock by Door 7  
 0518 08 G.S.A. Open Dock  
 0518 09 G.S.A. Open Dock by Door 5  
 0518 10 G.S.A. Open Dock  
 0518 11 G.S.A. Open Dock by Door 3  
 0518 12 G.D.A. Open Dock by Door 1  
 0519 01 Sawmill Pocket Track OMalley Lumber  
 0521 01 Gate City Steel Open Area  
 0521 02 Gate City Steel Open Area  
 0521 03 Gate City Steel Inside Bldg  
 0521 04 Gate City Steel Open Area  
 0523 01 Nat'l Transfer (Oakley) North Door  
 0523 02 Nat'l Transfer (Oakley) Middle Door  
 0523 03 Nat'l Transfer (Oakley) South Door

0525 01 Universal Carloading Door  
 0525 02 Universal Carloading, Dock  
 0527 01 Gorman Appliance North Open Dock  
 0527 02 Gorman Appliance South Open Dock  
 0527 02 House of Carpet South Open Dock  
 0531 01 Zork Hardware, Open Area  
 0531 02 Zork Hardware, Door  
 0531 03 Zork Hardware, Door  
 0531 04 Zork Hardware, Door  
 0533 01 O'Malley Glass, Door  
 0533 02 O'Malley Glass, Crane  
 0535 Sawmill Run-a-round  
 0537 01 Acme Fast Frt East Door  
 0537 02 Acme Fast Frt Door  
 0537 03 Acme Fast Frt Door  
 0537 04 Acme Fast Frt West Door  
 0539 N M Co. East Whse, Lead to  
 0541 Laun-Dry Supply, Lead to  
 0549 N M Cold Storage  
 0551 Duke City Lbr Co

-35-

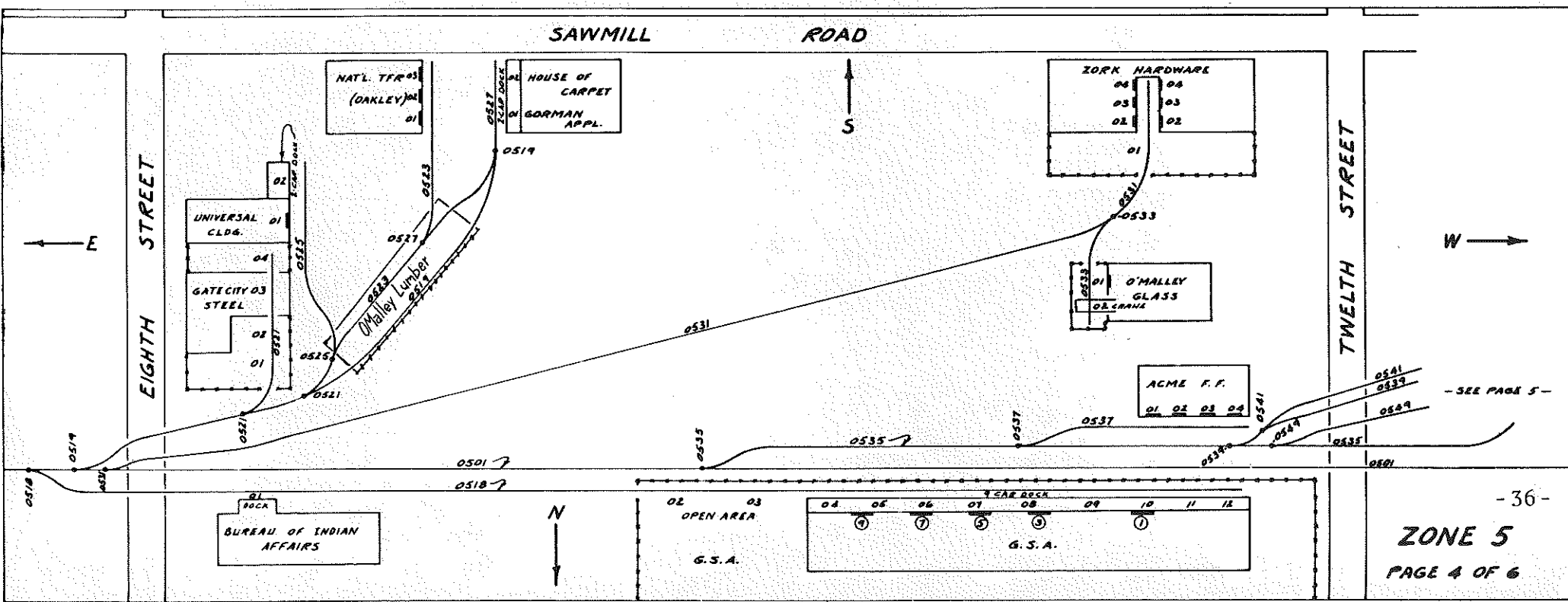

-36-

ZONE 5  
 PAGE 4 OF 6

0539 N M Co., East Track  
 0539 01 N M Co., East Track North Door 1  
 0539 02 N M Co., East Track Door 2  
 0539 03 N M Co., East Track Door 3  
 0539 04 N M Co., East Track Door 4  
 0539 05 N M Co., East Track Door 5  
 0539 06 N M Co., East Track Door  
 0539 07 N M Co., East Track Door  
 0541 01 Laun-Dry Supply, Open Dock  
 0541 02 A. Mathias, North Door  
 0541 03 A. Mathias, Middle Door  
 0541 04 A. Mathias, South Door  
 0541 05 Hale Sanitary Supply, North Door  
 0541 06 Hale Sanitary Supply, South Door  
 0543 01 Through  
 0543 07 N M Grocery Co., Open Dock 7 cars  
 0545 01 Through  
 0545 05 Kimbell Albuqr Co., 5 cars inside  
 0549 01 N M Cold Storage, East Door  
 0549 02 N M Cold Storage, Middle Door  
 0549 03 N M Cold Storage, West Door  
 0551 01 Through  
 0551 13 Duke City Lbr New Horn Open Area

0551 15 Duke City Lbr Bldg Spot Open Area  
 0551 16 Duke City Lbr Mldg Spot Open Area  
 0553 01 Duke City Mldg Whse, North Door 1  
 0553 02 Duke City Mldg Whse, Door 2  
 0553 03 Duke City Mldg Whse, Door 3  
 0553 04 Duke City Mldg Whse, Door 4  
 0553 05 Duke City Mldg Whse, Door 5  
 0555 01 Mexwood Products, Dock inside bldg  
 0555 02 Mexwood Products, Dock inside bldg  
 0555 03 Mexwood Products, Dock outside South side bldg  
 0557 Blueher Lbr Co., new track to be built  
 0559 01 Forest Products, Open Spot ldg east end  
 0559 02 Forest Products, Open Spot ldg  
 0559 03 Forest Products, Open Spot ldg  
 0559 04 Forest Products, Open Spot ldg  
 0559 05 Forest Products, Sawdust ldg East Spot  
 0559 06 Forest Products, Sawdust ldg West Spot  
 0559 07 Forest Products, Open Spot unldg  
 0559 08 Forest Products, Open Spot unldg  
 0559 09 Forest Products, Open Spot unldg  
 0560 Public Svc NM, Short Track inside  
 0562 01 Public Svc NM, Prager Station

-37-

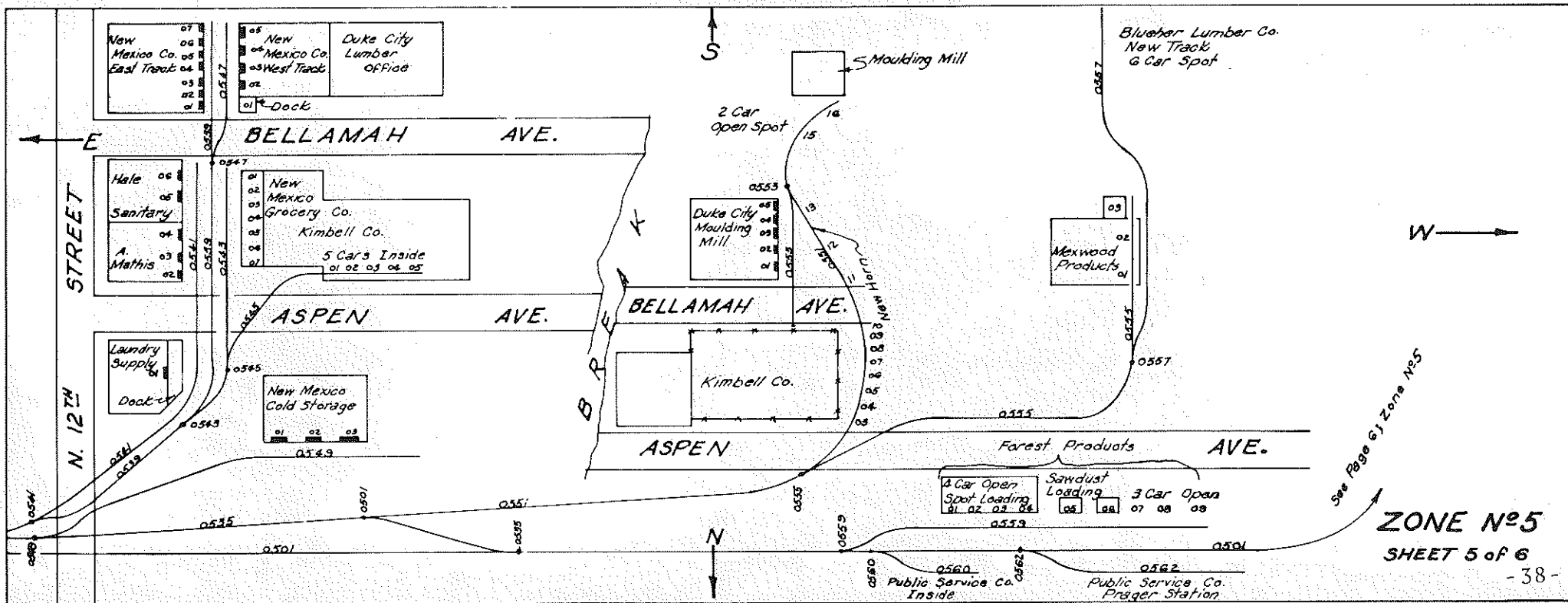

0563 01	Duke City Trk 45 Open Spots Through (North to South)	0571 01	Paint Pot, Tank Unldg	0585 05	Through (East to West) Mtn States Insul Doors
0563 05	Duke City Trk 45 Open Spots	0573 01	Paint Pot, North Door	0586 01	Wm. Volker Door
0564 01	Run-a-round Trk Open Spot	0573 02	Paint Pot, South Door	0588 01	Swift & Co, East Door 1
0564 02	Run-a-round Trk Open Spot	0575 01	Georgia-Pacific Short Track Open Spot	0588 02	Swift & Co, Door 2
0564 11	Paxton Lbr, Open Spot at Gate	0575 02	Georgia-Pacific Short Track Open Spot	0588 03	Swift & Co, Door 3
0565 01	Georgia-Pacific, Open Spot	0577 01	Keebler Co, North Door	0588 04	Swift & Co, West Door 4
0565 02	Georgia-Pacific, Open Spot	0577 02	Keebler Co, South Door	0588 05	Wm Volker Co, East Door
0565 03	Through (North to South)	0579	Blueher Lbr Co, E Trk outside	0588 06	Wm Volker Co, West Door
0565 08	Georgia-Pacific, Spots at Dock	0581 01	Blueher Lbr Co, inside Trk Open Spot	0589 03	State Distr Co, East Door 3
0565 09	Through (North to South)	0581 02	Blueher Lbr Co, inside Trk Open Spot	0589 04	State Distr Co, Door 4
0565 12	Georgia-Pacific, Open Spots	0581 03	Blueher Lbr Co, inside Trk Open Spot	0589 05	State Distr Co, Door 5
0567 01	Georgia-Pacific, Open Spots Through (North to South)	0583 01	Blueher Lbr Co Open Dock North Spot	0589 06	State Distr Co, West Door 6
0567 08	Georgia-Pacific, Open Spots	0583 02	Blueher Lbr Co Open Dock South Spot		
0569 98	Paxton Lbr, Open Spot	0585 01	Mtn States Insulation doors		
0569 99	Paxton Lbr, Open Spot				
0569 01	Paxton Lbr, East Door #1				
0569 02	Paxton Lbr, Door 2				
0569 03	Paxton Lbr, Door 3				
0569 04	Paxton Lbr, West Door #4				

-39-

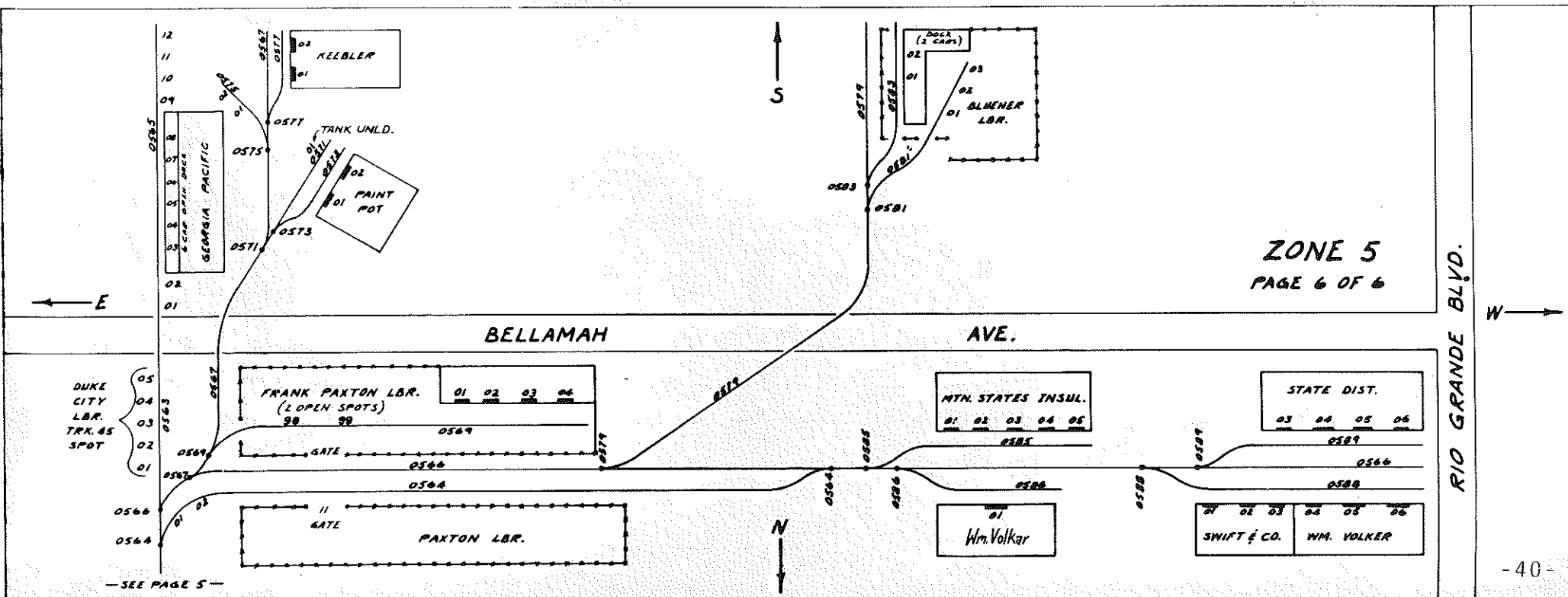

0601 00 Claremont Spur  
 0601 01 Builders Material Open Spot  
 0601 05 Builders Material North Dock  
 0601 06 Builders Material Open Spot  
 0601 08 Builders Material South Dock  
 0601 09 Builders Material South Dock  
 0601 10 American Forest Products Open Area  
 0603 01 Pacemaker Furn, Open Dock West Spot  
 0603 02 Pacemaker Furn, Open Dock East Spot  
 0603 03 Fir Pine Lumber, Open Spot  
 0603 04 Albuqr Lbr., Open Spot  
 0605 Killebrew Spur  
 0607 Stadler Spur  
 0608 Gibson Spur

0610 01 Big 3 Gas East Bldg Open Dock  
 0610 02 Banas Co., Open Area  
 0610 03 Garrett Freightways, Door  
 0610 04 Big 3 Gas West Bldg Open Dock  
 0610 05 Big 3 Gas West Bldg Open Dock  
 0611 01 Public Svc Co. N M Open Area  
 0611 03 Public Svc Co. N M Open Dock West End  
 0611 07 Public Svc Co. N M Open Dock East End  
 0611 08 Public Svc Co. N M Open Dock East End  
 0612 01 Eppsco, Open Area  
 0612 02 Eppsco, Dock West End Track  
 0613 01 Southern Union Gas Co. Open Area  
 0613 11 Southern Union Gas Co. Door at Bldg

-41-

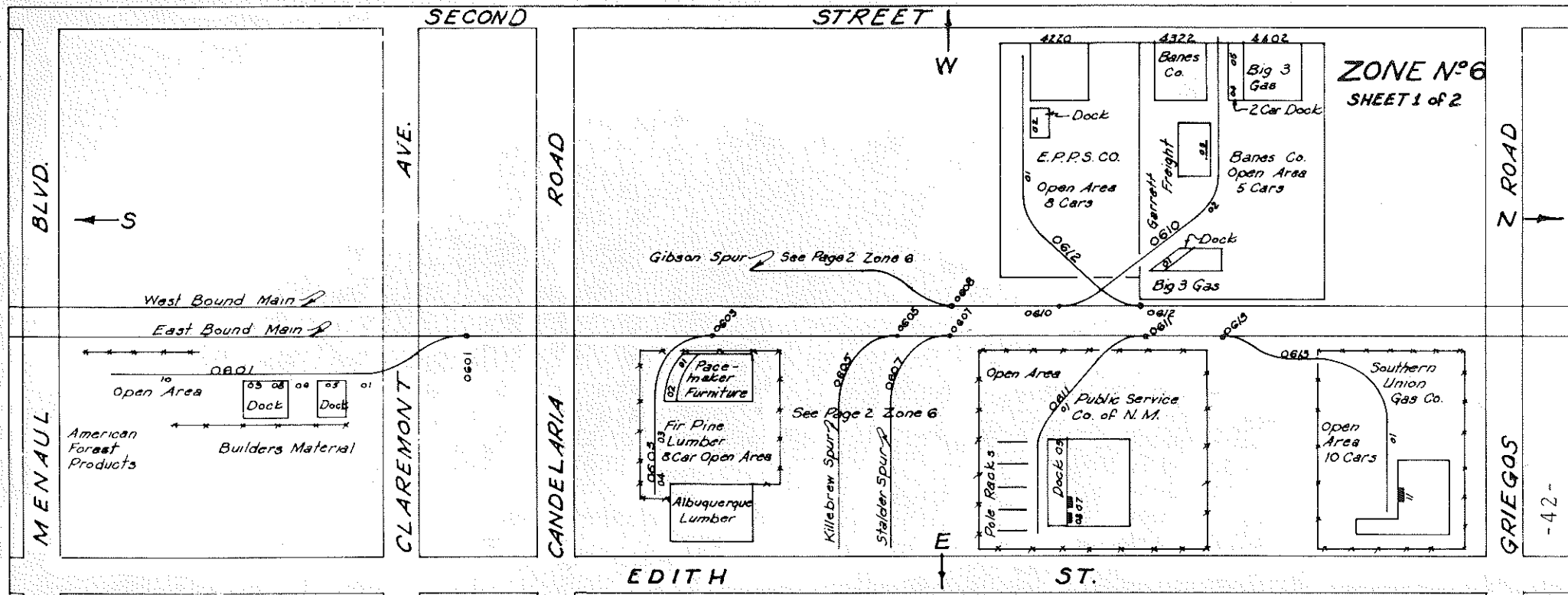

-42-

0605 Killebrew Spur  
 0605 01 Killebrew Spur, Open Area  
 0605 02 Killebrew Spur, Open Area  
 0605 03 Killebrew Spur, Open Area  
 0605 04 Killebrew Spur, Design Interiors  
 0605 05 Killebrew Spur, New Bldg East Door  
 0605 06 Killebrew Spur, Open Area  
 0605 07 Western Builders Supply, West Door  
 0605 08 Western Builders Supply, East Door  
 0605 09 Rust Sales, Door  
 0605 10 Contractors Heating, West Door  
 0605 11 Contractors Heating, East Door  
 0605 12 U S Plywood, Open Dock West Spot  
 0605 13 U S Plywood, Open Dock East Spot  
 0605 14 Furn Cty, West Door  
 0605 15 Old Georgia-Pacific, Door  
 0605 16 Old Georgia-Pacific, Door  
 0605 17 Old Georgia-Pacific, East Door  
 0607 Stalder Spur  
 0607 01 Quality Imp, Dock Dor 1 1  
 0607 02 Bottling, Dock Door 2 2  
 0607 03 Plant Wine, Dock Door 3 3

0607 04 Quality Imports, North Door  
 0607 05 Quality Imports, South Door  
 0607 06 Lath & Plaster, Open Dock West Spot  
 0607 07 Lath & Plaster, Open Dock East Spot  
 0607 08 Quality Import Bottle Plant Plant No.1, Door  
 0607 09 Stryco Sales, West Door  
 0607 10 Stryco Sales, Middle Door  
 0607 11 Stryco Sales, East Door  
 0607 12 Mtn States Chem, West Door  
 0607 13 Mts States Chem, East Door  
 0607 14 Mts States Chem, Open Dock  
 0607 15 Markham Co, West Door  
 0607 16 Markham Co, East Door  
 0608 Gibson Spur  
 0608 01 Apache Lbr, Gate 1 at Door  
 0608 02 Apache Lbr, Gate 2 at Door  
 0608 03 Apache Lbr, Gate 3 at Door  
 0608 04 Apache Lbr, Dock at end of bldg  
 0608 05 Apache Lbr, Open Area  
 0697 East Bound Main  
 0698 West Bound Main

-43-

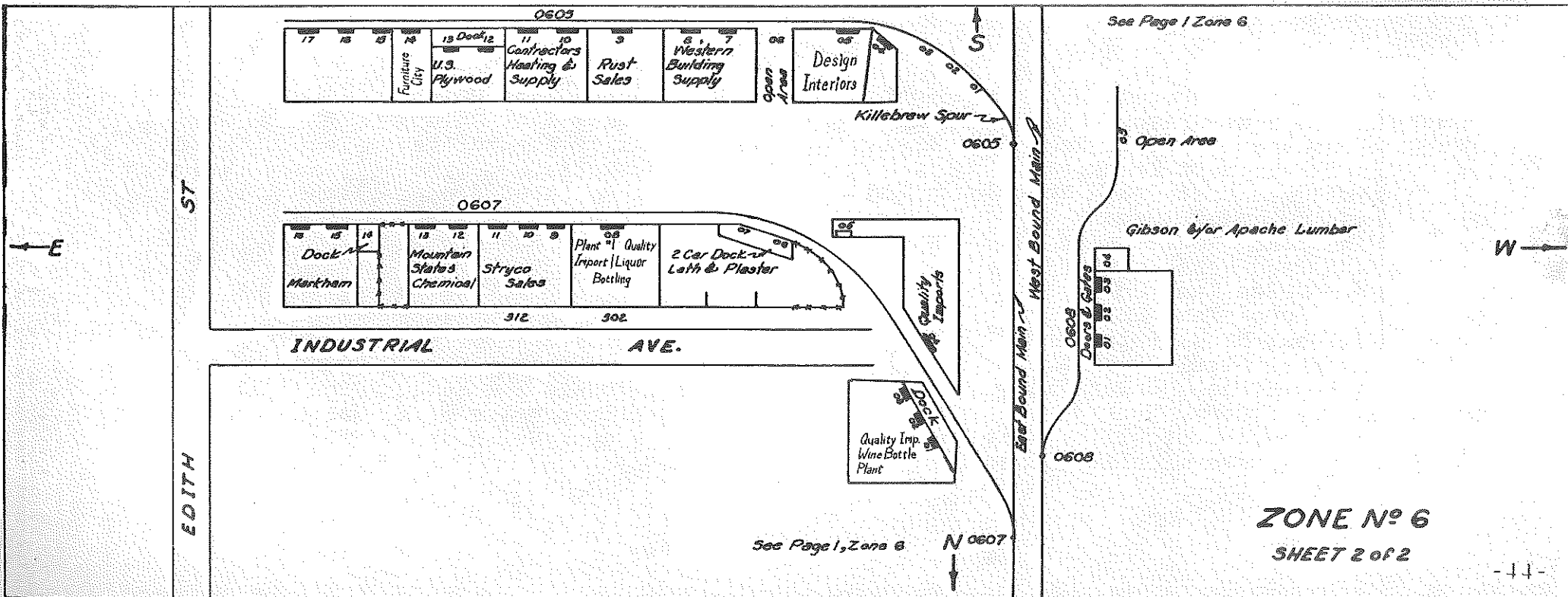

0701 01 Albuquerque Gravel, Hahn Open Spot  
 0701 02 Albuquerque Gravel, Hahn Ldg Ramp  
 0701 03 Albuquerque Gravel, Hahn Open Area  
 0704 Hahn Team East Track #1  
 0704 21 Hahn Team East Track Spot South End  
 0705 Passing Track, Hahn  
 0706 Hahn Team Middle Track #2  
 0708 Hahn Team West Track #3  
 0708 11 Kerr McGee Tank Unldg  
 0708 12 Kerr McGee Tank Unldg  
 0709 01 National Steel, Open Area  
 0709 02 National Steel, Open Area  
 0709 03 El Rey Stucco, Unldg Pit  
 0709 04 El Rey Stucco, Dock  
 0709 05 Southwest Vermiculite, West Door  
 0709 06 Southwest Vermiculite, East Door

0710 01 Dixel Tank Unldg  
 0710 02 Dixel Tank Unldg  
 0712 01 Associated Grocers, Zone C inside  
 0712 02 Associated Grocers, Zone B inside  
 0712 03 Associated Grocers, Zone A inside  
 0713 01 Rainbo Bakery, Door at Dock  
 0713 02 Rainbo Bakery, Flour Unldg Pit  
 0714 01 Grego Block Gate  
 0714 02 Grego Block Unldg Pit  
 0715 01 Kitts Enterprises  
 0715 02 Kitts Enterprises  
 0716 01 Acme Iron & Metal, Open Spot at Derail  
 0716 02 Acme Iron & Metal, Open Area Spot  
 0716 Winter-Weiss Spur, North Track  
 0718 Winter-Weiss Spur, South Track

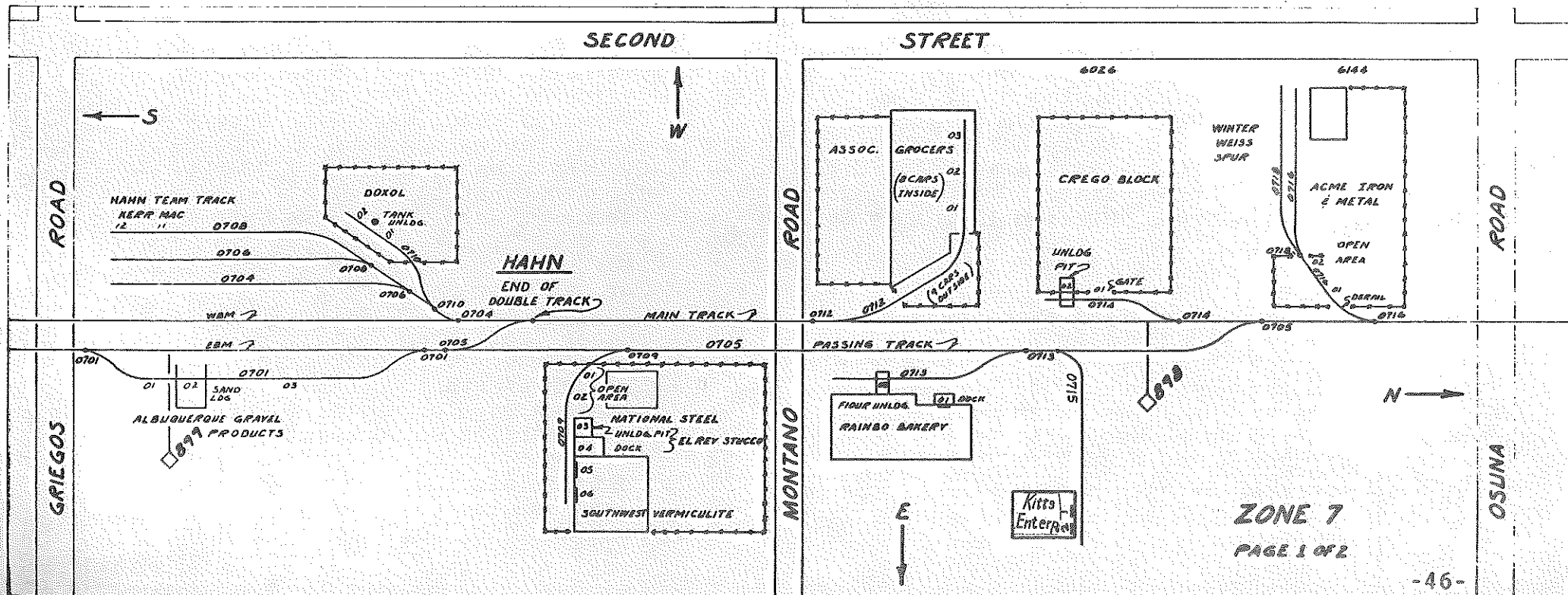



0722 Rio Grande Steel Spur  
 0722 01 Hutchinson Fruit, West Door at Dock  
 0722 02 Hutchinson Fruit, Middle Door at Dock  
 0722 03 Hutchinson Fruit, East Door at Dock  
 0722 10 Rio Grande Steel, Station 10 Unldg Crane  
 0722 11 Rio Grande Steel, Station 11 Unldg Crane  
 0722 12 Rio Grande Steel, Station 12 Unlodg Crane  
 0726 01 Tewa Moulding, Open Area Spots  
 0726 05 Sine Lumber, Open Area Spots  
 0726 07 Perfection Truss, Open Area Spots  
 0735 American Gypsum, Lead track to  
 0739 Overmeyer Warehouse Spur  
 0739 01 Overmeyer Whse, West Whse West Door 1  
 0739 02 Overmeyer Whse, West Whse Door 2  
 0739 03 Overmeyer Whse, West Whse Door 3  
 0739 04 Overmeyer Whse, West Whse Door 4  
 0739 05 Overmeyer Whse, West Whse Door 5  
 0739 06 A B M Supply, West Whse Door 6

0739 07 Overmeyer Whse, West Whse Door 7  
 0739 08 Overmeyer Whse, West Whse Door 8  
 0739 09 Overmeyer Whse, West Whse Door 9  
 0739 10 Valley Packaging, West Whse Door 10  
 0739 11 Overmeyer Whse, East Whse Door 11  
 Through (West to East)  
 0739 15 Overmeyer Whse, East Whse Door 15  
 0741 PBS of N M, Reeves Sta Open Area Spots  
 0745 01 American Gyp Co, Spots at Dock inside  
 Through (North to South)  
 0745 06 American Gyp Co, Outside Trk West Side  
 0745 06 Lumber Inc., Open Spot  
 0747 01 American Gyp Co, Inside Bldg  
 Through (North to South)  
 0747 10 American Gyp Co, Spots at Dock inside  
 0752 01 Best Moulding Co, Sawdust Ldg Spot  
 0752 02 Best Moulding Co, Open Area Spot  
 0752 03 Best Moulding Co, Open Area Spot  
 0752 04 Best Moulding Co, Open Area Spot  
 0752 05 Best Moulding Co, Open Area Spot

-47-

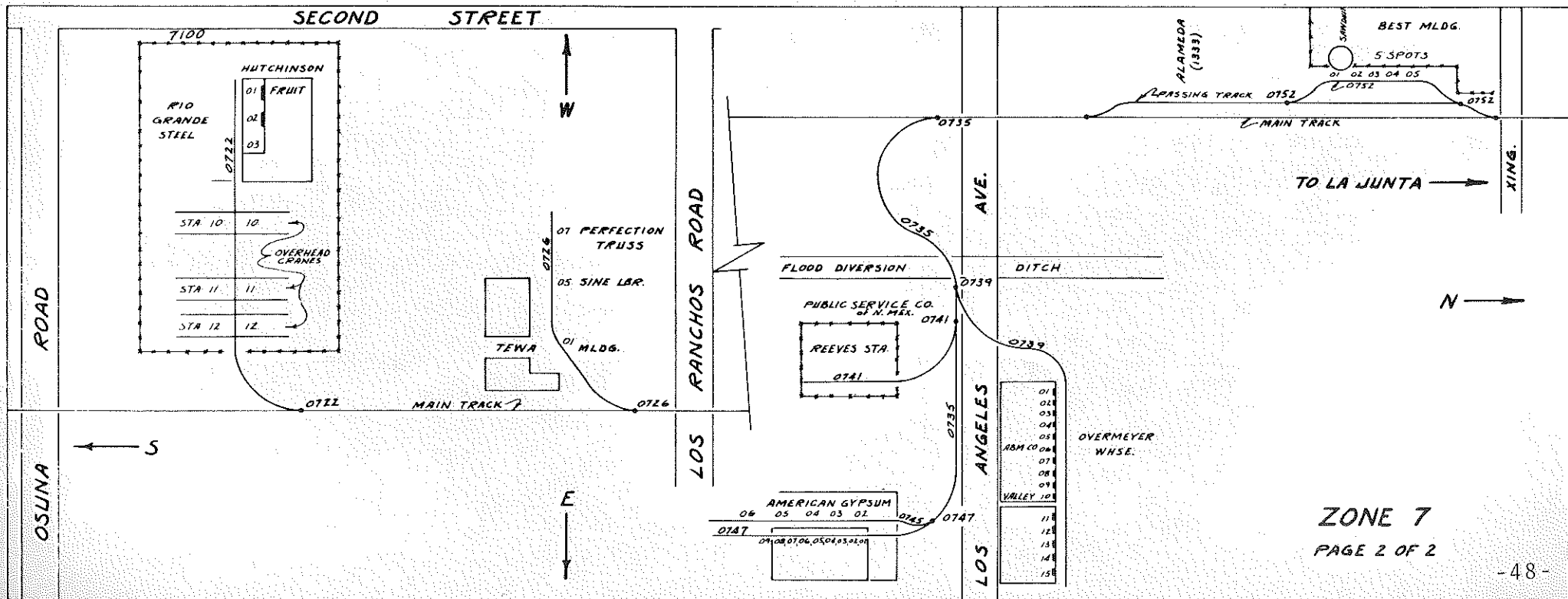

-48-

0802 West Pass at Stock Yards  
 0804 01 Refinery Spur, Unldg Pit  
 0804 02 Refinery Spur, Open Area Spot  
 0806 Schwartzman Packing Co, Open Area  
 0808 Newell Salvage, South Track  
 0810 Hebenstreit Spur, Open Area  
 0812 Newell Salvage, North Track  
 0812 06 Newell Salvage, Shredder North Track  
 0816 02 Chevron Asphalt, Gate Spot North Track  
 0816 04 Valley Lumber Co, Open Spot at Gate  
 0816 06 Valley Lumber Co, Open Spot Open Area  
 0816 07 Valley Lumber Co, Open Spot Open Area

0816 10 Wellborn Paint Co, East Door marked X  
 0816 11 Wellborn Paint Co, Door #1  
 0816 12 Wellborn Paint Co, Door #2  
 0816 13 Wellborn Paint Co, Door #3  
 0816 14 Wellborn Paint Co, Tank Unldg Spot  
 0822 Barcelona Lumber Spur  
 0822 01 Barcelona Lbr Co, North Gate Spot at Dock  
 0822 02 Barcelona Lbr Co, South Gate Spot at Dock  
 0823 03 Barcelona Lbr Co, Gate Spot  
 0823 04 Barcelona Lbr Co, Gate Spot South End  
 0823 05 Barcelona Lbr Co, Open Spot extreme South End

-49-

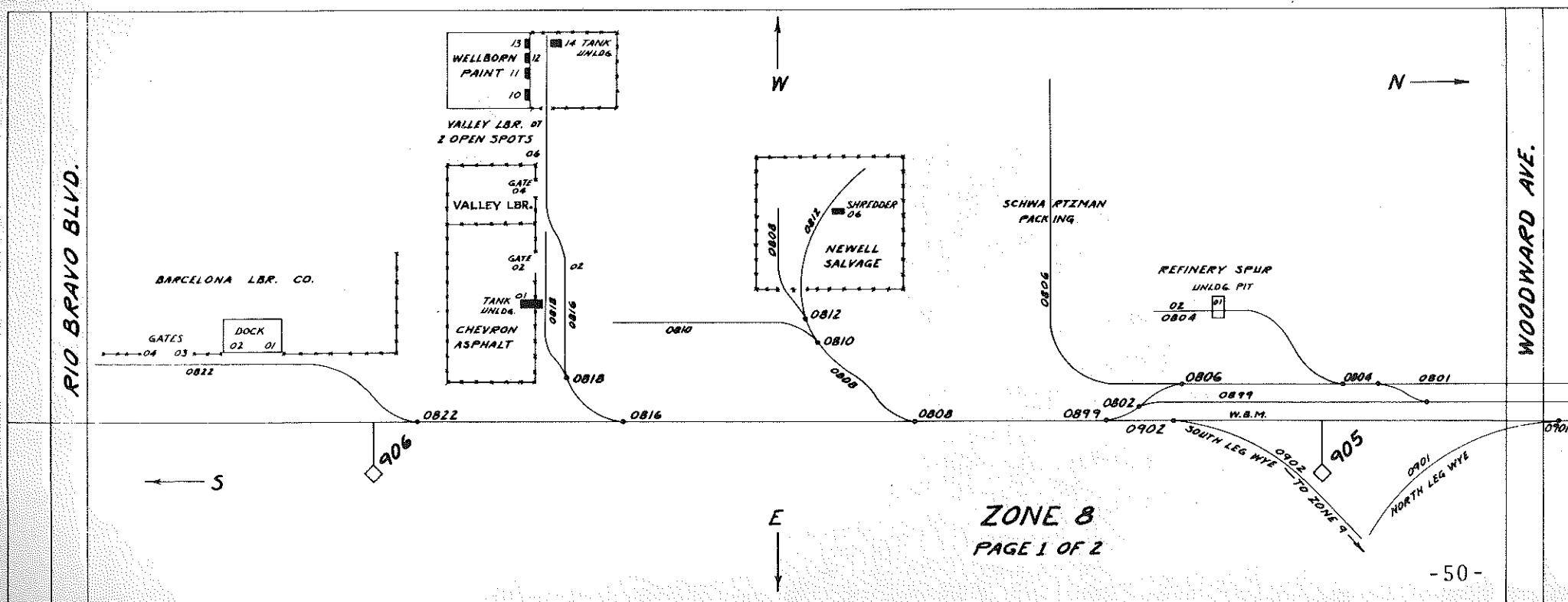

-50-

- 0851 01 Kinney Brick Co, Open Dock Spot
- 0851 02 Kinney Brick Co, Open Dock Spot
- 0851 03 Kinney Brick Co, Open Dock Spot
- 0851 04 Kinney Brick Co, Open Dock Spot
- 0851 05 Kinney Brick Co, Open Dock Spot
- 0871 01 American Concrete Pipe, Open Spots
- 0873 01 Stalder Industrial Park, North Track
- 0875 01 Stalder Industrial Park, South Track
- 0877 01 Old American Concrete Pipe Spur
- 0881 01 Briner Rust Proofing Spur, Open Spot - CEI Enterprise
- 0885 01 Industrial Wood Components, Dock at East End
- 0885 02 Industrial Wood Components, Open Area Spots
- 0891 Bates Lumber Co Spur
- 0891 01 Bates Luber Co, Open Area Spot West End Trk
- 0891 02 Bates Lumber Co, Open Area Spot West End Trk
- 0891 05 Bates Lumber Co, Woodchip Ldg Pipe

-51-

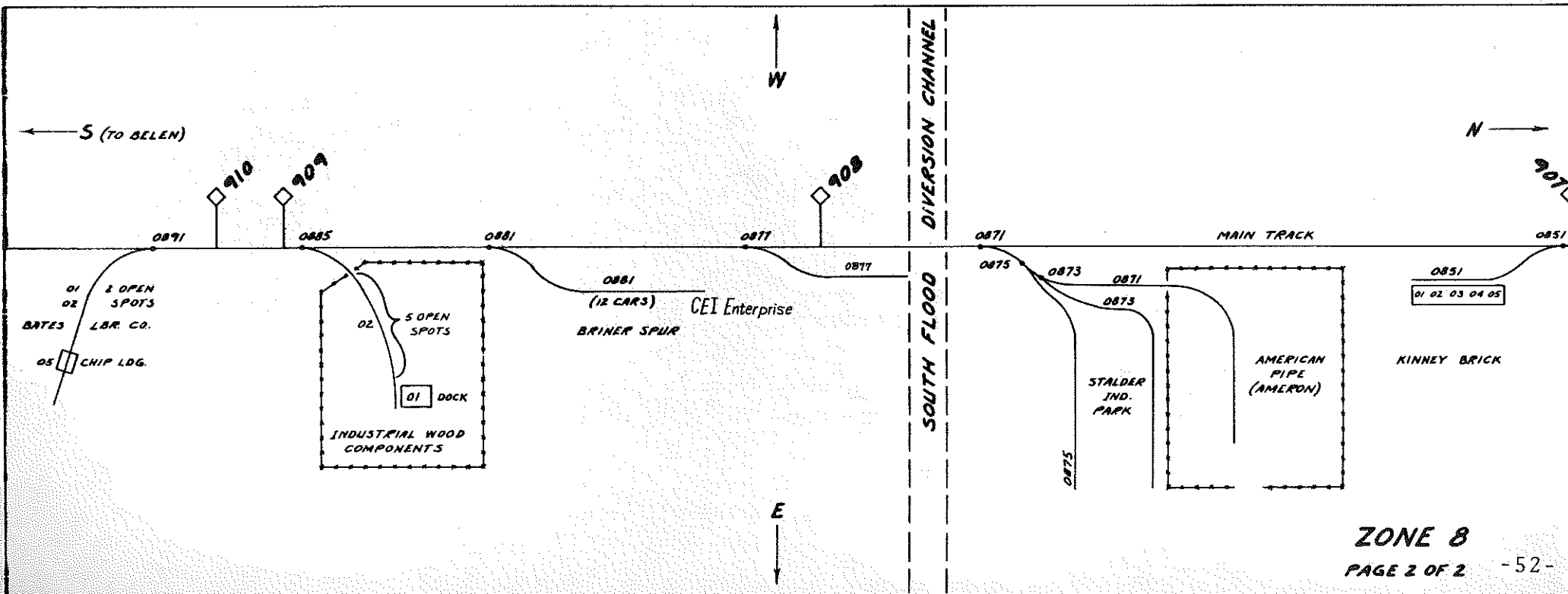

0901 North Leg of Wye  
 0902 South Leg of Wye  
 0903 TOFC Track, West Track  
 0905 TOFC Track, East Track  
 0909 Stock Yard Track, Old  
 0912 01 Arrow Freightways, End Dock  
 0914 01 Arrow Freightways, Open Area Spots  
 0914 11 Eidal International, Open Area South End  
 0914 12 Eidal International, Inside Bldg  
 0914 13 Eidal International, Open Spot between Bldgs  
 0914 14 Eidal International Inside North Bldg  
 0914 15 Eidal International, Open Spot North End  
 0914 16 Eidal International, Open Spot North End  
 0915 Lead to Tie Plant  
 0916 01 Arrow Freightways, Open Area Spots  
 0917 Farr Spur

0918 01 General Electric, West Track  
 0940 Lead to Sandia Base  
 0942 01 PBS of N M, Pearson Sta, Open Spots  
 0946 01 Ravel Bros Spur, Dock  
 0946 02 Ravel Bros Spur Open Area  
 0946 03 Fairview Eggs, South Door  
 0946 04 Fairview Eggs, Middle Door  
 0946 05 Fairview Eggs, North Door  
 0948 01 El Rey Stucco, Open Area Spot  
 0948 02 El Rey Stucco, Unldg Pit  
 0951 Old Tie Plant West Track  
 0952 Old Tie Plant  
 0953 Old Tie Plant  
 0954 Old Tie Plant  
 0955 Old Tie Plant  
 0956 Old Tie Plant  
 0957 Old Tie Plant, East Track  
 0958 Old Tie Plant, East Track

-53-

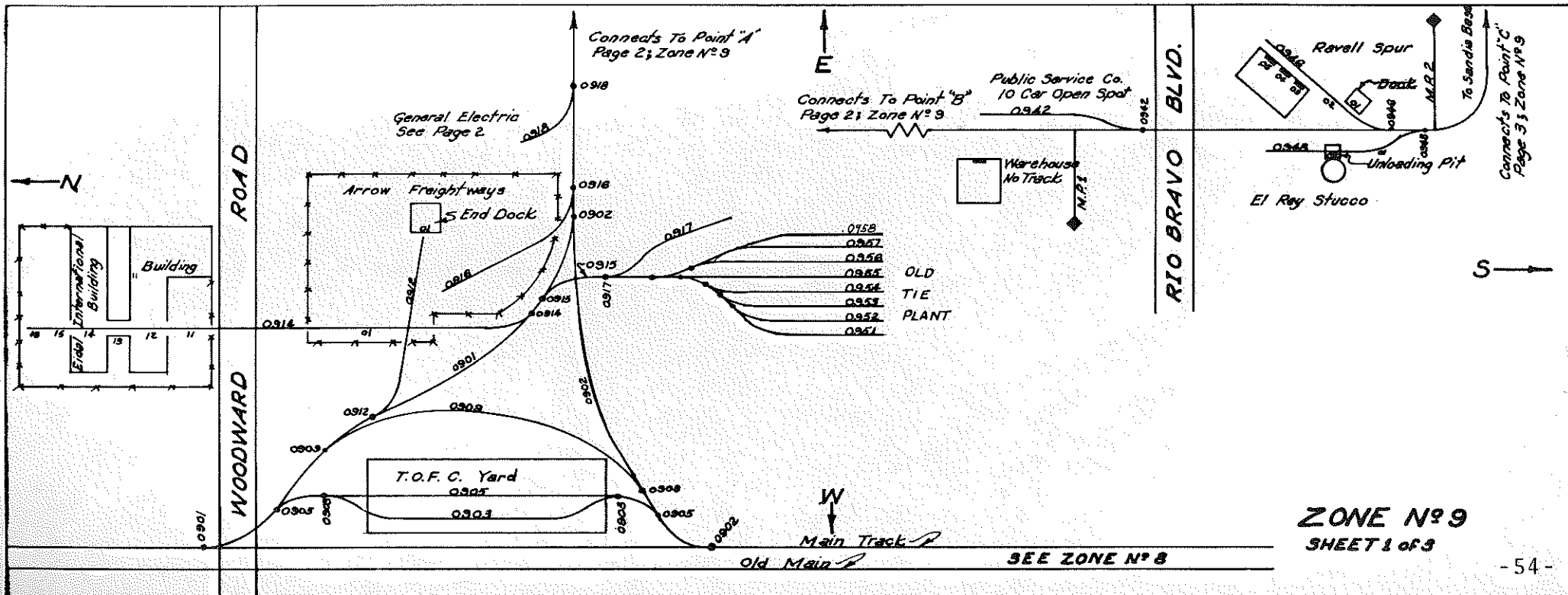

0901 West Kirtland, Lead to  
 0918 01 General Electric Co, West Track  
 0920 01 General Electric Co, East Track  
 0922 Lead to Texaco and Duke City Foods  
 0922 01 Duke City Foods, Dock  
 0924 01 Texaco, South Door  
 0924 02 Texaco, North Door  
 0924 03 Texaco, 4-car Tank Ldg Rack  
 0926 01 Standard Oil Spot 1  
 0926 02 Standard Oil Spot 2  
 0926 03 Standard Oil Spot 3  
 0927 04 Standard Oil Spot 4  
 0927 05 Standard Oil Spot 5  
 0927 06 Standard Oil Oil Spot 6  
 0927 07 Standard Oil Spot 7  
 0927 34 Standard Oil Co, Spot 34  
 0927 36 Standard Oil Co, 2-car Tank Ldg Rack

0930 01 Van Waters & Rogers, Dock Spot South End  
 0930 02 Van Waters & Rogers, Dock Spot  
 0930 03 Van Waters & Rogers, South Door  
 0930 04 Van Waters & Rogers, North Door  
 0930 99 Van Waters & Rogers, Open Area Spot  
 South End  
 0932 01 Van Waters & Rogers, Tank Unldg Spot  
 West Track  
 0940 Lead to Sandia Base

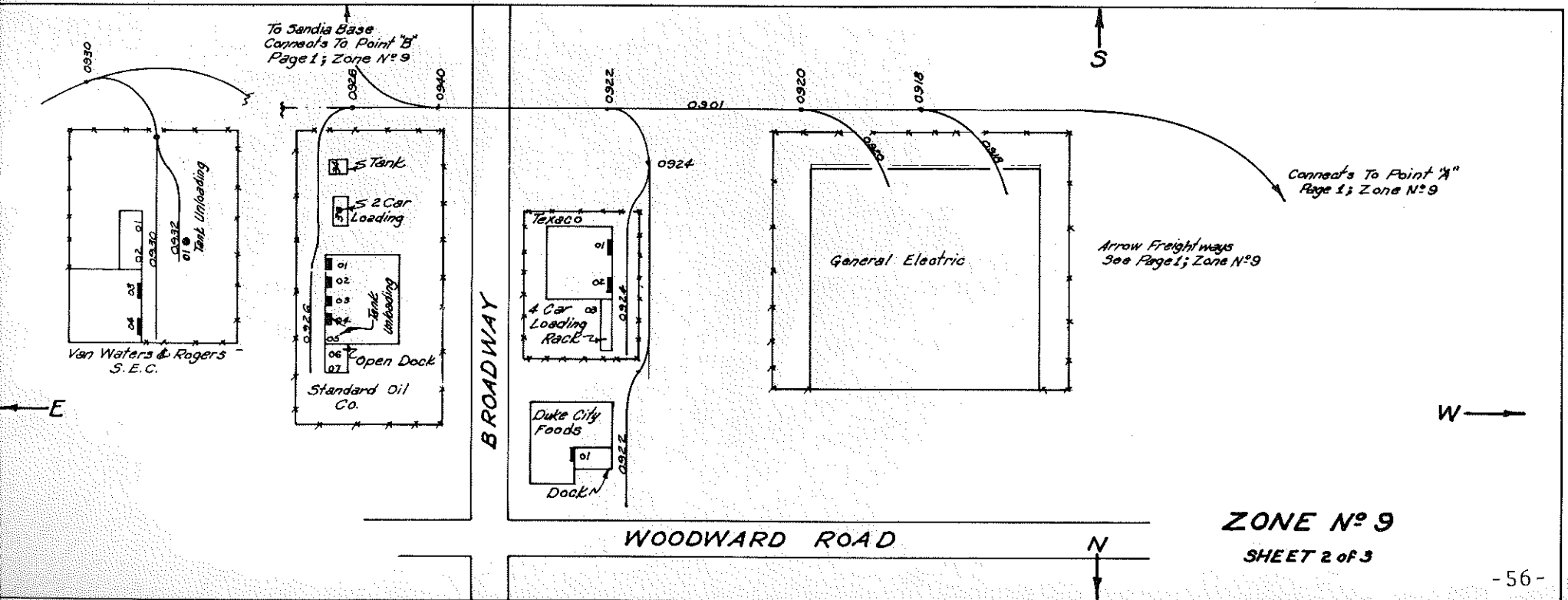

0940	Lead to Sandia Base	0974 02	Kirtland AFB, Whse 1010 Door (Commissary)
0961	Sandia Spur 1, Open Area Spots	0974 03	Kirtland AFB, Whse 1010 Door
0962	Sandia Spur, Passing Track	0974 04	Kirtland AFB, Whse 1010 Door
0964	Kirtland AFB, Track to	0974 05	Kirtland AFB, Whse 1010 Door
0964 01	Kirtland AFB Whse 1015 West Door, Open Dock	0974 06	Kirtland AFB, Whse 1010 Door
0964 02	Kirtland AFB Whse 1015 Door	0974 07	Kirtland AFB, Whse 1010 West Door at Dock
0964 03	Kirtland AFB Whse 1015 Door	0976 01	Kirtland AFB, End Dock
0964 04	Kirtland AFB Whse 1015 Door	0981 01	Sandia Spur 2, Open Area
0964 05	Kirtland AFB Whse 1015 Door	0991	Sandia Base, Passing Track
0964 06	Kirtland AFB Whse 1015 Door	0992	Sandia Spur 5 South Track
0964 07	Kirtland AFB Whse 1015 Door	0992 01	Sandia Spur 5 Open Area Spot
0964 08	Kirtland AFB Whse 1015 East Door, Open Dock	0992 02	Sandia Spur 5 Open Area Spot
0964 09	Kirtland AFB Whse 1015 Open Area East End	0992 03	Sandia Spur 5 East Spot at Dock
		0992 04	Sandia Spur 5 Spot at End Dock
0966 01	Kirtland AFB Acid Spot Salvage Yard Trk	0993 01	Sandia Spur 3 Spot at End Dock
0966 02	Kirtland AFB Salvage Yard Open Area Spot	0993 02	Sandia Spur 3 Open Area Spot
0968	Kirtland AFB, Track Number EK 1	0994 01	Sandia Spur 5 Fuel Unldg Spot North Track
0970	Kirtland AFB, North Tank Track at Rack	0994 02	Sandia Spur 5 Fuel Unldg Spot North Track West End
0972	Kirtland AFB, South Tank Track at Rack	0995 01	Sandia Spur 4 South Spot at Open Dock
0974 01	Kirtland AFB, Whse 1010 East Door at Dock	0995 02	Sandia Spur 4 Open Dock Spot
		0995 03	Sandia Spur 4 Open Dock Spot

-57-

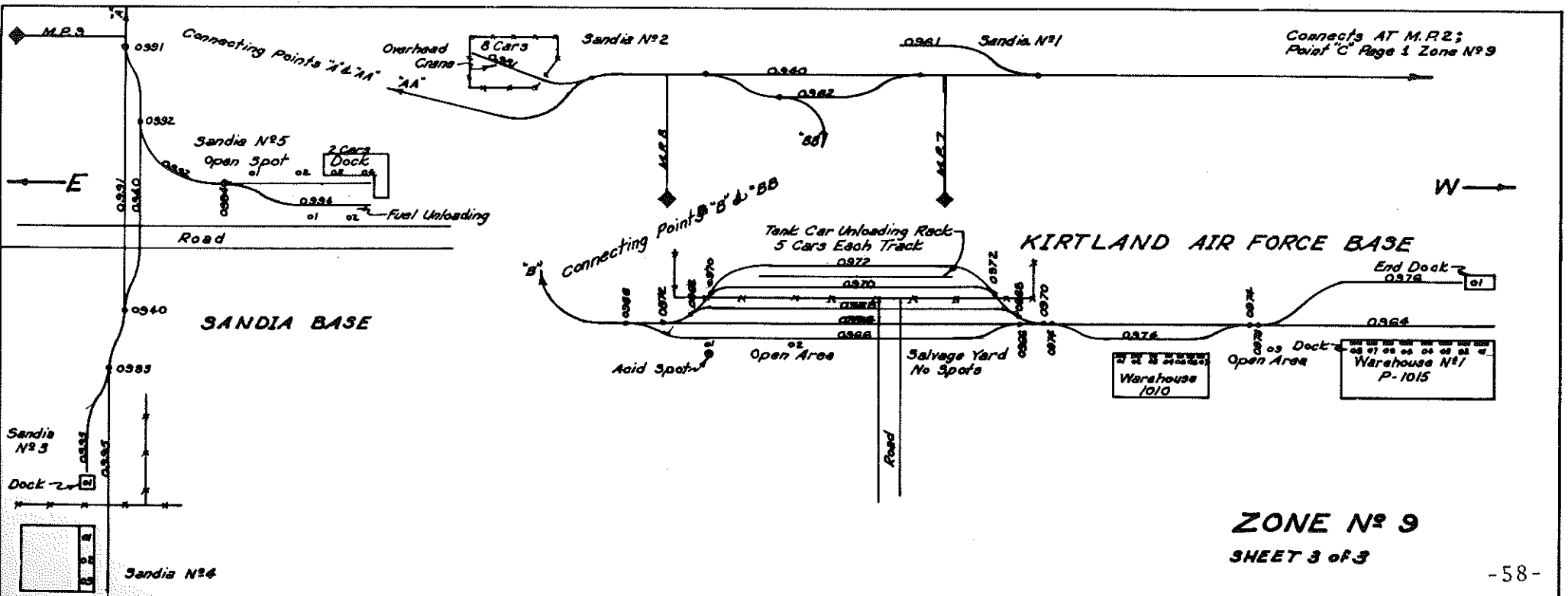

-58-