

CLIC BULLETIN NO. 11



**C**AR

**L**OCATION

**I**DENTITY

**C**ODES

INSTRUCTIONS - MAPS

LOS ANGELES DIVISION

THIRD SUBDIVISION

M.P. 143.2-148.3

REVISED: JUNE 1, 1986

## CAR LOCATION IDENTITY CODES

This booklet contains instructions and maps for the Car Location Identity Code (CLIC) and procedures governing the Work Order Document System.

Maps are not drawn to scale and are to be used only as a guide to locating customer and yard tracks and the numbers assigned to them.

The geographical area covered in this booklet is divided into zones. Each zone has designated tracks and/or industries within its boundary.

A CLIC number will consist of six digits- the first two digits designate the zone; the second two digits indicate the track number within the zone; the last two digits represent the actual spot along the track.

The combination of the zone-track-spot number is known as the "Car Location Identity Code" (CLIC) System.

This "CLIC" number will be used for switching and reporting purposes rather than the industry or track name.

### \*\*EXAMPLE OF CLIC NUMBER\*\*

12	22	04	___	Spot Number
			___	Track Number
			___	Zone Number

All switch targets or stands have been painted with a combination of the zone and track number.

Spot numbers have been painted on doors, docks, buildings, gates, etc., wherever possible.

### WORK ORDER DOCUMENT

Any written or verbal instructions issued to yard or road crews requiring work to be performed during their tour of duty will constitute a work order.

**NOTE:** Exceptions to written work orders must be noted on the work orders according to current instructions; cars handled on verbal work orders must be reported on the prescribed form.

For observation and guidance, the following codes may appear on work order.

AI	- Agri. Industries
B1	- Bad Order
BA	- Blasting Agent (Hazardous)
CG	- Cargill
CD	- Condemned
CB	- Combustible (Hazardous)
CL	- Chlorine (Hazardous)
CM	- Corrosive (Hazardous)
DG	- Dangerous
DH	- Do Not Hump
DU	- Do Not Uncouple
EQ	- Equity Export - Houston
FG	- Flammable Gas (Hazardous)
FL	- Flammable (Hazardous)
FS	- Flammable Solid (Hazardous)
FW	- Flam. Solid W (Dangerous When Wet)
HE	- Head End Only
HL	- High Wide Load
PE	- Houston Public Elevator
HV	- High Value
IP	- Interchange Prohibited
IPSW	- Intraplant Switch (Respot Car)
MR	- Mechanical Refrig. Maintain - Degrees
MCNR	- Mechanical Car or Trailer - No Refrigeration Required
NG	- Non-Flammable Gas (Hazardous)
NP	- No Placards Required
OM	- Oxidizer (Hazardous)
OP	- Organic Peroxide (Hazardous)
OR	- Other Regulated Material
OX	- Oxygen
PA	- Poison Gas (Hazardous)
PB	- Poison
RE	- Rear End Only
RM	- Radioactive Material
REJT	- Car Rejected by Shipper
RSPT	- Respot Due to Railroad Error
TURN	- Turn Car & Respot
WH	- Weight Heavy
WI	- Waive Inspection - Set Direct
WL	- Weigh Light
XA	- Explosive "A"
XB	- Explosive "B"
XX	- DO NOT MOVE THIS CAR

Conductors and Engine Foremen will be furnished work orders during their tour of duty.

This document will specify the cars to be picked up or set out at various stations, industries or interchange tracks served by the train or switch job.

Certain information (described below) must be recorded on the work order document by the Conductor or Engine Foreman. Prior to turning in the document at the designated reporting station, it must be dated and signed -- even if no work was accomplished. This is necessary to comply with switching and demurrage tariffs, as well as other rules and regulations.

Conductors and Engine Foreman must show on work order cars handled, time and date work performed, CLIC number taken from, CLIC number left and appropriate code as listed below:

- BO - Bad order
- ND - Work indicated not done (State reason.)
- NIT - Car not in train or not on track
- OTCC - Car on track, carriers convenience
- OTNP - Car on track not placed (State reason.)
- PULL - Car pulled, time and date
- SPOT - Car spotted, time and date

Conductor/Engine Foreman must make notation on work order and notify the appropriate employe (S/O, RYO clerk, Dispatcher) of any exceptions taken to the work order, such as no car, car not on list, car out of line, car is hazardous, excess dimension (when the information is not so indicated on work order), car is carded rear or head end movement, or any other exceptions noted.

If switching is performed without a work order, the Conductor or Engine Foreman must complete the prescribed form showing all the information required above and turn it in at the designated reporting station.

If an industry requests service not shown on work order, Conductor/Engine Foreman should obtain such request in writing. This request is to be turned in with work order for processing. If unable to obtain request in writing, Conductor/Engine Foreman should record on work order the name of person making request and the service requested and performed.

<u>CLIC #</u>	<u>NAME</u>	<u>MAP PAGE</u>
3300	Long Siding	109, 113
330101	Filtrol Vern Chem Plant	
3301	Snowden Spur	113, 115
330201	Filtrol Vern Chem Plant	115
330301	Filtrol Vern Chem Plant	115
330401-08	Filtrol Vern Chem Plant	115
330501-09	Filtrol Vern Chem Plant	115
330601	Excel Minerals	113
330601-07	Pennzoil Co	113, 114
330795	LAWI Consolidation	
330801-06	Nelson Distributors	113, 114
330802	Vacant	
330808-19	Finkel Outdoor	113, 114
330896	Bohnhoff Lumber	113, 114
330995	LAWI Consolidation	115
3310	Long Siding and Runaround	112, 114
331101	Bandini Whse IAP (Intl Auto Parts) FD Trading Great Empires	112
331102-03	Brown Stove Works	112
331301-02	Golden Bear Oil Div Witco Chemical	112
331296	PVO-PAC (PAC Veg Oil)	112
331303-04	Hart Bindry	112
331401	Bradshaw Int.	112
331402-04	Vernon Leather	112
331501	Golden Wool Co.	112
331502	Sierra Tanning Co	112
331601-03	Bee Distributing	112
331602	W. States Sales	
331603	World Fibre Mfg.	
331604	Dealers Installation	112
331605	Eureka Plastics	112
331606	Baker Intl Whse	112
331606-07	Sunroc Western	112
331608-09	Grubbs Agency CF Foods	112
331610	World Fibre	112

<u>CLIC #</u>	<u>NAME</u>	<u>MAP PAGE</u>
353501-03	GNB Batteries	142, 143
353601	Pioneer Metals	143
353701-05	GNB Batteries	143
353896	GNB Batteries	143, 144
353901-04	ATSF Whse	144
3540-01	Epp Sand Co	144
354490	National Can	119
354601-03	Vacant	134, 136
355004	Clorox Co	134
355091	East Field Lead	
355201-03	Seneca Assn	136
355202-10	Sweetheart Cup	136
355501-03	Better Made Plastic, Inc	145, 146
355504-05	Koppers Chem.	
355603-04	Keystone Steel Wire	145, 146
3556-90	Judson Steel	145, 146
355701-03	Vacant	146
355894	Clorox Chem	146
355901-07	Clorox Chem	146
356001-02	Victorville Barstow Trk	146
	BL Trk Trans	
356201-07	Clorox Chem	146
356301-07	Anchor Hocking	146, 147
356495	Higgins Trucking	147
356501-02	Prepared Products	147
	Joes Plastic	
356601-06	Amerace Chem	147
	West Chem Cmpd	
	Penetone Corp	
356701-05	Vacant	147
356706-07	F&S Distributing	147
356801-03	Fortifiber Corp	147, 148
356901-06	F&S Distributing Co	148
	Richards	
356909-10	Franklin Adams Inc.	148
	Silverline Prods Brake Div	
	Amex Mtl Sup	
357090	Agrashell Inc	148
	Agrashell Inc	148
357101-03	Agrashell Inc	148

<u>CLIC #</u>	<u>NAME</u>	<u>MAP PAGE</u>
331611-12	Cardinal Glover	112
331801-02	Joe's Plastic	112
	Frank Davis	
331901	Amerace Cpn Automotive	111
	Automotive Battery	
332001	Amerace Cpn Automotive	111
3349	Storage	111
335001	Amerace Corprn	111
335104	Superior Coffee	111
335121-27	Data Trans	111
335120	Malter Int.	
	Norman Williams	
335128	Superior Coffee	111
335129	Vacant	111
335130	Bloomfield Industries	111
335201-06	Western Auto Whse	111
335204-07	Sweetheart Soap	111
335209	Mercury Wholesale Auto	111
335301-04	G F Business Equip	111
	Century Product	
335305-06	Boise Cascade	111
335307	South Bay Wholesale	111
	James Hill	
335401	South Bay Wholesale	111
338001-06	N L Inds. Paint Div	111
	Dutch Boy Paints	
338196	Alpert & Alpert	109, 110
338296	Alpert & Alpert	109, 110
	AKA Vista Sales	
338403-05	Alex Coleman, Inc.	109, 110
338501-07	CA Stuffed Toys, Inc.	109, 110
338801-03	Paradise Mfg	110

<u>CLIC #</u>	<u>NAME</u>	<u>MAP PAGE</u>
357201-05	Agrashell Inc	148
358001-03	W. Steel and Tinplate	136
358004-05	Lees Bars Stools Dinett Lees Purchasing Inc	136
358101	Calif Rendering	136
358296	Southwest Processor	136, 137
358104-05	Baker Commodities	137
3584	LAJ Lead	137
3585	Stub Track Lead	137, 138
358601-03	Parco Inc	139
353604-05	Baker Commodities	139
358605	J&M Rendering	139
358701-04	Golden Wool Co	139
358890	Proler Intl Co	139
358990	L A By Products Vulcan Detinning	140
359301	S&L Master Distr Excel. Prod., Inc Riekes Crisa Corp	118, 119 144 144
359304	Bankok Market	118, 119
359306	Specialty Pack	118, 119
359307	Tri Furn Distr G. M. Levine, Mfg	118, 119
359308	Bill Brown Sales	118, 119
359309	Pioneer Stationers	118, 119
359897	Vacant	117, 119
3701	Storehouse Track 1 Luttrell Storekeeper J. Vaughn	121, 123 125, 126 128

<u>CLIC #</u>	<u>NAME</u>	<u>MAP PAGE</u>
339396	Alpert & Alpert	109
340101-07	Stinnes-Western Chem.	113, 114
340201-03	Filtrol Corp D	113, 114
340301-09	Filtrol Corp C	113, 114
340401-06	Filtrol Corp B	113
340801-04	Filtrol Corp A	113
340995	Edgecraft Co	112
345096	Imperial Pipe Sply	109
351201-06	National Can Co	135
3520	West Field Lead	135
352101-04	National Can Co	134, 141, 145
352201-02	Executive Whse	134, 141, 145
352401	Bandini Fertilizer	141
352402-03	Calif Rendering	141
352690	Bandini Fertilizer	141
352701-07	Estech Genl chem	141, 142
352801	West Cast Rendering	141
352802-03	So West Processors	141, 142
353003-04	So Bay Wholesale Rasco Stores	142
353005-06	Rehrig Pacific	142
353007-08	Eagle Rubber	142
353490	Gould, Inc. Metal Divn GNB Batteries	142, 143

<u>CLIC #</u>	<u>NAME</u>	<u>MAP PAGE</u>
390196	Ford Motor Co	160, 162
390101-03	Autolite Parts Divn	
390505-07	Clipper Express	155, 156
390601-03	Clipper Express	155, 156
390801-04	C. B. Delivery Svc	156, 160
	United Stores Whse	
390809	F.T.L.	
390805-10	Vacant	156
390811-12	Vacant	156
390813	Vacant	156
391101-06	MSA LAMDA	
	Road Rail Trans.	
	Pacific Progress	
391103	W. Std. Transportation	
391201-06	MSA Lamda	150, 155
392101-05	LAWI CSA Consolidators	149
	MSA LAMDA	
	RC Trucking	
392201-07	LAWI CSA Consolidators	149
	MSA LAMDA	
393001	Leos Dental Prods	150, 152
393021-26	AMVAC Chem	150, 151

<u>CLIC #</u>	<u>NAME</u>	<u>MAP PAGE</u>
3702	Storehouse Trk 2 (Diesel Track #7)	121, 126
	Luttrell	
370602	Sharpe Diets Co	
3711	Rip Trk 1	121, 126
	J. H. Vaughn	
3712	Rip Trk 2	125, 126, 128
3713	Rip Trk 3	125, 126, 128
3714	Rip Trk 4	125, 126, 128

<u>CLIC #</u>	<u>NAME</u>	<u>MAP PAGE</u>
393030-31	Globe Grease	151
393032-03	Blocksom and Co	151
393035	Sinclair Paint	151
393090	Groh C.W. D. A. Mansheim	
393190	D. A. Mansheim	151
393201-03	Lubricating Co of America	152
393601-03	Leo's Dental Prods David Fell Forquer Forque	152
393701-02	AMRAC Chem	152
393801-06	Golden Bear Divn Witco	151
394001	Penreco	152
394002	Vacant	
394003	Parker Petroleum	152
394004	Vacant	153
394019	Penreco	153
394032	C T S Tool Co	154
394036	Ceramic Decorating	154
394044	Vacant	154
394046	Triangle Cold Stge	154
394090-95	Penreco	153
394101	Motor Guard Lube	
394201	Penn Refining/Penrcco	153
394301-03	Vacant	153
394304	Vacant	153
394304-05	ATSF Rwy Sinclair Paint	153
394401	E. E. Processing	153
394501-02	House of Ideas	153
394701-03	Parker Supply/Sunset Fireplace	154
394702	Aiden Int.	
394801	Viking Automatic Spkr.	154

<u>CLIC #</u>	<u>NAME</u>	<u>MAP PAGE</u>
3808	Storage	134
3809	Ramp Pocket	120, 121, 123
380901	Ramp Lead	121, 123
3811	Caboose Trk (Dsl Trk #1)	120, 123
3812	Diesel Trk #2	
3813	Diesel Trk #3	121, 123
3814	Diesel Trk #4	121, 123
3815	Diesel Trk #5	121, 123
3816	Diesel Trk #6	121, 123
3851	Straddlebuggy 1	116, 117, 120, 130, 131
3852	Straddlebuggy 2	117, 118, 122 131
3853	Straddlebuggy 3	
3854	Straddlebuggy 4	117, 118, 122 124, 131
3855	Straddlebuggy 5	122, 124, 129
3856	Straddlebuggy 6	120, 122, 124
3857	Straddlebuggy 7	120, 122
3858	Straddlebuggy 8	120, 122
3861	Straddlebuggy Lead	118, 120, 122 124, 129, 131
3862	Mid Track	122, 124, 129, 131

<u>CLIC #</u>	<u>NAME</u>	<u>MAP PAGE</u>
473001-04	Johnson Sons, Inc. 02-03-04 Spots	172
473101-03	McKesson Robbins Drug Divn/Formac, Inc	172, 173
4731-04	Vacant	172, 173
473203-04	Die Craft Tool	172, 173
473201-03	Action Leathercraft	
473401-04	Bryant Air Condition	172, 173
473601-06	Weber Truck Caloric Corp	172, 173
473701-06	McKesson Robbins Chemical Divn	172, 173
474201-02	American Cyanamid	169, 171
474401	Computer Management	169, 171
474402	Neptune Meter Co	169, 171
476095	Gallo Wine Co	165, 174, 176
4762	Vacant	
476301-06	Blake Moffitt & Towne	174, 176
476401-06	Blake Moffitt & Towne Drill Trk	174, 176
476701-06	Crown Zellerbach Flexible Packaging	175, 176
476890	Crown Zellerbach Flexible Packaging	175
4770	Lead East End Industry	177
477304-06	Boyle Midway	177, 178
477408	Boyle Midway	177
478001-08	Jersey Maid Co	178

<u>CLIC #</u>	<u>NAME</u>	<u>MAP PAGE</u>
4555	Autoveyor 5 Team Track Convoy	176
4570	C Yard Lead	181
461101	Certified Grocers	163
461201	Certified Grocers	163
465092	Certified Grocers of CA Grocers Specialties	164
465192	Certified Grocers of CA	164
465292	Certified Grocers of CA	164
471101-03	Chemical Specialties	165, 166
471101-03	Pennwalt Co	165
471201-04	BeLeon Co	166, 167
471301-02	Northrup King	166, 167
471501-02	Mercadolatino G. Rodriguez	166, 167
471601-02	Organic Foods Garden Miller Electric	166, 166
471701	Gibbs Wire Steel	167, 168
471702	A. C. Depuydt, Inc.	168
4720	S and H Lead	168, 170
4721	Middle Lead	168, 170
472201-02	Kaman Bearings Corp.	170
472301	Coast Detergent	170
472401	Vacant	170
472501-04	Ennis Buisness	170, 172



<u>CLIC #</u>	<u>NAME</u>	<u>MAP PAGE</u>
478009-12	Union Ice Co	178
478501	Zacky Farms	179, 180
478505-07	Dalgaty Foods	179, 180
	Santa Fe Driscoll	
478509-10	Union Ice Co	179, 180
479001-06	International Paper	180

<u>CLIC #</u>	<u>NAME</u>	<u>MAP PAGE</u>
394802	Metro U S. Equipment	154
3949	Storage	154
395001	PPG Industries	153
	United Refrigerator	
395002-03	Cale Ramics	153
395004	True Prods	153
	Astro Pneumatic Tool	
	Fishernat	
395004	Unimac	153
	United Marquette Aplnc.	
398092	Western Carloading	123, 125
	Pacific Forwarding	134
4410	Lever Brothers	
441101	Eleven Pocket	133
441301	Thirteen Pocket	157
441401	Fourteen Pocket	157
4418	Hold Track	
4421	Hold Track	
4445	Hobart Yard	
4451	117 Pocket	124, 129
4501	Autoveyor Stge	165, 176
	Track 1	
4502	Autoveyor Stge	165, 176
	Track 2	
4503	Autoveyor Stge	165, 176
	Track 3	
4551	Autoveyor 1	176
	Convoy Team Track	
4552	Autoveyor 2	176
	Convoy Team Track	
4553	Autoveyor 3	176
	Convoy Team Track	
4554	Autoveyor 4	176
	Convoy Team Track	

0902P

- P -

- m -



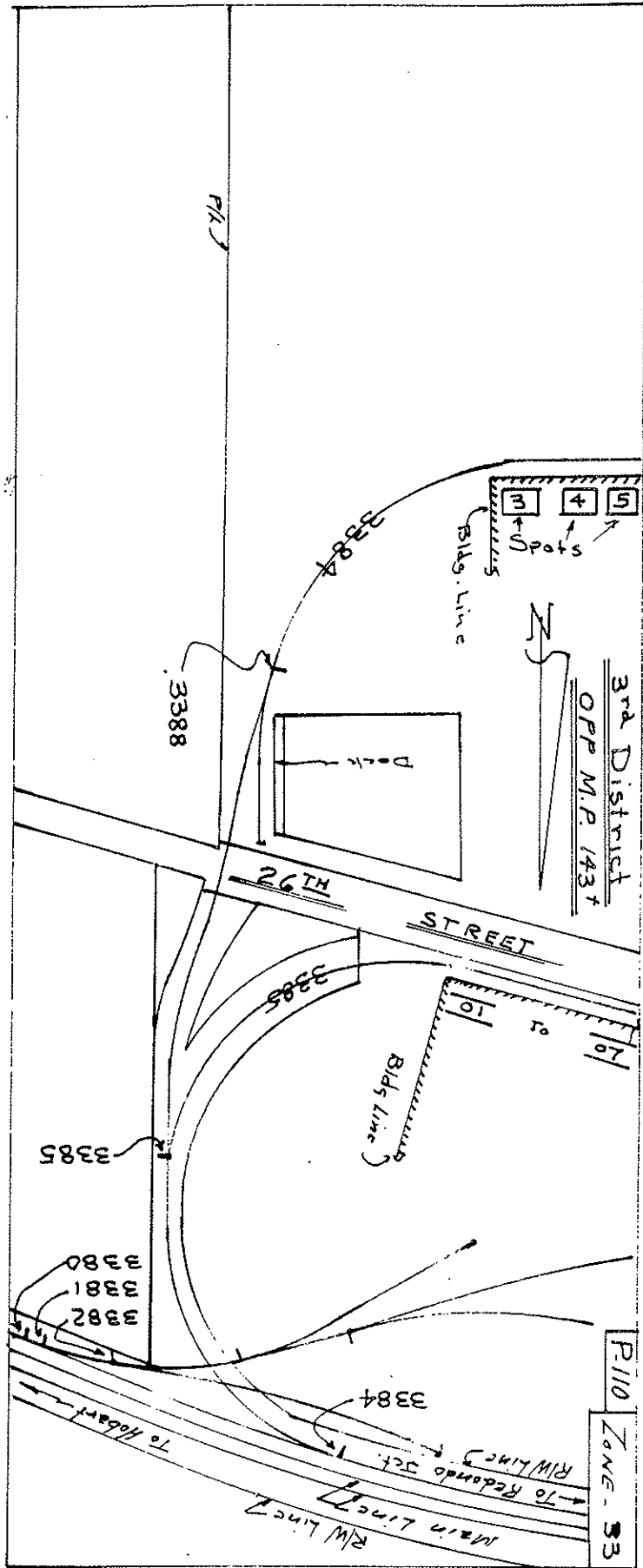
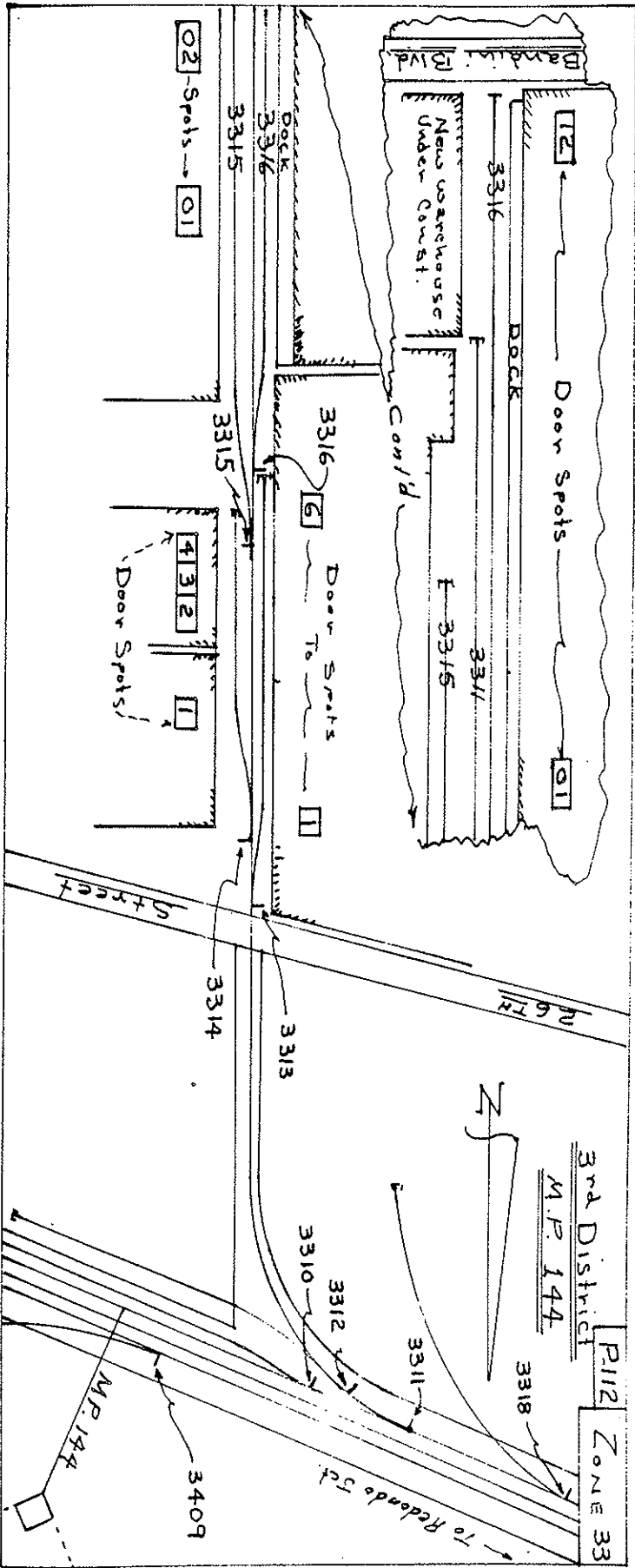

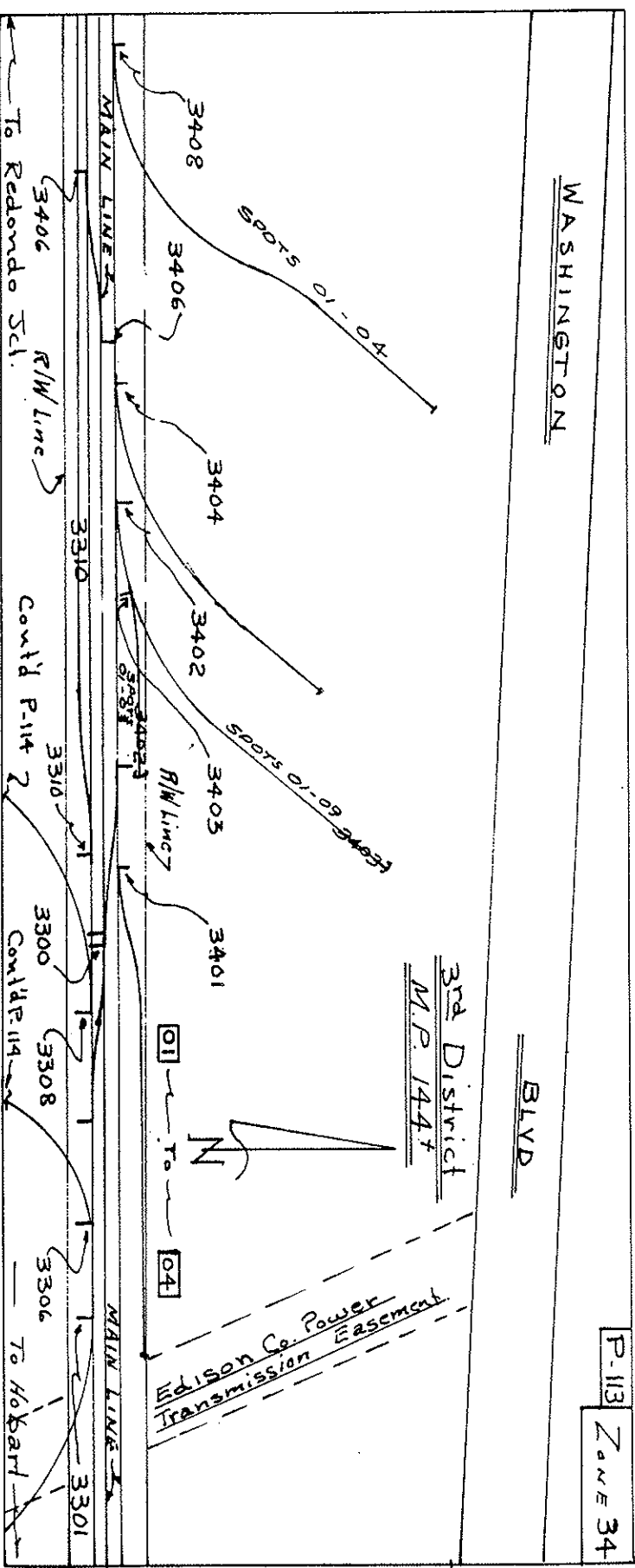
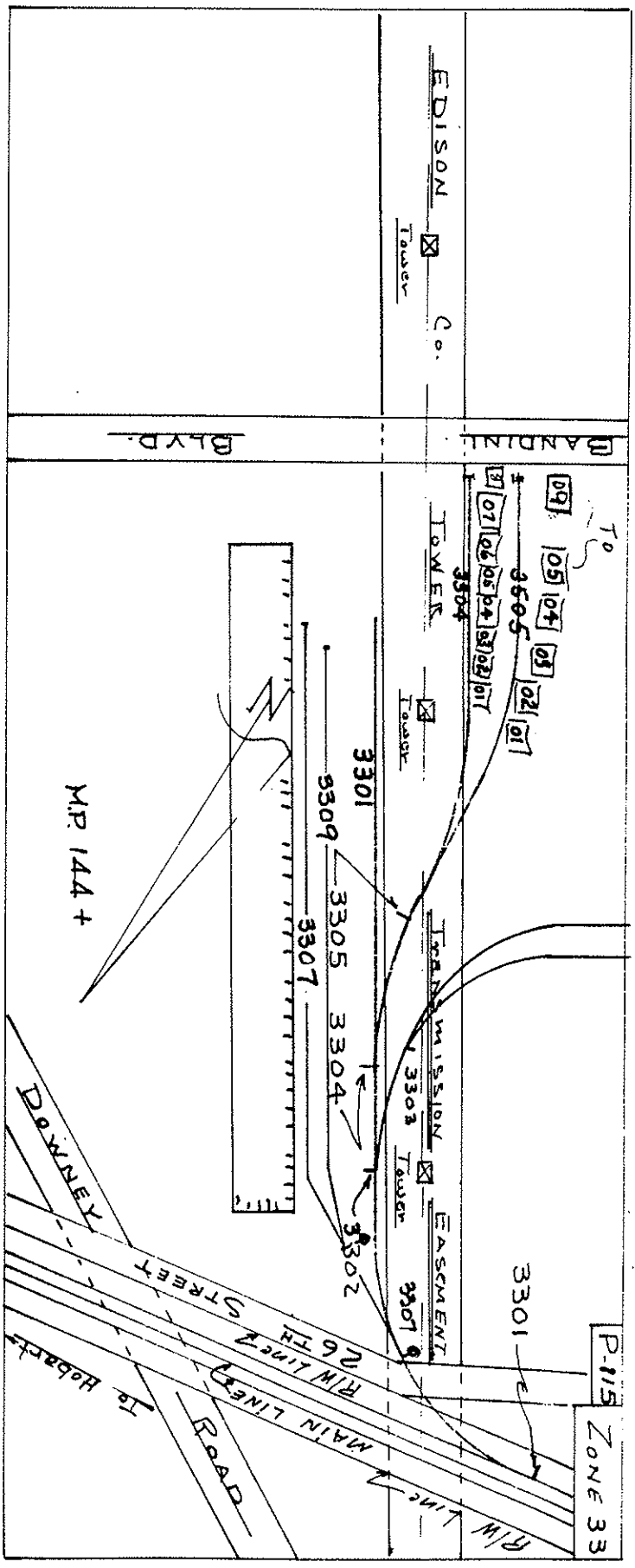

601-34362-11

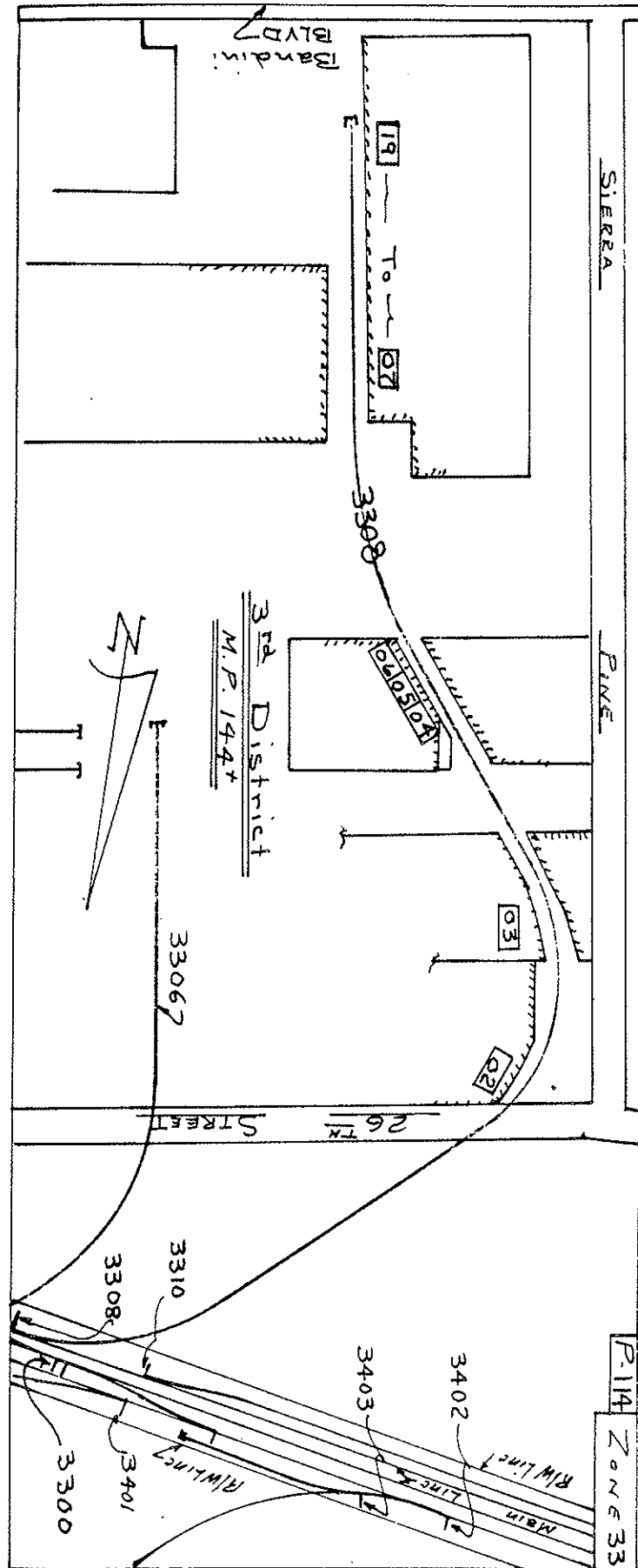
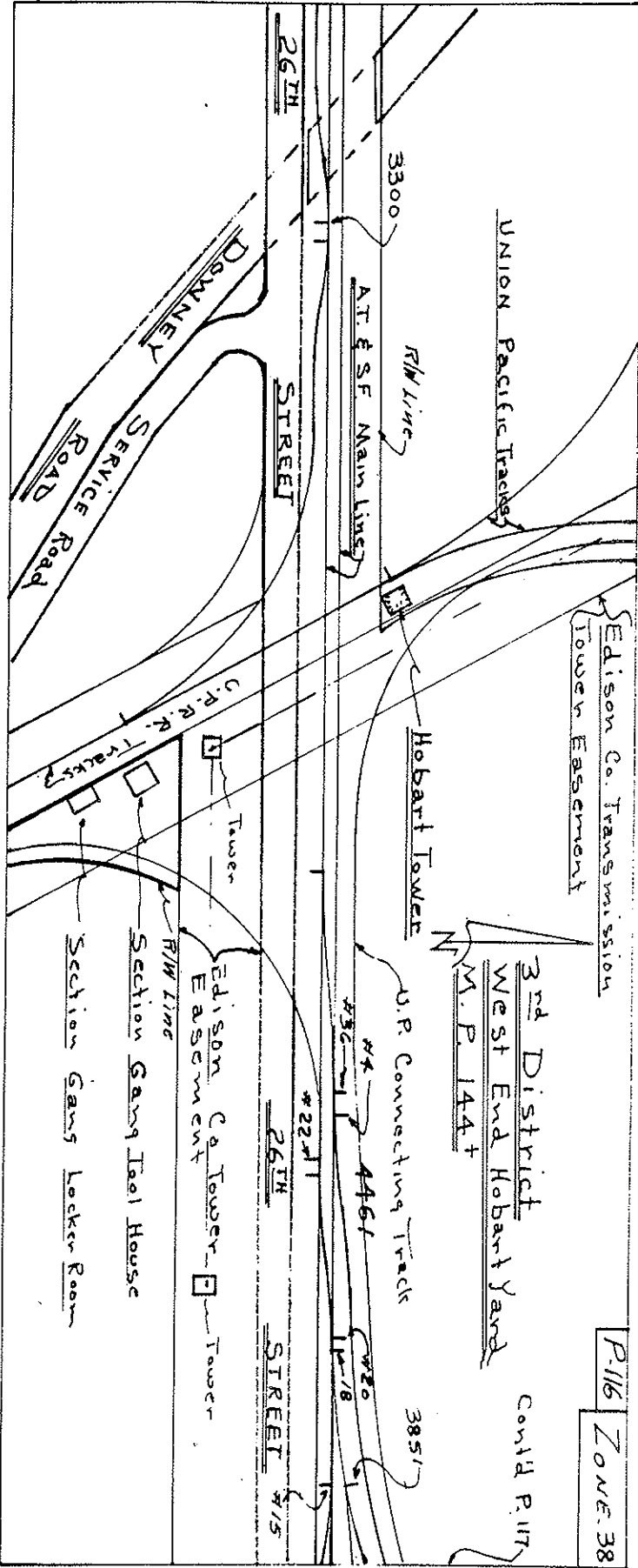



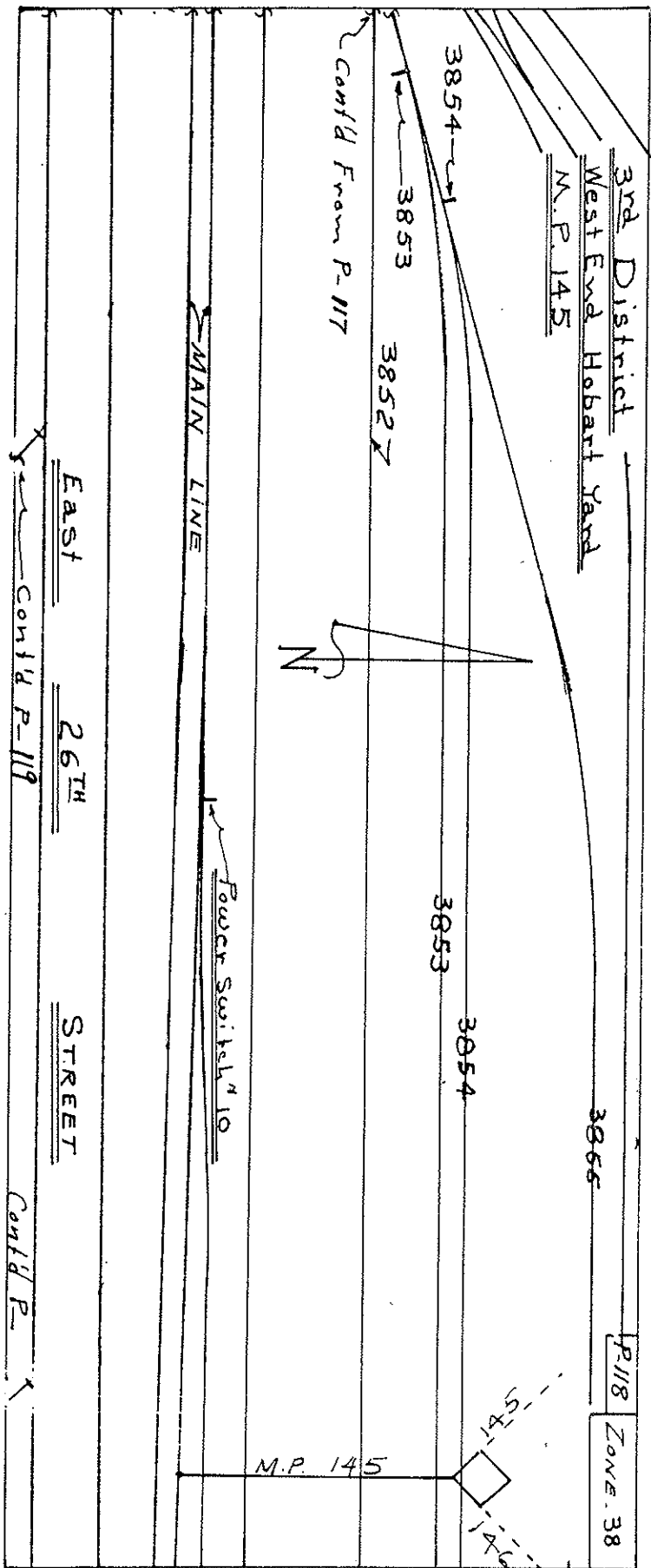
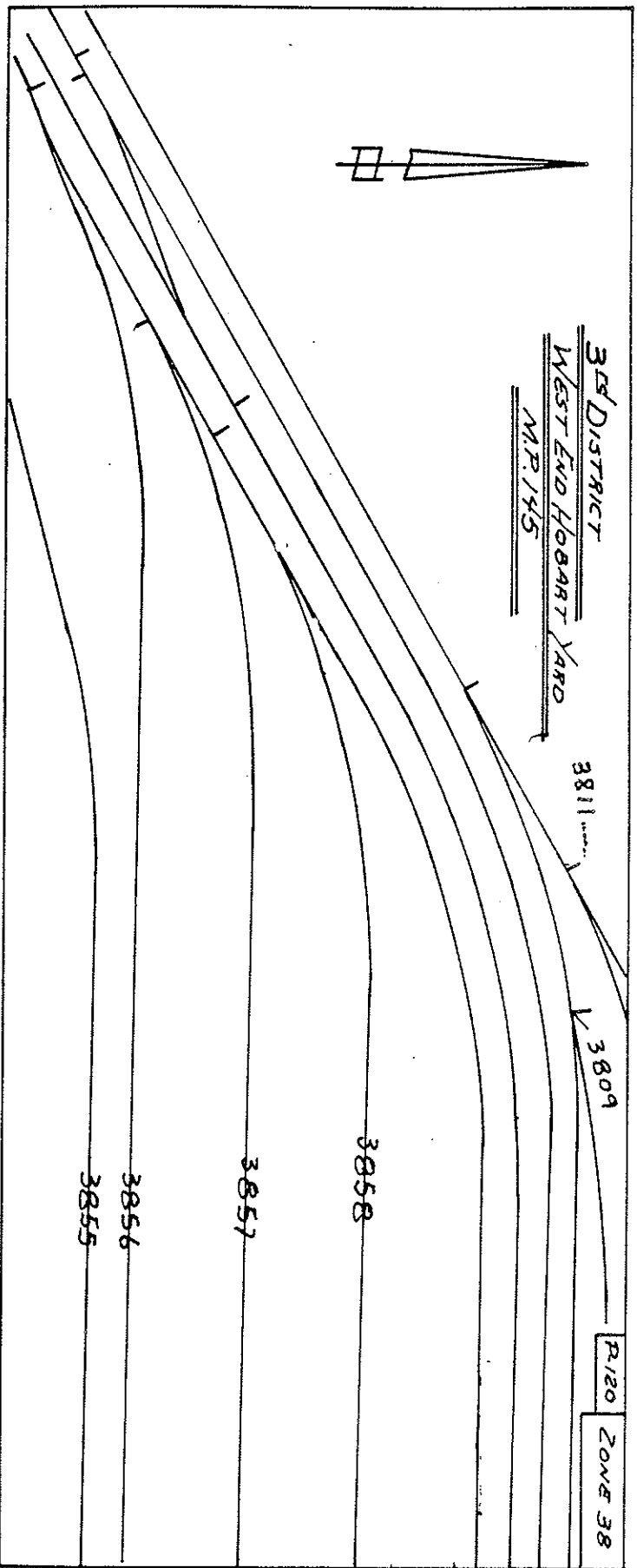

601-34362-12

601-34362-15

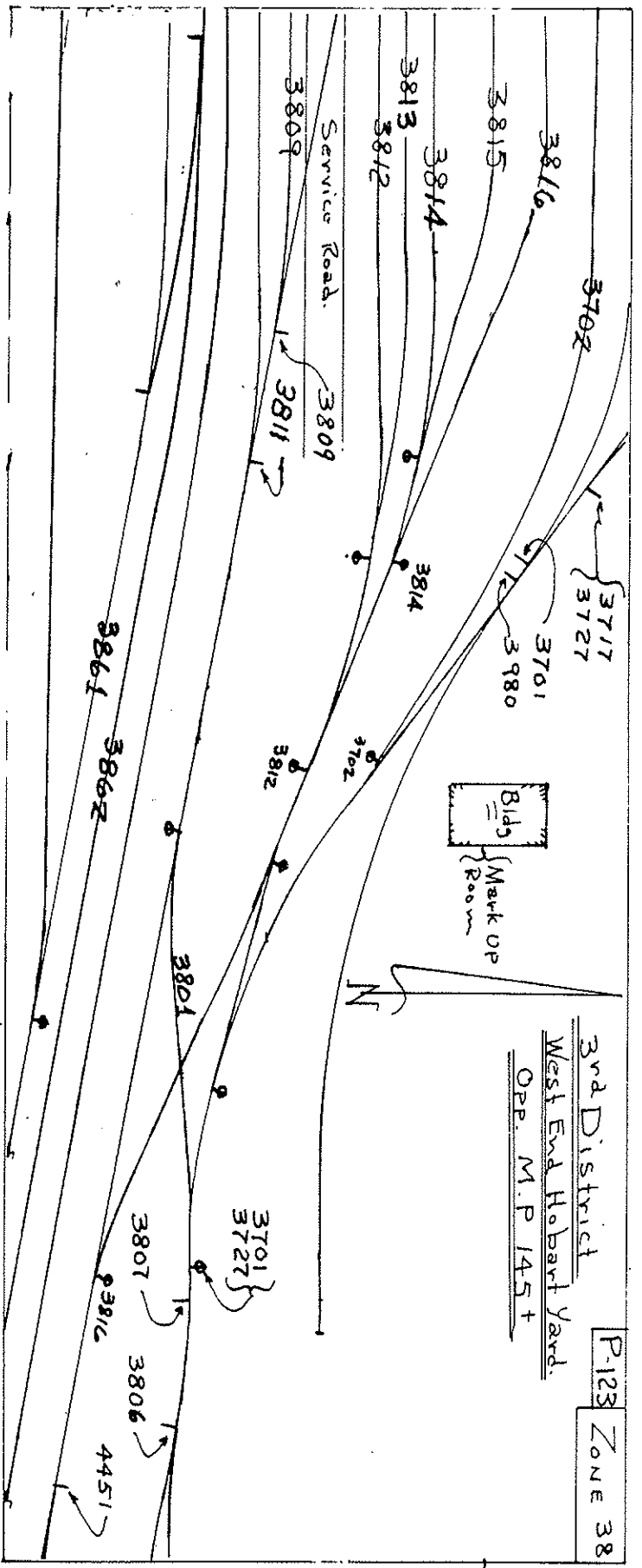

P-123 ZONE 38

3rd District  
West End Hobart Yard  
OPP. M.P. 145 +

Bldg  
Mark UP  
Room

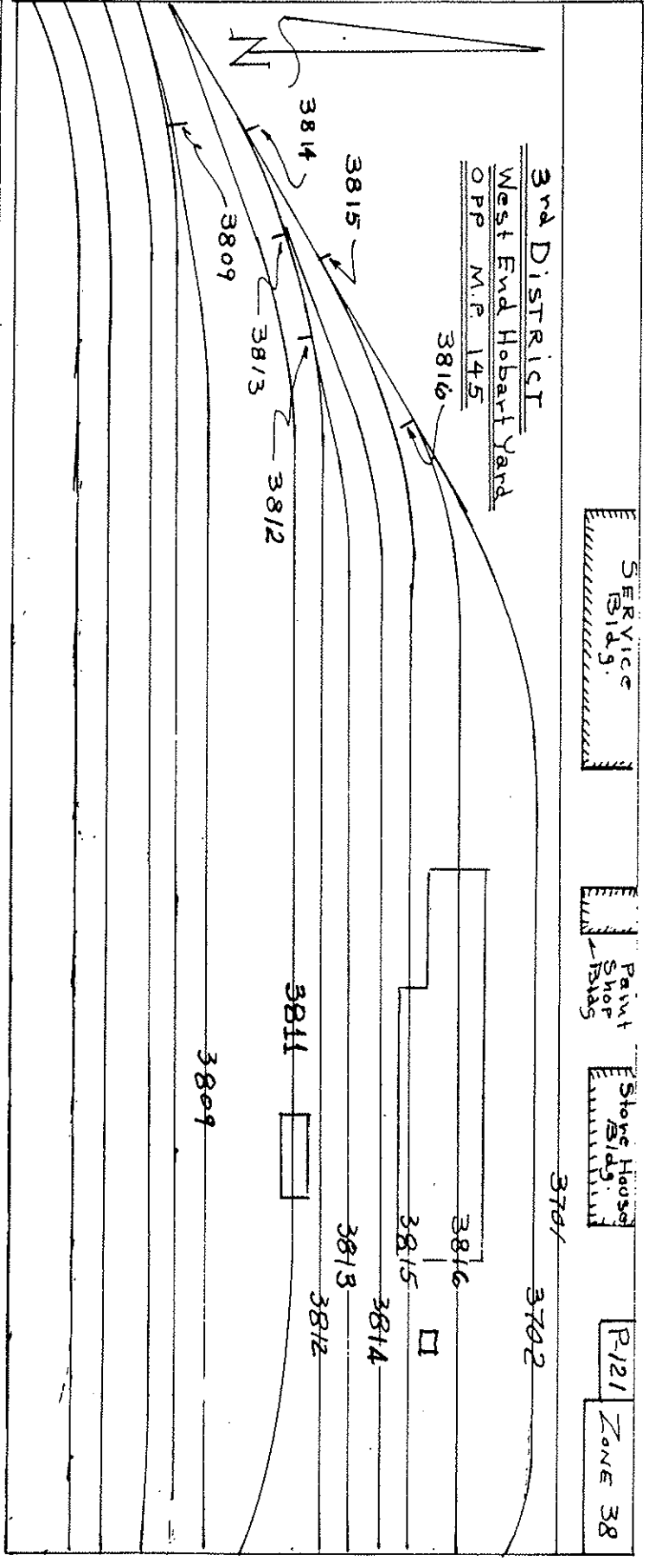

P-121 ZONE 38

3rd District  
West End Hobart Yard  
OPP. M.P. 145

Service Sidg.

Paint Shop

Stone House





P-122 ZONE 38

3859

3858

3857

3856

3855

3854

3853

3852

MP 145

3RD DISTRICT  
WEST END HOBART YARD  
M.P. 145

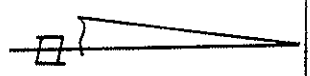

601-34362-1A

P-124 ZONE 38

3RD DISTRICT  
WEST END HOBART YARD  
OPP M.P. 145+

34451

3861

3862

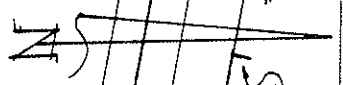

3356

3355

3854

3853

601-34362-17

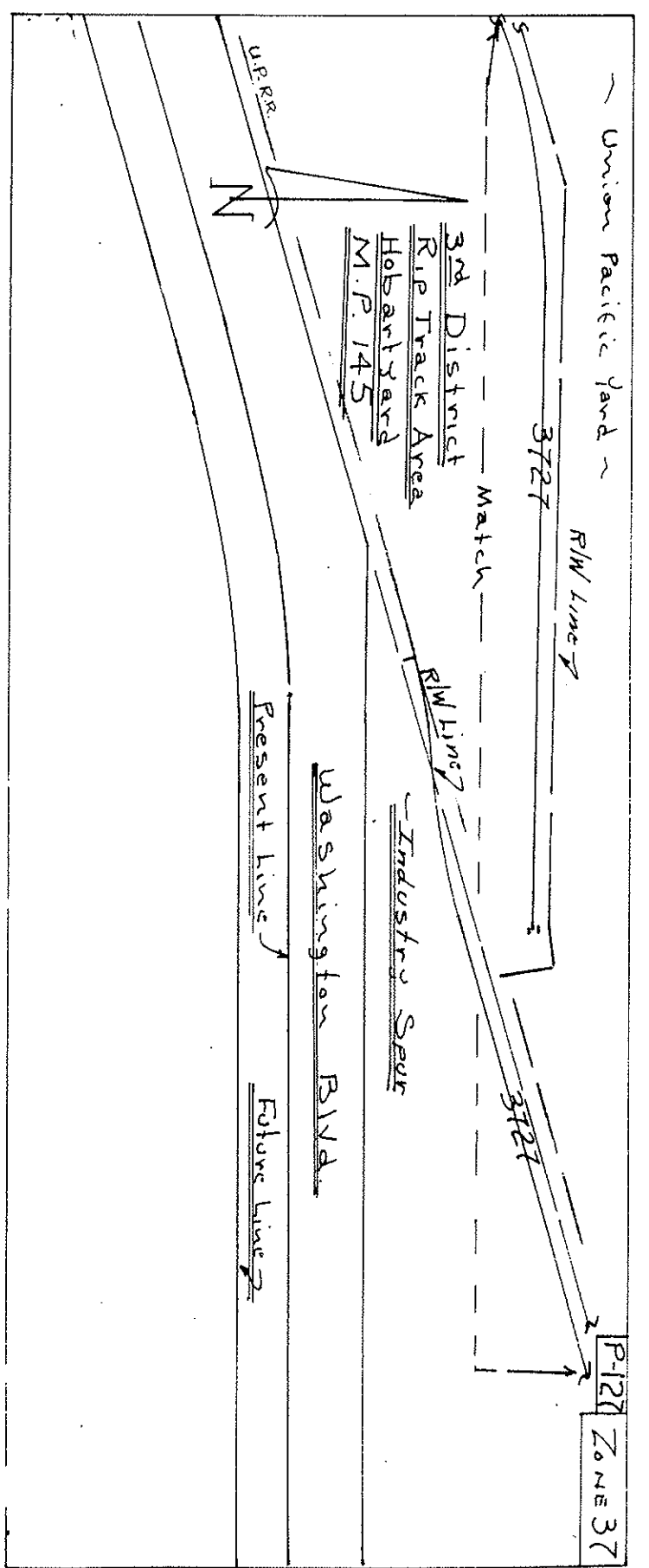
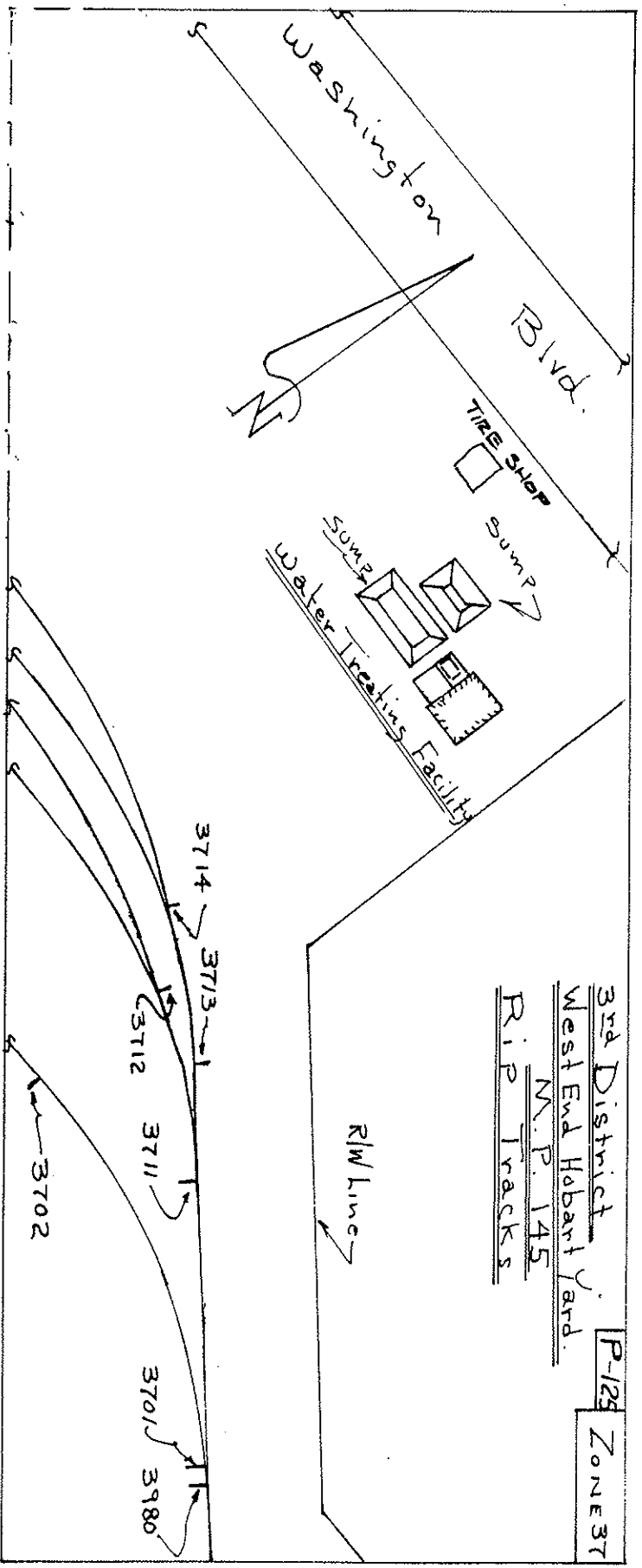

Cont'd P-

P126 ZONE 37

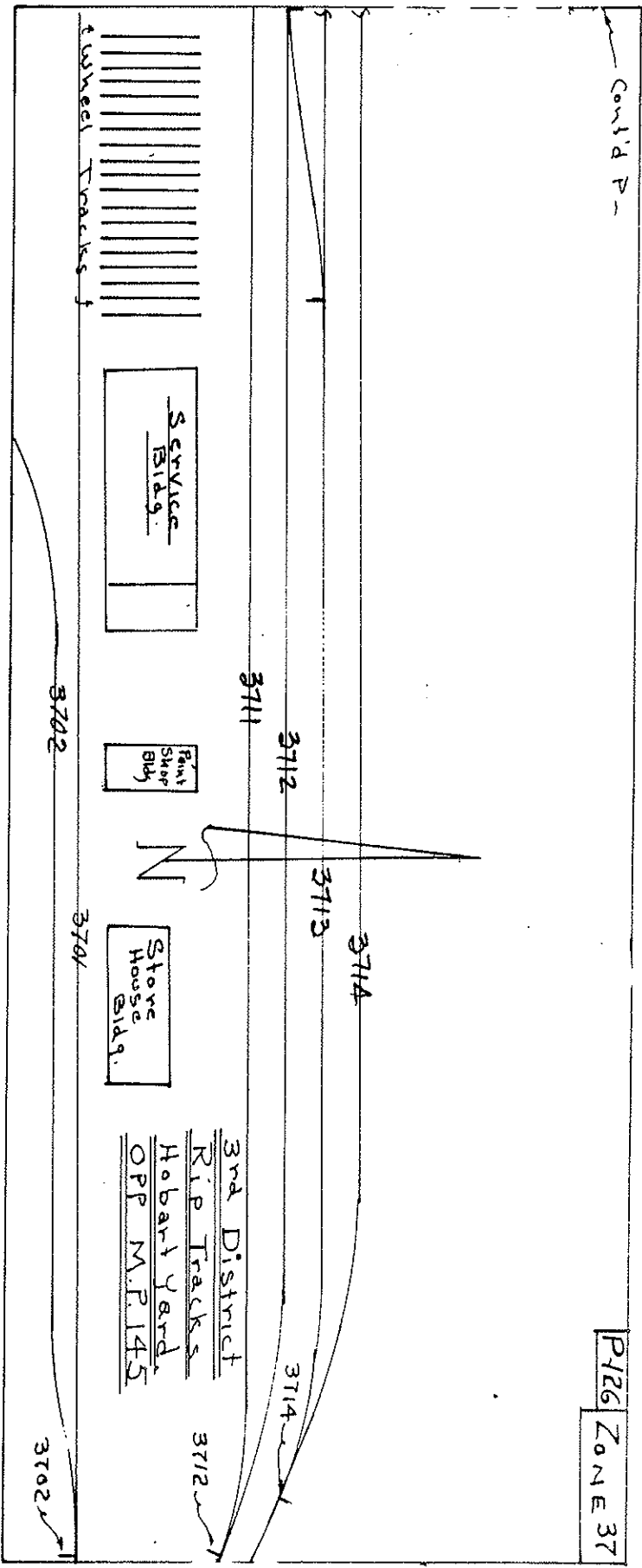

601-34862-10

P128 ZONE 37

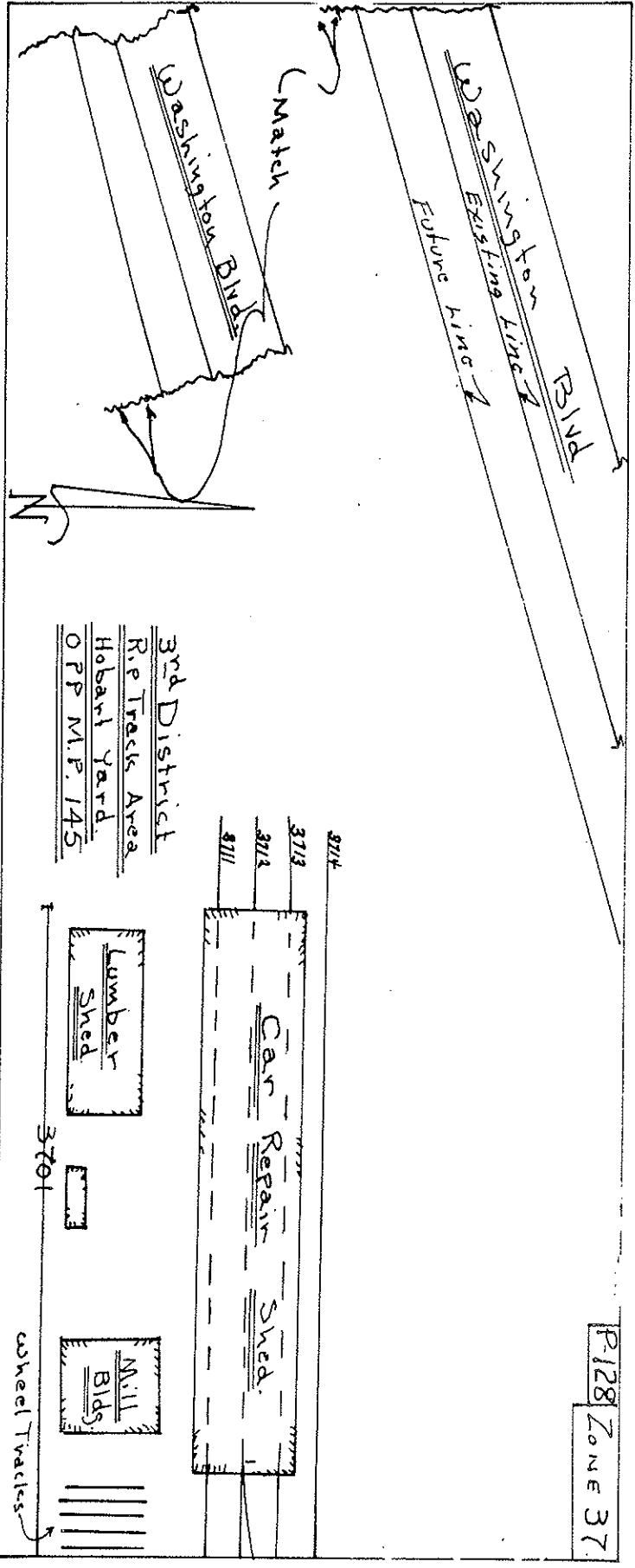

4401  
4411

P131  
Zone 38

3rd District  
Hobart Yard.  
M.P. 1451

Main Line  
4399  
4398

EAST  
26TH  
Street

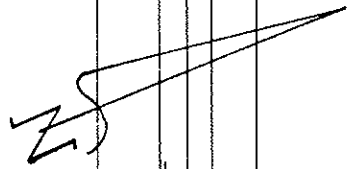

601-34362-19

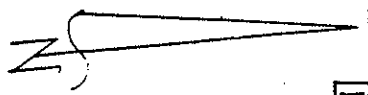

3rd District  
Hobart Yard.  
M.P. 1451

P129  
Zone 38

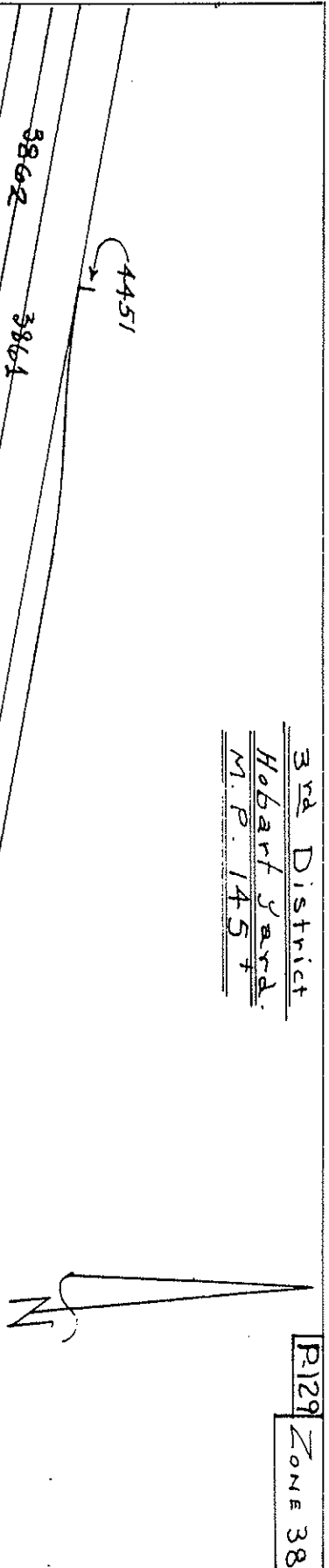

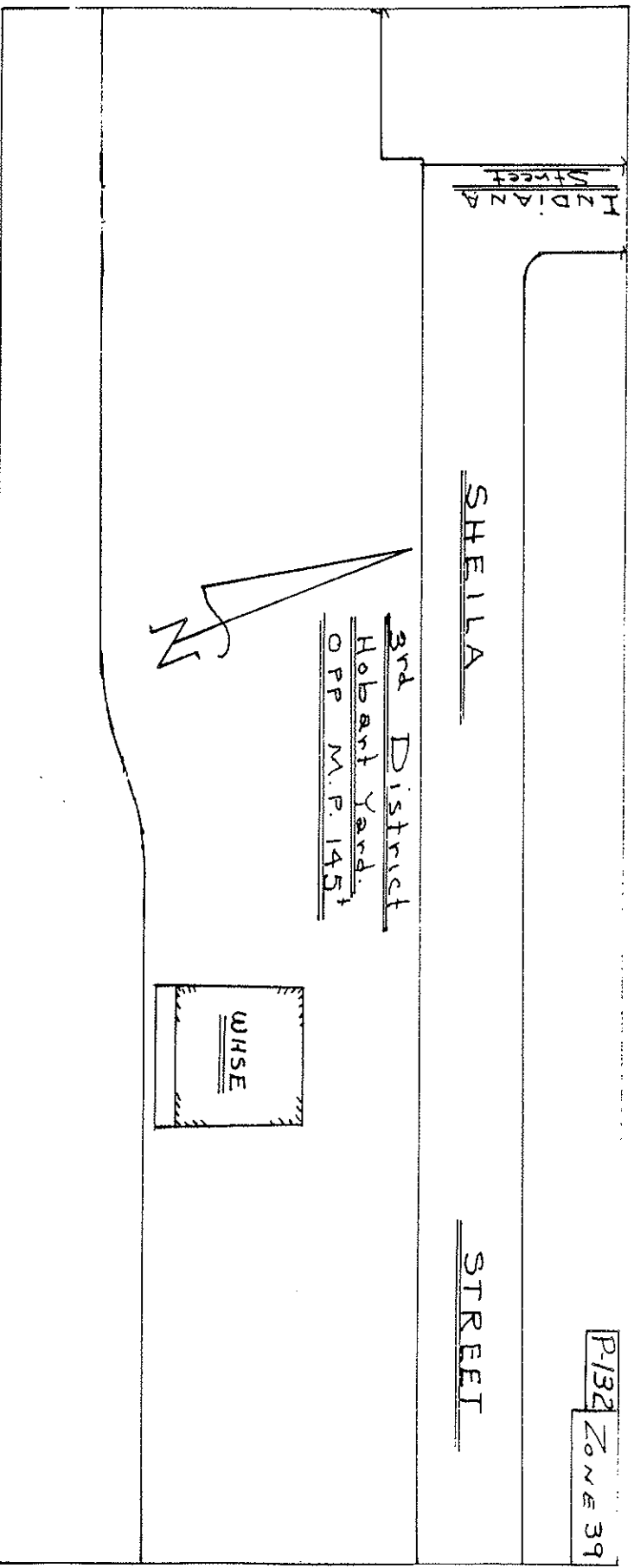
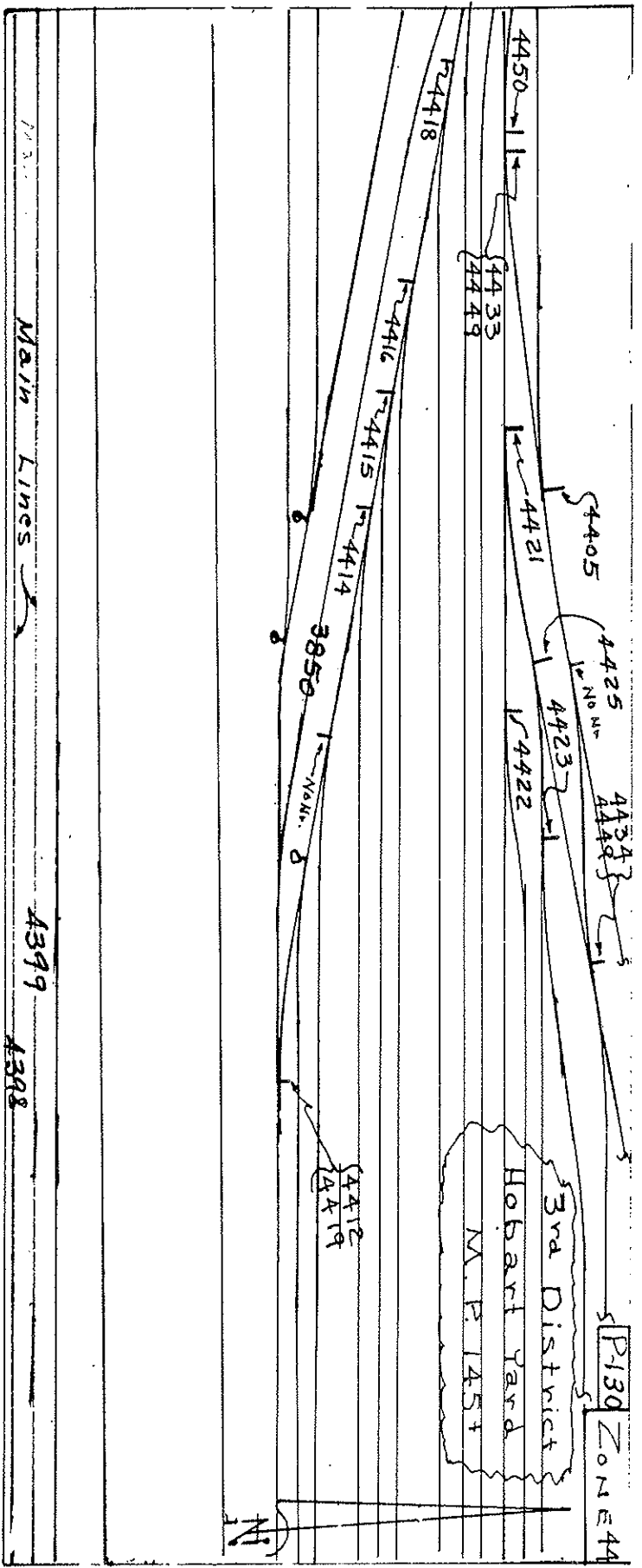



P/34 Zone 44

3rd District  
Hobart Yard  
M.P. 145+

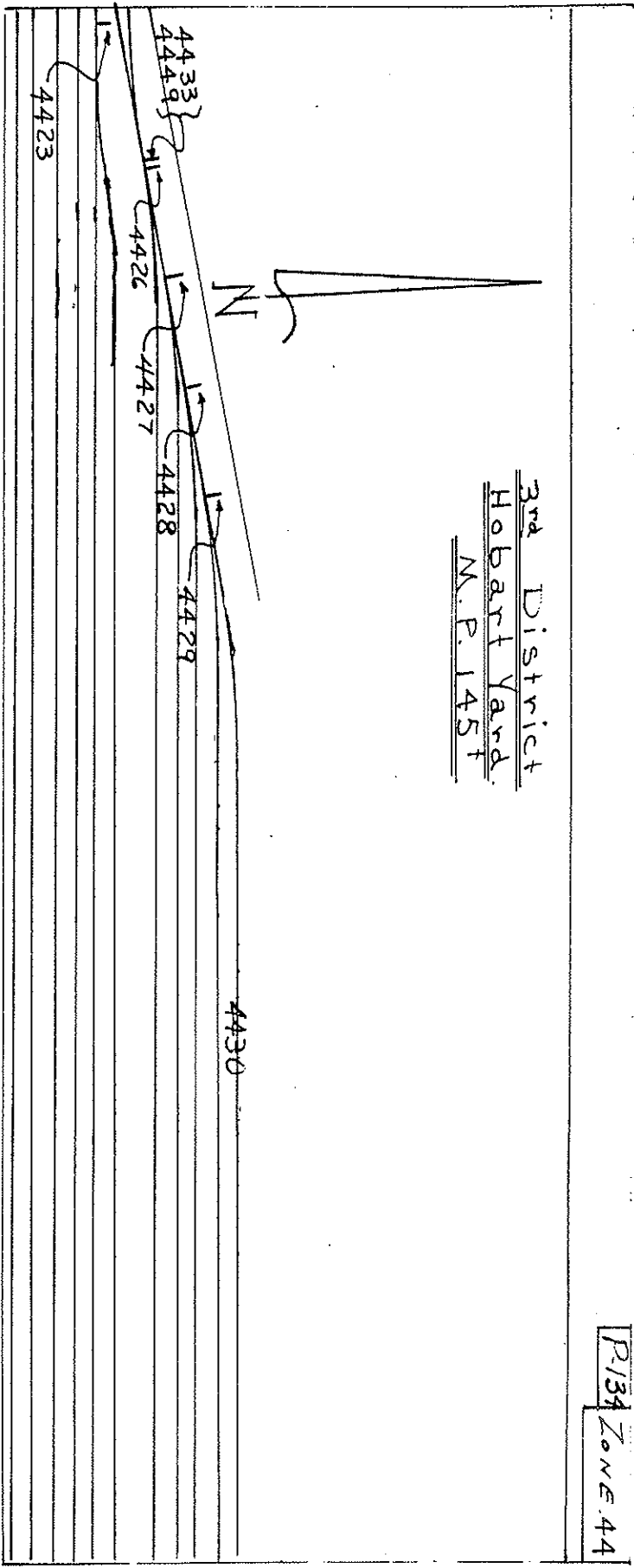

P/36 Zone 35

3rd District  
Hobart Yard  
Joint Union Pacific  
and AT&SF Ry Co.  
Industry Tracks  
OPP M.P. 145+

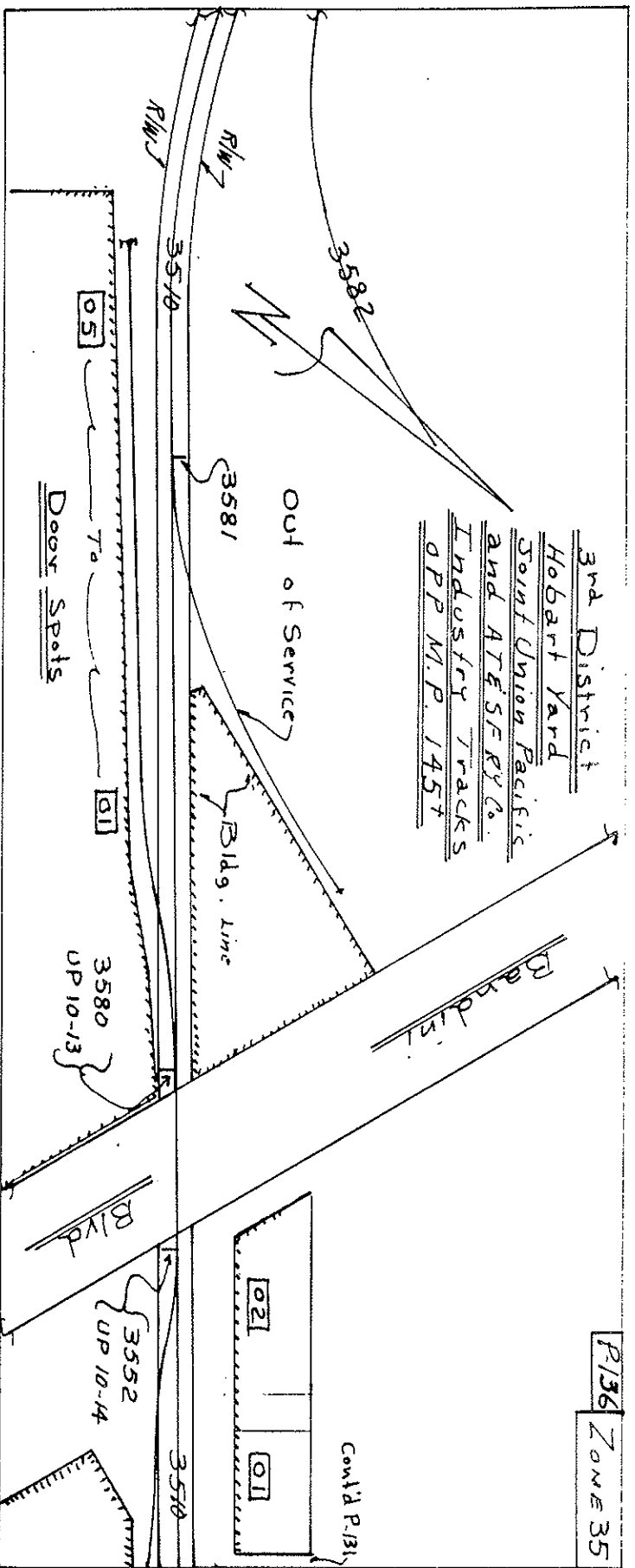

601-34362-20

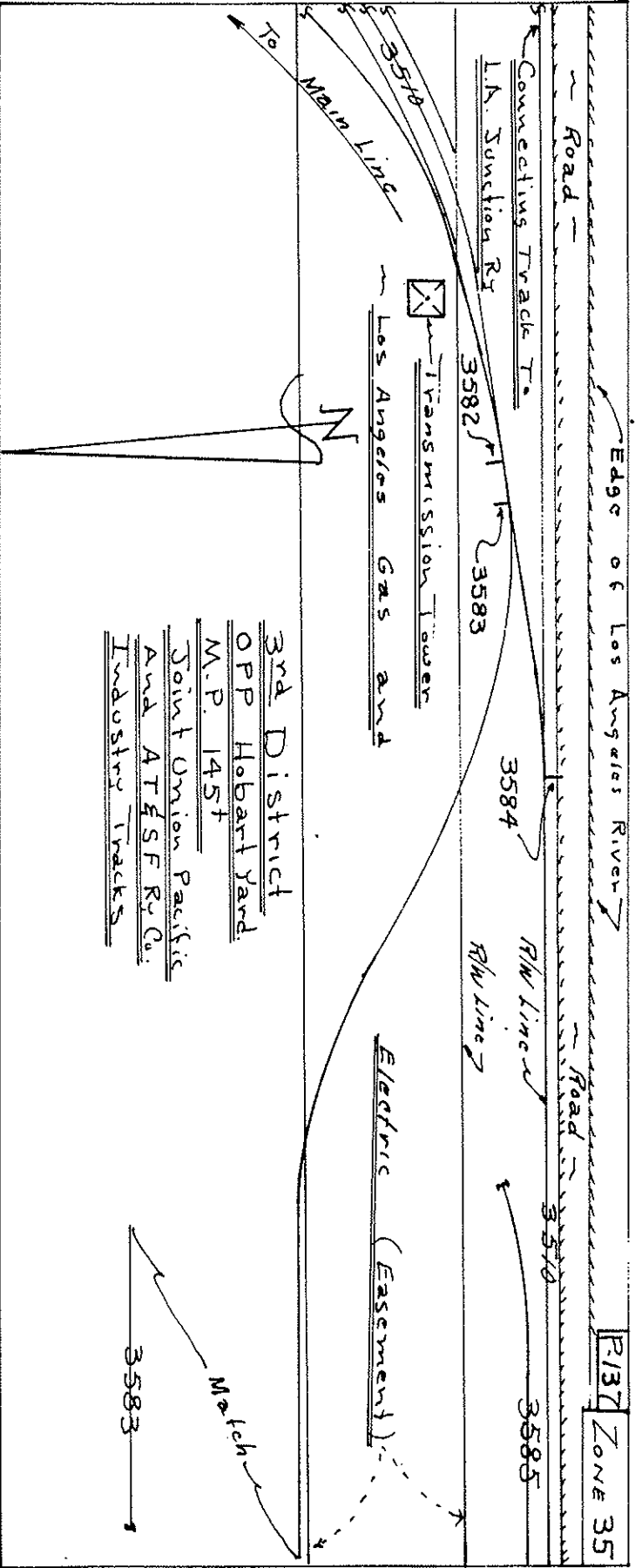
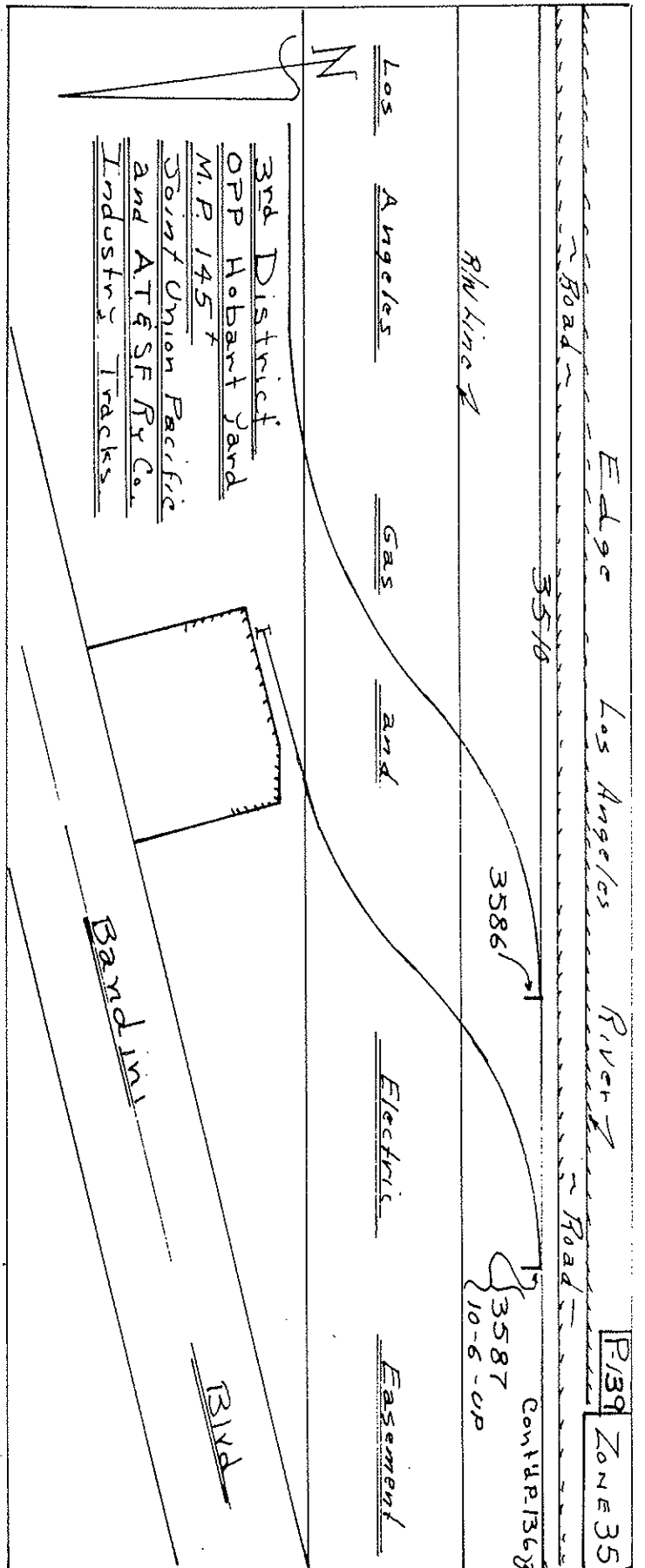



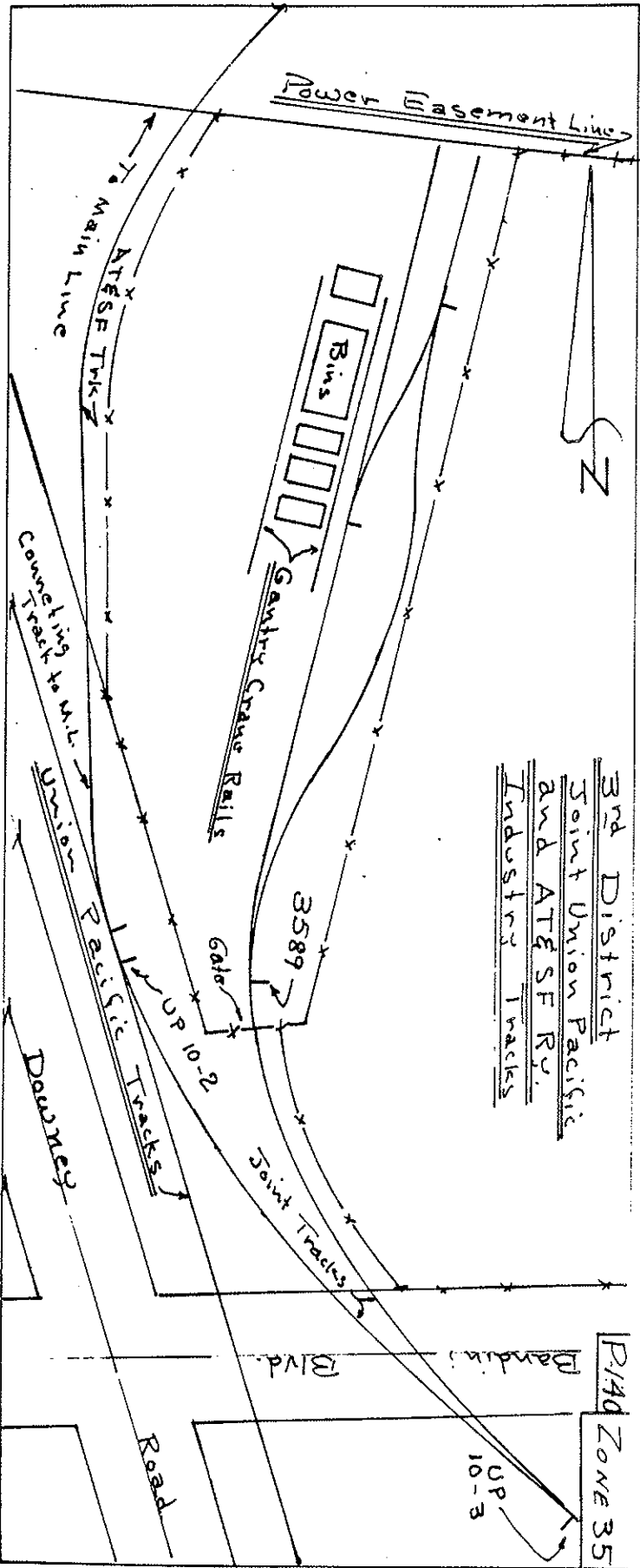
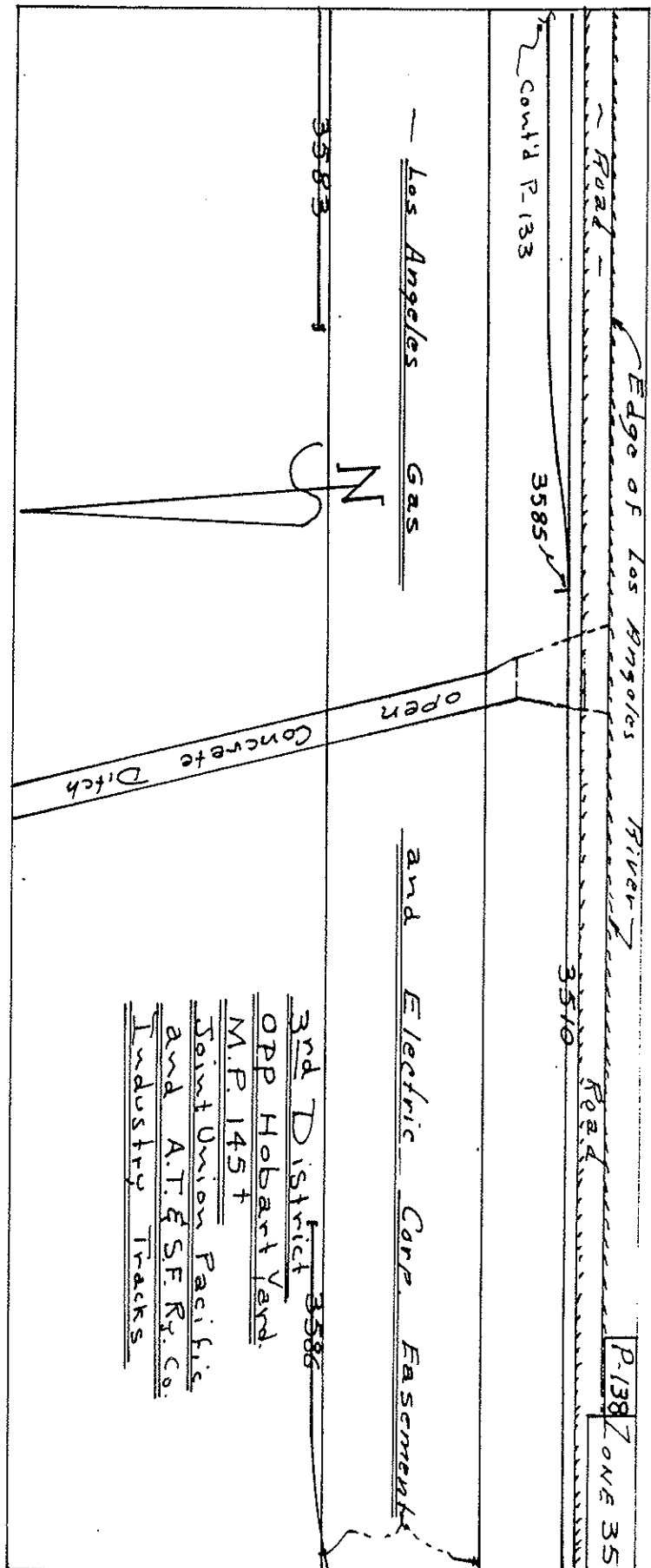

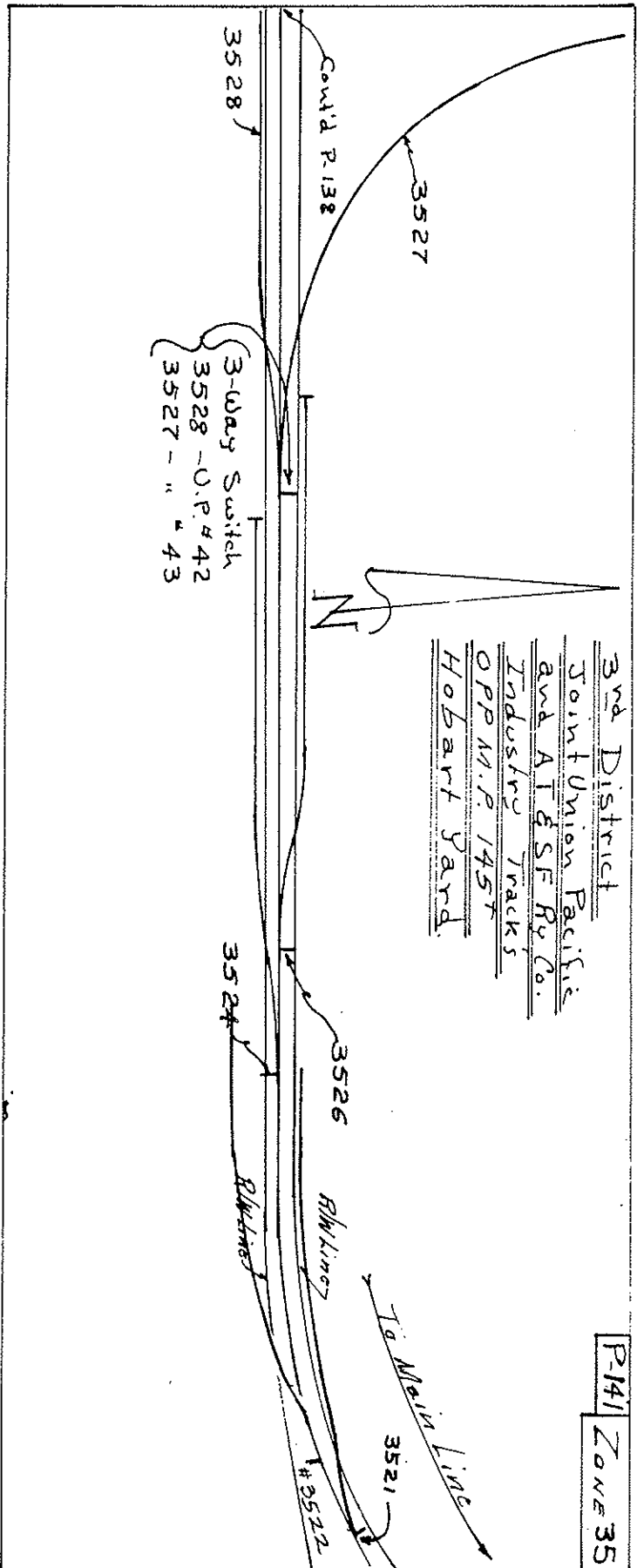
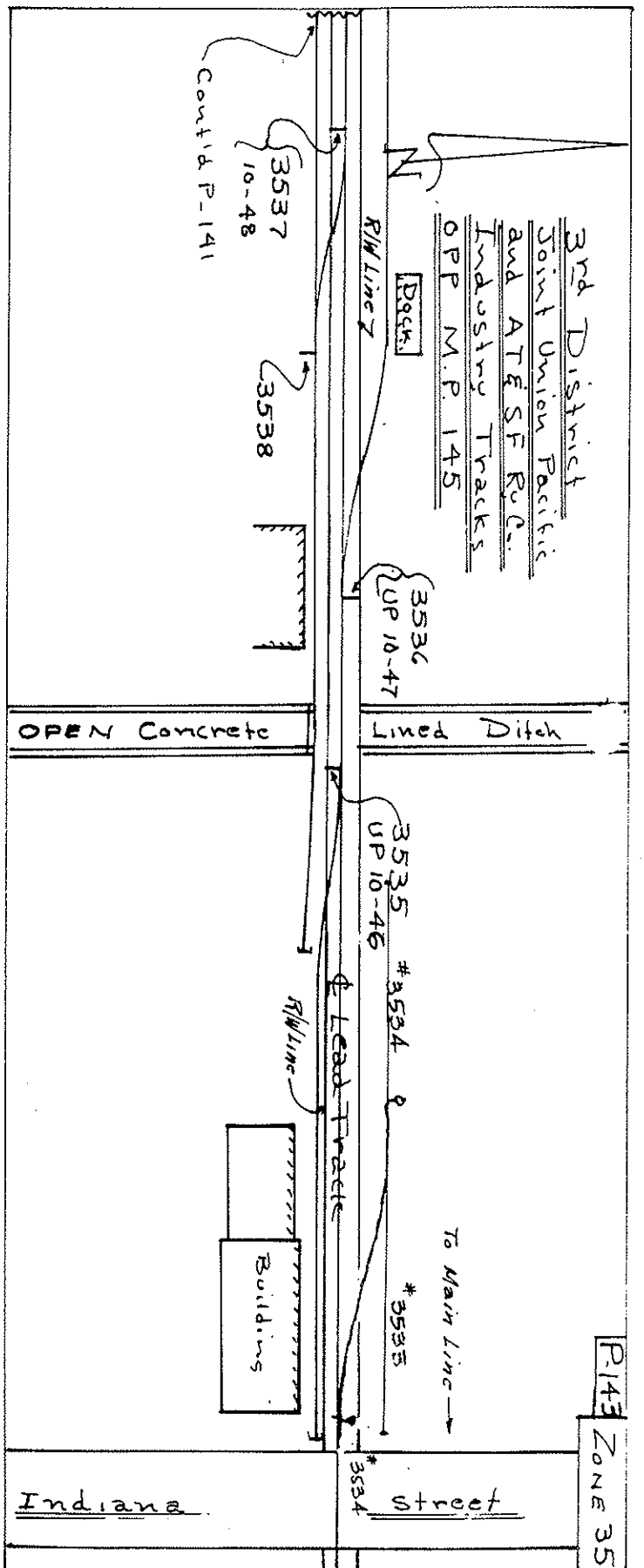

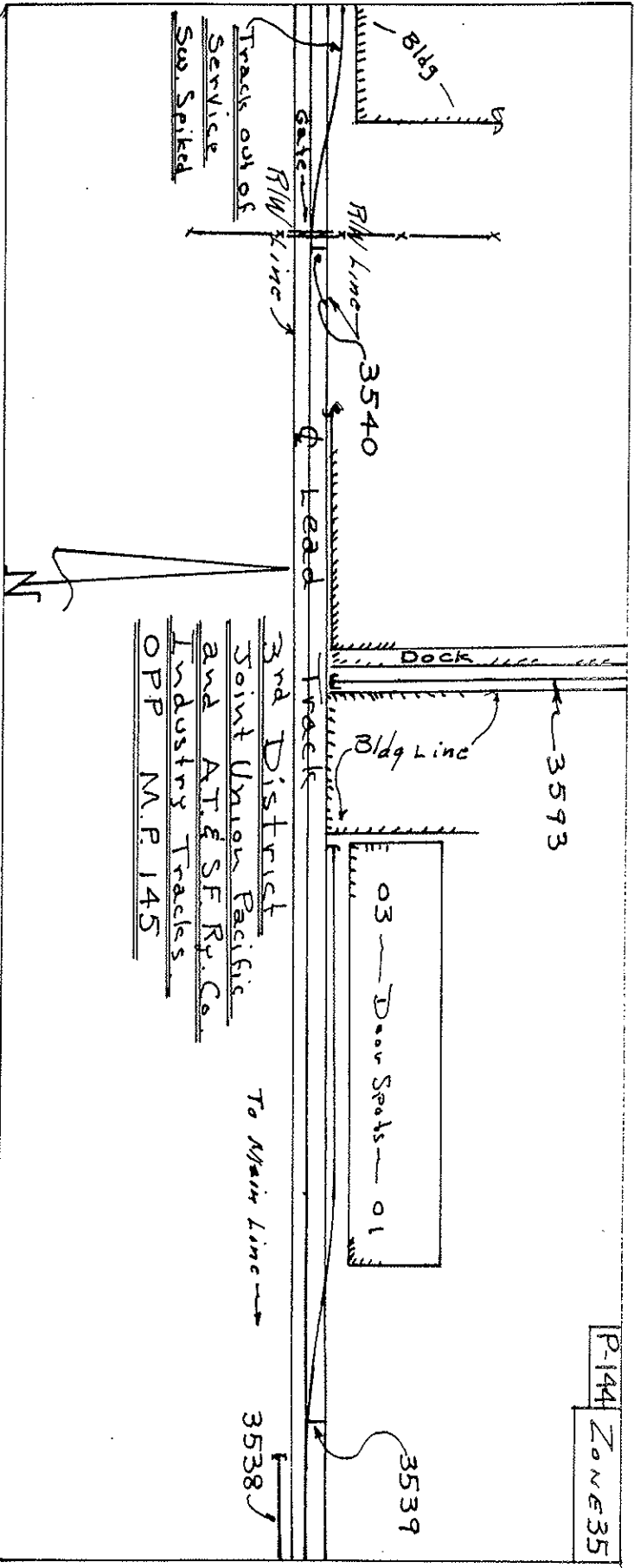

3rd District  
 Joint Union Pacific  
 and AT & SF Ry. Co.  
 Industry Tracks  
 O.P.P. N.P. 145

To Main Line

P-144  
 Zone 35

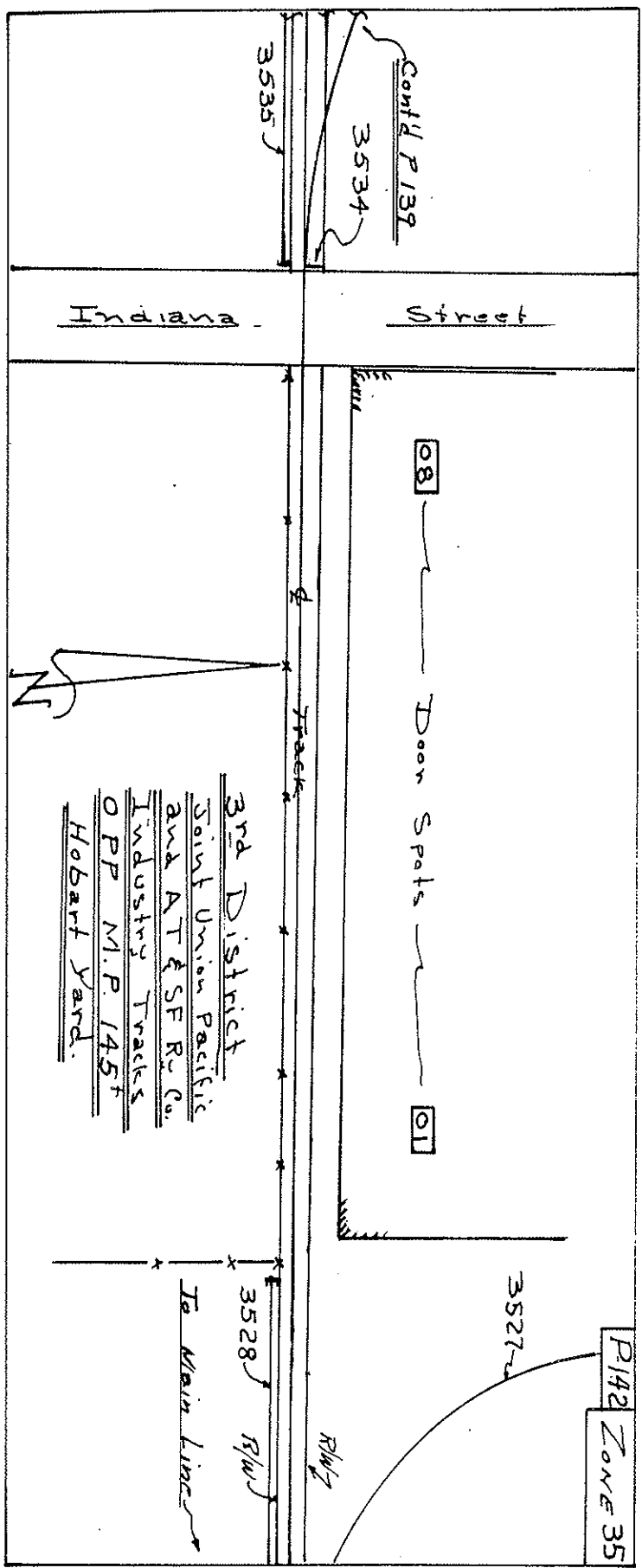

3rd District  
 Joint Union Pacific  
 and AT & SF Ry. Co.  
 Industry Tracks  
 O.P.P. N.P. 145  
 Hobart Yard.

To Main Line

P-142  
 Zone 35

601-34362-27

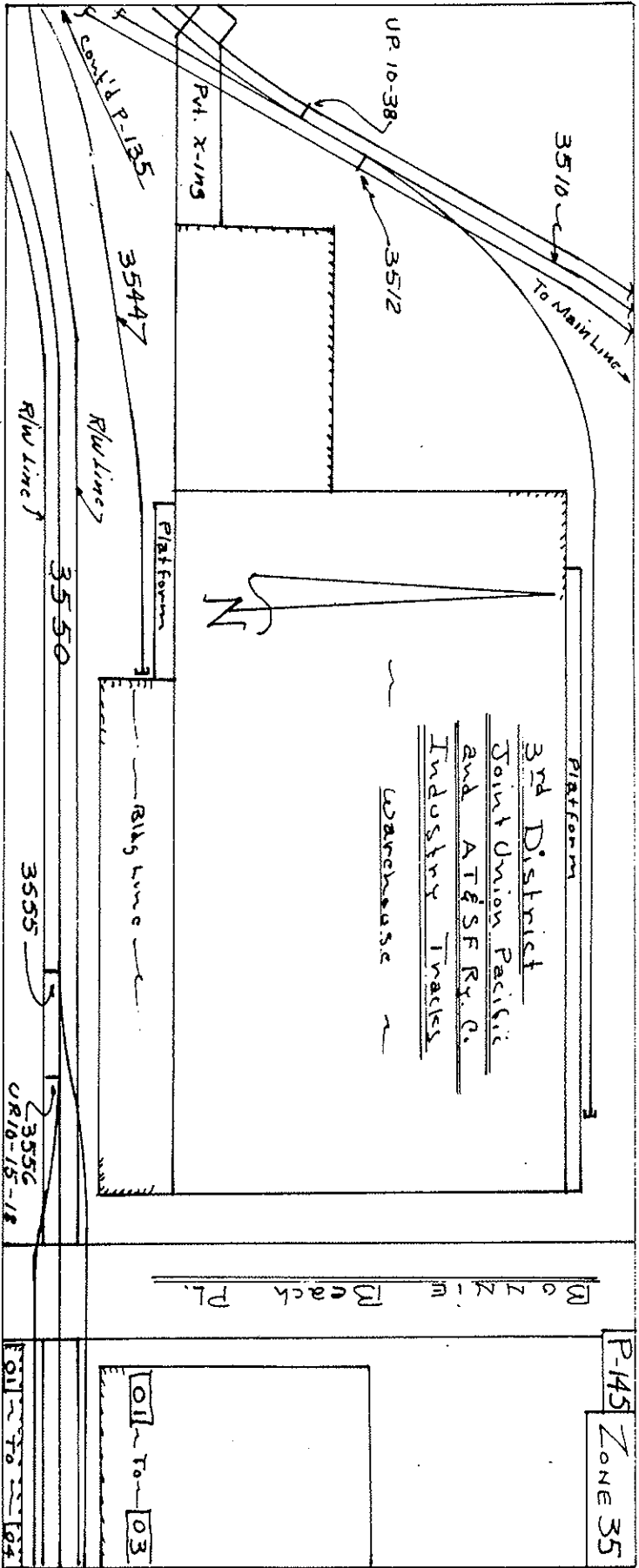

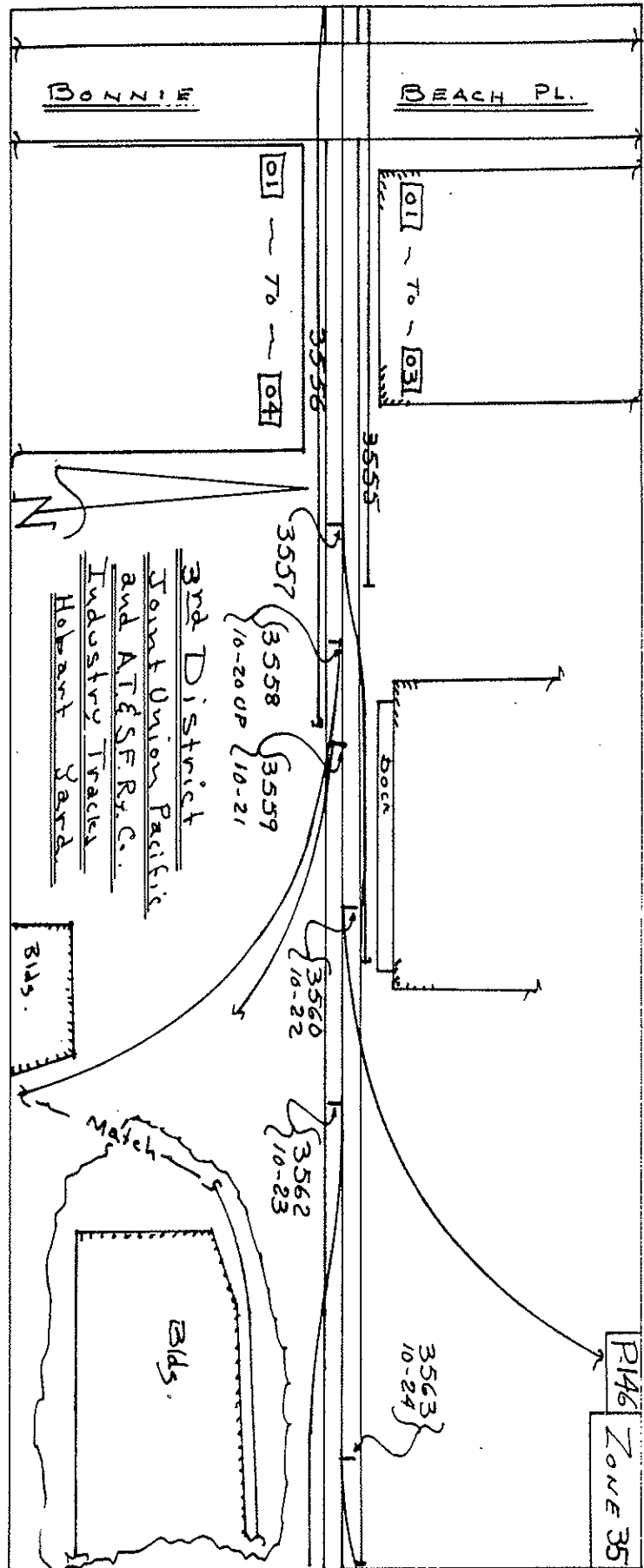
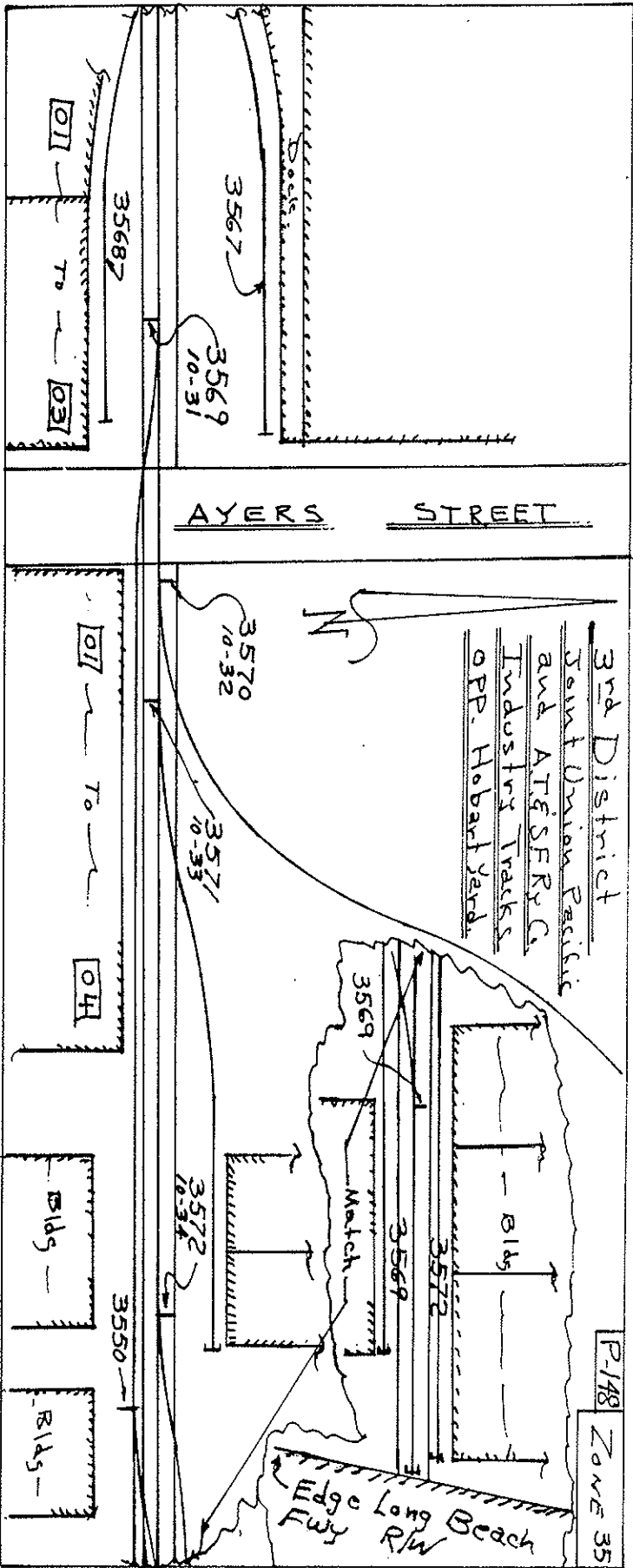

P-151 ZONE 39

WASHINGTON STREET

BIVD.

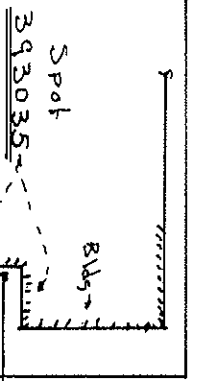

INDIANA STREET

SHELLA STREET

3938 UP 16-17

3930

3rd District  
 Joint Union Pacific  
 and A T & S F Ry Co.  
 Industry Tracks  
 Hobart Yard

3937 UP 16-16

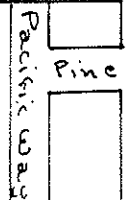

SHELLA STREET

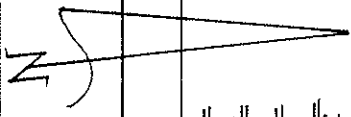

601-34362-29

P.149 ZONE 44

SHELLA STREET

SHELLA STREET

Connecting Track  
 To Union Pacific Yards

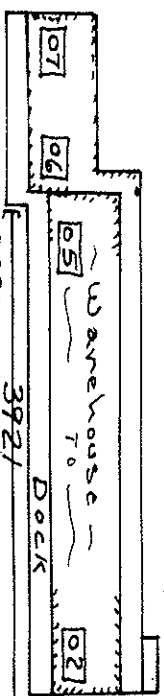

3rd District  
 Hobart Yard  
 M. P. 146

4445

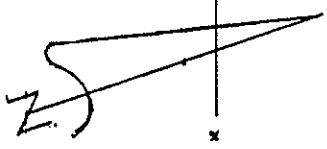

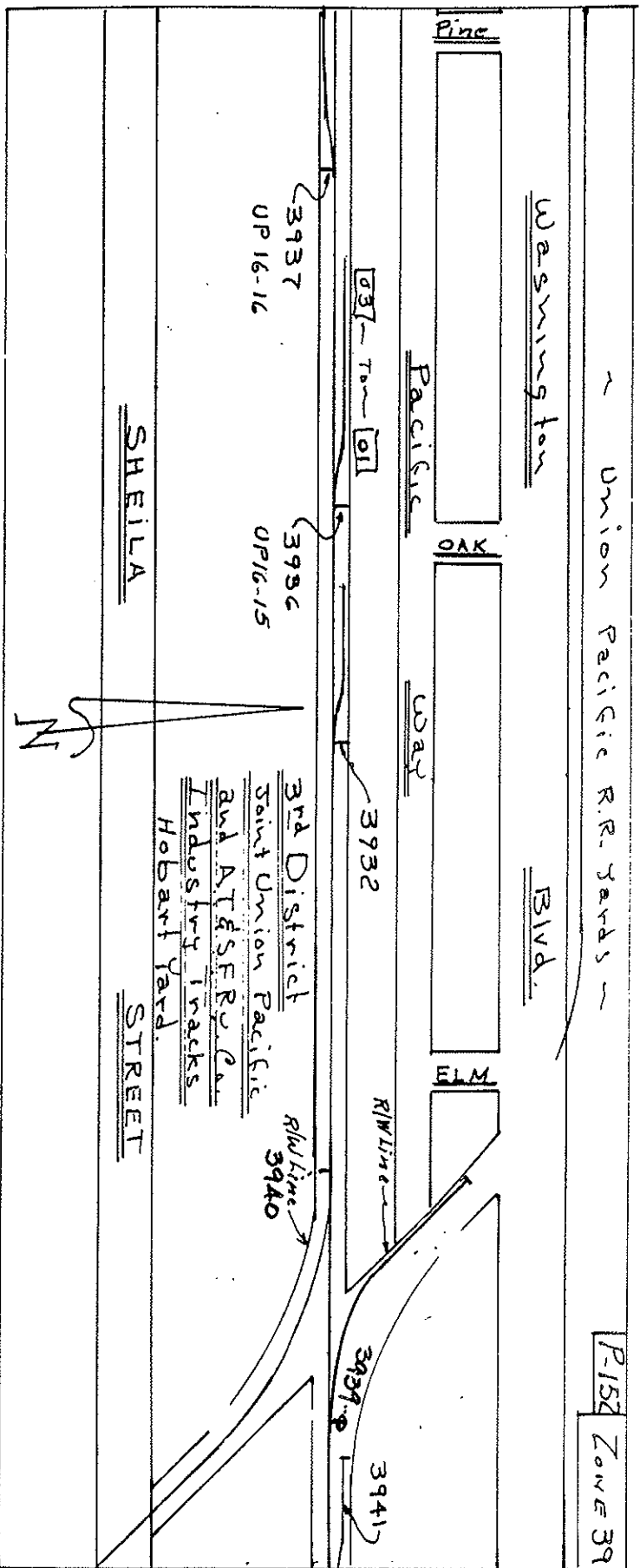
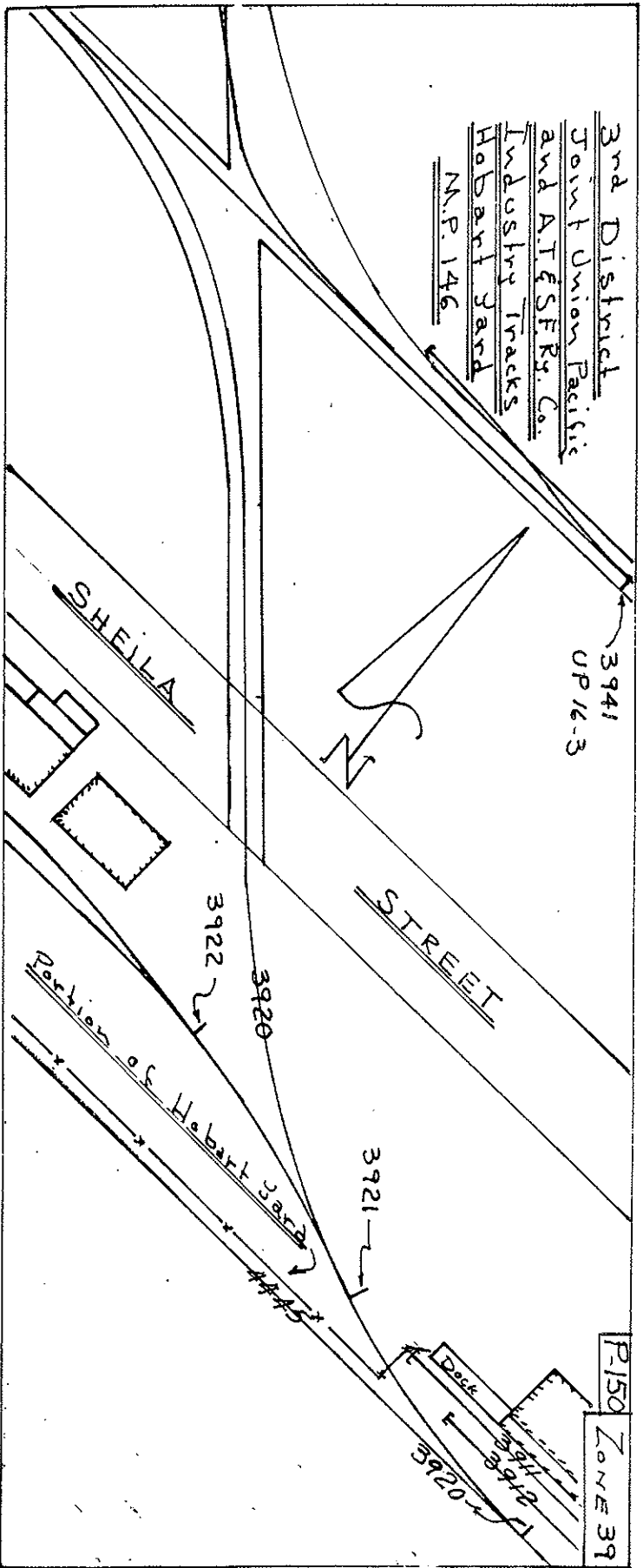

601-34362-28

Sheila

Arrowmill Ave

Street

3rd District  
Hobart Yard  
M.P. 146+

P-153 Zone 39

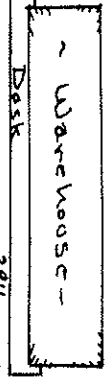

3920

3912

3912

3911

4445

Warehouse

3905  
3906

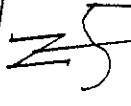

Washington

3rd District  
Joint Union Pacific  
and AT&SF R.R.C.

Blvd

P-153 Zone 39

3941  
UP 16-3

3942  
UP 16-4

3943  
UP 16-5

3940  
R/W Lines

3944  
UP 16-6

3945  
UP 16-7

out of Service  
3947

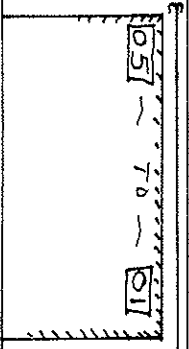

Arrowmill Ave

Industry Tracks  
Hobart Yard  
Pacific Way

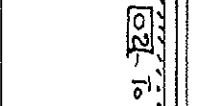

Ayers St

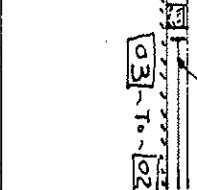

Sheila

Street

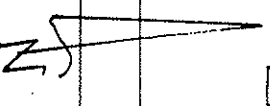

601-34362-31





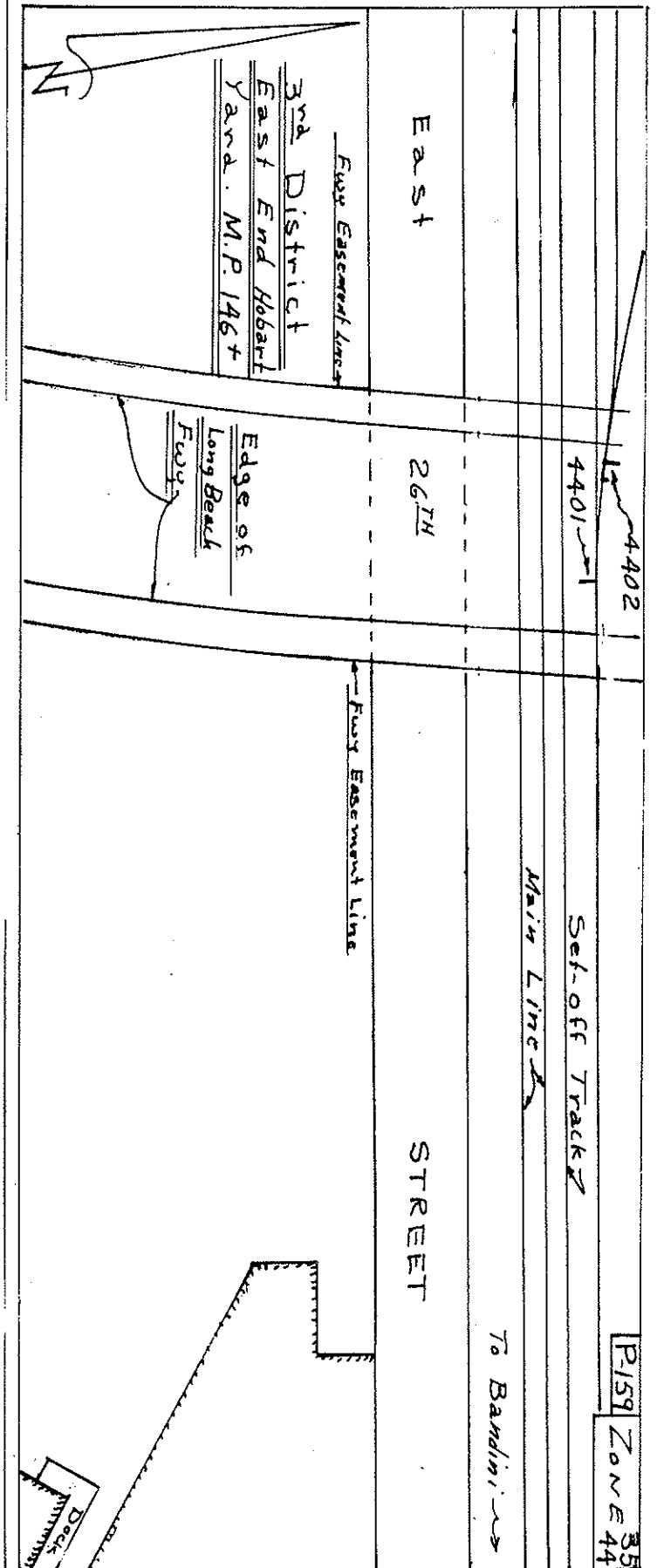

P-159 Zone 35

(3505-3506) (4401-4402)

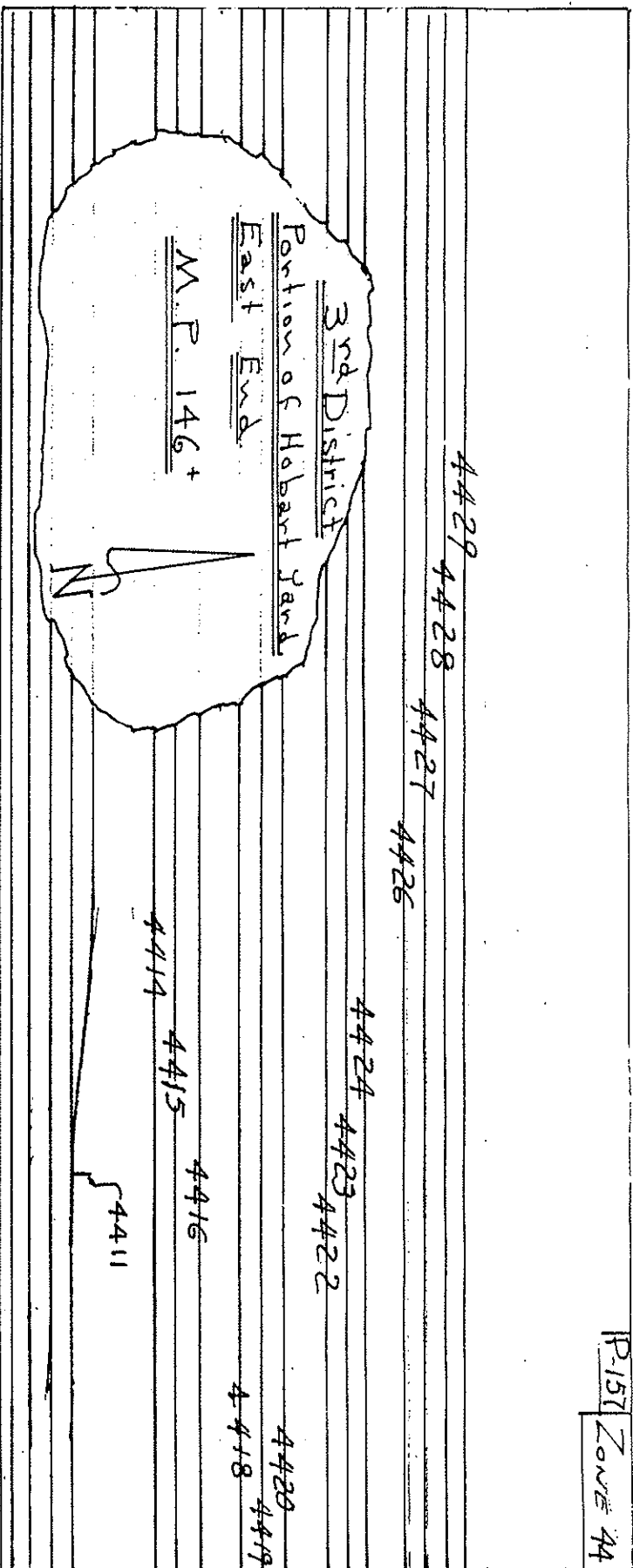

(4401 TO 4435)

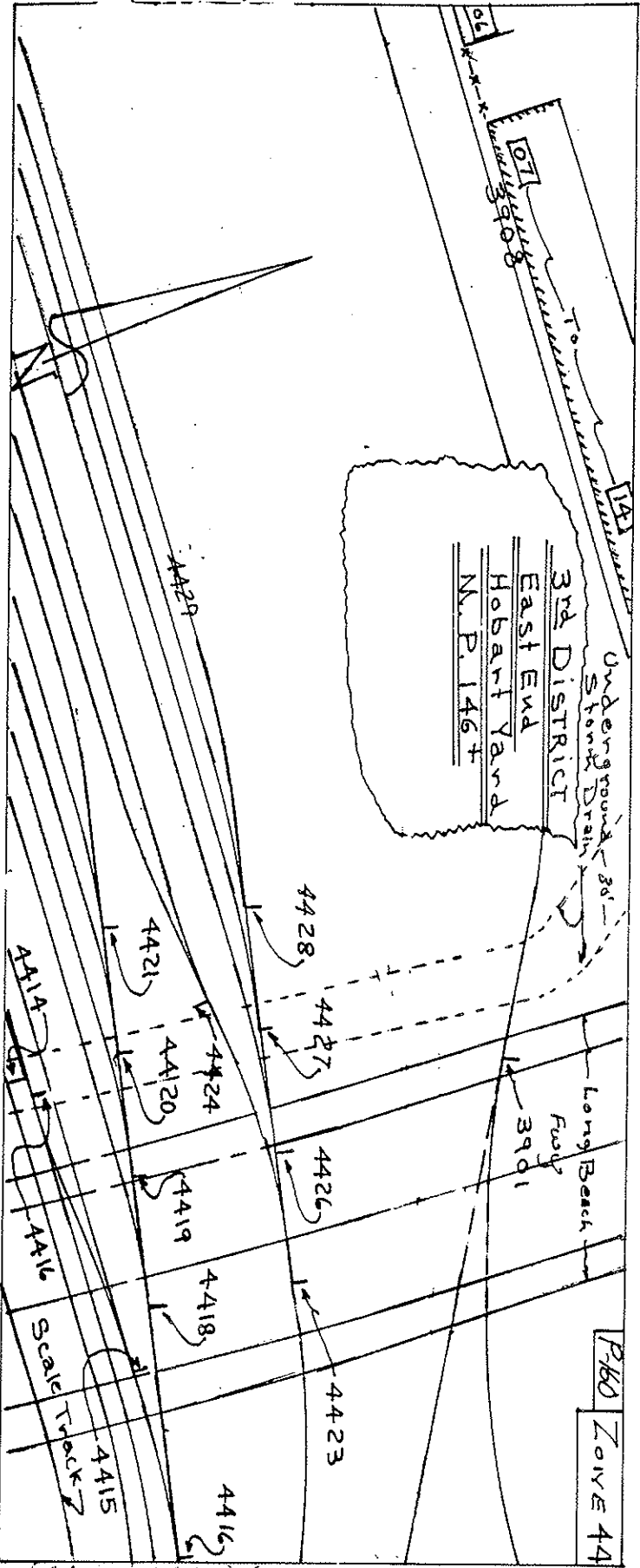
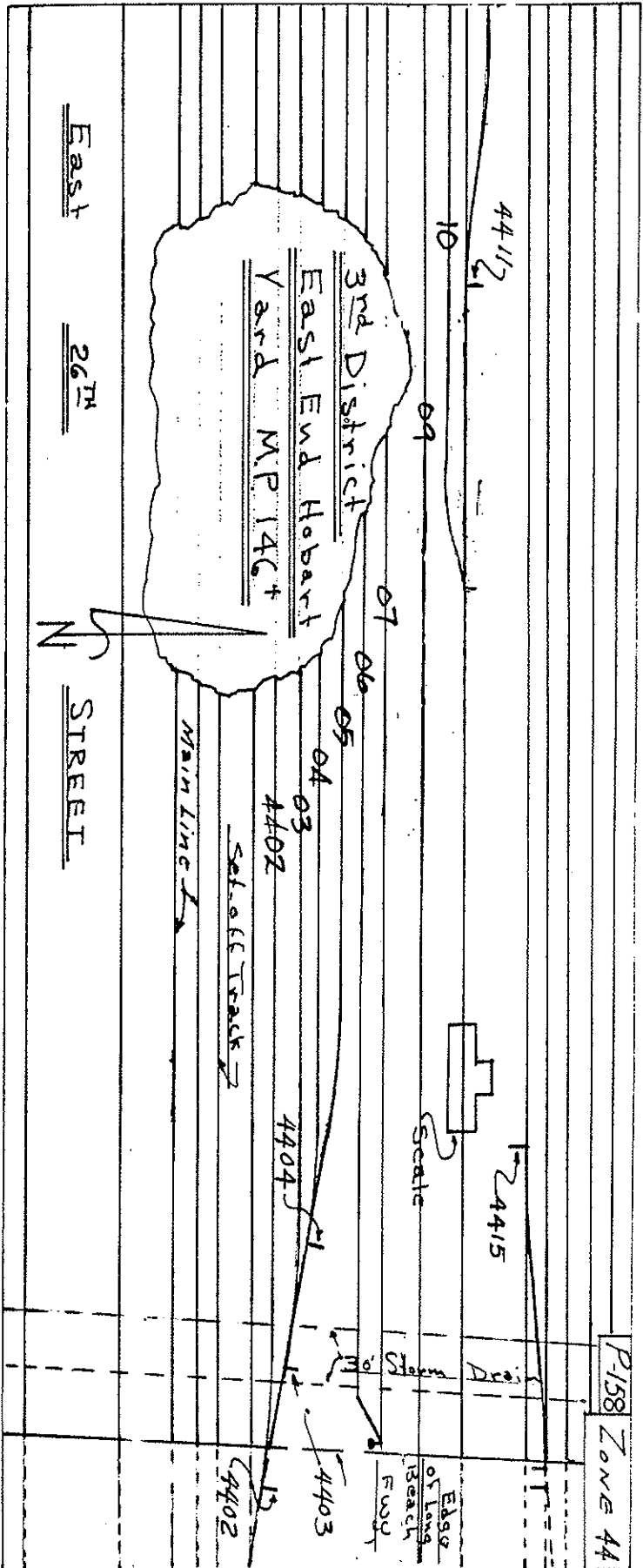

(4410 - 4440) (3900 - 3901 - 3903)

601-34302-35

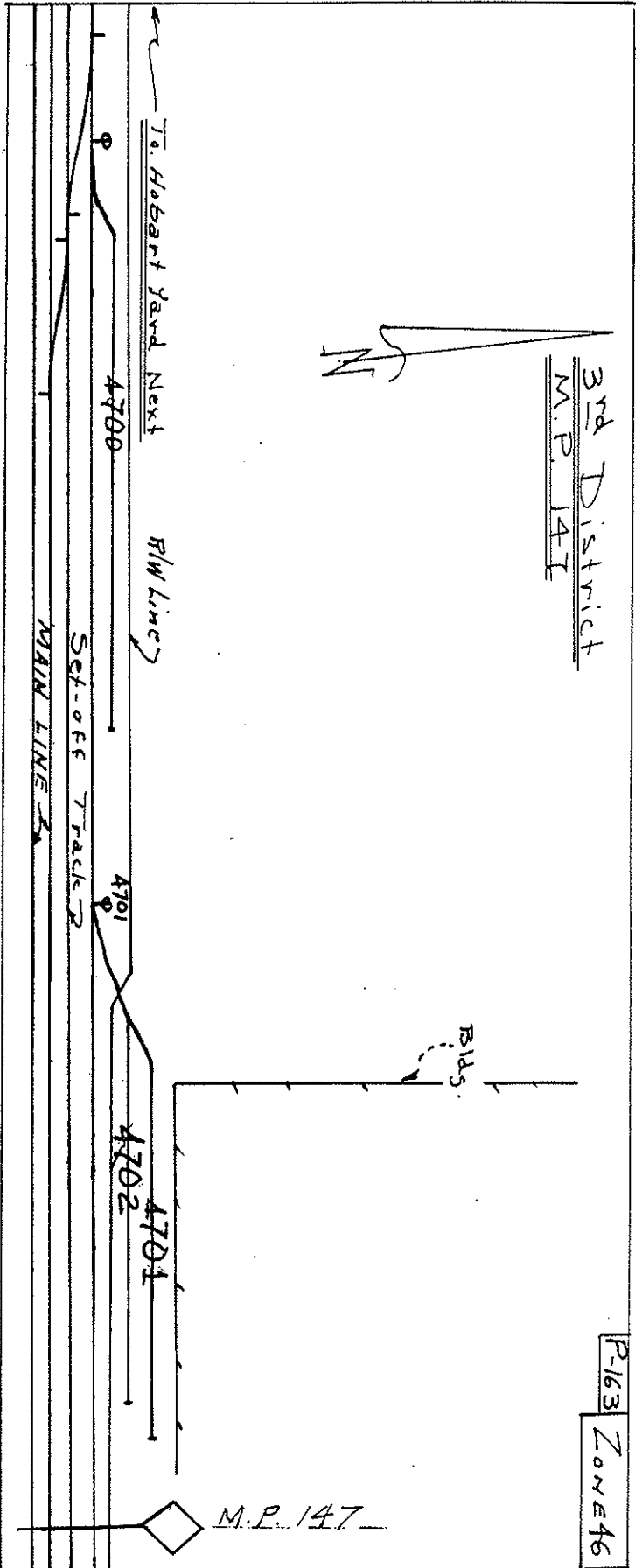
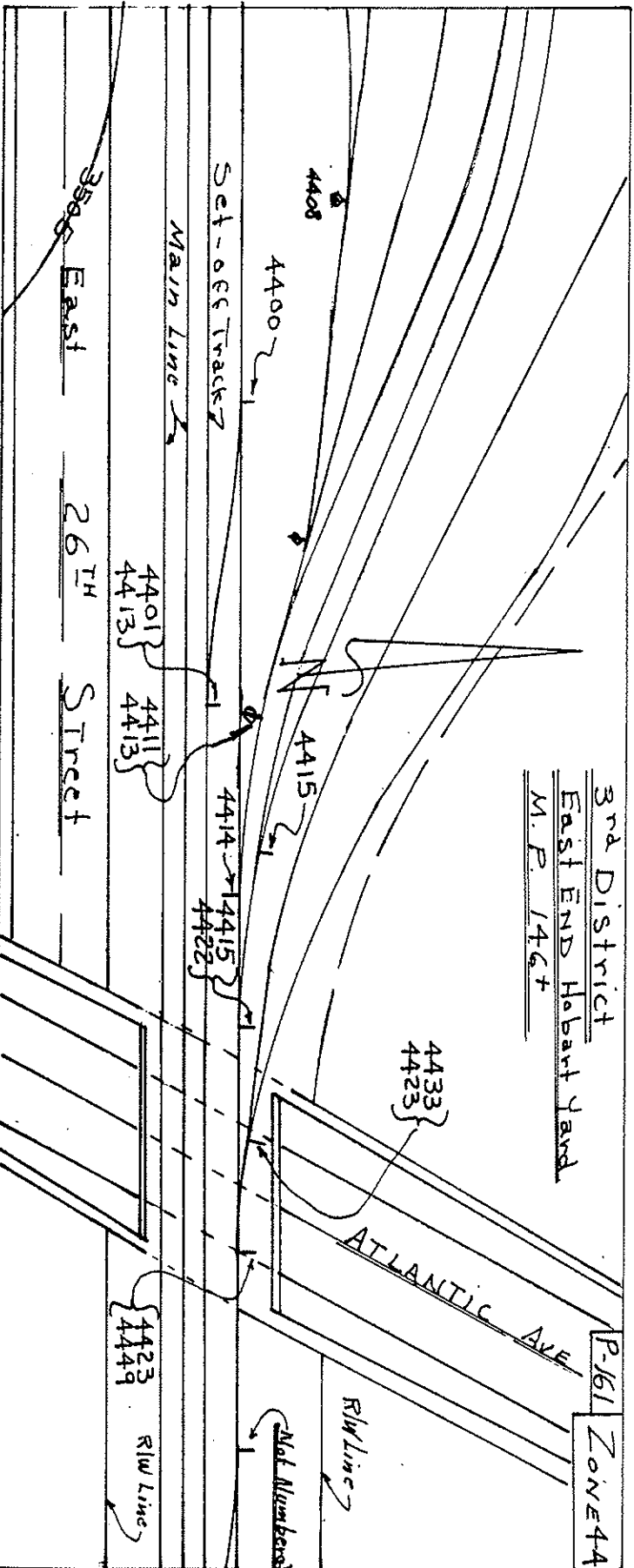

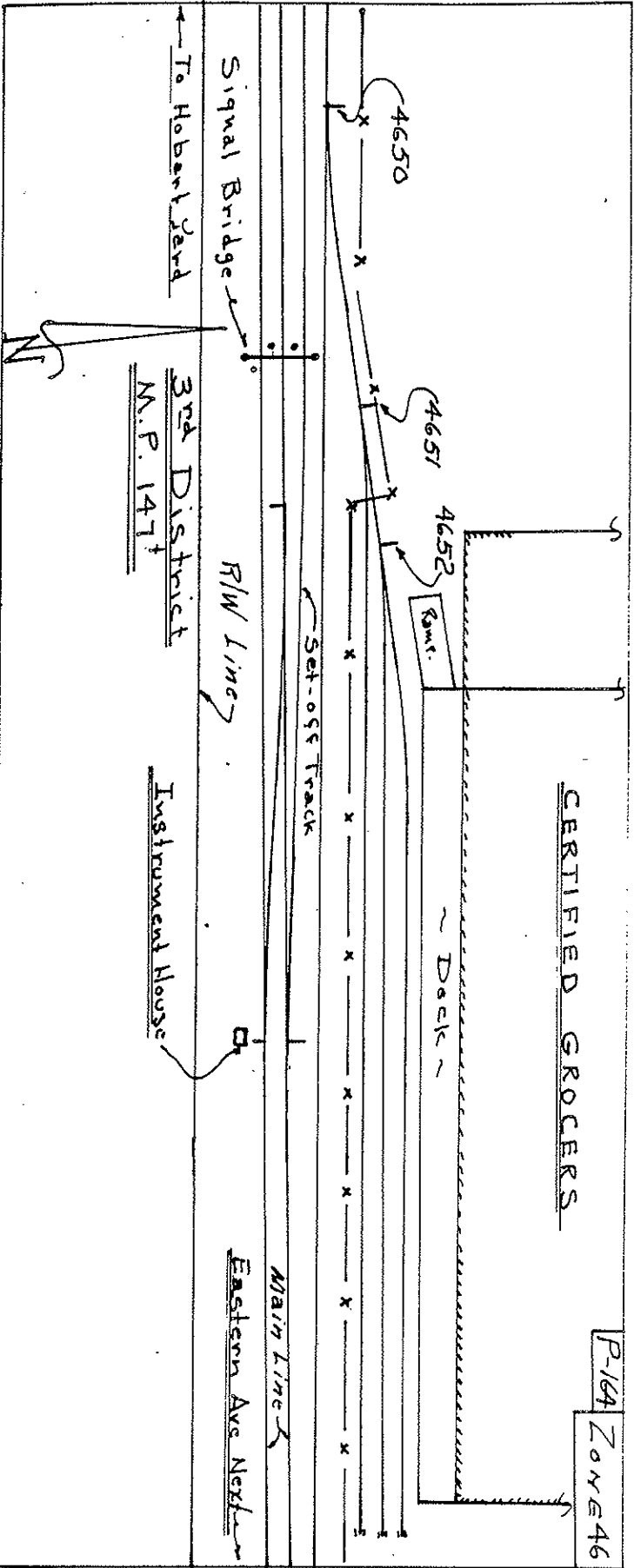
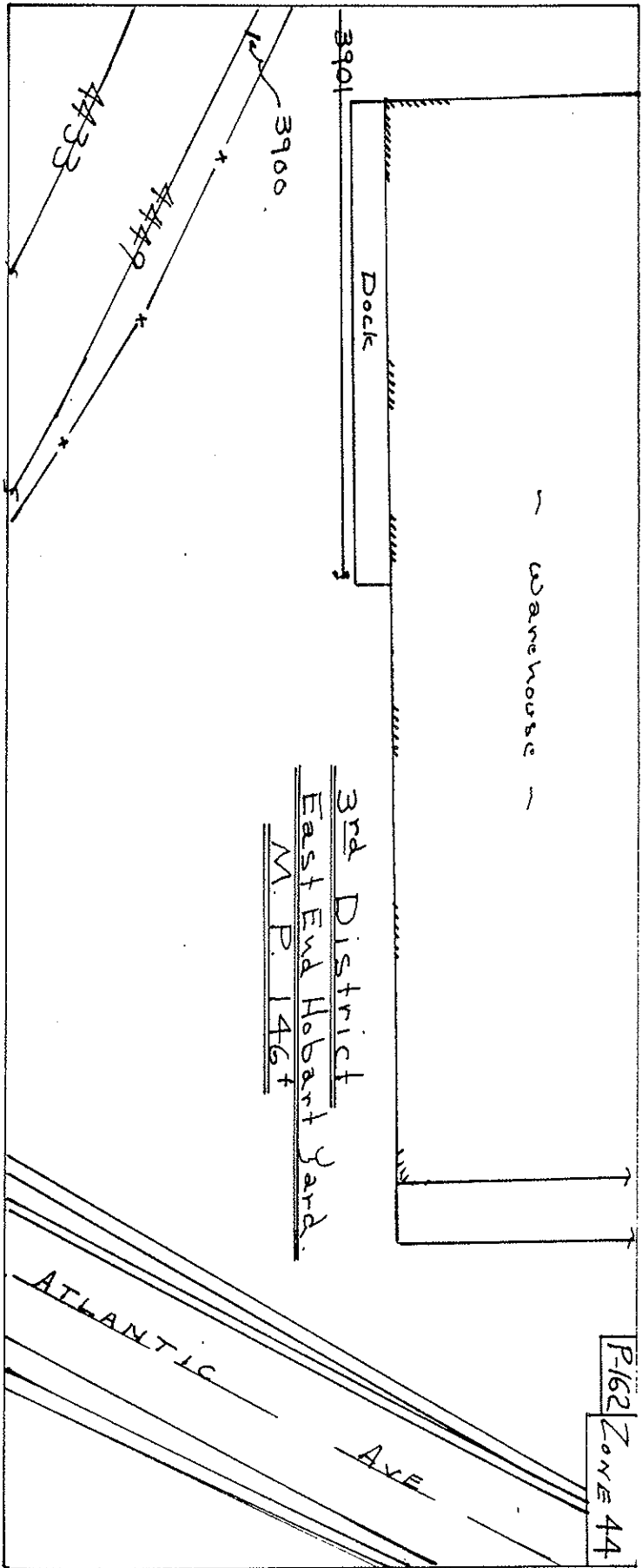



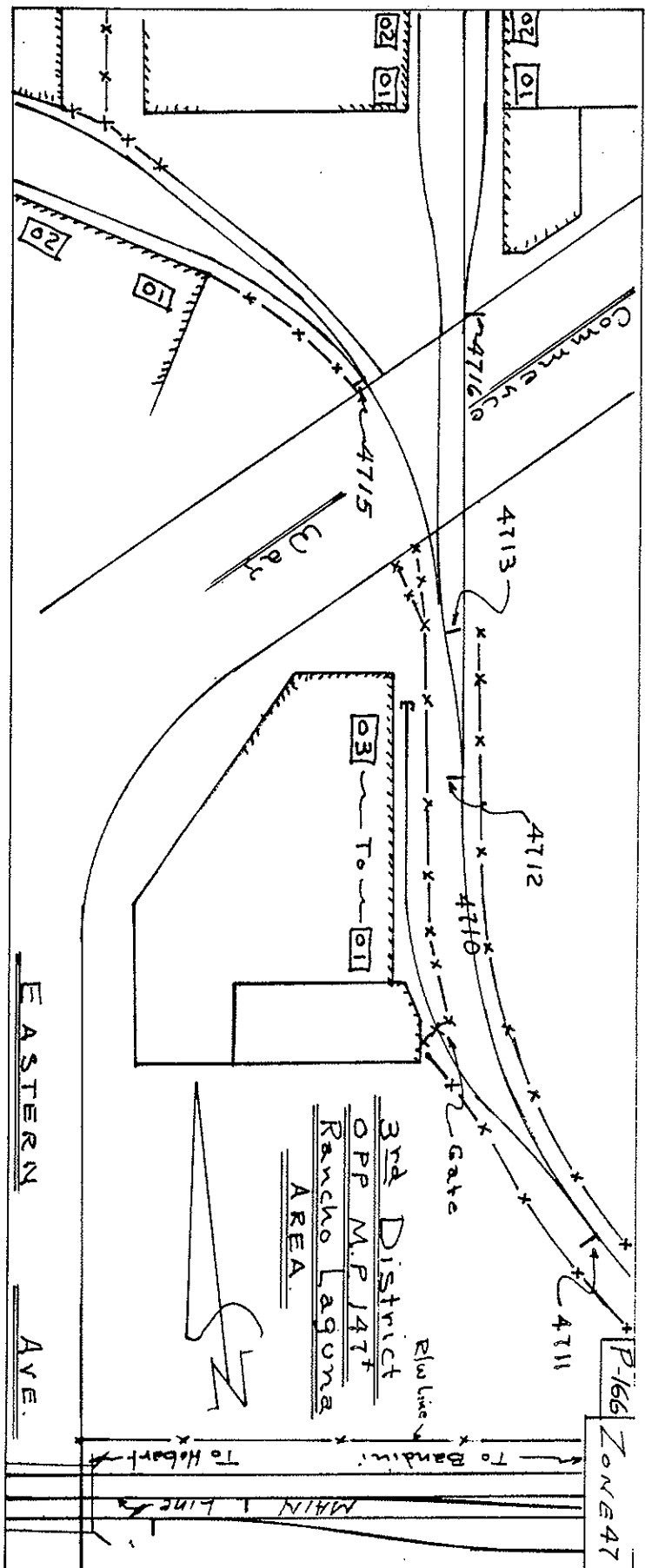
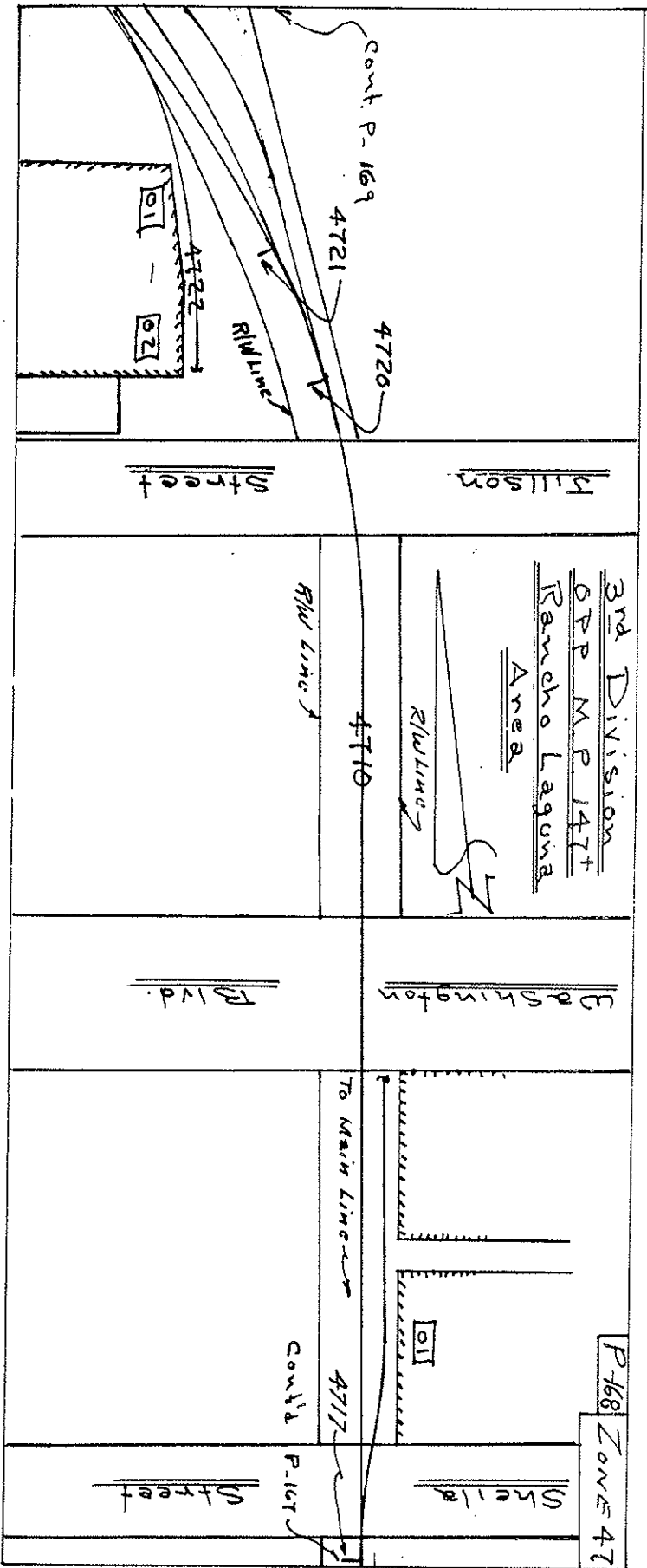

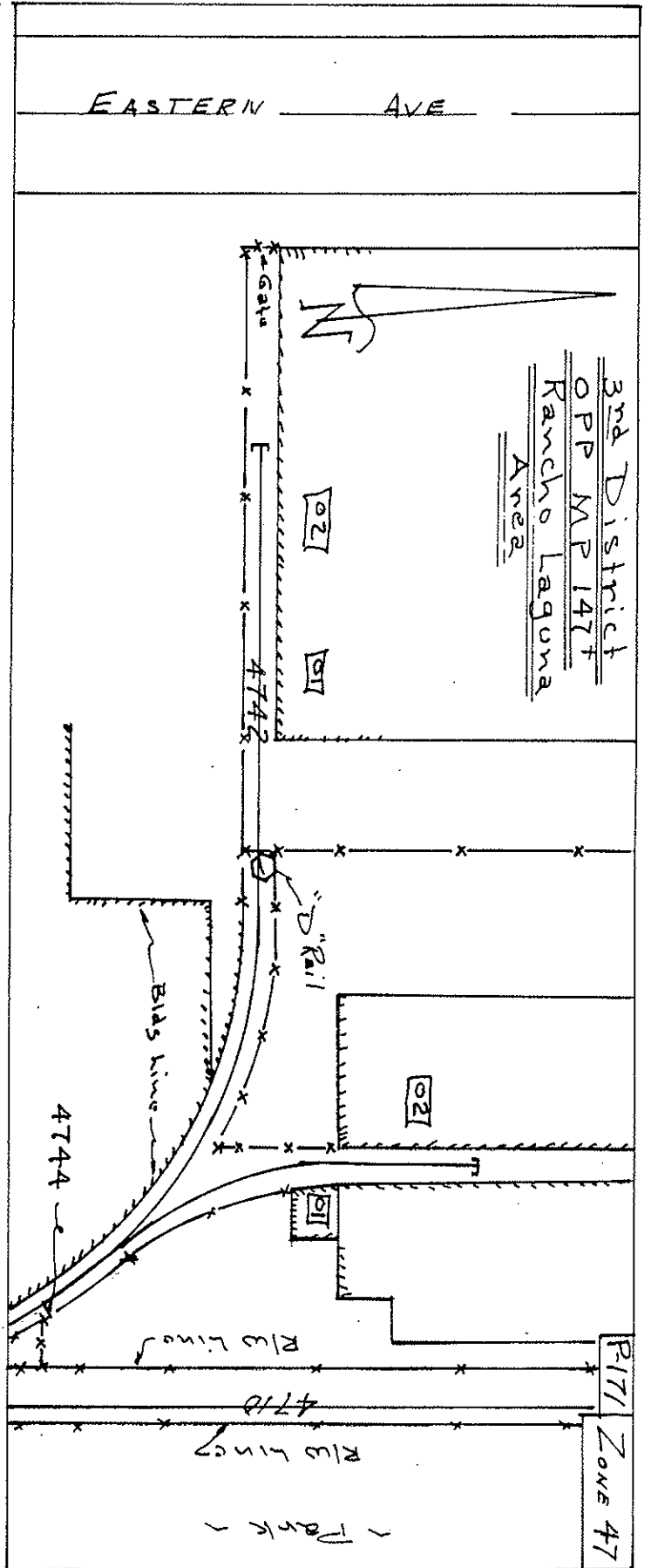
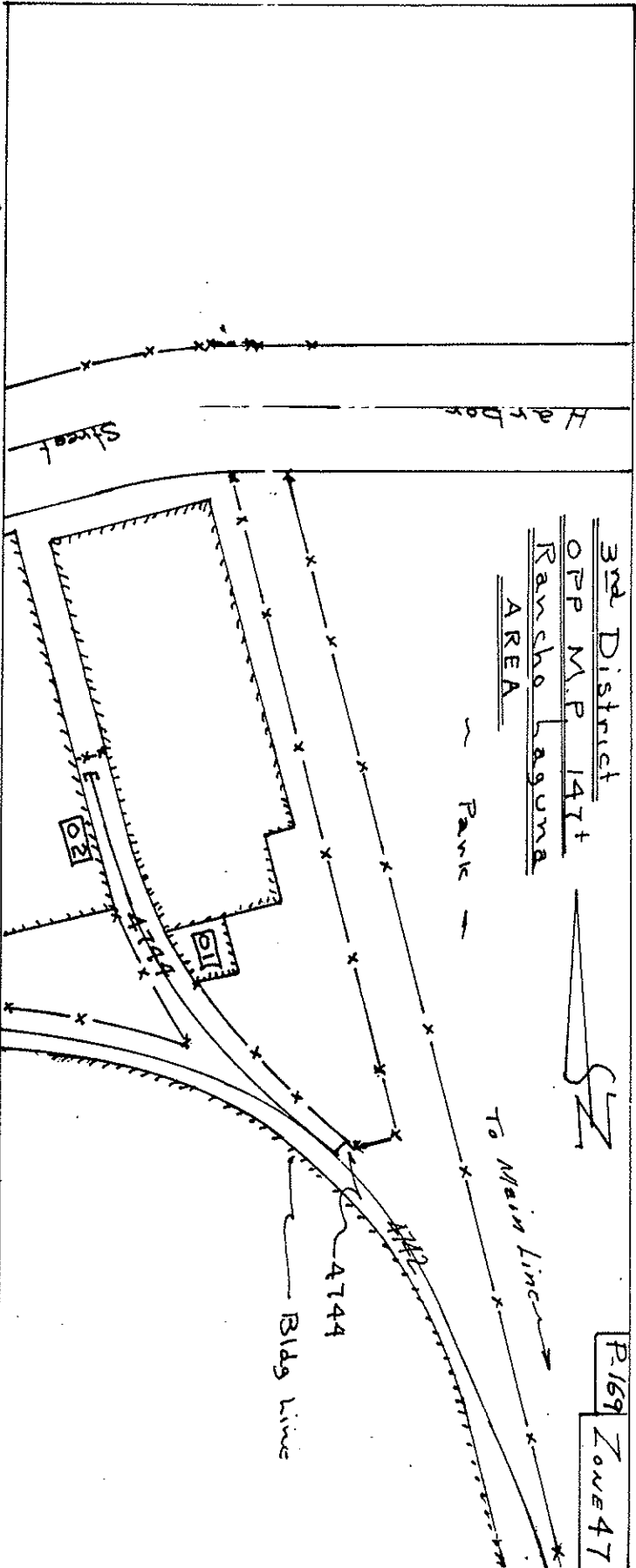





601-34362-41

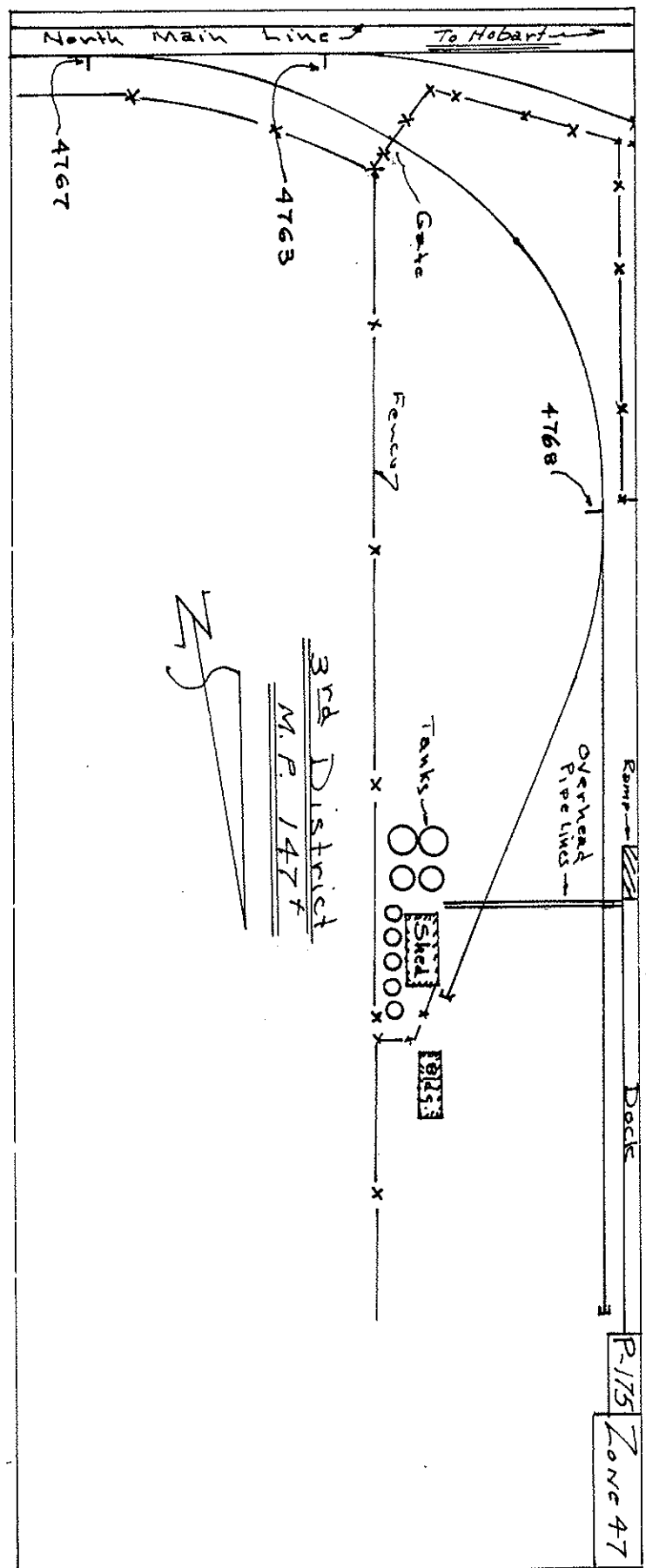
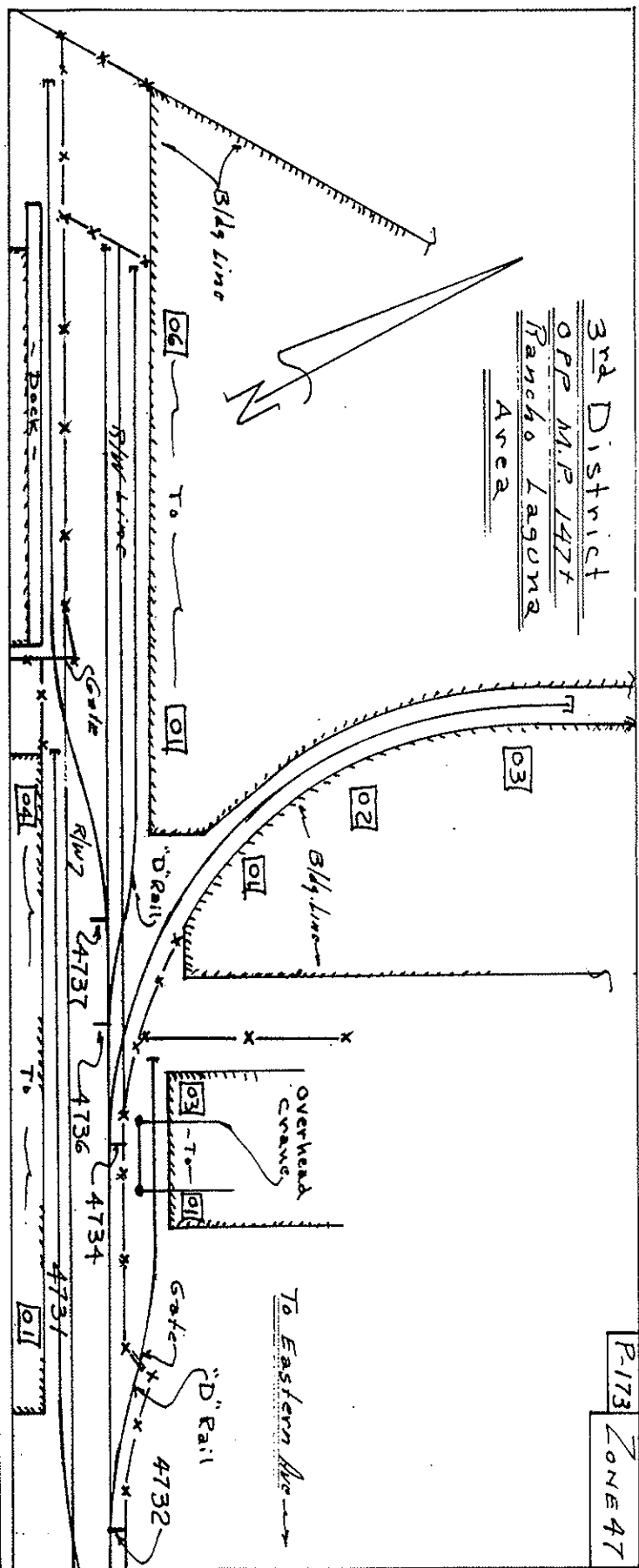

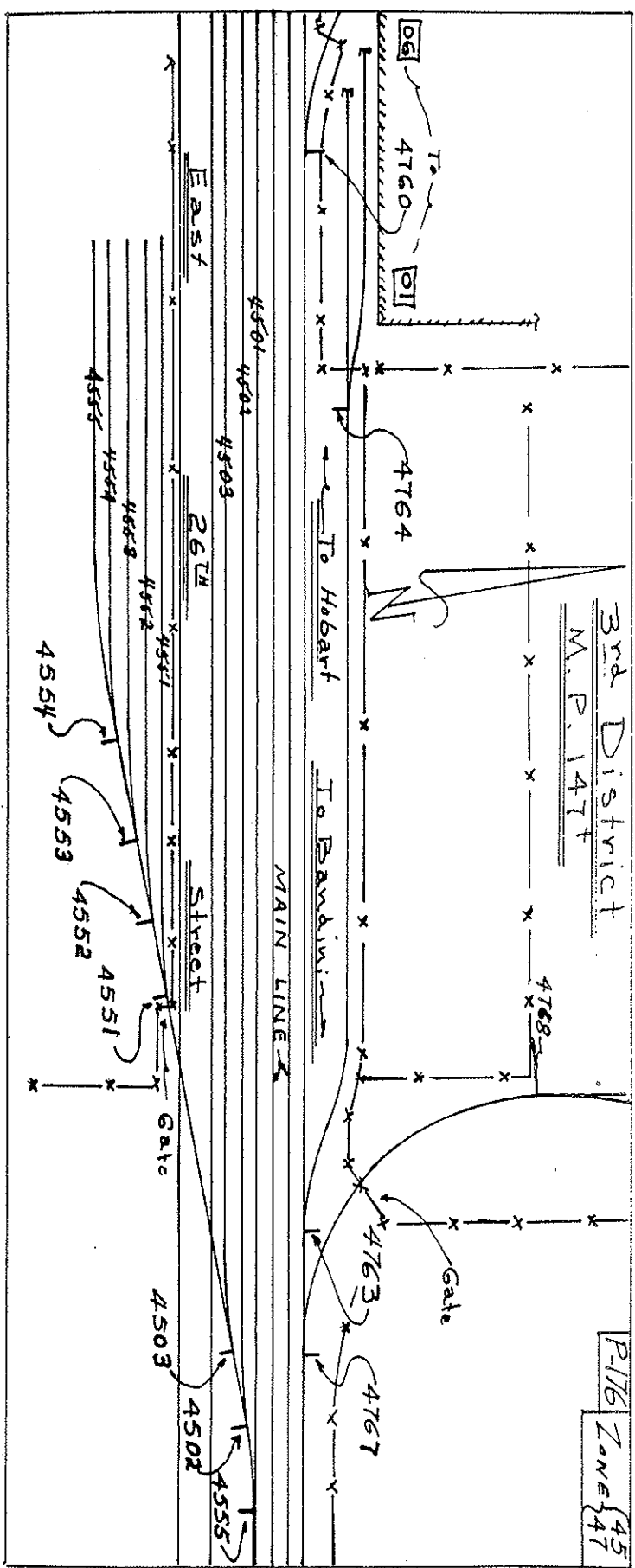
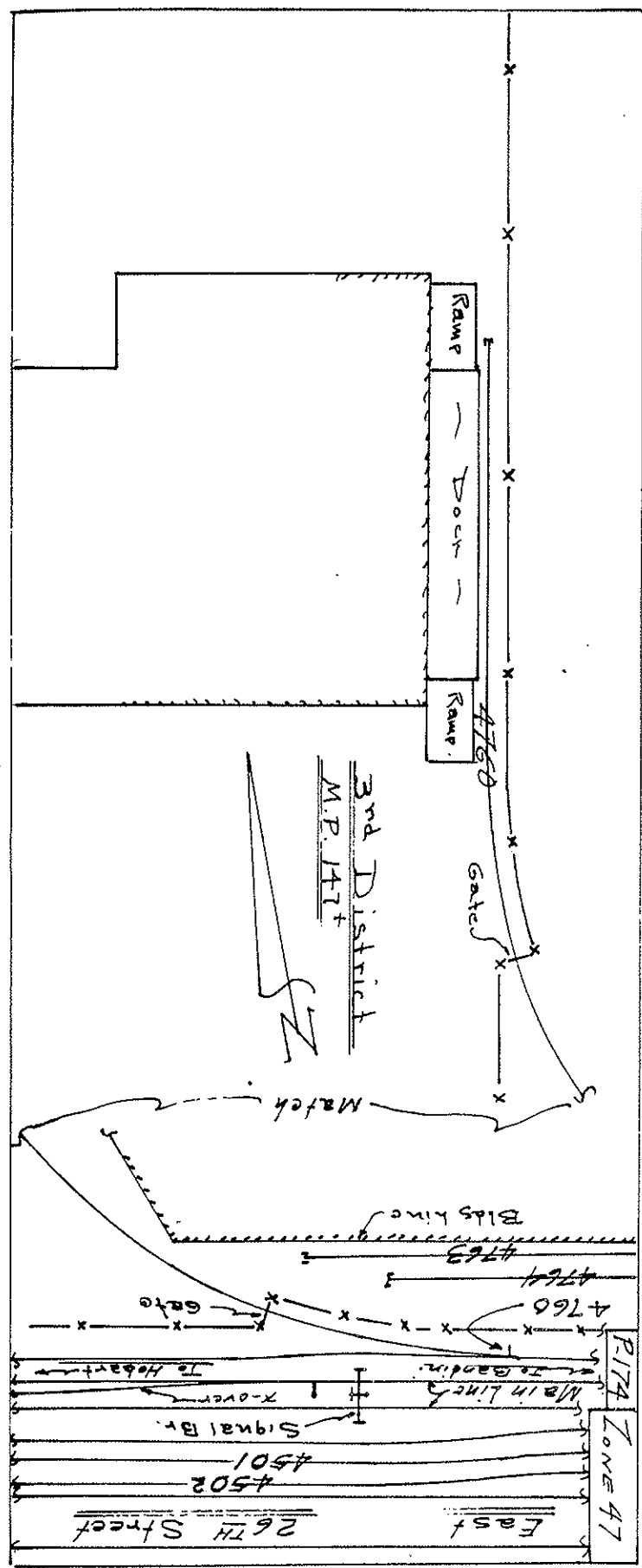

601-34362-43

