



'CLIC'

CAR

LOCATION

IDENTITY

CODE

L.A.T. DIV.-HARBOR DIST.

M.P. 0.0-8.0

ZONES 26-32

BOOK - 2

JUNE, 1983

CAR LOCATION IDENTITY CODES

This booklet contains instructions and maps for the Car Location Identity Code (CLIC) and procedures governing the Work Order Document System.

Maps are not drawn to scale and are to be used only as a guide to locating customer and yard tracks and the numbers assigned to them.

The geographical area covered in this booklet is divided into zones. Each zone has designated tracks and/or industries within its boundary.

A CLIC number will consist of six digits- the first two digits designate the zone; the second two digits indicate the track number within the zone; the last two digits represent the actual spot along the track.

The combination of the zone-track-spot number is known as the "Car Location Identity Code" (CLIC) System.

This "CLIC" number will be used for switching and reporting purposes rather than the industry or track name.

EXAMPLE OF CLIC NUMBER

12	22	04	Spot Number
			Track Number
			Zone Number

All switch targets or stands have been painted with a combination of the zone and track number.

Spot numbers have been painted on doors, docks, buildings, gates, etc., wherever possible.

WORK ORDER DOCUMENT

Any written or verbal instructions issued to yard or road crews requiring work to be performed during their tour of duty will constitute a work order.

NOTE: Exceptions to written work orders must be noted on the work orders according to current instructions; cars handled on verbal work orders must be reported on the prescribed form.

For observation and guidance, the following codes may appear on work order.

AI	- Agri. Industries
B1	- Bad Order
BA	- Blasting Agent (Hazardous)
CG	- Cargill
CD	- Condemned
CB	- Combustible (Hazardous)
CL	- Chlorine (Hazardous)
CM	- Corrosive (Hazardous)
DG	- Dangerous
DH	- Do Not Hump
DU	- Do Not Uncouple
EQ	- Equity Export - Houston
FG	- Flammable Gas (Hazardous)
FL	- Flammable (Hazardous)
FS	- Flammable Solid (Hazardous)
FW	- Flam. Solid W (Dangerous When Wet)
HE	- Head End Only
HL	- High Wide Load
PE	- Houston Public Elevator
HV	- High Value
IP	- Interchange Prohibited
IPSW	- Intraplant Switch (Respot Car)
MR	- Mechanical Refrig. Maintain - Degrees
MCNR	- Mechanical Car or Trailer - No Refrigeration Required
NG	- Non-Flammable Gas (Hazardous)
NP	- No Placards Required
OM	- Oxidizer (Hazardous)
OP	- Organic Peroxide (Hazardous)
OX	- Oxygen
PA	- Poison Gas (Hazardous)
PB	- Poison
RE	- Rear End Only
RM	- Radioactive Material
REJT	- Car Rejected by Shipper
KSPT	- Respot Due to Railroad Error
TURN	- Turn Car & Respot
WH	- Weight Heavy
W1	- Waive Inspection - Set Direct
WL	- Weigh Light
XA	- Explosive "A"
XB	- Explosive "B"
XX	- DO NOT MOVE THIS CAR

Conductors and Engine Foremen will be furnished work orders during their tour of duty.

This document will specify the cars to be picked up or set out at various stations, industries or interchange tracks served by the train or switch job.

Certain information (described below) must be recorded on the work order document by the Conductor or Engine Foreman. Prior to turning in the document at the designated reporting station, it must be dated and signed -- even if no work was accomplished. This is necessary to comply with switching and demurrage tariffs, as well as other rules and regulations.

Conductors and Engine Foreman must show on work order cars handled, time and date work performed, CLIC number taken from, CLIC number left and appropriate code as listed below:

- BO - Bad order
- ND - Work indicated not done (State reason.)
- NIT - Car not in train or not on track
- OTCC - Car on track, carriers convenience
- OTNP - Car on track not placed (State reason.)
- PULL - Car pulled, time and date
- SPOT - Car spotted, time and date

Conductor/Engine Foreman must make notation on work order and notify the appropriate employe (S/O, RYO clerk, Dispatcher) of any exceptions taken to the work order, such as no car, car not on list, car out of line, car is hazardous, excess dimension (when the information is not so indicated on work order), car is carded rear or head end movement, or any other exceptions noted.

If switching is performed without a work order, the Conductor or Engine Foreman must complete the prescribed form showing all the information required above and turn it in at the designated reporting station.

If an industry requests service not shown on work order, Conductor/Engine Foreman should obtain such request in writing. This request is to be turned in with work order for processing. If unable to obtain request in writing, Conductor/Engine Foreman should record on work order the name of person making request and the service requested and performed.

<u>CLIC #</u>	<u>NAME</u>	<u>MAP PAGE</u>
260190	Peterson Mfg Co	65
260291	Storage	
2603	Storage	64
260595	Old Richfield Spur	64
260701	Reliance Steel Alum	66, 67
260801	Reliance Steel Alum	66
260902-04	Columbian Chemi Sperling Sales Intelam warehouse	67
261101	Kleen Towel Service	67, 68
261201-02	Smith Daniel Team Track	66, 67
261203-04	United Am. Metal National Trucking	66, 67
261205-06	United Paper Stock	66, 67
261209	Schulken Bros Paper	66, 67
261211-12	Designer Reproductions	
261601	Teledyne Western Wire	67
261602	Federal Office Prods	67
261603-04	Nationwide Paper Co	67, 68
261791	Storage	68
261890	Williams Trans	68
261891	Wilshire Spur	68
261991	Wilshire Spur	68
262091	Hercules Spur	68
262101-02	Gibson Homans Crescent Chemical	68
2630	Lead	69, 73
263010	Scony Paint #5	69, 73
263001-09	Mobil Oil #4	69, 73
263101-09	Mobil Oil #15	70
263201-08	Mobil Oil #6	70
266001	Genl Whlse Prods Warner Foods	69, 71, 72
266101	Aynet Inc Ferry Mfg Co Carol Cable Co Columbia Electronics	

<u>CLIC #</u>	<u>NAME</u>	<u>MAP PAGE</u>
266501-02	Zelman Development	73
266503-05	C H Laurence	73
267001-02	Guild Moccasin Corp	69, 71
		72
267003-14	Glass Contr	69, 71, 72
267008	Vacant	
267018	Siesta Bedding	
267019-20	L. A. Brush	
267201	Maas Hansen Steel	68, 69
268001-02	Ritten House Paper	73
268201-02	Riviera Convertible	73
2701	Malabar Yard 1	73, 75, 77
270110	L. A. Brush	73, 75, 77
2702	Malabar Yard 2	73, 75, 77
2703	Malabar Yard 3	73, 75
2704	Malabar Yard 4	
2705	Malabar Yard 5	74, 75
2706	Malabar Yard 6	74
2707	Malabar Yard 7	75
270701	McKay Co.	75
	Teledyne McKay Co.	
270801-02	Littlejohn Reuland	73, 75
270901-02	Peerless Pump	73, 75
	Mechanical Foundries	
271001	Merchants World	74, 75
271002	Sun Dance Furn	74, 75
271101-03	Boiston Industries	75
	Catspaw	
271201-02	Fee Mason	75
	Mathis Sales	
271202	Hilex Roly	75
271290	All Distribution	
272001	Hi Power Automation	75
	Castings Material	
272002	Star Name Plate	74, 75
272003-07	Lincoln Foundry Co	74, 75

<u>CLIC #</u>	<u>NAME</u>	<u>MAP PAGE</u>
276197	Consol Mt	74, 75, 77
276201-03	Ed Bensley Son	77, 78
	Congoleum Whse	77, 78
276204-05	Quality Park Prods	
276301-03	Trade Paper Co	77, 78
276401	B J Hughes	78
	Interline Dist.	80
276591	Storage Trk	78
276502	Glaser Bro	
276601-08	Gardena Seed	78
276802-04	Vacant	
276805-07	Ivy Hill Lithograph	75, 79
277091	Vacant	75, 79, 80
2771	Vacant	
277201-04	Ivy Hill Lithograph	79
2773	Transfer	79
277401-19	Vacant	79
277415-20	Golden Oak, Inc	79
277501-19	Vacant	79
277601-12	Vacant	80
277712-19	Golden Oaks	79
277801-10	Vacant	79, 80
277904-06	Dept. Store Co	79
277613-19	Baker Intl Whse	
277713-19	Baker Intl Whse	
278001-02	Hartfield Zody's	80
	RMG Corp	
	Interline Distr.	
278101-03	Vacant	80
278297	Ducommon Metal & Sply	80
278497	Ducommon Metal & Sply	80
279701-03	USCO Inc Whse	75
279704-05	Piping Prods West	75
280101	Kelley Mfg Co	75, 81
2803	Malabar Team Trk	81
280390	Talley Brothers	81
280402	Butler Johnson	81
280501-02	Malabar TT House 2	81

<u>CLIC #</u>	<u>NAME</u>	<u>MAP PAGE</u>
272009-12	U S Container	74, 75
272013	Amer Drill Bushing	74, 75
272201-02	Interlake Steel Co	75
272301-03	Pacific Soap Co	75
272304	Blosser Co E J Walnut Investment	75
272305	Thornton Coast Ring	75
272401	Lawson Products Perfection American	75
272402	Manhattan Trans	75
273101	Standard Sales	75
273201	Goode Products	75
2735	Vernon Team 6	76
2736	Vernon Team 5	76
2737	Vernon Team 4	76
2738	Vernon Team 3	76
2739	Vernon Team 2	76
2740	Vernon Team 1	76
275002	Thermo King	73, 76
275004-06	Vacant	73, 76
275101-05		
275201-05	Pac Coast Paper	74, 75, 77
275301-07	Pac Coast Paper	77
276001	Jeffries Bank Note	74, 77, 78
276001-02	Dormer Carpet	74, 77, 78
276002	India Ink	
276002	Inventory Plus	74, 77, 78
276002-04	Jensen Genl Cpn	74, 77, 78
276003	Pottery Sales Inc	74, 77, 78
276003-04	Cal West Dist Co	74, 77, 78
276005	LA Co. Registrar	74, 77, 78
276005-08	Cort Furniture	74, 77, 78

<u>CLIC #</u>	<u>NAME</u>	<u>MAP PAGE</u>
2806	House 3 Malabar	81
280701-02	Western Furn Uphol81	
280801-02	Ramco Supply Co	81
280901-07	C F S Continental81	
282001-02	Duncan D D Co	82, 83
282206	L A Sales & Service	83
282401-03	Western States Stone	83, 84
282502	Nadeau Team Track	83, 84
282601-07	City of Los Angeles	84
2828	Wingfoot Team Track	85, 86
283001	Ace Bailing Wire	86, 96
283002	Advance Alum Brass	86, 96
283503	Morrissey Brothers	86, 96
283504	Alphapac Indust.	86, 96
283006	Raytee Co	86, 96
2832	Storage	86, 87, 96
283591	Wingfoot Runaround	86, 96
283601-03	Gillespie Furn	97
283701	Lowell Wood #1	97
283702	Triangle Pipe	97
283801	All Mtl Recycling	97
283901-02	Haley Brothers	98
284001-04	Haley Brothers	98
284301-02	Beauchamp Dist Co	98
284501-02	Lisa's Trading	98
284501	Rex Paper	98
284503-06	Atlas Mill Supply	98
284801-02	Beauchamp Dist Co	
284803-05	Parrish Cake Decor	99
285001-02	Standard Fabrics	100
285101	Times Furniture	100

<u>CLIC #</u>	<u>NAME</u>	<u>MAP PAGE</u>
285291	Passing Track	100, 103
285401-04	All Roofing Co	101
	Lesco Matls Co	101
2855	Wildasin Team Trk	102
385601	Cadet Records	102
285701-03	V&M Distr Co	103
285704	Landauer Lamp Mfg	103
285705-06	Lightcraft of Calif	103
	Mariner Pacific	103
286096	Fum-a-Pest	103
386201	Leo's Quality Foods	104
286301	Hofert J Co	104
286302	Container Service Co	104
286303-05	C B Van Vorst	104
286306-08	Berg Mill Co	104
286309-10	C B Van Vorst	104
286311	Reischel Cottrell	104
286312-13	Advance Paper Box	104
286315	Vacant	104
286316	Kant Wet Mattress	104
	Quester Juv Furn	
286317	Vacant	104
286318	Specialty Contrs	104
286390	Altenberg Assn	104
286396	Cyclo Chemical	104
2865	Vacant	104
286803	Quality Craft	
286804-06	Cont. Baking Box	105
286807	Epoch Ind.	105
286808	Advance Paper Box	
286809	Quester Juv Furn	105
	Babyline Furn	
287090	Mullins Lumber Co	106
287290	Active Recycl Inc	
287301	Ansin Manufacturing	106
	Star Warehouse	

<u>CLIC #</u>	<u>NAME</u>	<u>MAP PAGE</u>
321703	Vacant	91
321706	Futuristic Inst.	91
3220	SP No-ATSF Spur 2832	87, 90
322105	Shindana Toy Co	89, 90
322201	Reliable Container	
3224	SP Transfer	87, 90
322501-03	Sheet Plant Corp	90
322605	Pervo Paint	
322613-14	L L Cole	90
322640	Clark Litho	90
322701	Johns Milton	90
322702	Les Gross Assn	
	High Point Furn	
322719	D S Hamway	90
322719-21	Signature Ofc Furn	90
322805	Appolo Plastics	90
322807	Royal Woodcraft	90
	Sheet Plant Co #1	
	Otte Eds Trucking	
322808	A&A Wiping Cloth	90
322810	Std Chrome Plating	90
	Std Nickel Plating	
322814	Continental Desk	
322816	Schapp	90
322817	Paltex Inc	90
322820-21	SW Fibres	90
	Burlap Ind Inc	
	Glentex Corp	
323001	Inmont Corp	90
323101	Pacific Castings	90
323102	City Paper Box	90
323103-04	Aslanian Export Co	90
323105-10	Fairmont Tire	90
323107-08	H L Corp	90
323201	Paul's Trkg	90
323202	Cons. Bolt Nut	90
323301	Saitex Corporation	89
323302	Alloy Metals	89
323304	Sun Supply	89

<u>CLIC #</u>	<u>NAME</u>	<u>MAP PAGE</u>
287501-03	Eclipse Plaster Co	106
2880	Van Ness Team Track	107
2881	Van Ness TT Storage	107
288290	Sanfd Lussier Lmbr	107
288301-02	Ray Hill Lumber	107
288701-03	Maurice Ceramic Ind	108
288704-07	Mid City Beverage	108
288801	Rainier Mfg	108
288802	Ross Cook, Inc	108
2890	Hyde Park Team	108
289003	Lar Par Inc	108
	Contntl Beer Dist	
	West Side Distr	
321291	Storage Track	91
321308-12	Western Lithograph	91
321401	Safe T Pac Baking	91
	Ferris of Calif	
	Aleco, Inc	
	Boster Supply	
321402-14	Steelmet, Inc	91
321405	A&D Industrial	91
	Jelon Cosmetics	
321406	Trojan Metal Prods	91
321408	Cal Strip	91
321409	Brianco	
321412	Vacant	91
321413	Alesperams	91
321415	Specialty Paper Box	91
321416	Western Lithograph	91
3215	Amer Paper Co	91
3216	Salsburg Corp	91
321701	Federal Metals	91

<u>CLIC #</u>	<u>NAME</u>	<u>MAP PAGE</u>
323401	A M Building Main	89
323409-11	Easterday Supply Co	89
323502-04	Holly Decorations	89
323505-09	United Polymer	
	Marine Plastics	
323510	Browns Salv & Metal	89
323515	Fabricote	89
323517	Universal Pillow	89
323518	Widmarchemical	89
323606	Arrow Plating Co	89
323801	Central Metals Prod	89
323805	Grand Rapids Zimmerla	89
323806	Jetset	89
324001	Amer Reinfrcd Plastics	88
324002	Cont Cement Prod	89
324002-03	Cav Pro Inc	88
324005-07	Olson Chem Co	88
324005-07	Leslies Pool Mart	88
324008-09	Gold Plastic Co	88
324101	Kapan Kent Co Inc	88
324146	Superior Wall Systems	88
324147	Prime Resources	88
324149	Cole	88
324159	Tex Coating Foam	88
324302	Great Western Frame	
324307	Moberg Lab	88
324308	Great Western Frame	
324313	Western Synthetic Felt	88
324305-06	Sou Cal Furn Distr	88
324501-02	L A Sanifelt Co	88
	Western Synthetics Felt	
324504-07	Badger Paper Co	88
3246	Track Spiked	88
325001	Chief Products	87, 88
325303	L A Cal Automotive	87
325304-07	United Alloys	87

<u>CLIC #</u>	<u>NAME</u>	<u>MAP PAGE</u>
325401	Book Covers Inc	87
325701-03	Rolla Metals Co	87
325705-06	West Lake Outlet	87
325701	Civic Center Sales	87
	Eagle Urethane Co	
	Franchise Leasing Co	
325712-13	Cannon Craft	87
325801	Vacant	87
325803	Royal Crown Cola Co	87
325901	Kramer Metals	87, 88
326006-08	Imperial Delta	93
326006	Crms Deliveries	93
	Argus Paper	
326006	Koat Pacific	93
326230	Signal Mfg Co	93
326302-03	Imperial Delta Co	93
326601	Los Angeles Stitching	93, 94
326605-06	Pervo Paint Company (Tank Cars Only)	93, 94
326608-12	Far Best Products	93, 94
326612	Millcraft Furn Co	93, 94
326613-15	Signal Mfg.	93, 94
326617	Apex Pattern Co	93, 94
326618	National Sandblasting Custom Lithograph Co	93, 94
326619	David Cooper	93, 94
326621	Interstate NonFerrous	93, 94

<u>CLIC #</u>	<u>NAME</u>	<u>MAP PAGE</u>
328503	Pyramid Press	95
328503-04	Paltex	95
328506-07	Assoc Machinery	95
328508	EMCO Corp	95
329101-06	Vacant	92
329201-06	Vacant	92
329301-04	Vacant	92
329401-05	Vacant	92
329501-06	Vacant	92
329701-03	Vacant	92
329892	Vacant	92, 93
329992	Vacant	93

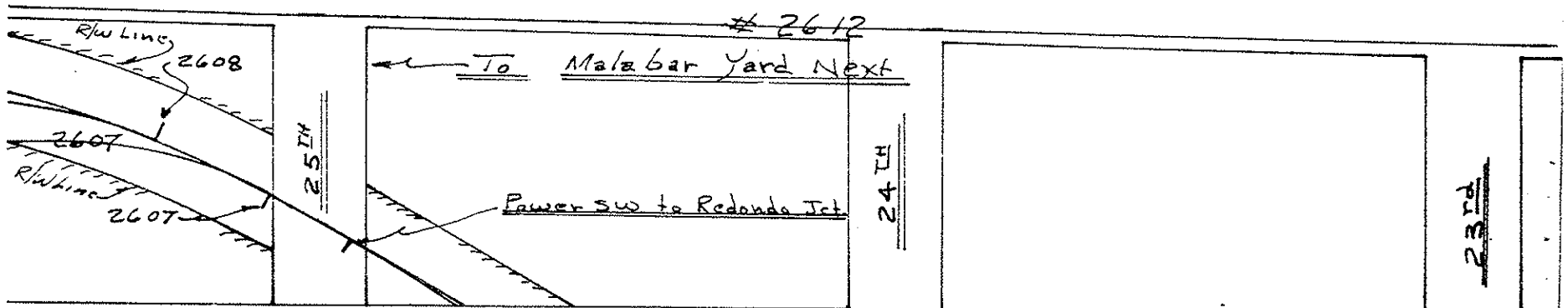
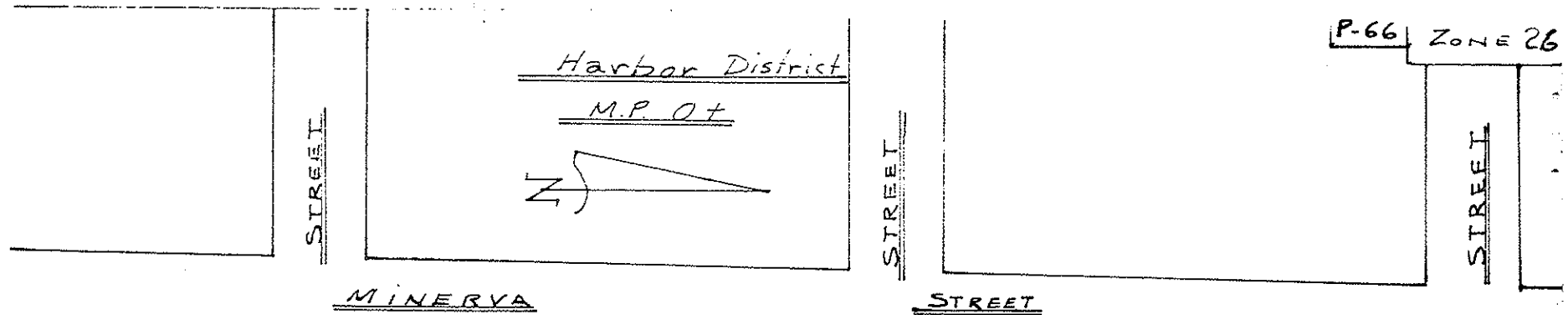
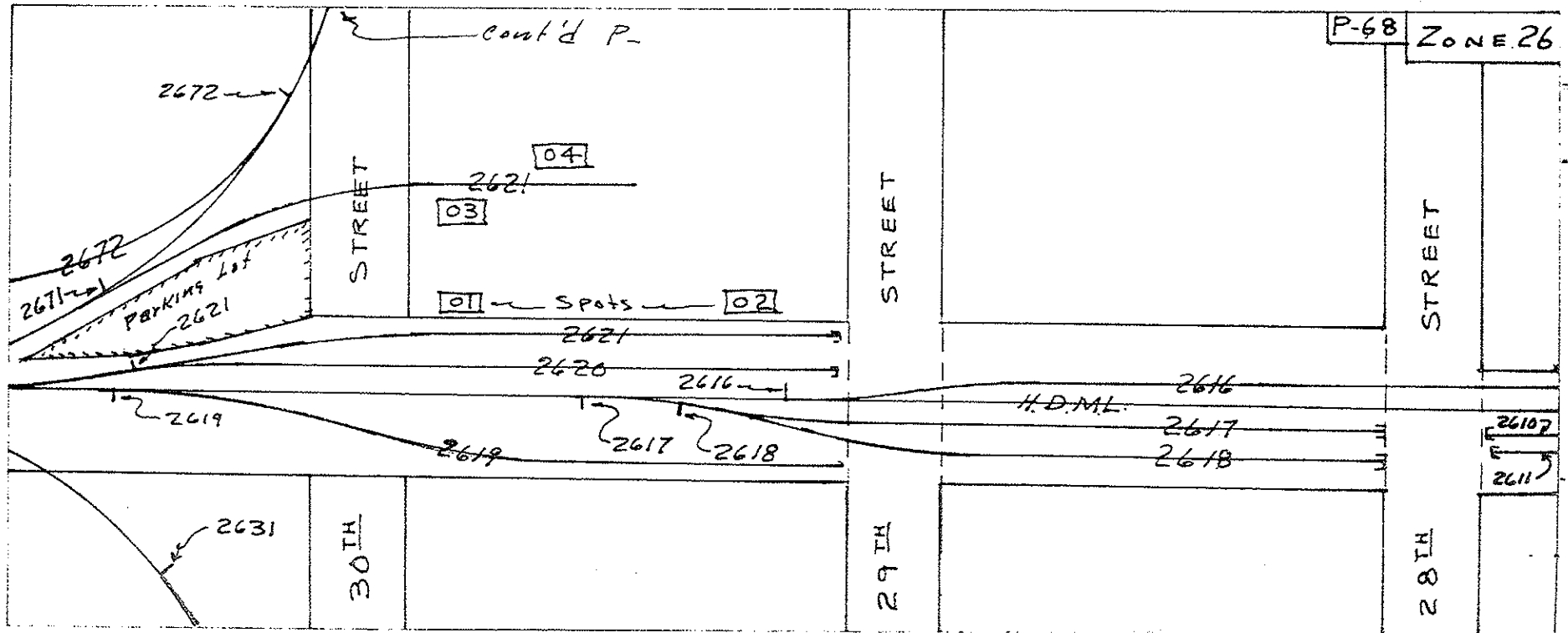

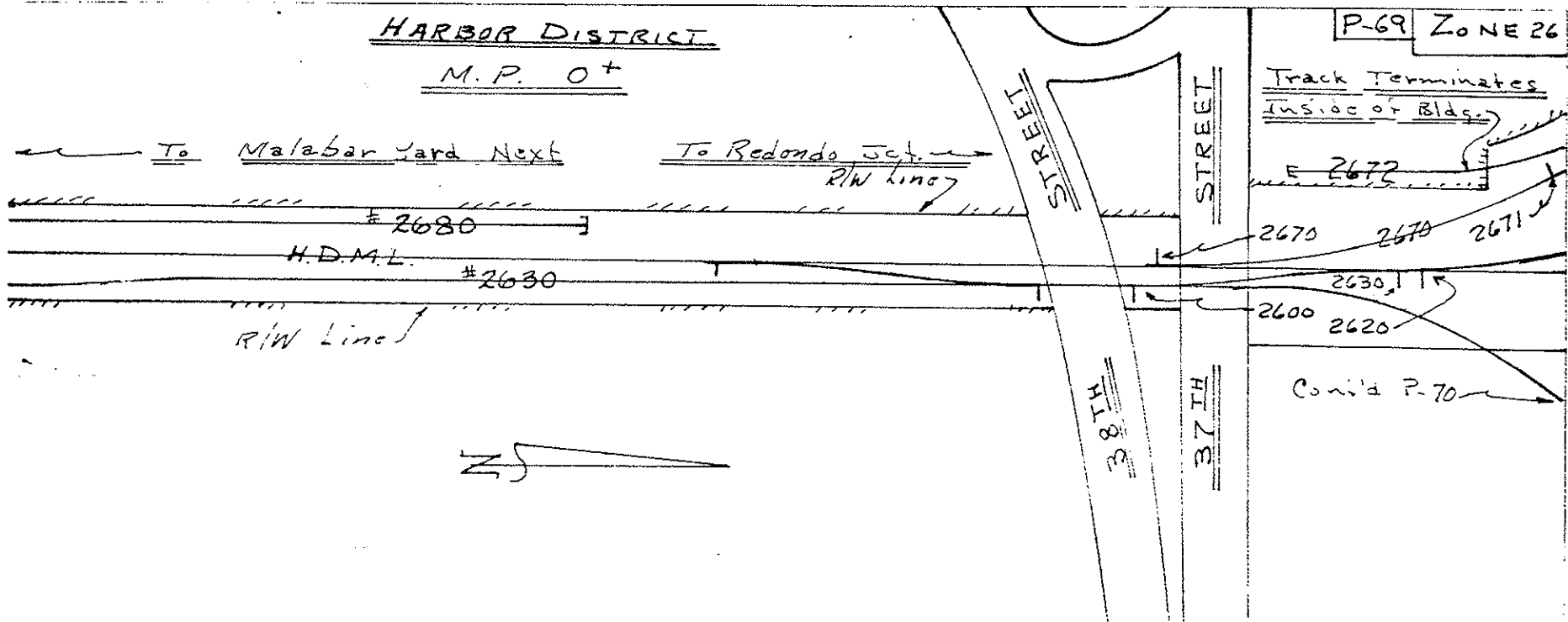
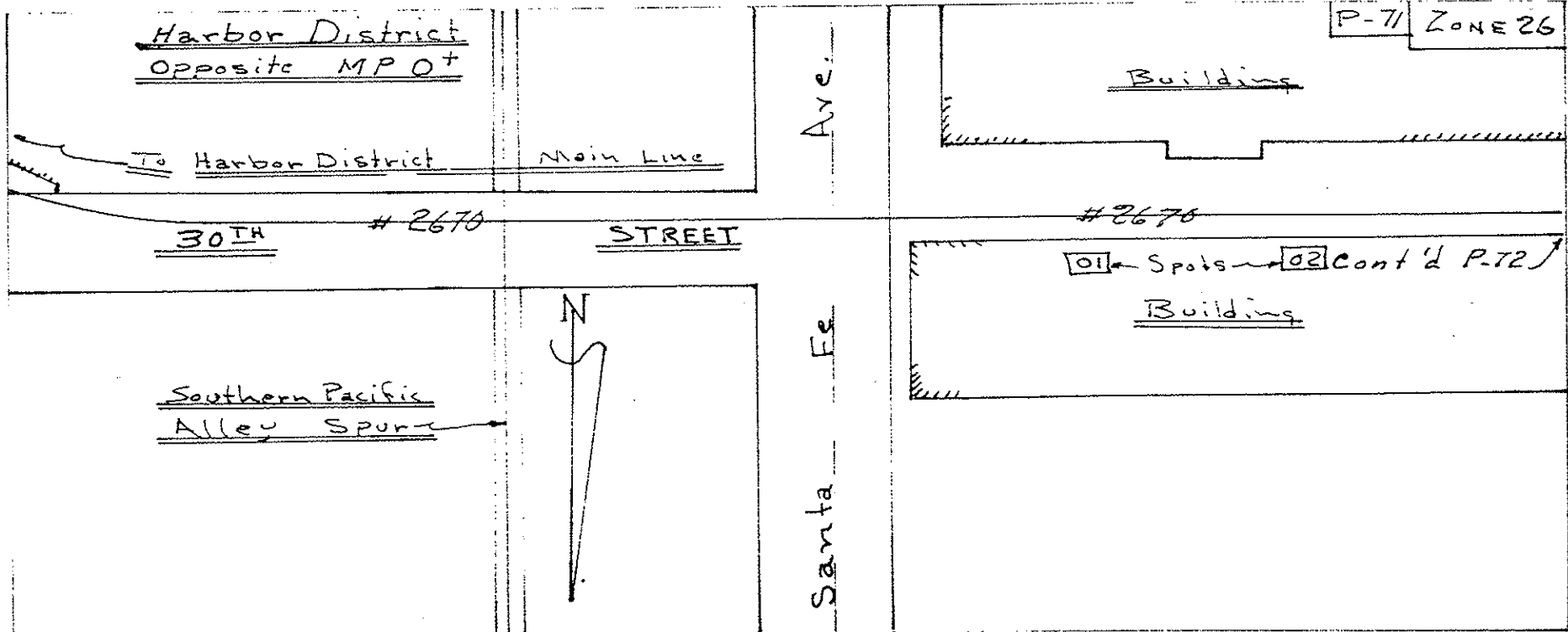

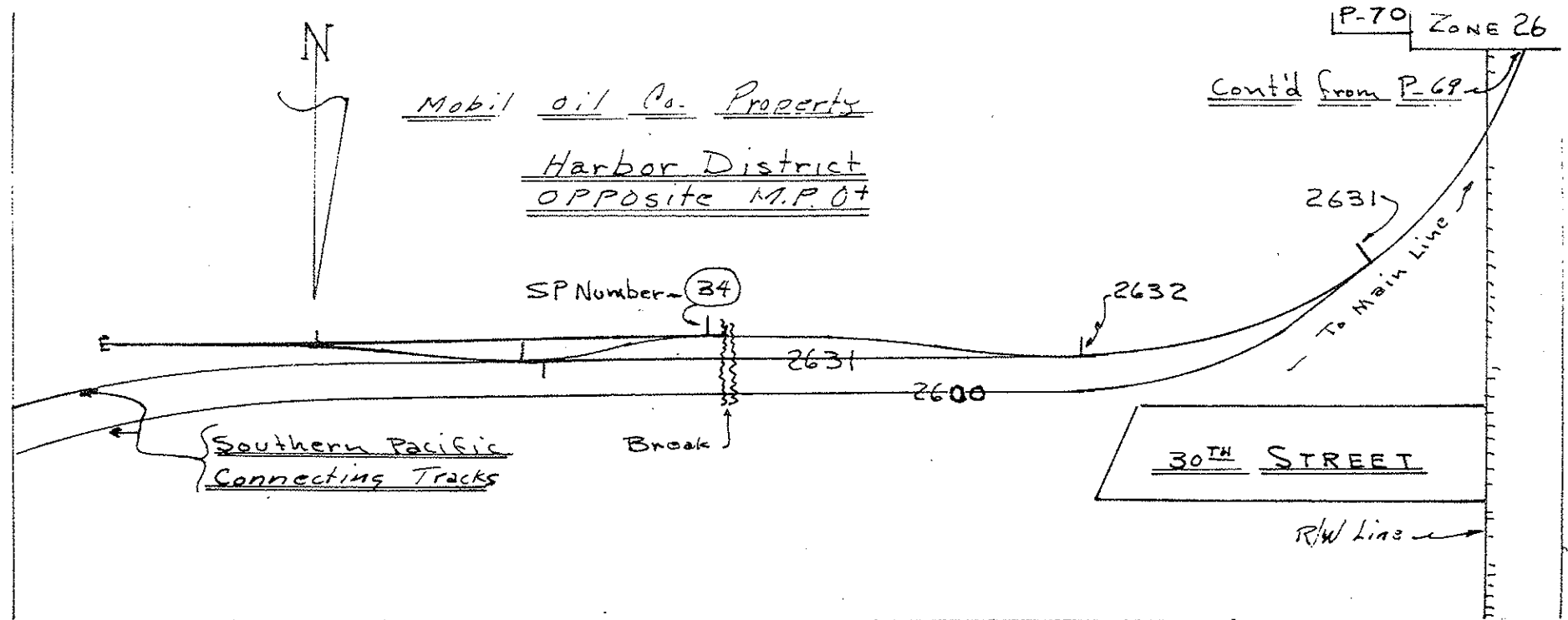
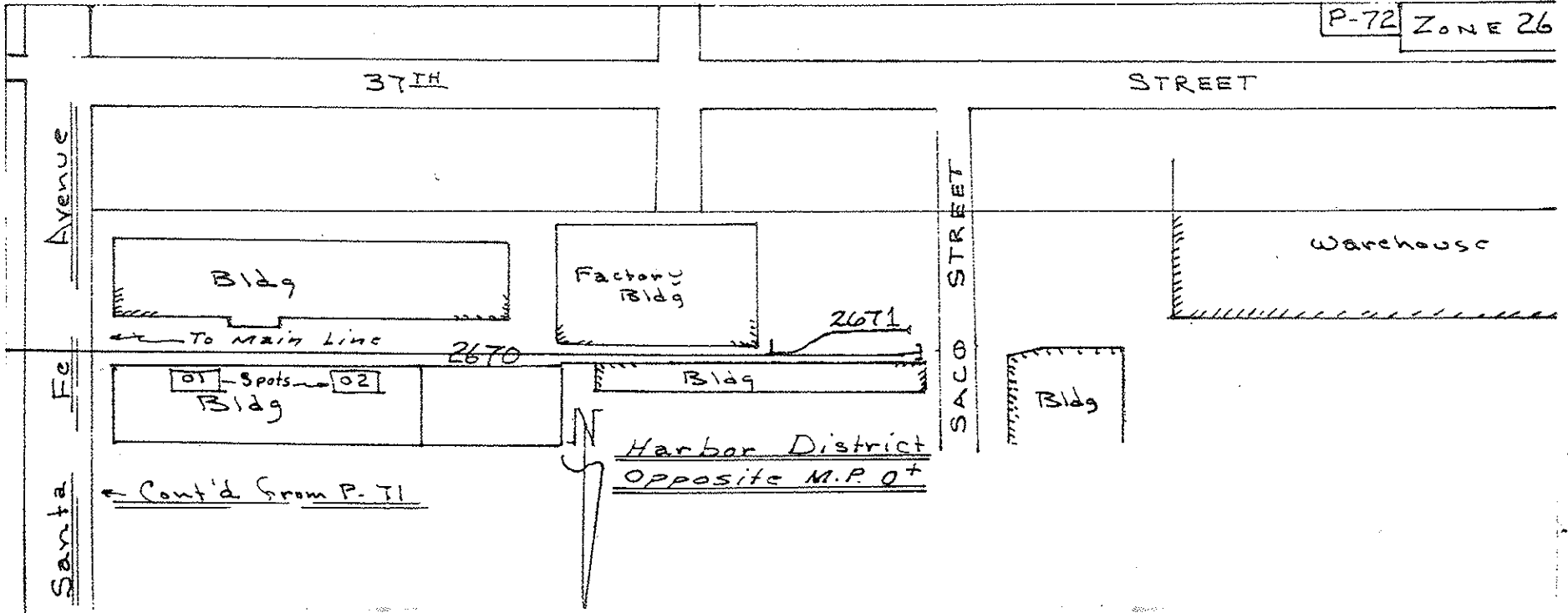

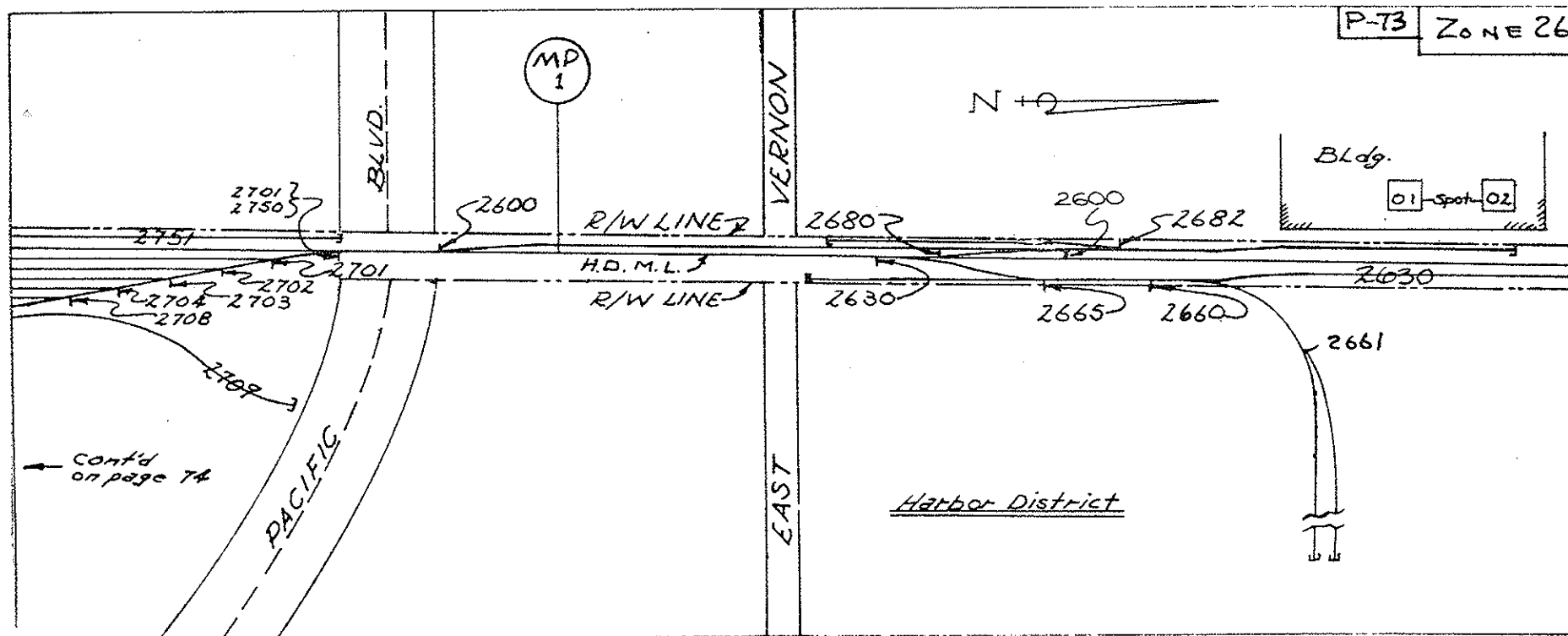
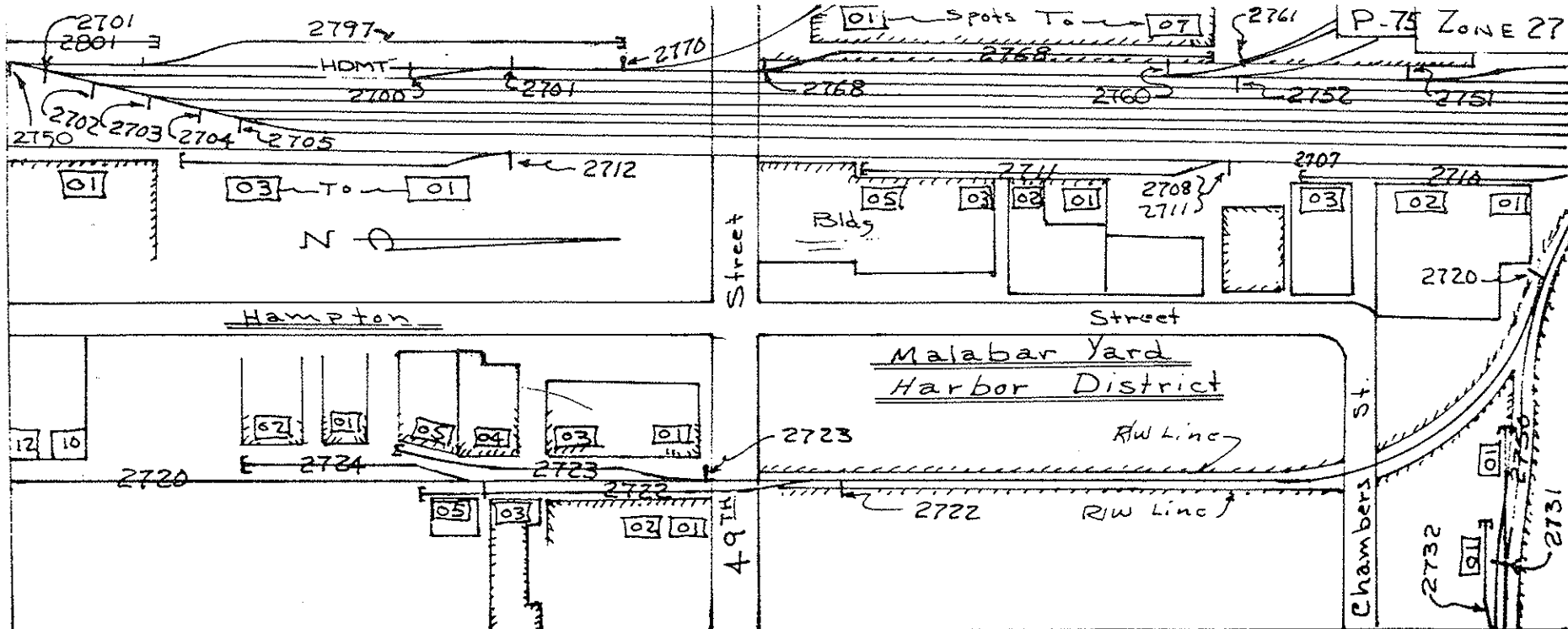

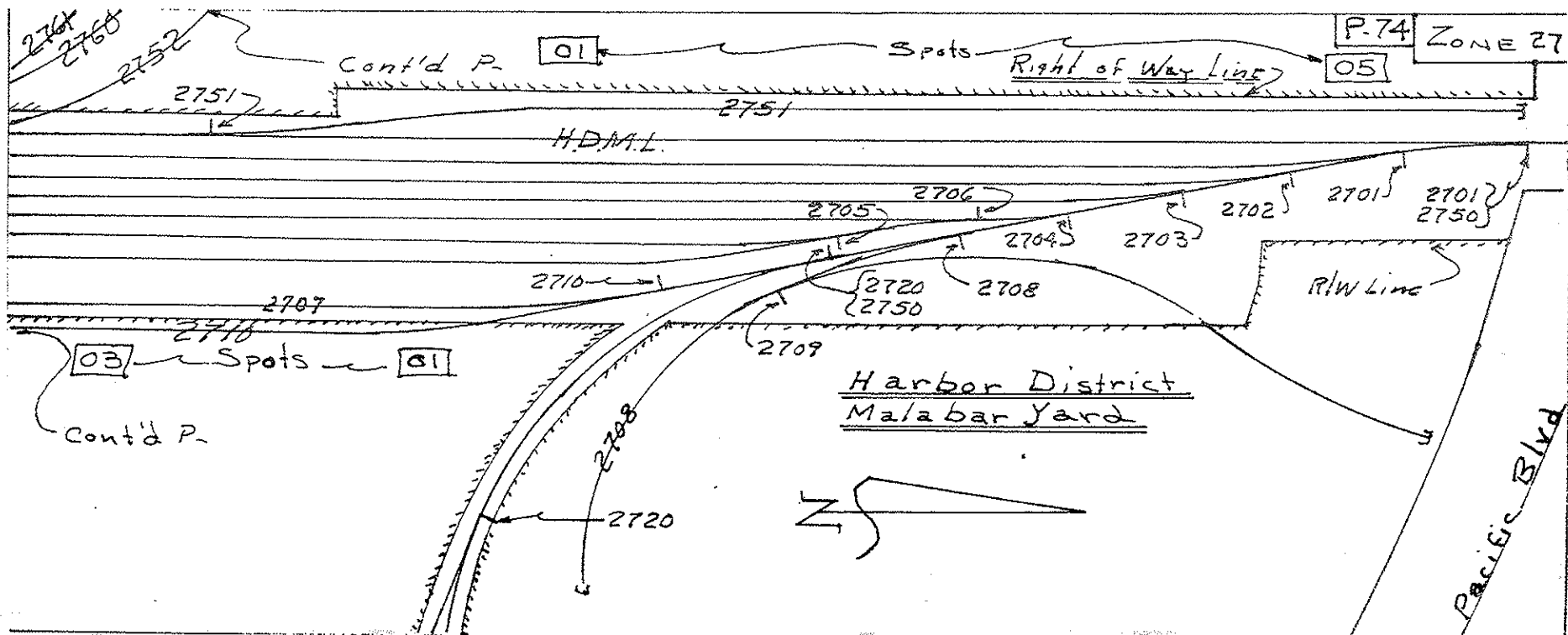
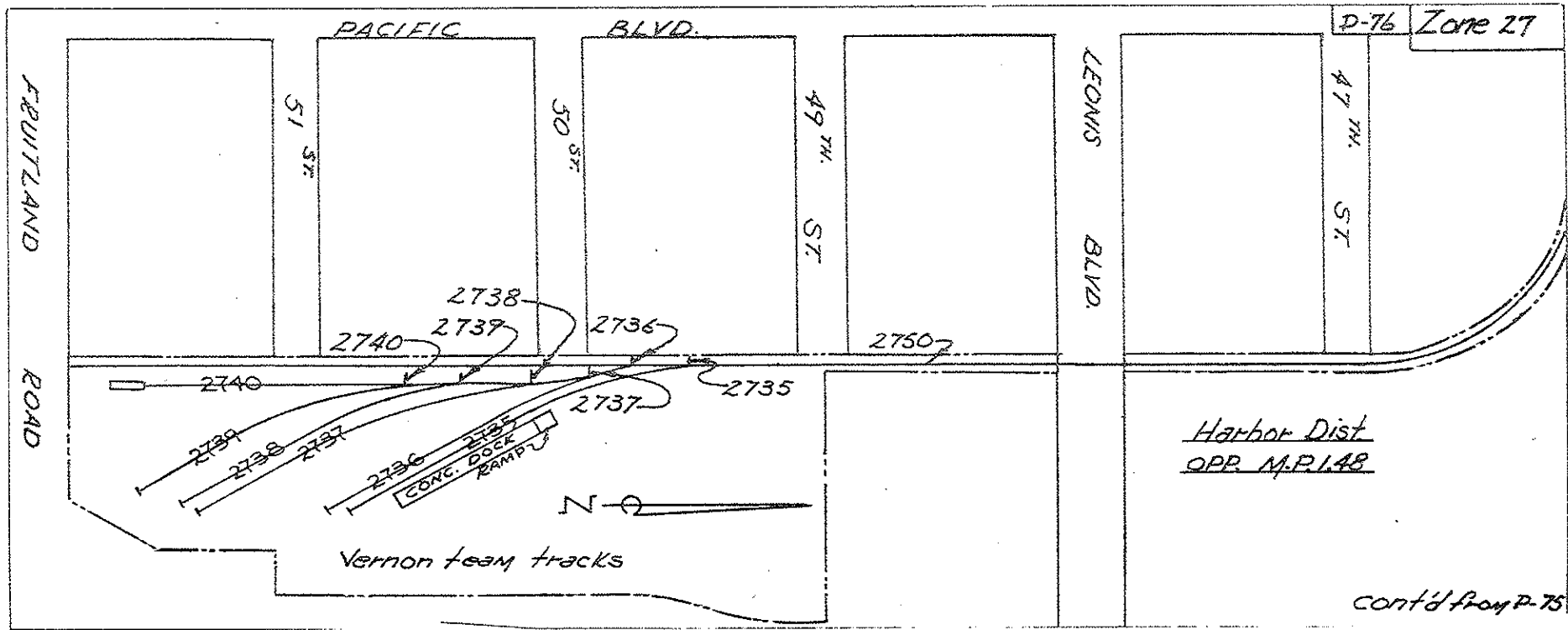

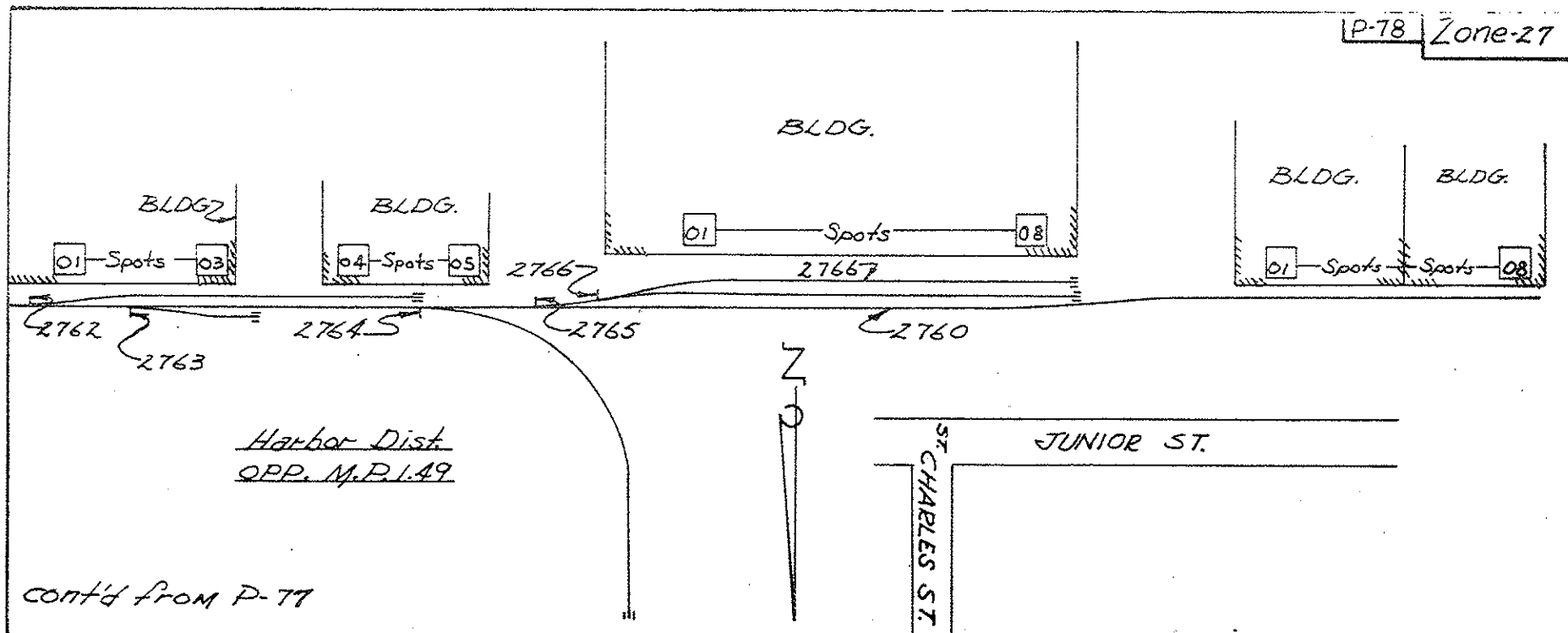
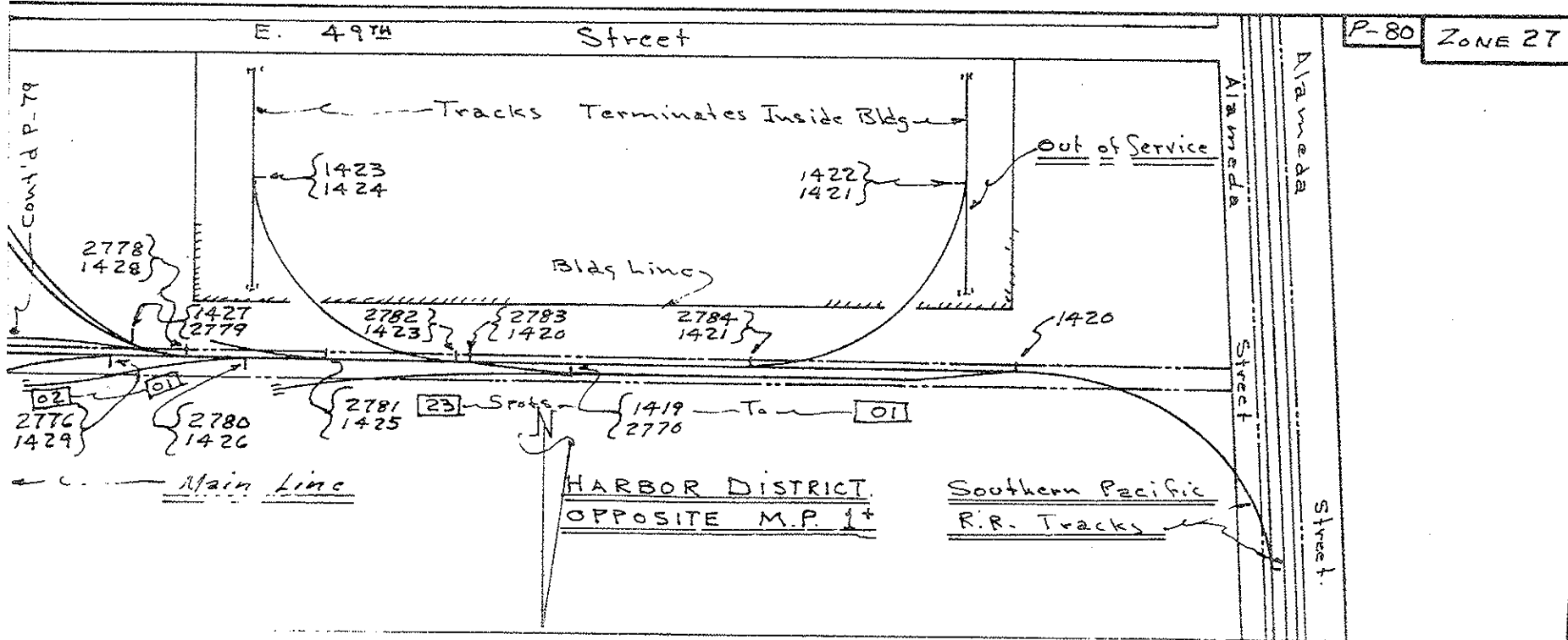

Cont'd Page -- 84

Holmes Street

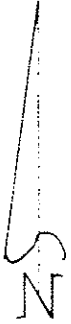

2824

Bandera Street

Wilmington Street

Alameda Street

Southern Pacific RR

Alameda Street

Center Ave.

Ave.

P.83

ZONE 28

Harbor District
M.P. 2+

1st Street

Cont'd from
Page - 82

H.D.M.L.7

Slauson

Ave

Slauson

Ave.

Stat 01 & 02

Street

Cont'd P. 82

2808

Street

56th

Malabar

Street

55th

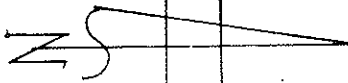

HARBOR DISTRICT

M.P. 2

Street

54th

Street

53rd

Street

52nd

P.81

ZONE 28

Harbor District Main Line

2803

2801

Fruitland Road

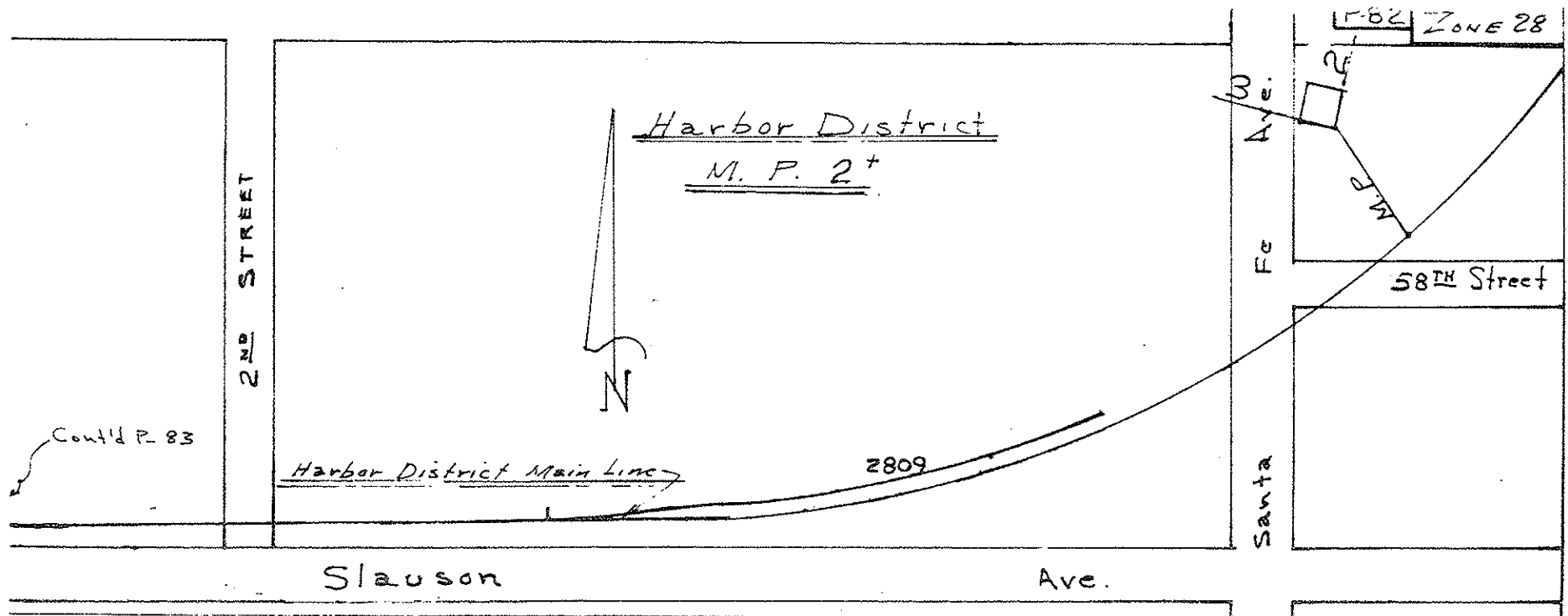
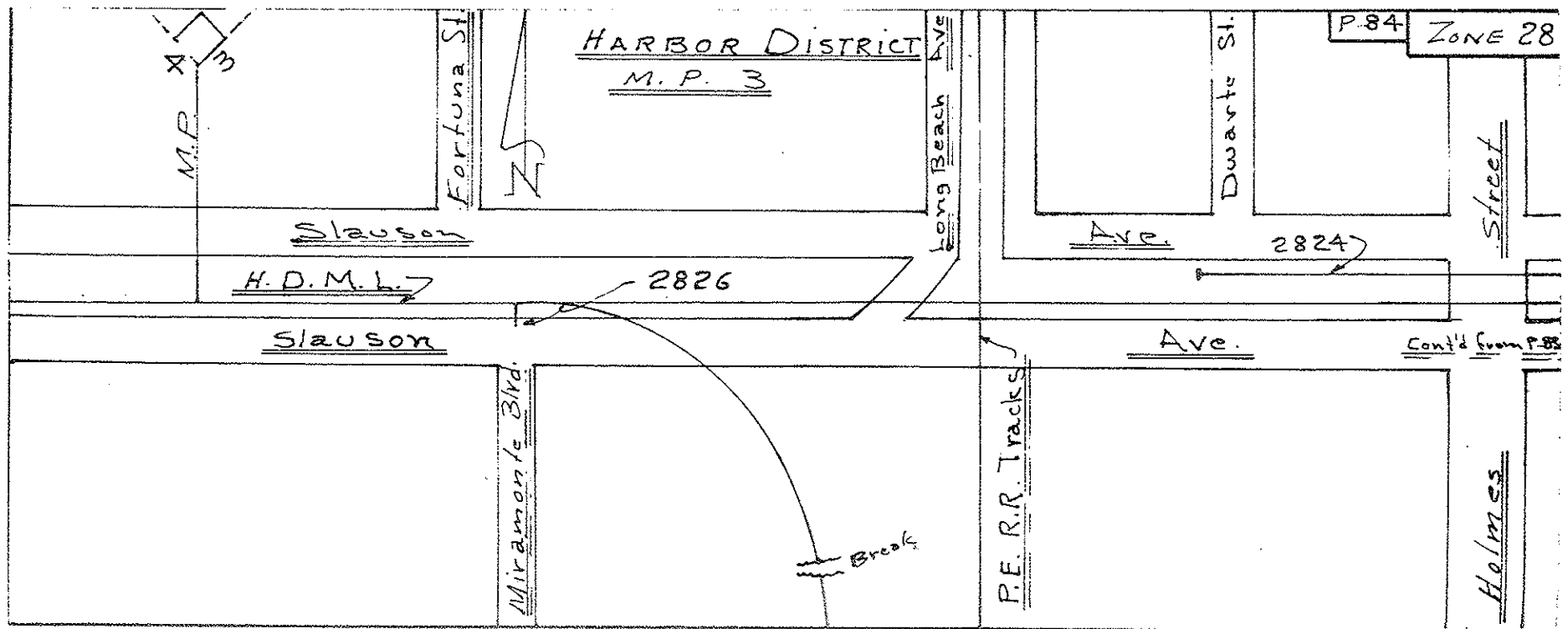

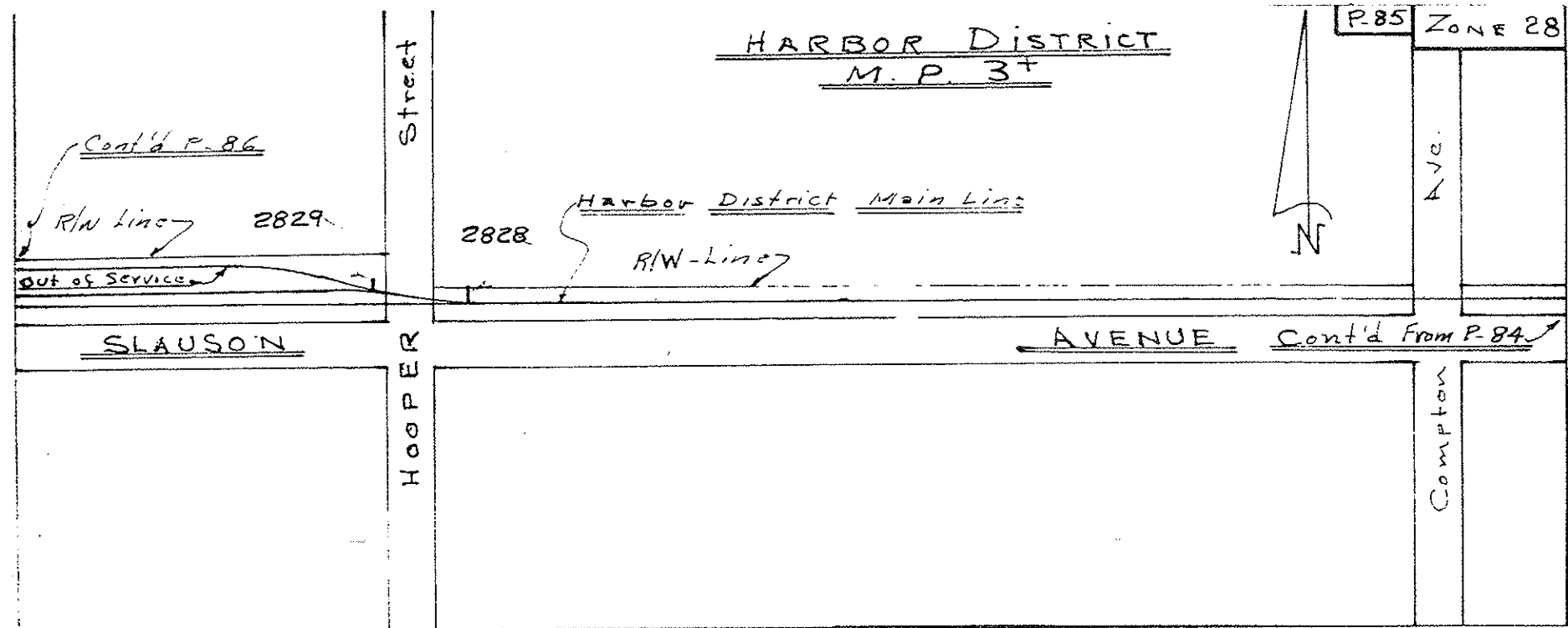
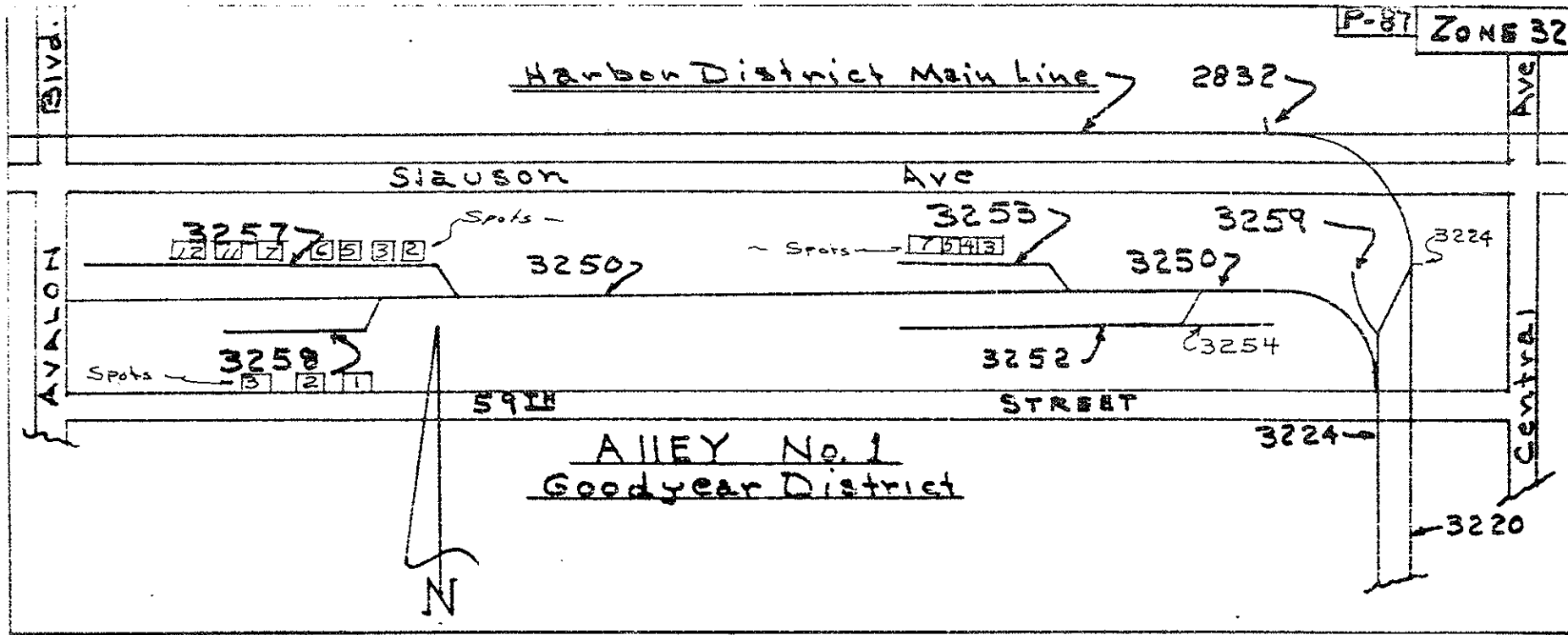

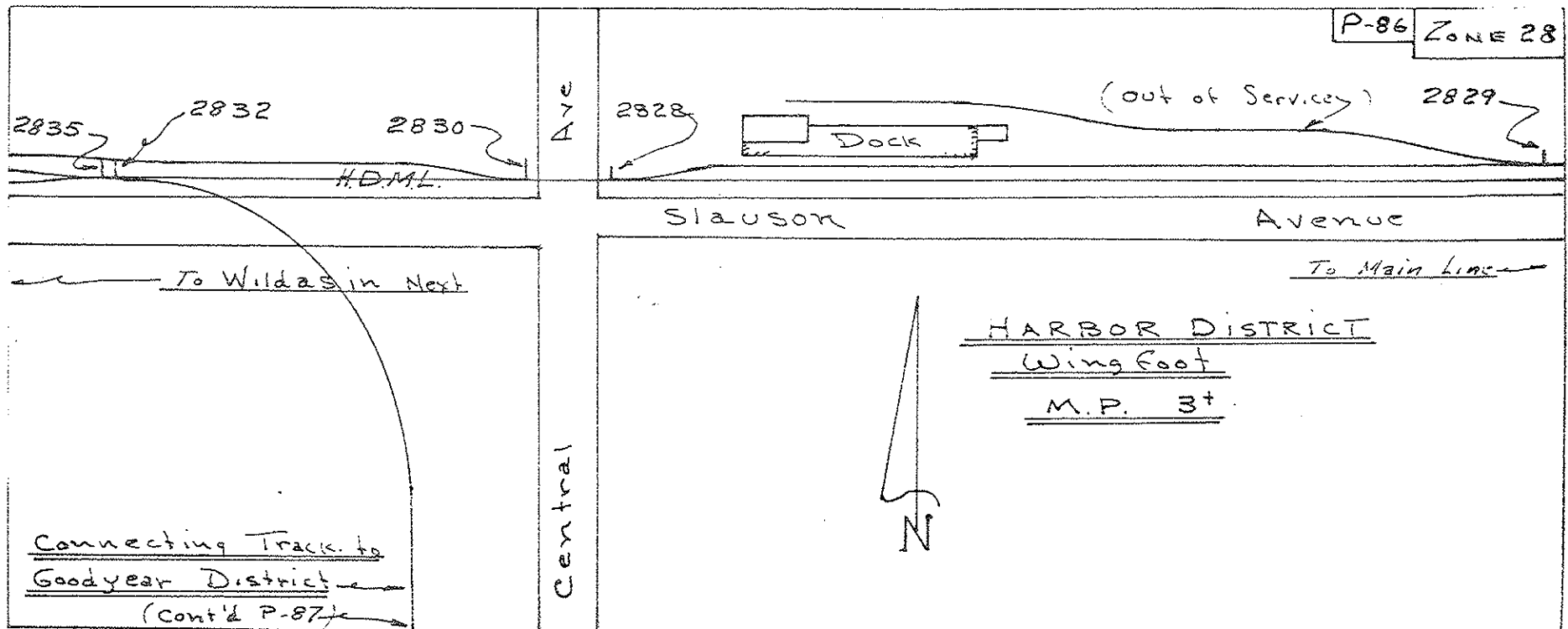
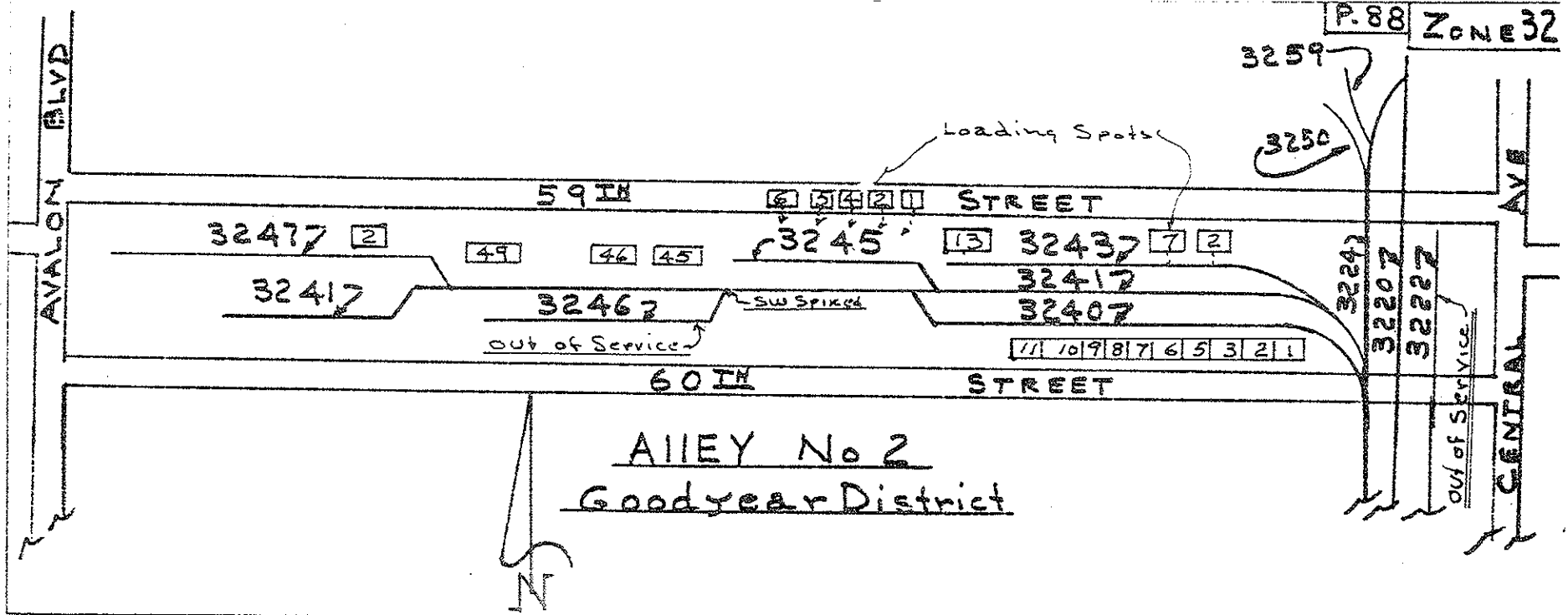

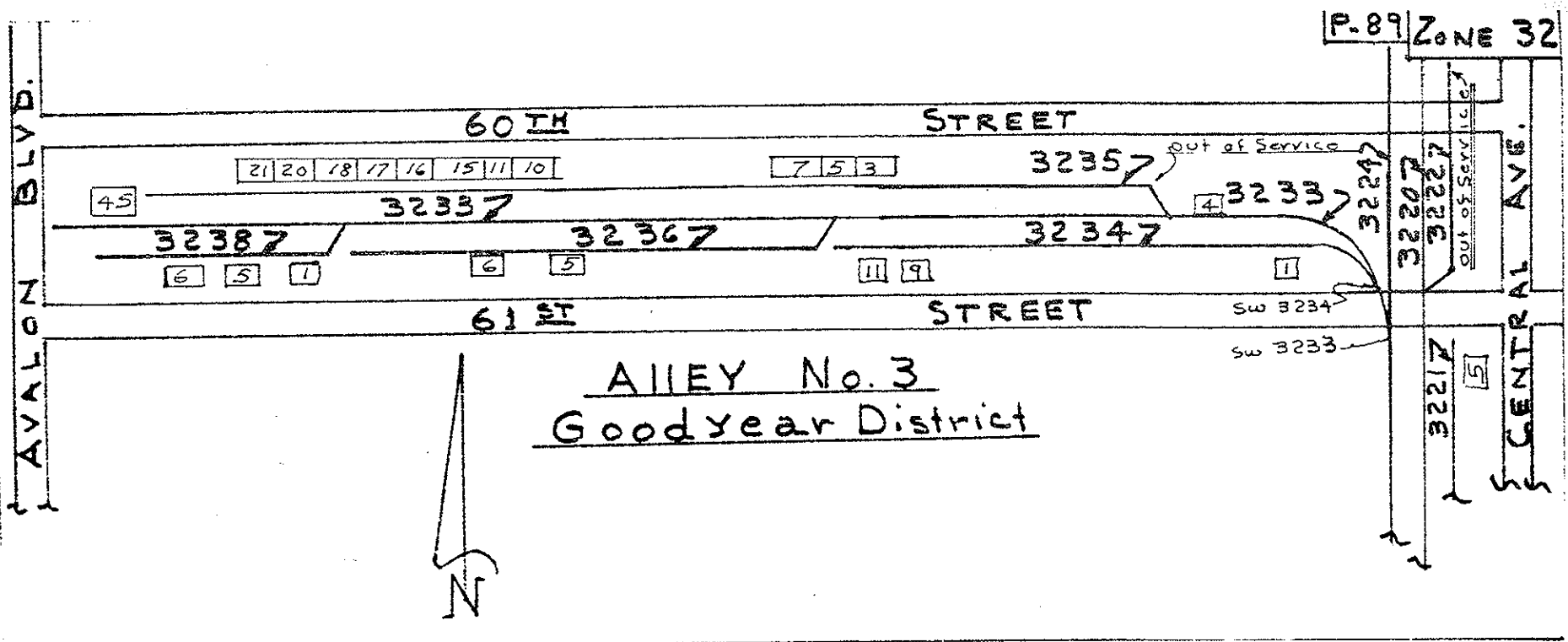
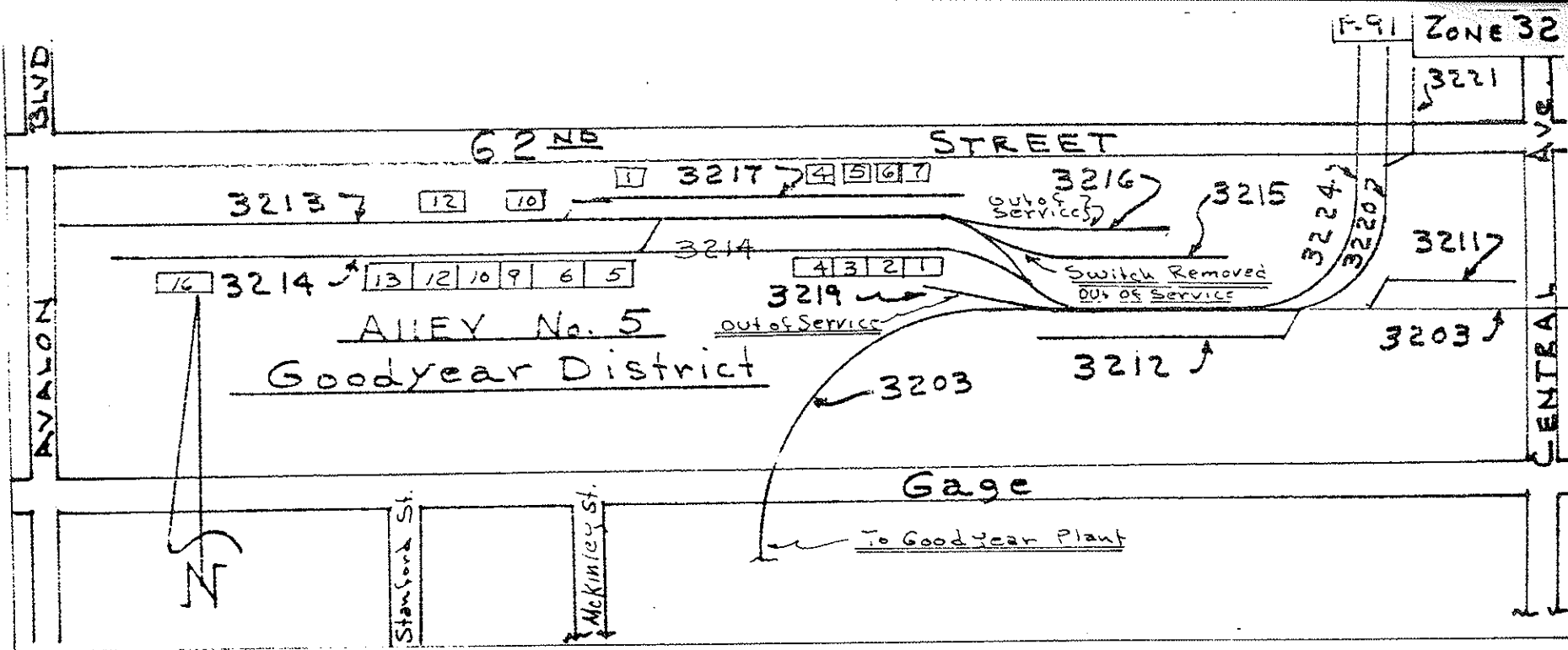

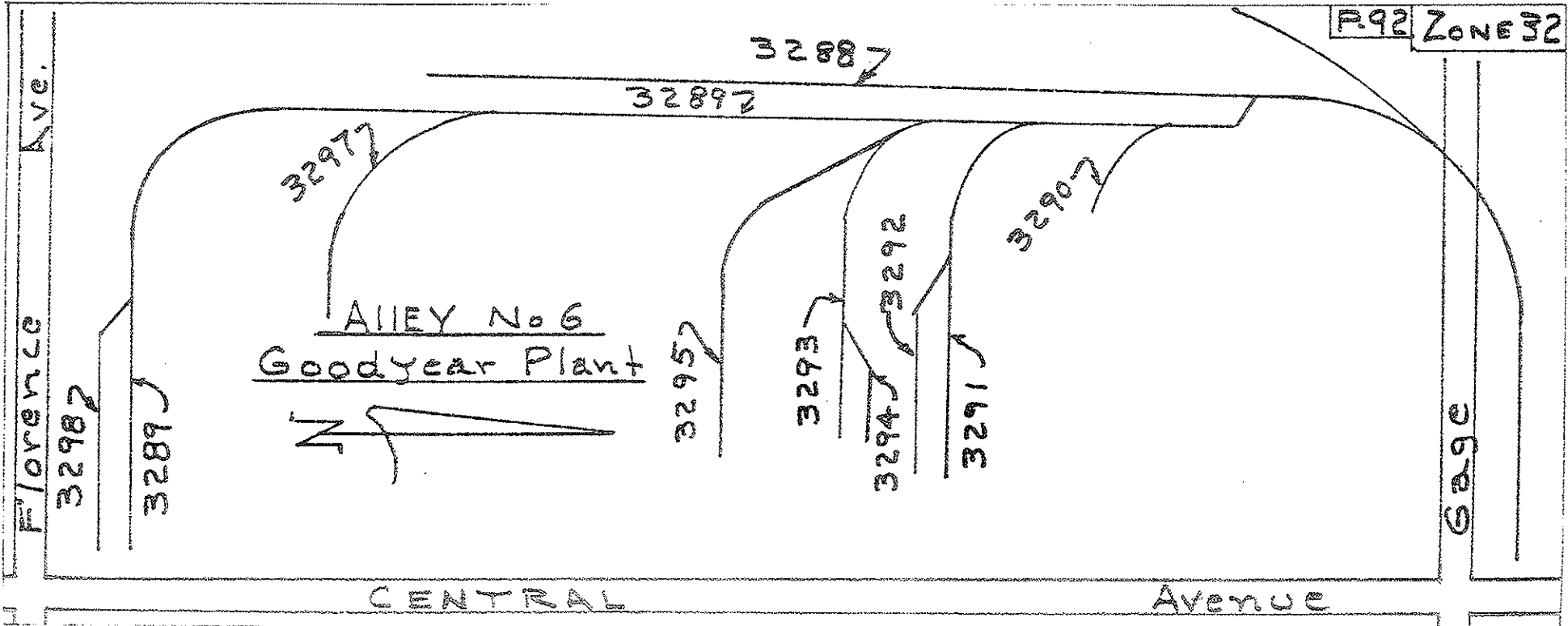

F-92 ZONE 32

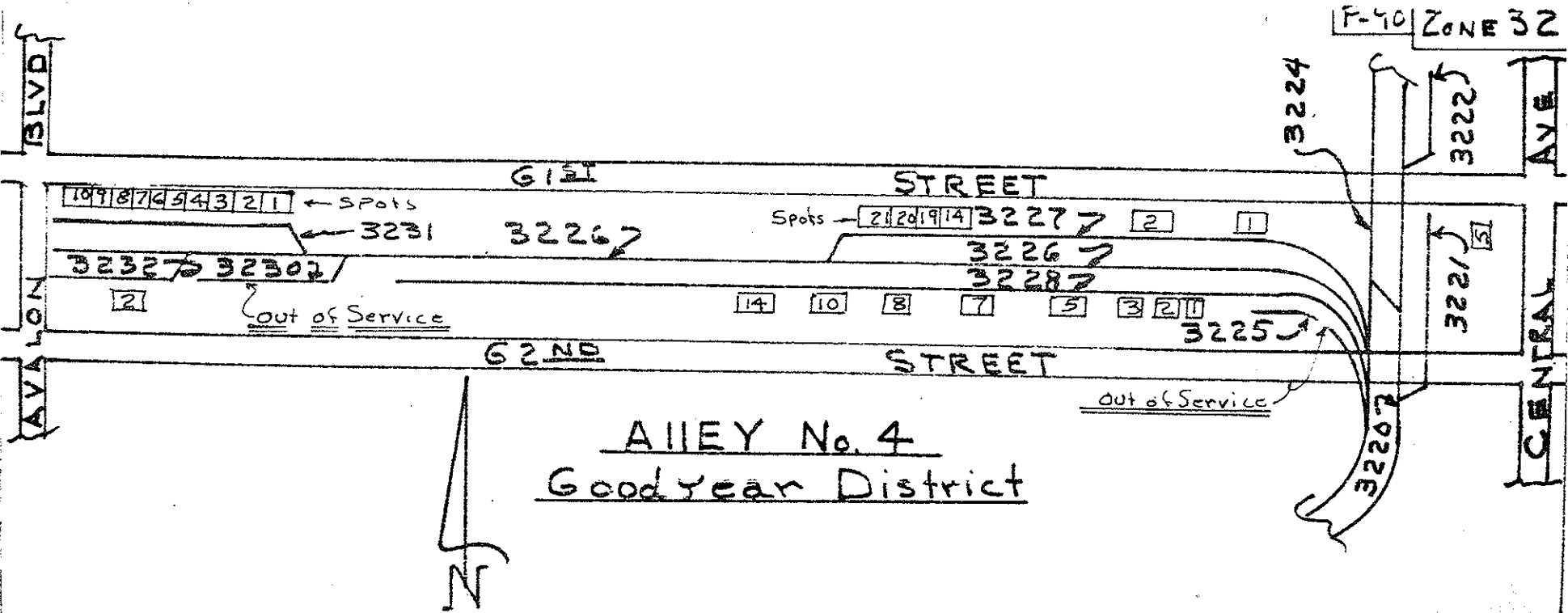

F-90 ZONE 32

ALLEY No 9
Goodyear District

P-95 ZONE 32

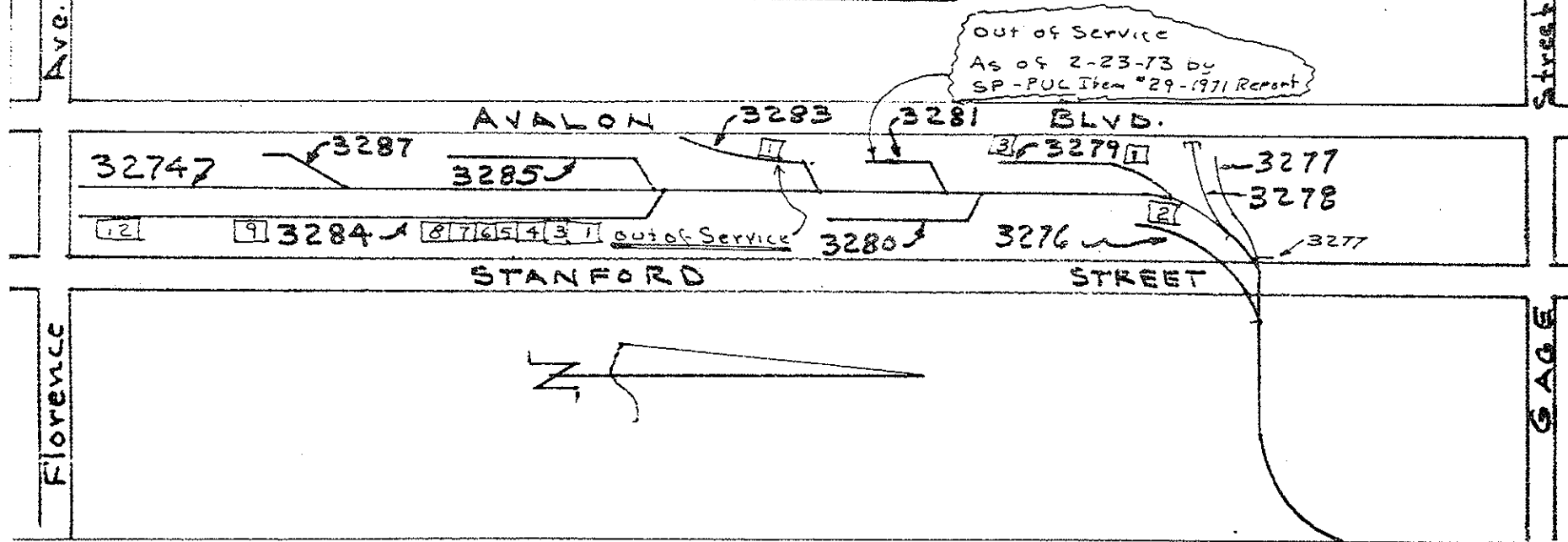

P-93 ZONE 32

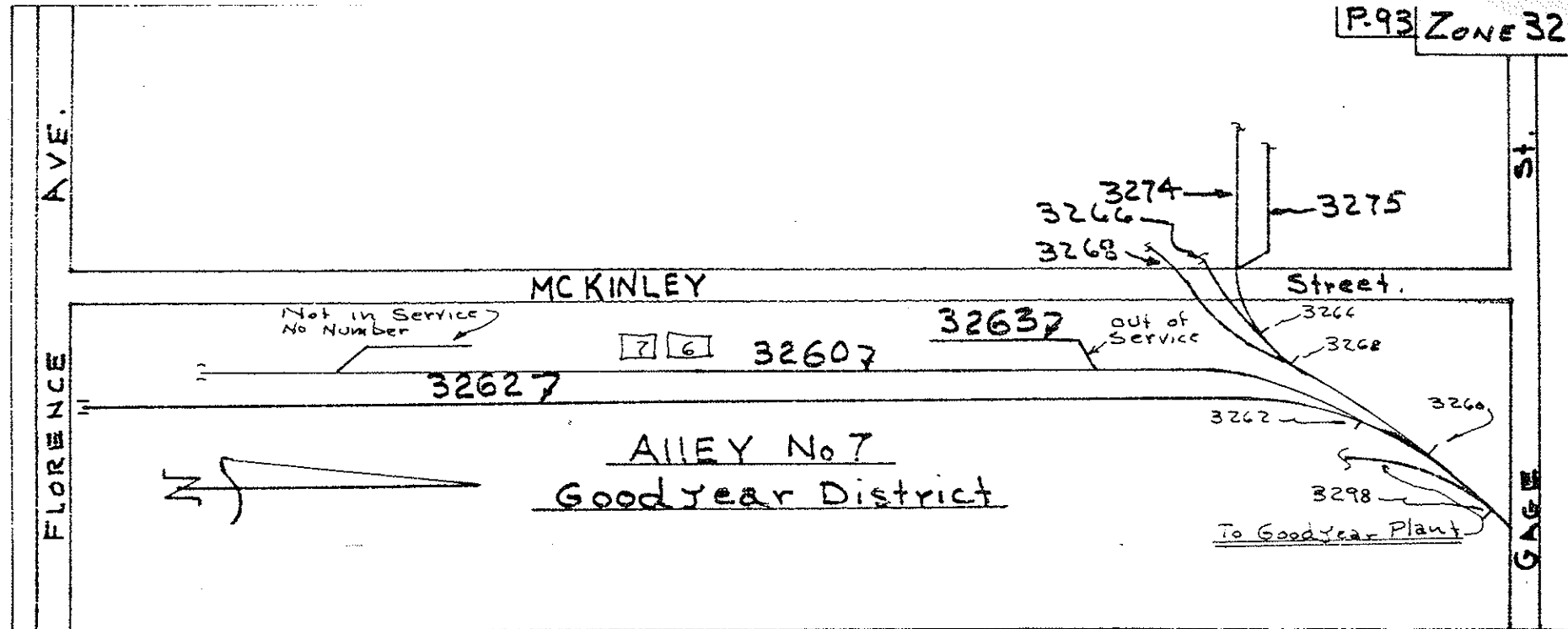

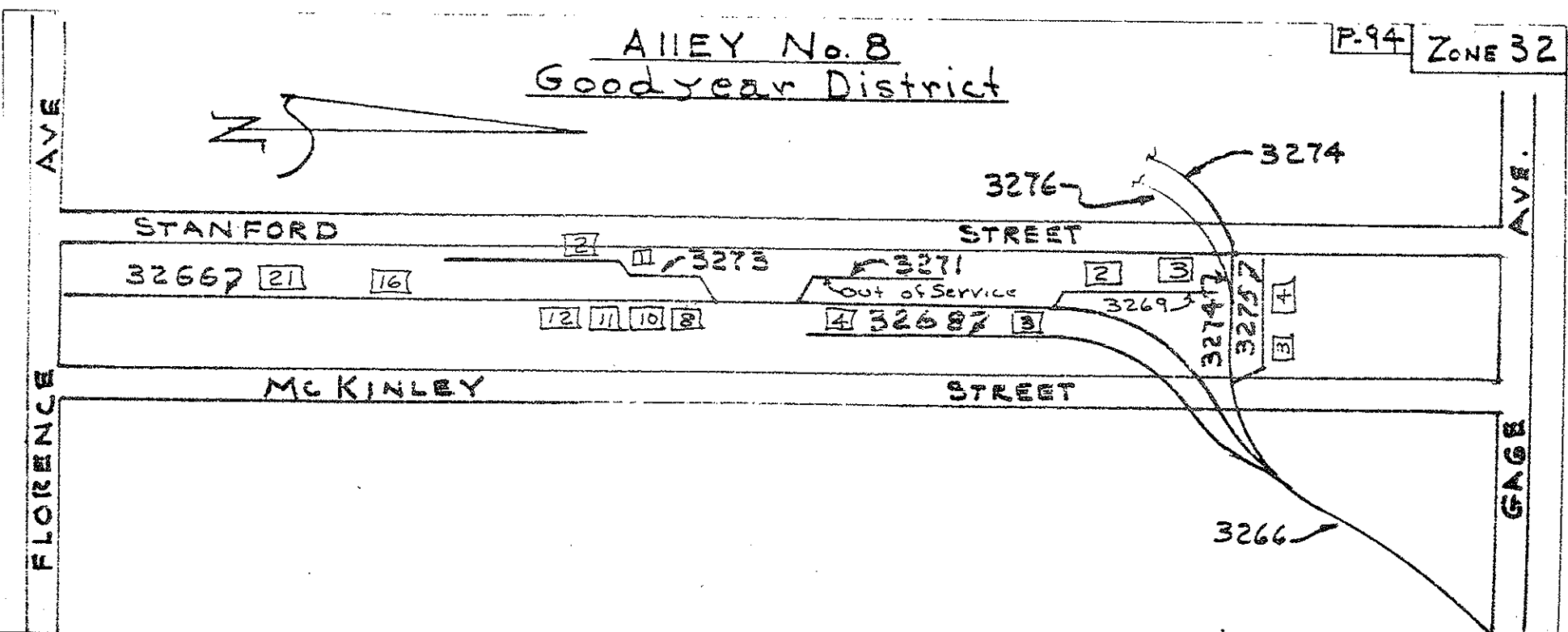
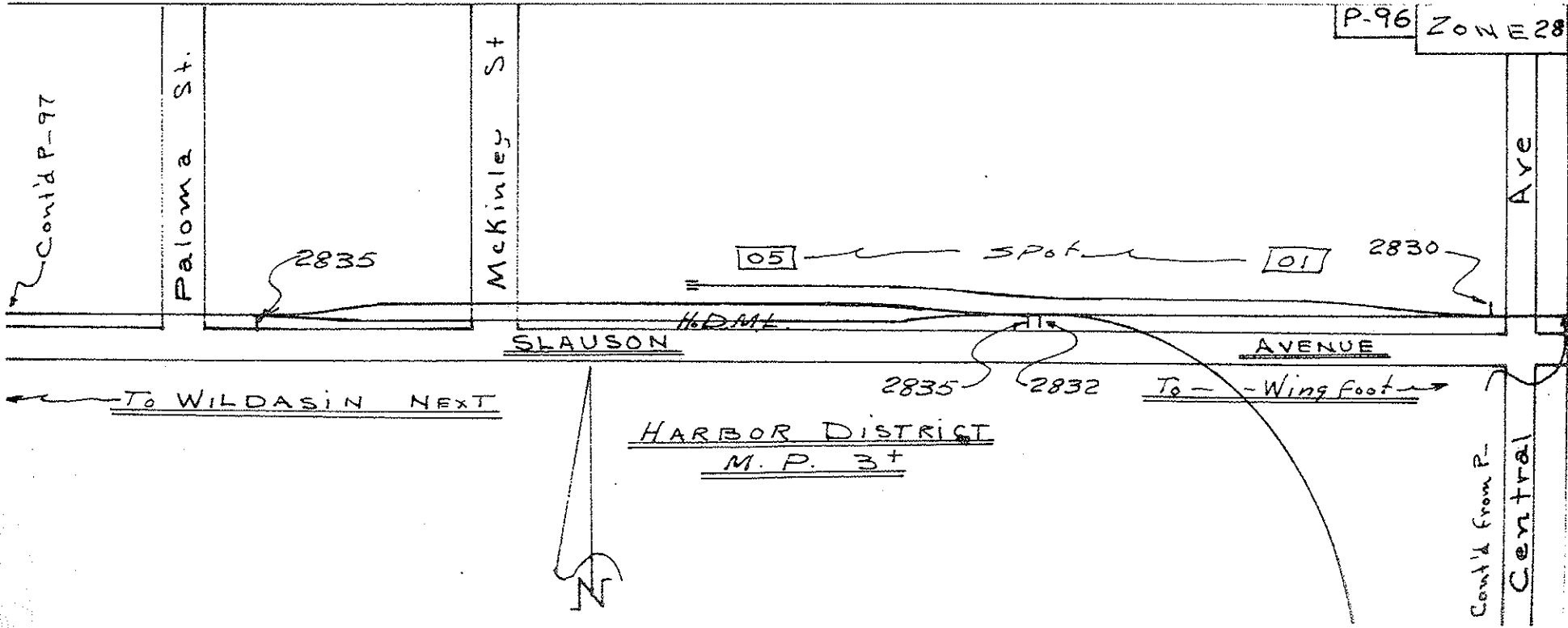

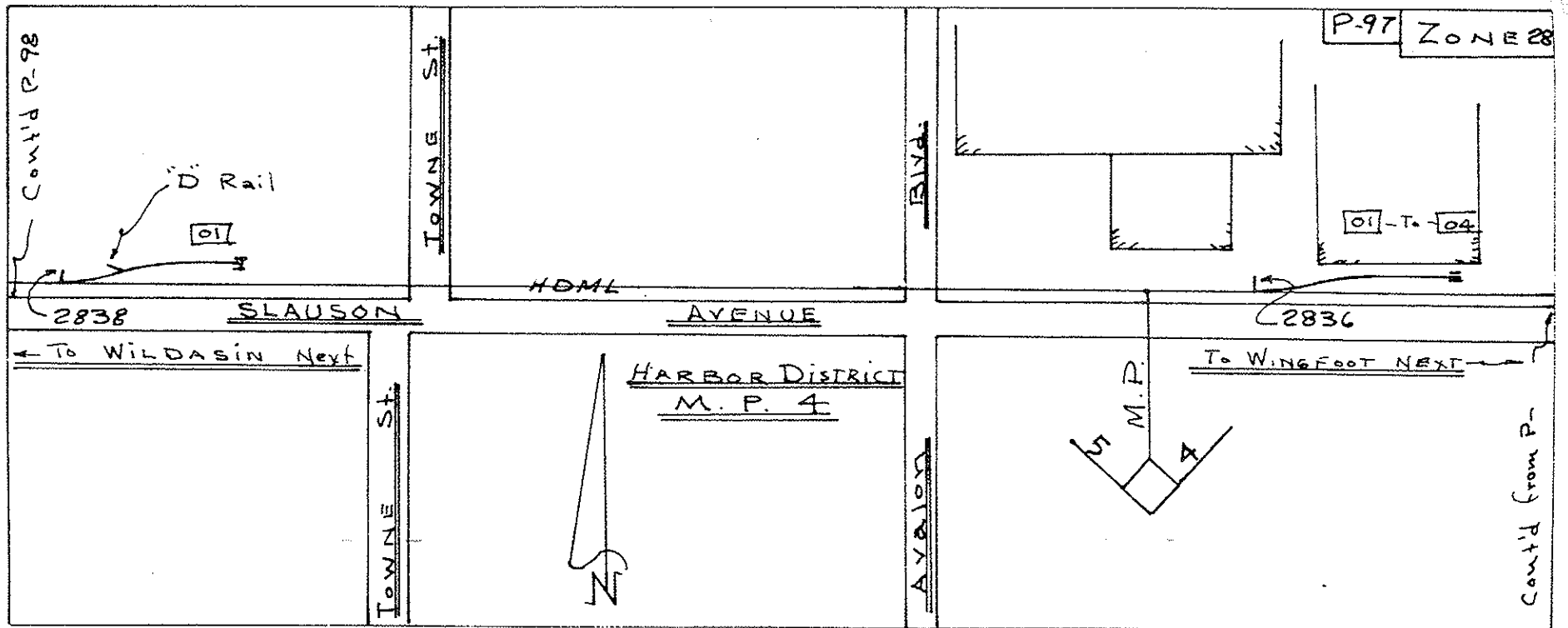
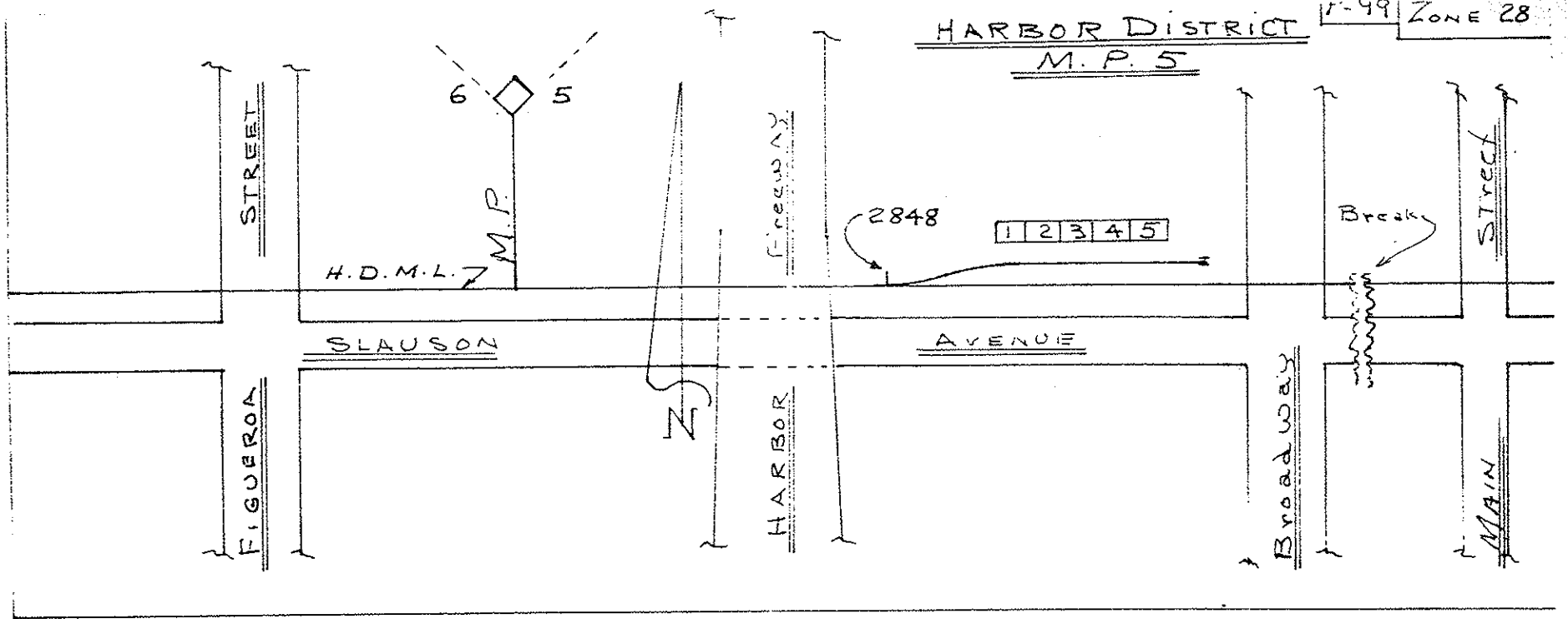

HARBOR District

M.P. 5+

P-100 ZONE 28

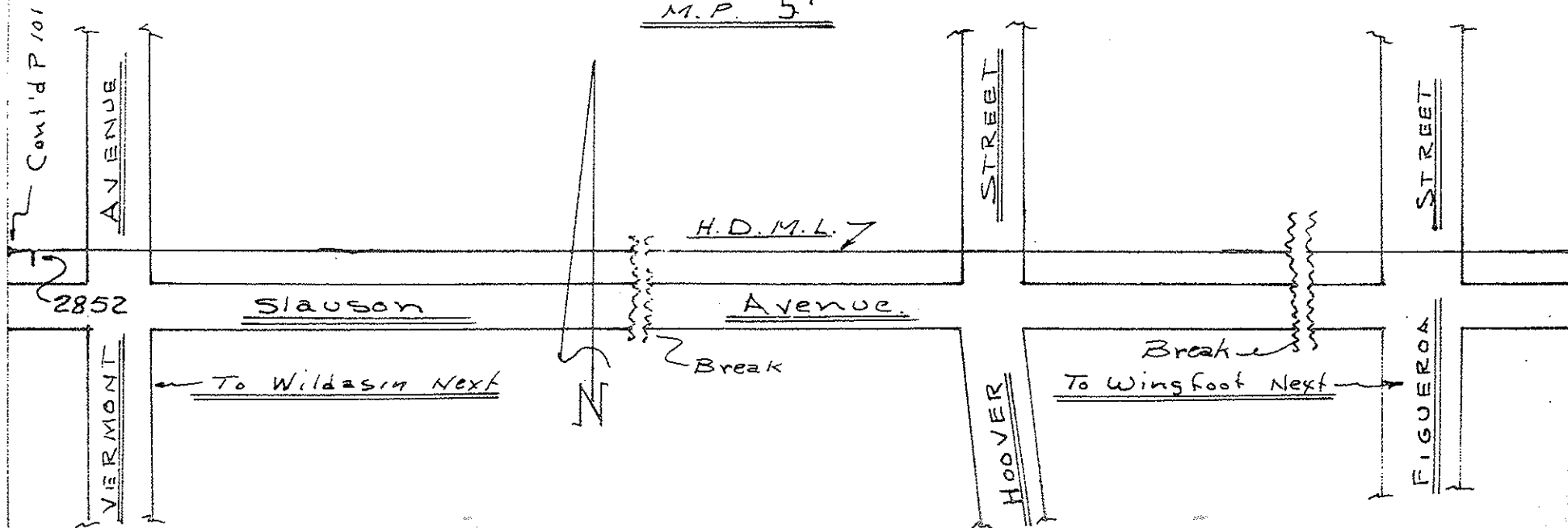

HARBOR DISTRICT

M.P. 4+

P-98 ZONE 28

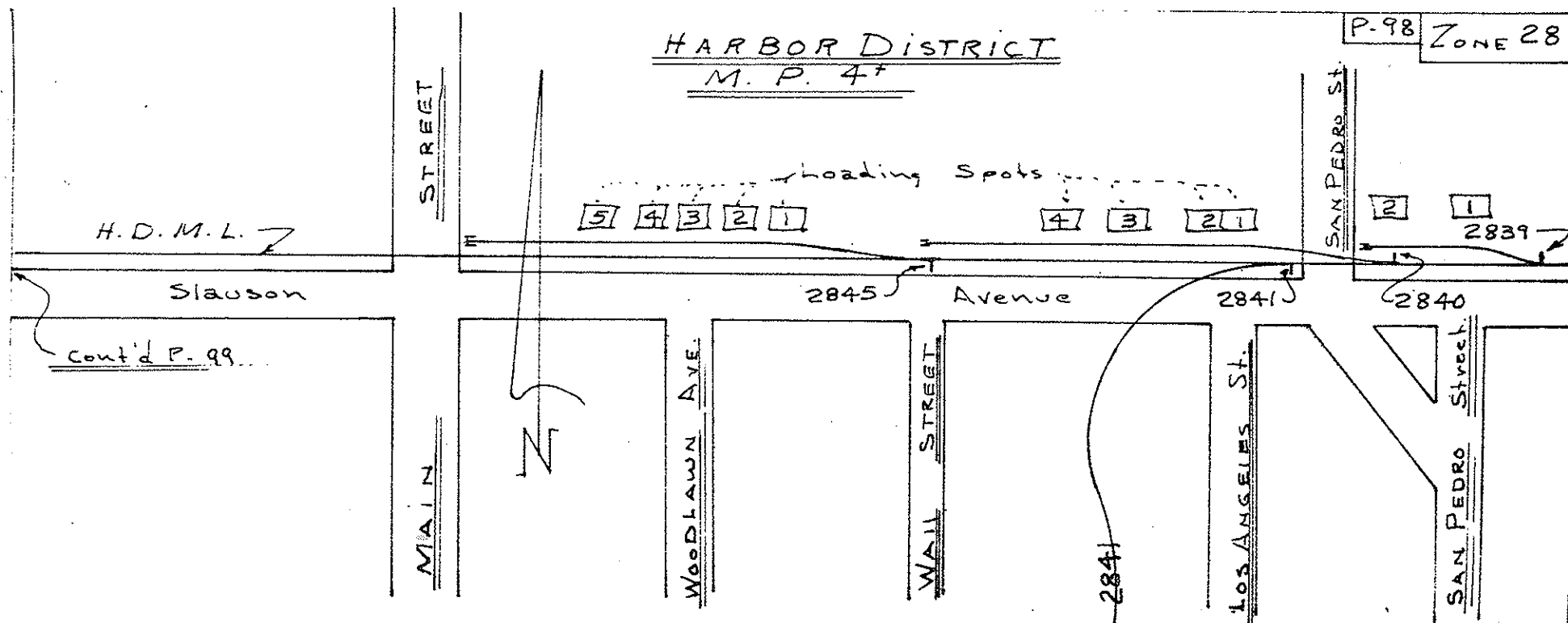

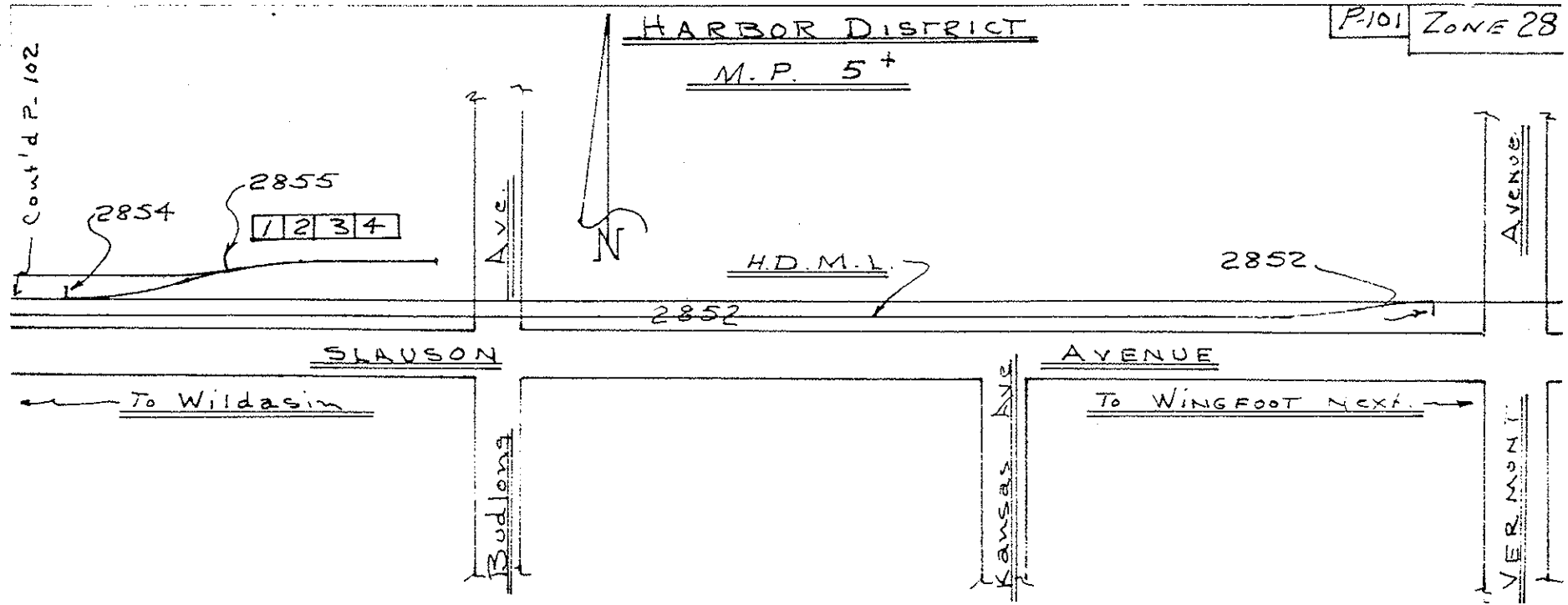
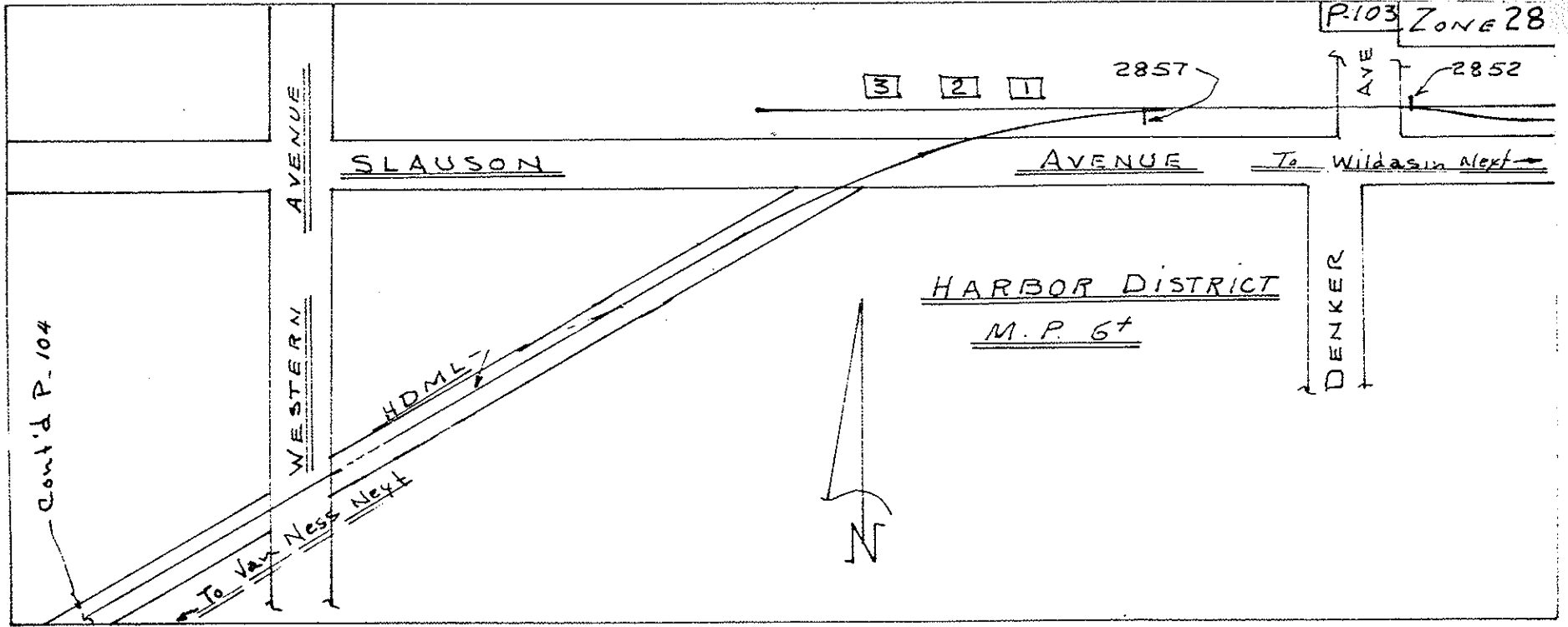

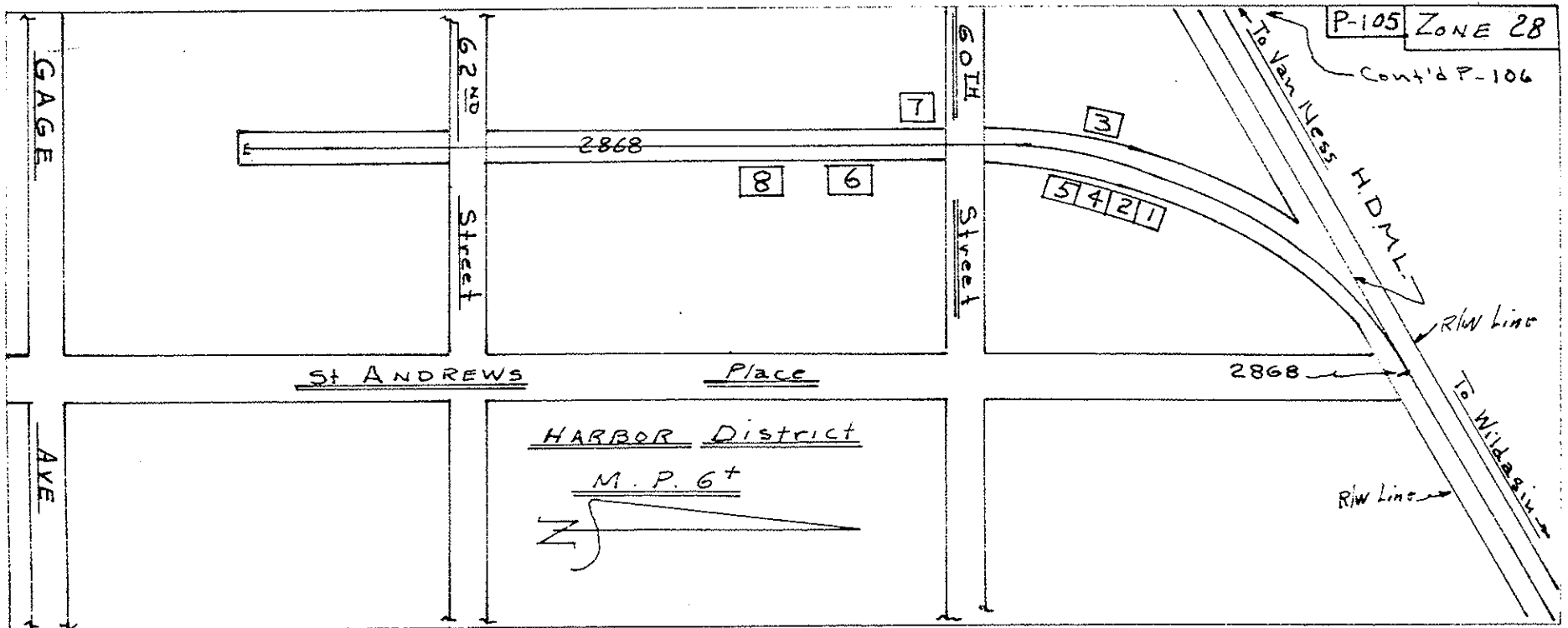
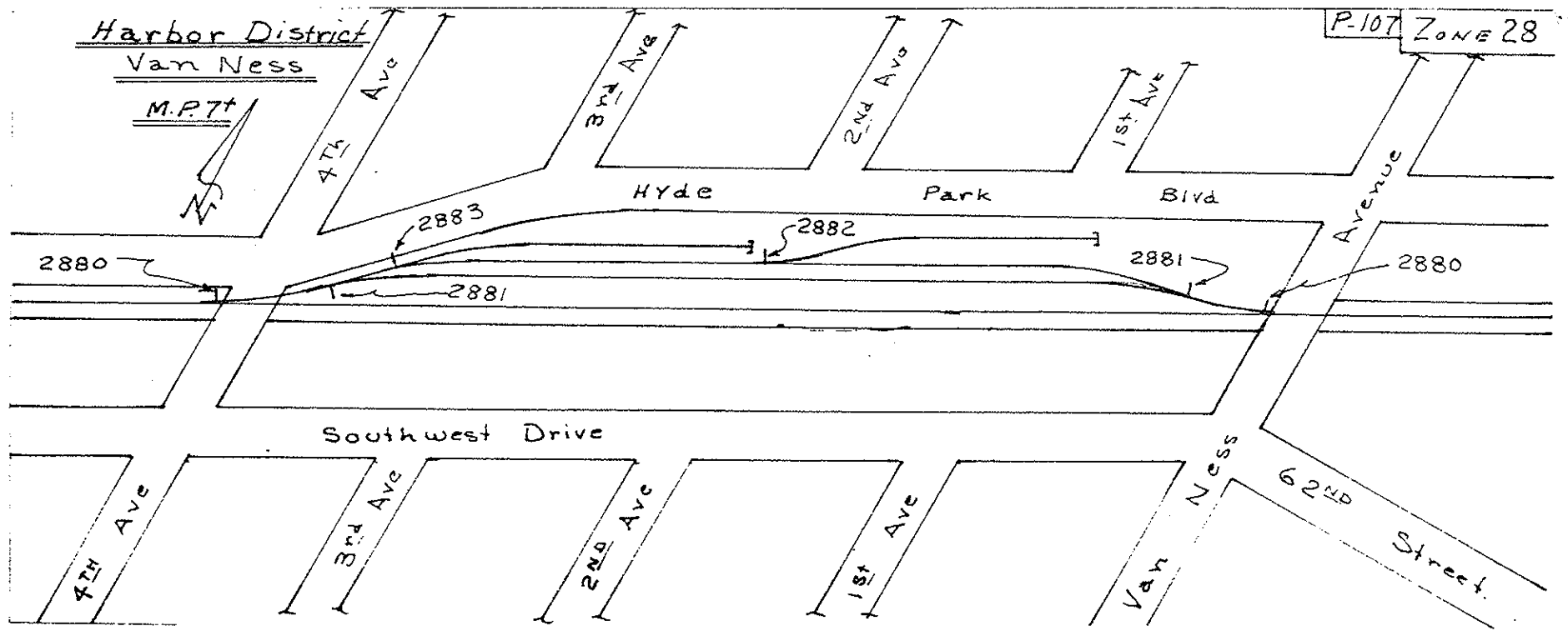

P-108 ZONE 28

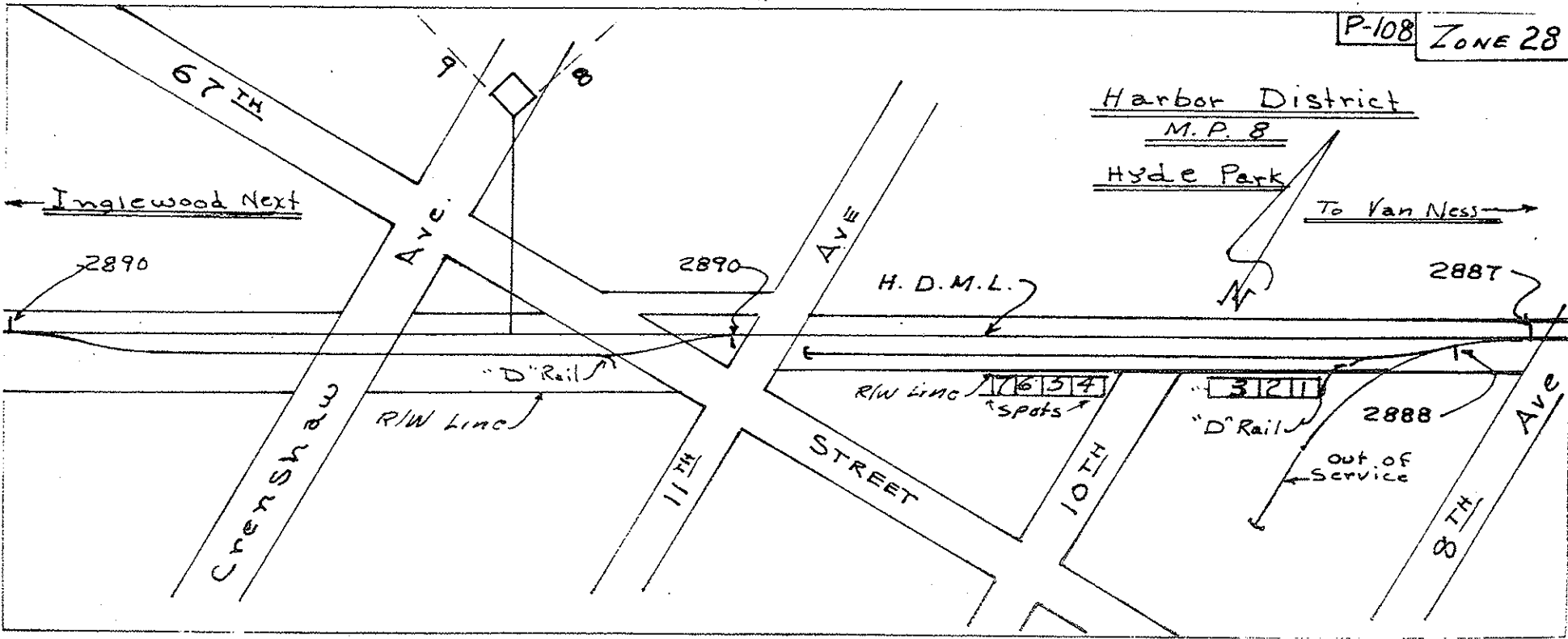

P-106 ZONE 28

