





895

894

893

892

891

890

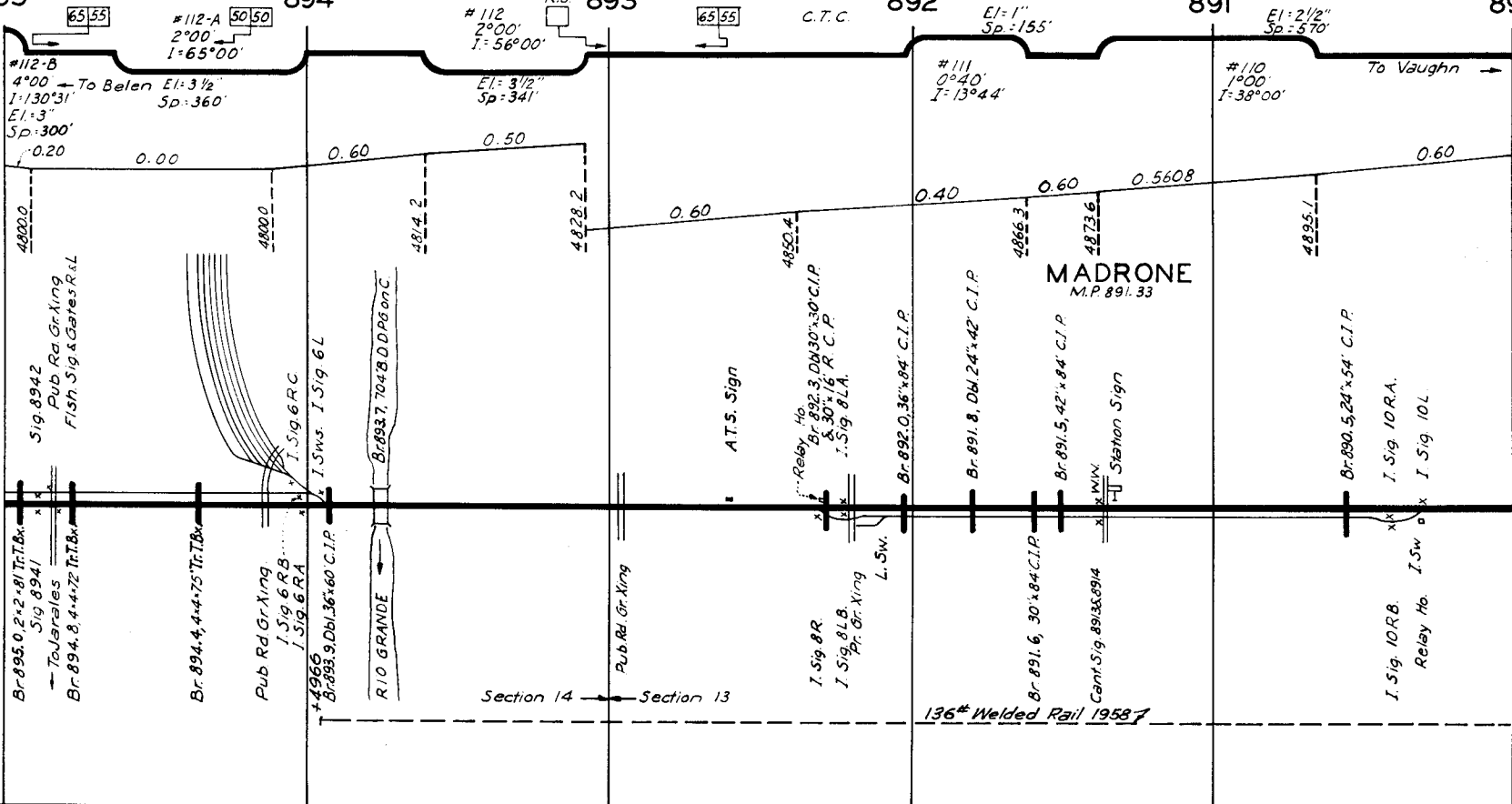

#112-B  
 4°00' → To Belen El.: 3 1/2'  
 1:130°31'  
 El.: 3'  
 Sp.: 300'

#112  
 2°00'  
 1:56°00'  
 El.: 3 1/2'  
 Sp.: 341'

#111  
 0°40'  
 1:13°44'

#110  
 1°00'  
 1:38°00'

**MADRONE**  
 M.P. 891.33

RIO GRANDE

Section 14 ← Section 13

136# Welded Rail 1958

4800.0

4800.0

4814.2

4828.2

4850.4

4866.3

4873.6

4895.1

Sig. 8942  
 Pub Rd Gr. King  
 Fish Sig. Gates R.S.L.

I. Sig. 6 RC  
 I. Sws. I. Sig. 6 L

Br. 893.9, Dbl. 36'x60' C.I.P.

Pub. Rd. Gr. King

A.T.S. Sign

I. Sig. 8 R  
 I. Sig. 8 L B  
 Pr. Gr. King  
 L. S.W.

Relay Ho.  
 Br. 892.3, Dbl. 30'x30' C.I.P.  
 S. 30'x16' R. C.P.  
 I. Sig. 8 L A.

Br. 892.0, 36'x84' C.I.P.

Br. 891.8, Dbl. 24'x42' C.I.P.

Br. 891.5, 42'x84' C.I.P.

Station Sign

Br. 890.5, 24'x54' C.I.P.

I. Sig. 10 R A.  
 Relay Ho. I. Sw. I. Sig. 10 L

Br. 895.0, 2'x2'x81' Tr. T.B.x

Sig. 8941

To Jarales

Br. 894.8, 4'x4'x72' Tr. T.B.x

Br. 894.4, 4'x4'x75' Tr. T.B.x

Pub Rd Gr. King

I. Sig. 6 R B

I. Sig. 6 R A

+4965



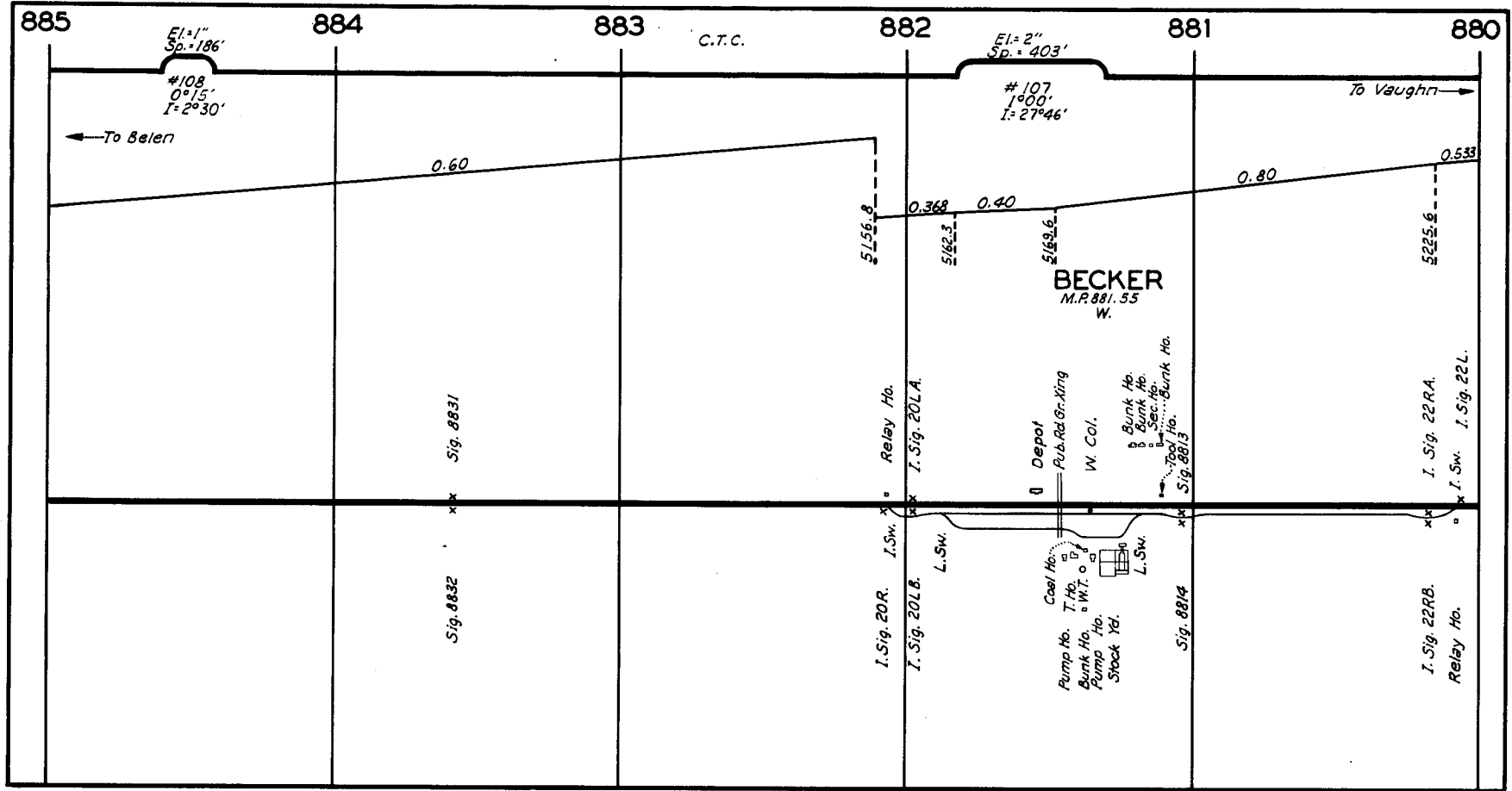

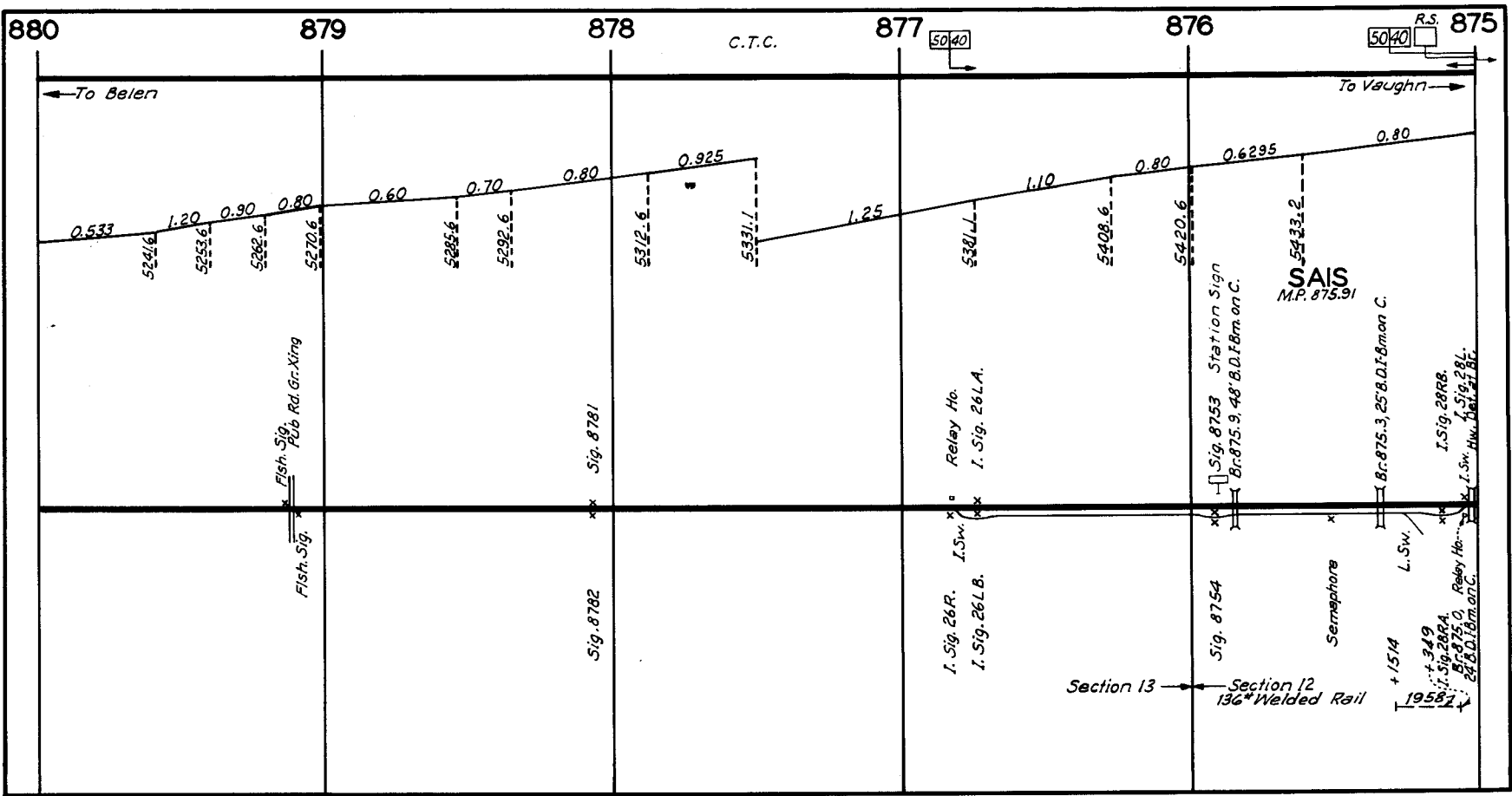

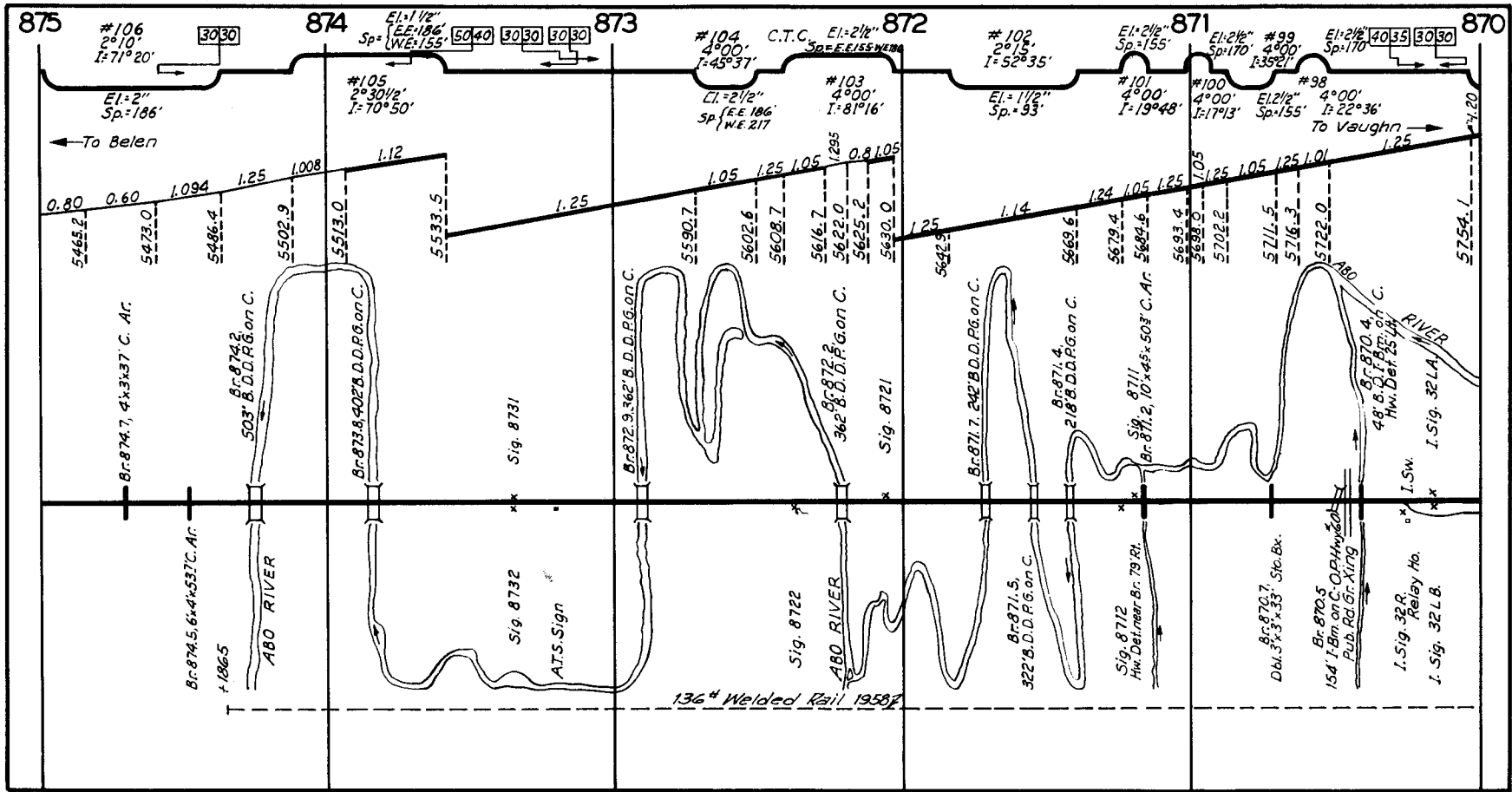

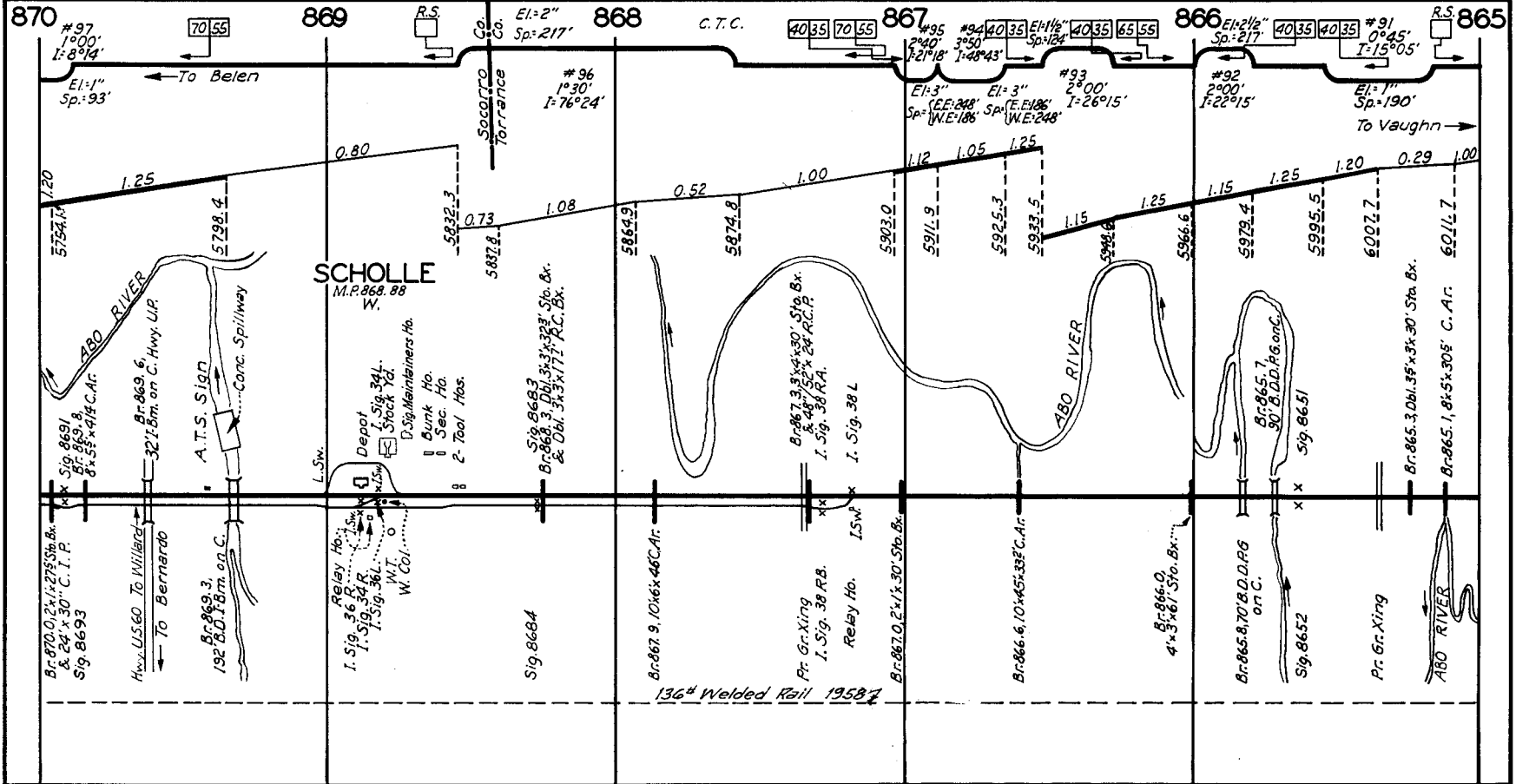



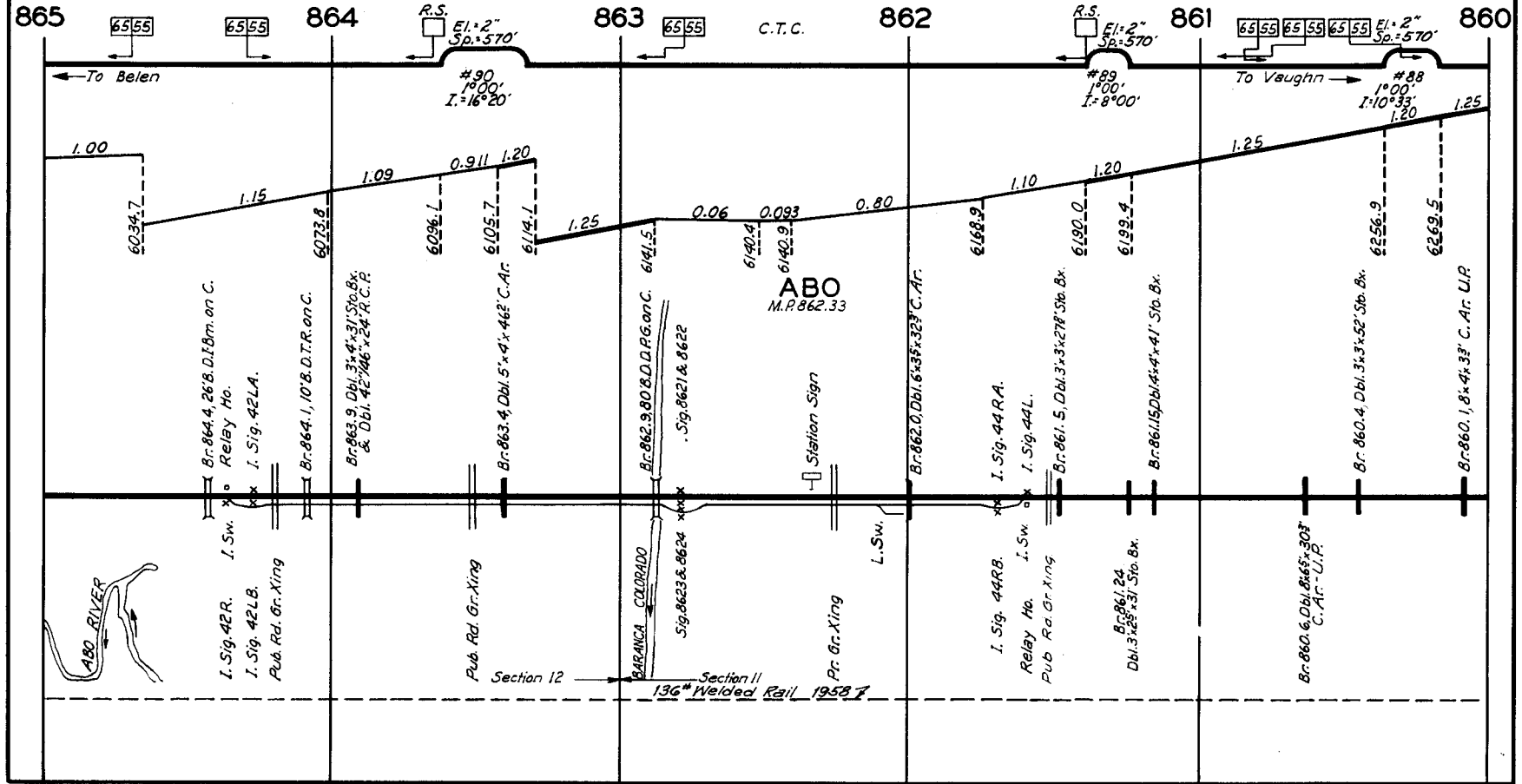

865

6555

6555

864

R.S.

EI: 2"  
Sp: 570'  
#90  
1'00'  
I: 16°20'

863

6555

C.T.C.

862

R.S.

EI: 2"  
Sp: 570'  
#89  
1'00'  
I: 8°00'

861

6555

6555

6555

EI: 2"  
Sp: 570'  
#88  
1'00'  
I: 10°33'

860

To Belen

To Vaughn

1.00

6034.7

1.15

6073.8

1.09

6096.1

0.91

6105.7

1.25

6114.1

0.06

6140.4

6142.9

ABO  
M.P. 862.33

0.80

6168.9

1.10

6190.0

6199.4

1.25

6256.9

1.20

6269.5



I. Sig. 42R. I. Sw. x  
I. Sig. 42LB. x  
Pub. Rd. Gr. Xing

Br. 864.4, 26'8" D.I.Bm. on C.  
Relay Ho.  
I. Sig. 42LA.

Br. 864.1, 10'8" D.T.R. on C.

Br. 863.9, Dbl. 3'x4'x31' Sto. Bx.  
& Dbl. 42'x46'x24' R.C.P.

Pub. Rd. Gr. Xing

Section 12

BARANCA COLORADO  
Sig. 862.9 & 862.4 x  
Sig. 862.1 & 862.2

Br. 862.9, 80'8" D.D.R.G. on C.

Pr. Gr. Xing  
L. Sw.

Station Sign

Br. 862.0, Dbl. 6'x3'x32' C.A.

I. Sig. 44RB. x  
Relay Ho. I. Sw. x

Pub. Rd. Gr. Xing

Br. 861.5, Dbl. 3'x3'x27' Sto. Bx.

Br. 861.24  
Dbl. 3'x3'x31' Sto. Bx.

Br. 861.15, Dbl. 4'x4'x41' Sto. Bx.

Br. 860.6, Dbl. 8'x5'x30'  
C.A.-U.P.

Br. 860.4, Dbl. 3'x3'x52' Sto. Bx.

Br. 860.1, 8'x4'x33' C.A. U.P.

Section 11  
136" Welded Rail 1952

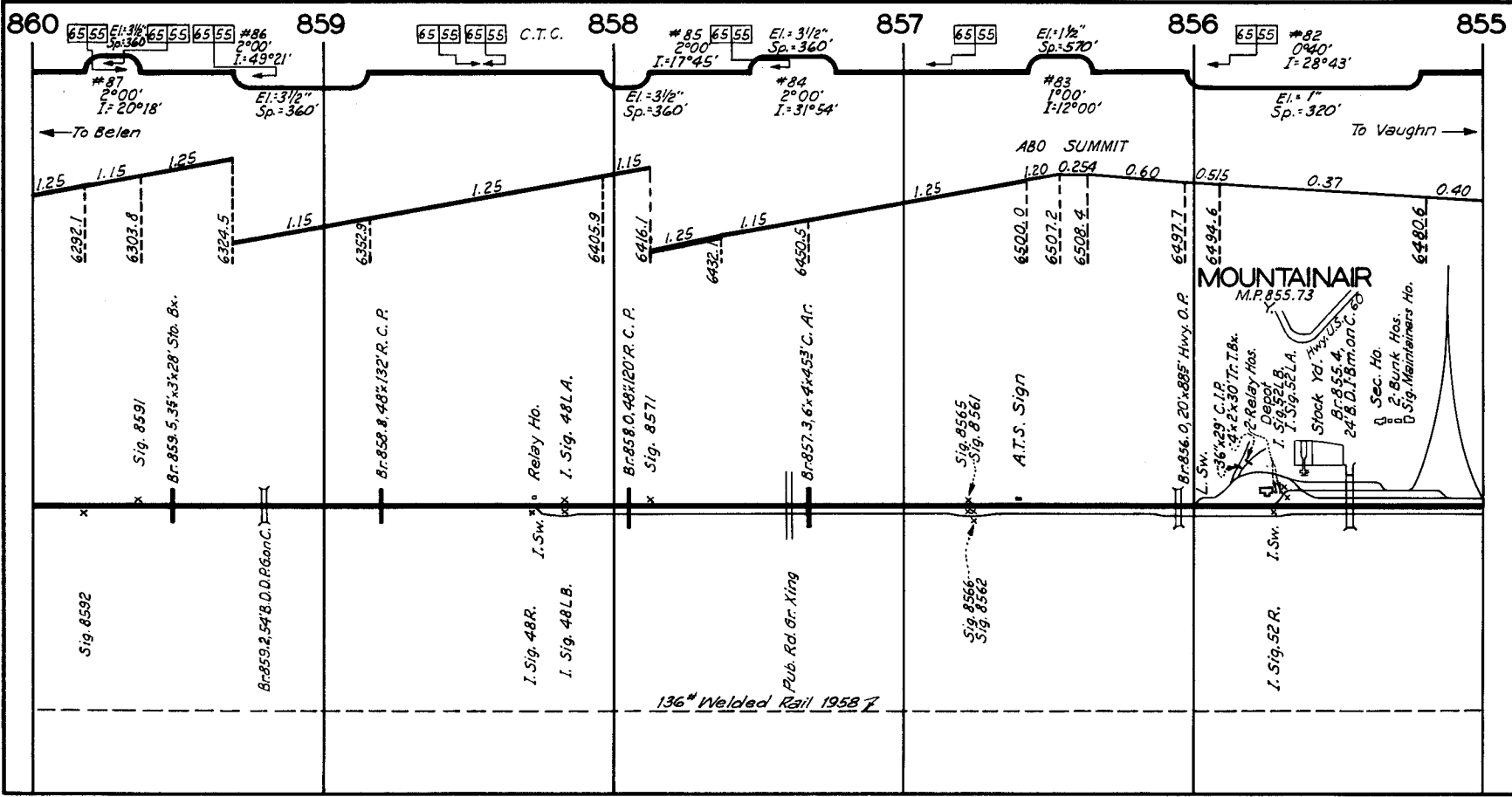

860 859 858 857 856 855

65 55 El: 3 1/2" Sp: 360' 65 55 65 55 #86 2°00' I: 49°21'

65 55 65 55 C.T.C.

#85 65 55 El: 3 1/2" Sp: 360' 2°00' I: 17°45'

65 55 #84 2°00' I: 31°54'

65 55 #83 1°00' I: 12°00' El: 1 1/2" Sp: 570'

65 55 #82 0°40' I: 28°43' El: 1" Sp: 320'

1.25 1.15 1.25 1.15 1.25 1.15 1.25 1.15 1.25 0.20 0.254 0.60 0.515 0.37 0.40

6292.1 6303.8 6324.5 6352.9 6405.9 6416.1 6432.1 6450.5 6500.0 6507.2 6508.4 6491.1 6494.6 6482.6 6480.6

To Belen  
 Sig. 8591  
 Br-859.5, 35'x3'x28' Sto. 8x.  
 Br-858.8, 48'x132' R.C.P.  
 Relay Ho.  
 I. Sig. 48L.  
 Br-858.0, 48'x120' R.C.P.  
 Sig. 8571  
 Br-857.3, 6'x4'x45' C. A.C.  
 A.T.S. Sign  
 Sig. 8565  
 Sig. 8561  
 MOUNTAIN AIR  
 M.P. 855.73  
 36'x29' C.I.P.  
 4'x2'x30' Tr. T.Bx.  
 2-Relay Hqs.  
 Dip Jar  
 I. Sig. 8558  
 I. Sig. 562L.A.  
 Stock Yd. Hwy. U.S.  
 Br-855.4  
 24' B.D.I.B.m. on C. 80  
 Sec. Ho.  
 2- Bunk Hqs.  
 2- Sig. Maintainers Ho.  
 To Vaughn

Sig. 8592  
 Br-859.2, 54' B.D.D.P. on C.  
 I. Sw. 48R.  
 I. Sw. 48L.B.  
 Pub. Rd. Gr. King  
 136# Welded Rail 1958  
 I. Sw. 52 R.

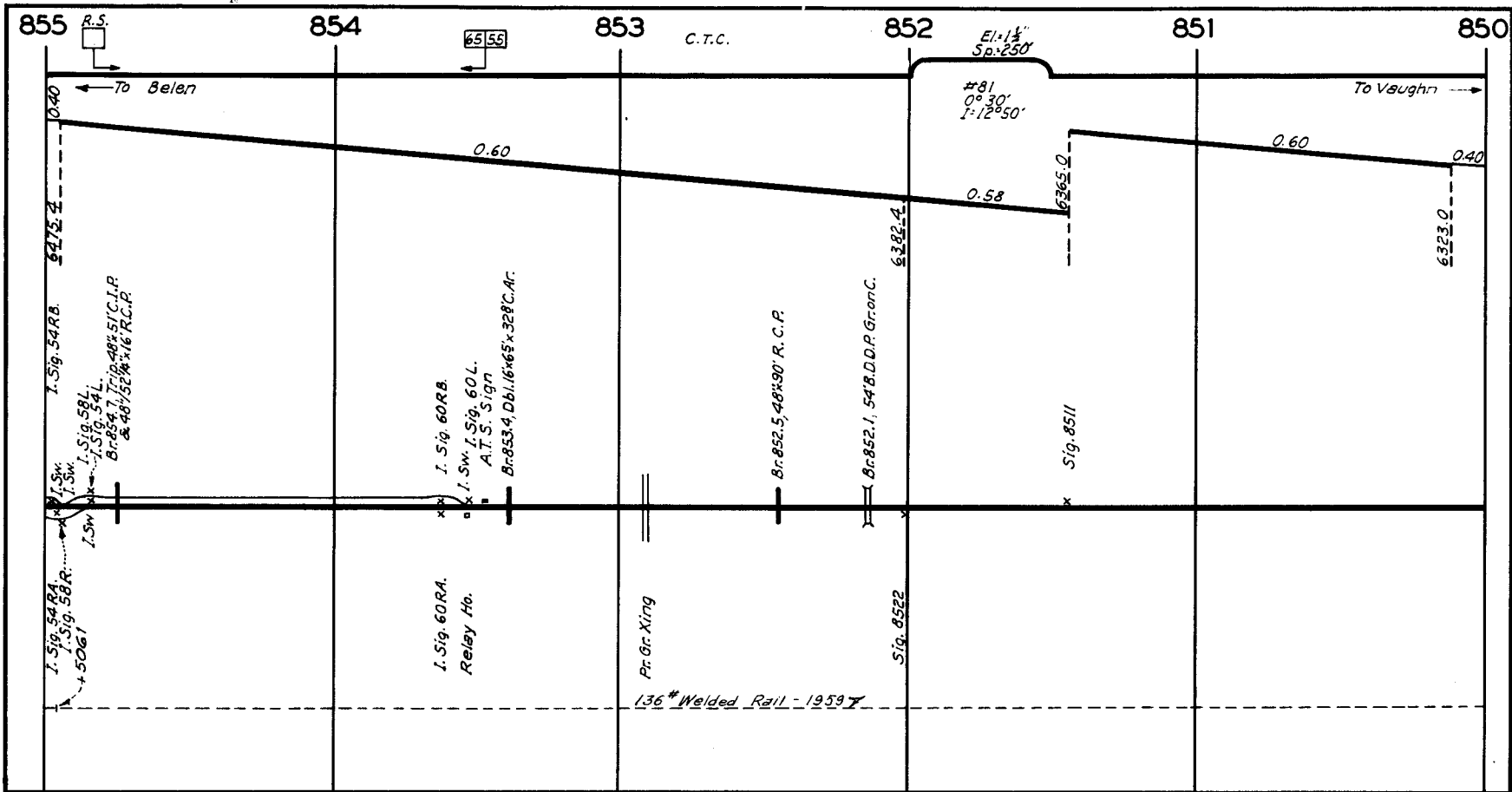

855

R.S.

854

6555

853

C.T.C.

852

El: 1 1/2"  
Sp: 250'

851

850

To Belen

To Vaughn

0.40

0.60

0.58

6365.0

0.60

0.40

6353.0

I.Sig. 54RB

I.Sw. I.Sig. 58L  
I.Sw. I.Sig. 54L  
Br. 854.1, 7'-10" 48" x 51' C.I.P.  
& 48' 152" x 16' R.C.P.

I.Sig. 60RB

I.Sw. I.Sig. 60L  
A.T.S. Sign

Br. 853.4, Dbl. 16' x 65' x 328' C.A.C.

Br. 852.5, 48' x 90' R.C.P.

Br. 852.1, 54' B.D.D.P. GronC.

Sig. 8511

I.Sig. 54RA

I.Sig. 58R

+5061

I.Sig. 60RA

Relay Ho.

Pr. Gr. Xing

Sig. 8522

136# Welded Rail - 1959

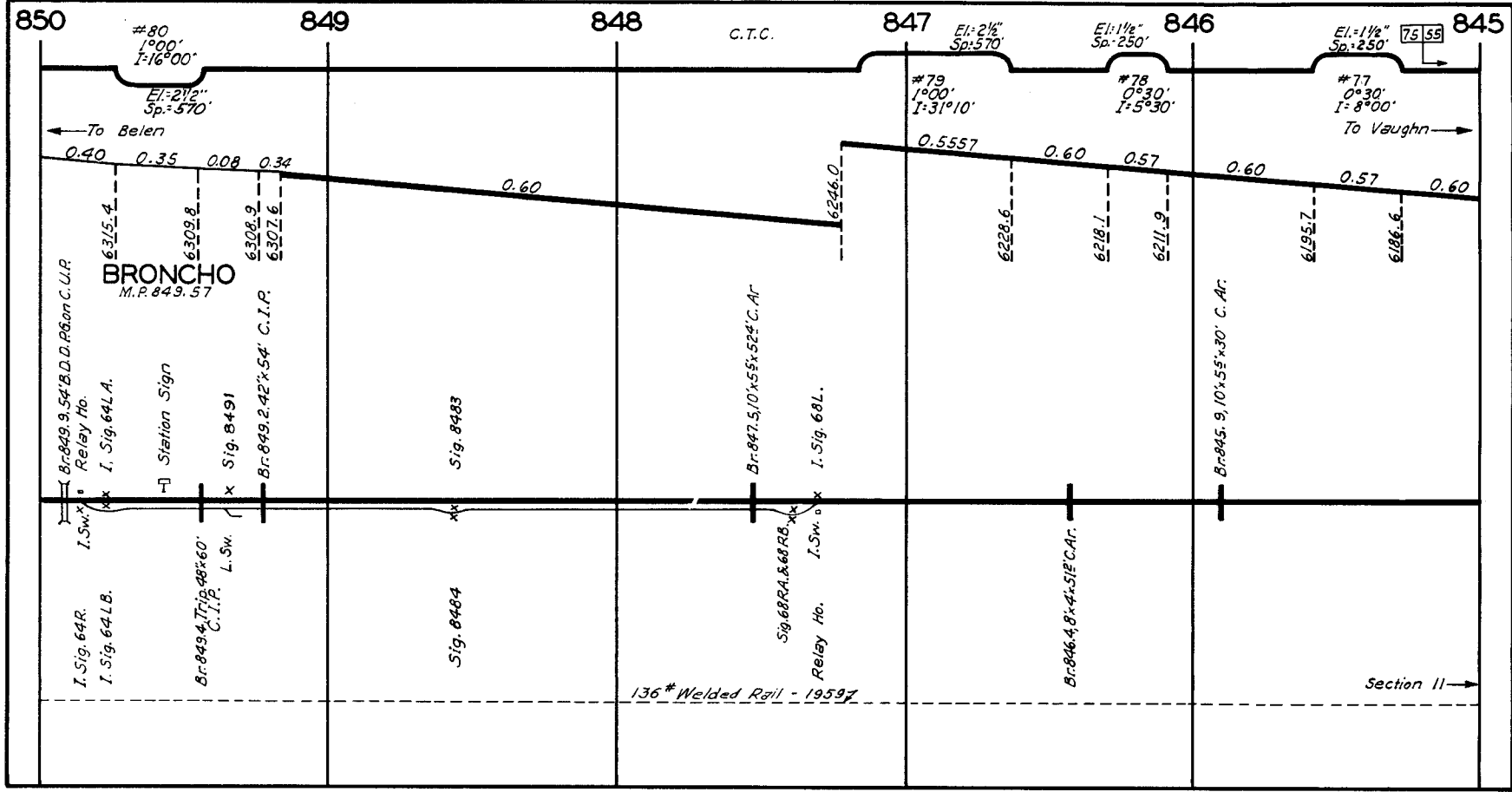

845

RS

844 R.S

6555

843

C.T.C.

842

841

840

To Belen  
0.60

EI = 4 1/2"  
Sp = 480"  
I = 84°00'

To Vaughn

6169.2

6148.2

0.60

6108.6

0.304

0.24

WILLARD  
M.R. 842.06  
W. Y.

6103.4

0.164

6096.2

0.25

6094.4

6087.4

0.20

6079.4

0.10

Sig. 8441

x

Sig. 8442

x

Section 10

I. Sig. 72 R. I.S.W. x  
I. Sig. 72 L.B. x x I. Sig. 72 L.A.

Depot

Fish. Sig. #42  
Fish. Sig.  
W. Loading Plm.  
W. Col.  
I. Sig. 78 R. & 78 B.  
I. Sig. 78 L.  
2-W. Tanks I. Sig. 78 L.

Calvert J.C.T.

Car Body

Pump Ho.

I. Ho. Boiler Ho.

136" Welded Rail - 1959

+4370'

136" Welded Rail 1957

Pub. Rd. Gr. Xing

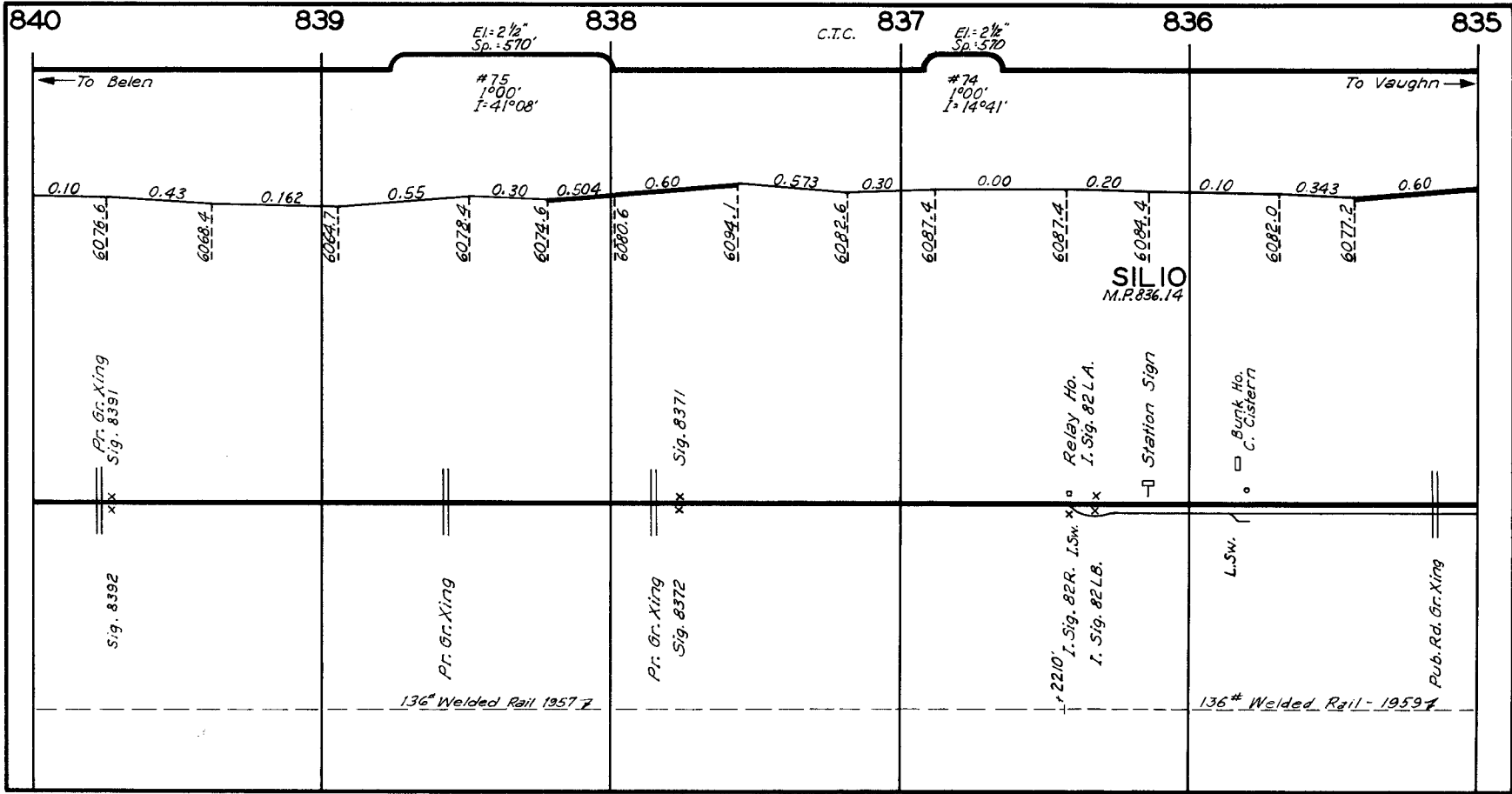

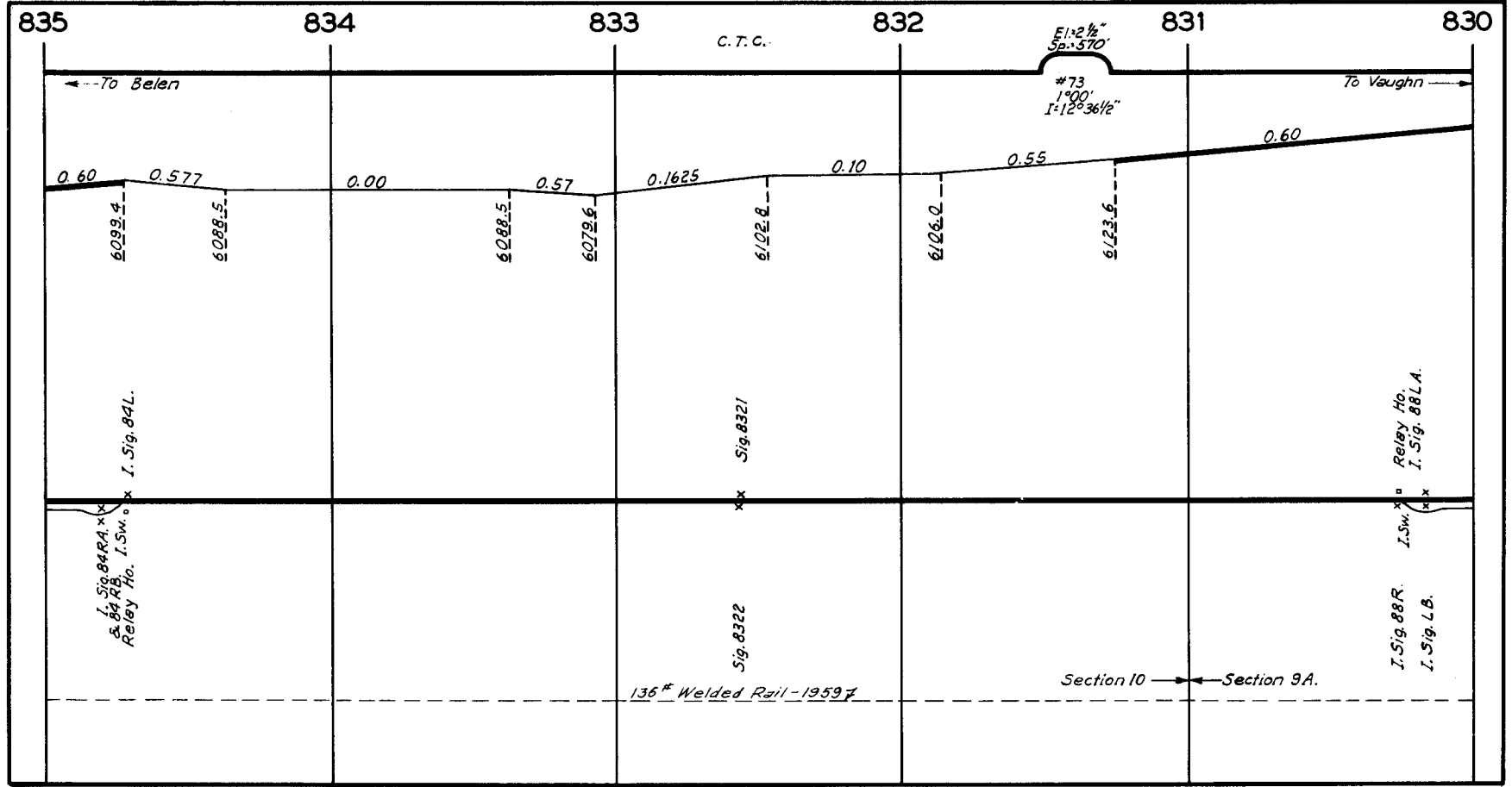

835

834

833

832

831

830

C. T. C.

E1:2 1/2"  
Sp.:570'

#73  
1°00'  
I=12°36 1/2"

←--To Belen

To Vaughn →

0.60

0.577

0.00

0.57

0.1625

0.10

0.55

0.60

I. Sig. 84R.A. x x  
I. Sw. x  
Relay Ho. I. Sig. 84L.

Sig. 8322

I. Sig. 8321

136 # Welded Rail - 1959

Section 10 ← Section 9A.

I. Sig. 88R.  
I. Sw. x x  
Relay Ho. I. Sig. 88L.A.

I. Sig. L.B.

830 829 828 827 826 825

C.T.C.

#72  
1°00'  
I: 17°45'  
El. = 2 1/2"  
Sp. = 570'

#71  
To Vaughn

To Belen

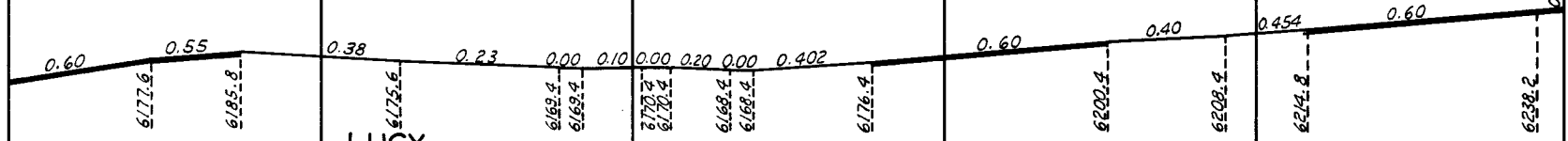

LUCY  
M.P. 828.80

Sig. 8291  
L.S.W.

Pub. Rd. Gr. King  
Depot  
L.S.W.



Sig. 8292  
Stock Yd.

I.Sig. 9294, 82282  
Relay

Br. 827.9, 144' B.D.I.B.m.on C.

Br. 826.5, Dbl. 8x4x31' C. A.C.

Sig. 8261

Br. 825.7, Dbl. 24x8x32' C. A.C.

I.S.W. Keley Ho.  
I. Sig. 96 L.B.

Sig. 8262

Br. 826.2, Trip. 48x24 C.I.P.

I. Sig. 96 R.  
I. Sig. 96 L.A.

135# Welded Rail - 1959



825

824

823

822

821

820

# 71  
1°00'  
I = 66°28'

C.T.C.

# 70  
1°00'  
I = 28°32'

El. = 2 1/2"  
Sp. = 570'

El. = 2 1/2"  
Sp. = 570'

El. = 2 1/2"  
Sp. = 570'

# 69  
1°00'  
I = 30°17'

← To Belen

To Vaughn →

0.5889

0.60

0.5562

0.60

0.55

0.03

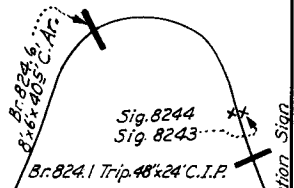

CULEBRA  
M.P. 824.01

6271.4

6317.4

6333.3

6391.3

Br. 824.1, 21' B.O.T. on C.

Br. 824.1, 21' B.O.T. on C.

Station Sign

L.S.W.

I. Sig. 100RB.

I.S.W. I. Sig. 100L.

Br. 823.1, 14' x 7' x 327 C. Ar.

I. Sig. 100RA.

Relay Ho.

Br. 821.9, 36' B.O.D. P.G. on C.

Sig. 8211

Br. 820.7, Dbl. 42' x 24' C.I.P. 6372.3

Pr. Gr. Xing

Relay Ho. I. Sig. 104LA & 104LB.

I. Sw. 104

I. Sig. 104R.

136# Welded Rail - 1959

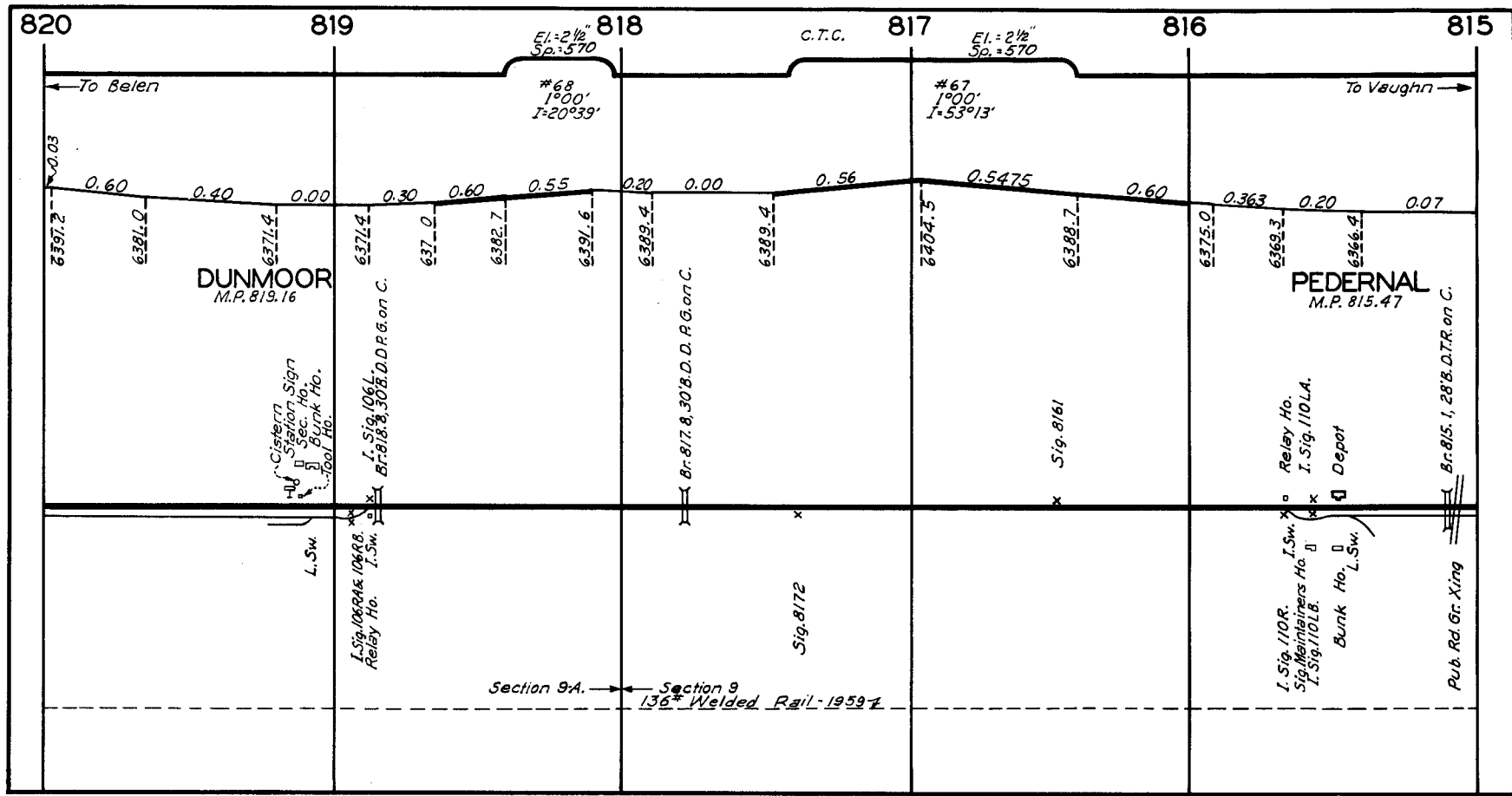

815

#66  
1°00'  
I=18°30'

814

#65  
0°30'  
I=7°36'

813

El.=2"  
Sp.=341

812

#63  
1°00'  
I=28°51'

811

#61  
0°30'  
I=14°13'

810

El.=2"  
Sp.=280

0.07 0.442 0.60 0.575 0.60 0.55 0.60 0.55 0.60 0.50 0.60 0.20 0.356 0.60 0.00

6364.6

6354.3

6344.1

6332.4

6315.9

6305.9

6284.6

6269.9

6262.1

6257.1

6251.9

6249.9

6441.6

6231.6

Br 814.7, Trip 48" x 24" C.I.P.  
& Trip 48" x 16" R.C.P.

Br 814.4, Dbl 48" x 24" C.I.P.  
& Dbl 48" x 16" R.C.P.

Br 814.1, Dbl 36" x 24" C.I.P.  
& Dbl 36" x 16" R.C.P.

Br 813.7, 24" x 24" C.I.P.  
& 24" x 16" R.C.P.

J. Sig. 114L.

Br 812.6, 24" B.D. 18" on C.U.P.

Sig. 8111

Br 811.1, Dbl 36" x 24" C.I.P.

Br 810.6, Dbl 42" x 24" C.I.P.

136# Welded Rail - 1959 Z

Br 813.9, 48" x 24" C.I.P.  
& 48" x 16" R.C.P.

I. Sig. 149A & 149B  
Sw. Ho.

Sig. 8122

Br 811.9, 48" x 24" C.I.P.

Br 811.5, 8" x 31" C.A.C.

Pub. Rd. Gr. Xing

C.T.C.

R.S. El.=41/2" Sp.=403

El.=1" Sp.=356  
(E.F. 279' W.E. 279')

To Vaughn  
I=9°00'

6555

6555

810 809 808 807 806 805

#59  
1°00'  
I = 11°26'  
El: 2"  
Sp: 341'

#58  
1°00'  
I = 21°24'  
El: 2"  
Sp: 372'

C.T.C.

To Belen

To Vaughn

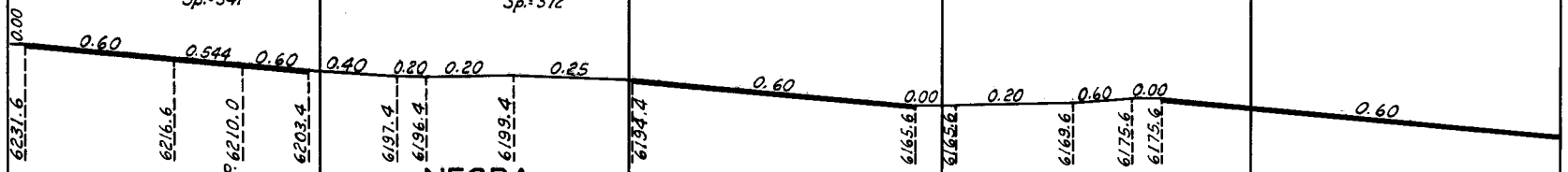

**NEGRA**  
M.P. 808.52

Br 810.0, Trip 42' x 24' C.I.P. 6231.6  
Relay Ho.  
I.Sig. 118 L.A.

Br 809.6, Trip 48' x 24' C.I.P.  
& Trip 48' x 52' x 16' R.C.P.

Br 809.3, 48' x 52' x 56' R.C.P. 6210.0

Br 809.1, 48' x 24' C.I.P.  
& 48' x 16' R.C.P.

Br 808.9, Dbl. 42' x 42' C.I.P.  
W. Col. Tool Ho.  
Distillate Tank  
L. Sw. Pub. Rd. Gr. Xing.  
Station Sign

Br 808.1, Dbl. 42' x 24' C.I.P.  
& Dbl. 42' x 46' x 16' R.C.P.

Br 806.3, 288' B.D.D.P.G. on C.  
H.W. Det.

Br 806.5, 48' x 52' R.C.P.

I.Sig. 118 R.  
I. Sig. 118 L.B.

Br 809.4, 36' x 40' R.C.P.

Sig. 808.3  
Sec. Ho.  
W. Loading Rack  
T. Plant  
C. Sunk Ho.

Br 808.5, Dbl. 36' x 48' R.C.P.

I.Sig. 122 R.A. & 122 R.B.  
Relay Ho. I.Sw.

I.Sig. 122 L.

Pub. Rd. Gr. Xing

Pr. Gr. Xing

Sig. 805.2

Sig. 805.1

Section 9



800

70 55

799

798

R.S. C.T.C.

#55  
1°00'

65 55

797

70 55

EI = 3 1/2"  
Sp = 290'

R.S.

796

#53  
1°00'

65 55

795

EI = 1"  
Sp = 248'

#56  
0°30'  
I = 28°24'

EI = 1 1/2"  
Sp = 279'

#54  
2°00'  
I = 47°22'

EI = 2 1/2"  
Sp = 279'

LLANO SUMMIT

I = 14°34'

0.60 0.575 0.60 0.40 0.332 0.55 0.60 0.50 0.60 0.55 0.60

6175.4

6208.8

6213.0

6227.0

6233.3

6223.9

6210.4

6198.5

6190.7

6182.1

CARNERO  
M.P. 797.94

I. Sig. 132 R.  
I. Sw. x  
Relay Ho.  
I. Sig. 132 L.A. & 132 L.B.

Br. 799.1, 48' B.D. 18m. on C.

Sig. 7983

Tool Ho.  
Sec. Ho.  
C. Caster  
C. Bunk Ho.

L.S.W.  
Br. 798.1, 24' B.D. 18m. on C.

Station Sign  
I. Sig. 136 R.A.

I. Sig. 136 L.

I. Sig. 136 R.B.  
Relay Ho.  
I. Sw. x

Br. 796.1, 95' B.D. 18m. on C.

Sig. 7952

Sig. 7951  
B.C. 795.7  
Dbl. 16' x 7' x 3 1/8" C. Ar.

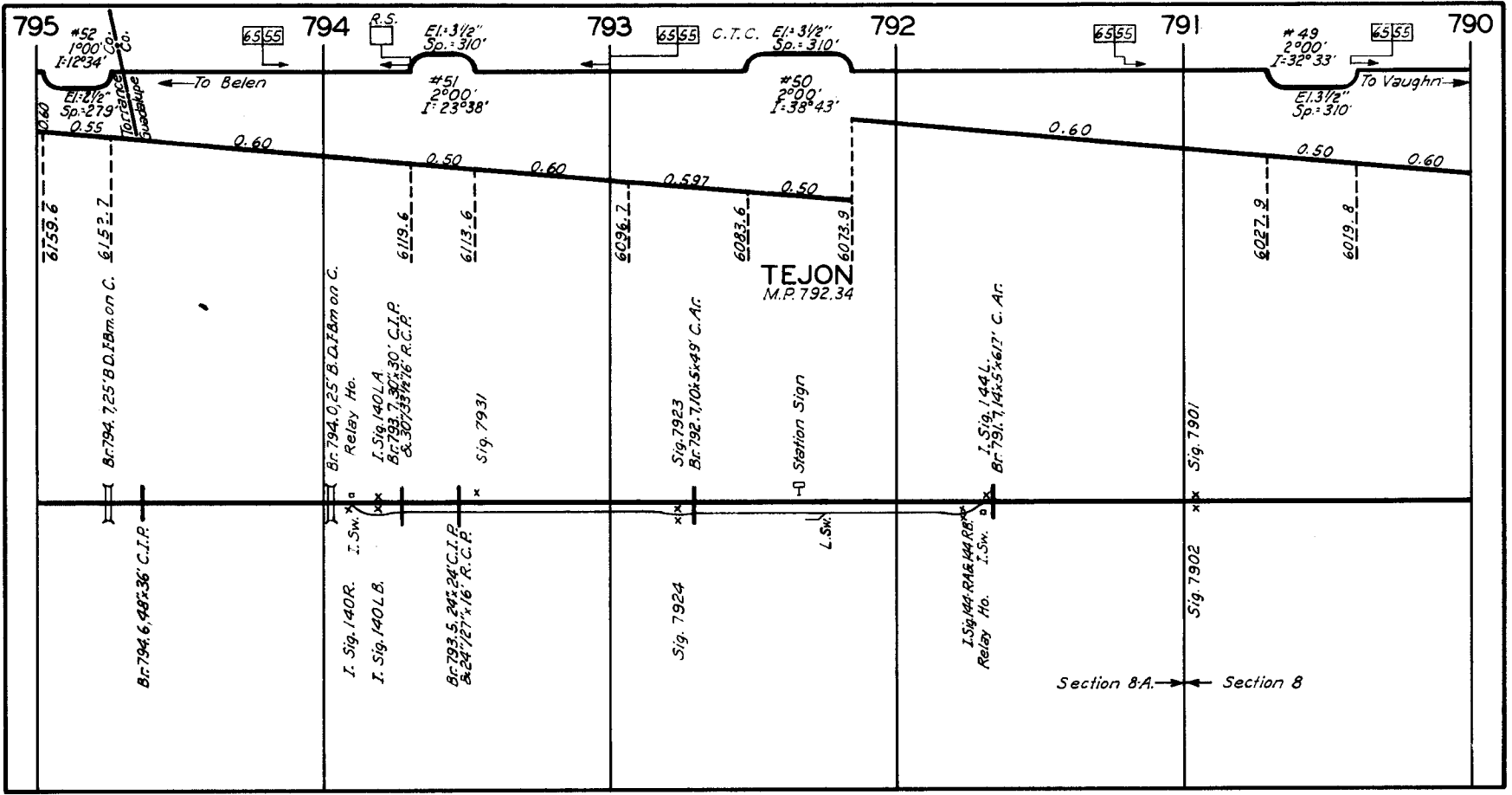

795

794

793

792

791

790

#52  
100'  
Sp: 279  
I: 12°34'

R.S.  
E1: 3 1/2''  
Sp: 310'

6555 C.T.C.

E1: 3 1/2''  
Sp: 310'

6555

#49  
200'  
I: 32°33'

6555

To Belen

To Vaughn

0.60 0.50 0.60 0.597 0.50 0.60 0.50 0.60

6159.6

6119.6

6113.6

60296.7

6083.6

6073.9

6027.2

6019.8

TEJON  
M.P. 792.34

Br. 794, 7.25' B.D. 18m on C. 61.5 2.7

Br. 794, 0.25' B.D. 18m on C. Relay Ho.

I. Sig. 140 L.A.  
Br. 793, 7.30' x 30' C.I.P.  
& 30733 1/2' R.C.P.

Sig. 7931

Sig. 7923  
Br. 792, 7.10' x 5' x 49' C. A.C.

Station Sign

I. Sig. 144 L.  
Br. 791, 142.5' x 617' C. A.C.

Sig. 7902 \* \* \* Sig. 7901

Br. 794, 6.48' x 36' C.I.P.

I. Sig. 140 R.  
I. Sw. \* \* \*

I. Sig. 140 L.B.

Br. 793, 5.24' x 24' C.I.P.  
& 24' x 16' R.C.P.

Sig. 7924 \* \* \*

L.S.W.

I. Sig. 144 R.A.R. 44 R.B.  
Relay Ho. I. Sw. \* \* \*

Section 8.A. ← Section 8

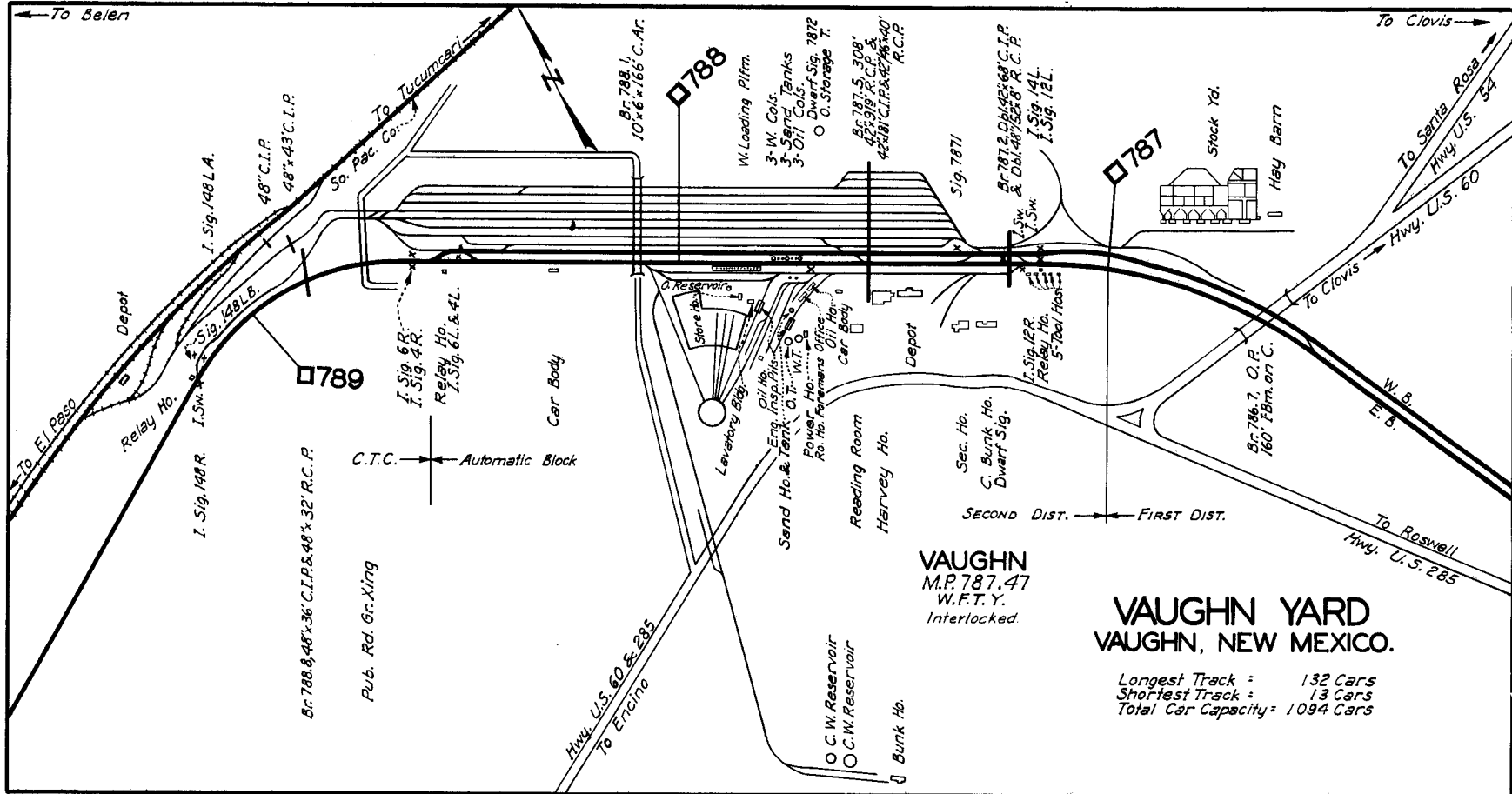

← To Belen

To Clovis →

To Tucumcari

To Santa Rosa

Hwy. U.S. 54

To Clovis

To Roswell

Hwy. U.S. 285

I. Sig. 148 L.A.

48" C.I.P.

48" x 43' C.I.P.

I. Sig. 148 R.

I. Sw.

Br. 788, 48" x 36' C.I.P. & 48" x 32' R.C.P.

Pub. Rd. Gr. Xing

C.T.C.

Automatic Block

Hwy. U.S. 60 & 285  
To Encino

Car Body

Reservoir

Laveberg Bldg.

Sand Ho. & Tank

Reading Room  
Harvey Ho.

Bunk Ho.

C. W. Reservoir  
C. W. Reservoir

Br. 788, 10' x 6' x 166' C.A.R.

W. Loading Plftm.

3- W. Coils

3- Sand Tanks

3- Oil Coils

Dwarf Sig. 7872

O. Storage T.

Sig. 7871

Depot

Sec. Ho.

C. Bunk Ho.

Dwarf Sig.

Br. 787, 5, 308', 48" x 918' R.C.P. & 48" x 81' C.I.P. & 48" x 81' C.I.P. & 48" x 40' R.C.P.

I. Sw.

I. Sw.

I. Sig. 128

Relay Ho.

5' Tool House

Stock Yd.

Hay Barn

Br. 786, 7, O.P. 160' Fbm. on C.

W. B.

E. B.

Br. 789

I. Sig. 6 R.

I. Sig. 4 R.

Relay Ho.

I. Sig. 6 L. & 4 L.

Spore Ho.

Oil Ho.

Eng. Insp. Ho.

Power Ho.

Ro. Ho. Foremans Office

Oil Ho.

Car Body

Br. 787, 2, 2014' x 68' C.I.P. & 2014' x 68' R.C.P.

I. Sw.

I. Sw.

I. Sig. 128

Relay Ho.

5' Tool House

Stock Yd.

Hay Barn

Br. 786, 7, O.P. 160' Fbm. on C.

W. B.

E. B.

Br. 789

I. Sig. 6 R.

I. Sig. 4 R.

Relay Ho.

I. Sig. 6 L. & 4 L.

Spore Ho.

Oil Ho.

Eng. Insp. Ho.

Power Ho.

Ro. Ho. Foremans Office

Oil Ho.

Car Body

Br. 787, 2, 2014' x 68' C.I.P. & 2014' x 68' R.C.P.

I. Sw.

I. Sw.

I. Sig. 128

Relay Ho.

5' Tool House

Stock Yd.

Hay Barn

Br. 786, 7, O.P. 160' Fbm. on C.

W. B.

E. B.



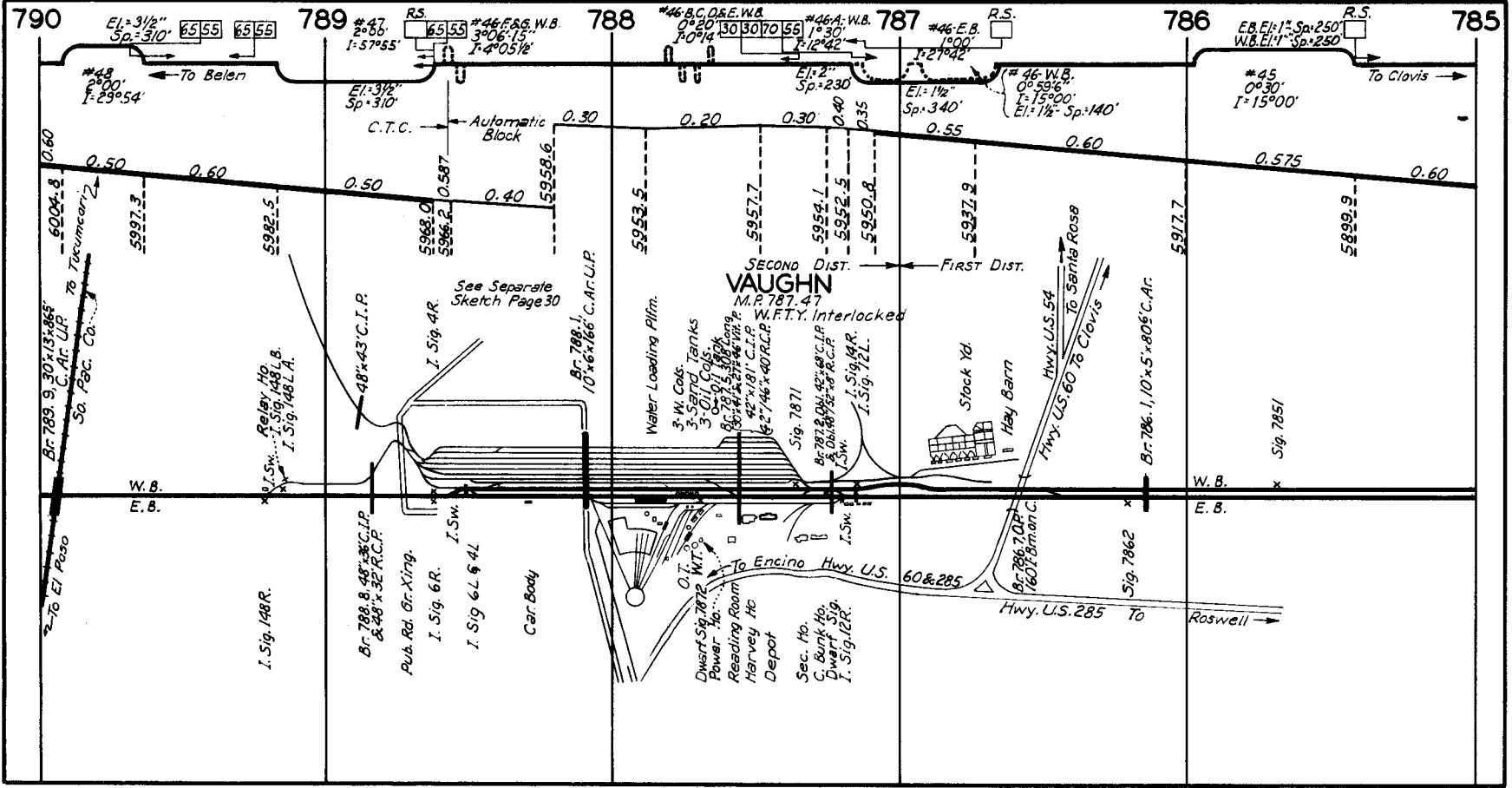

781 780 779 778

E.L. 1" Automatic  
Sp. = 190' Block

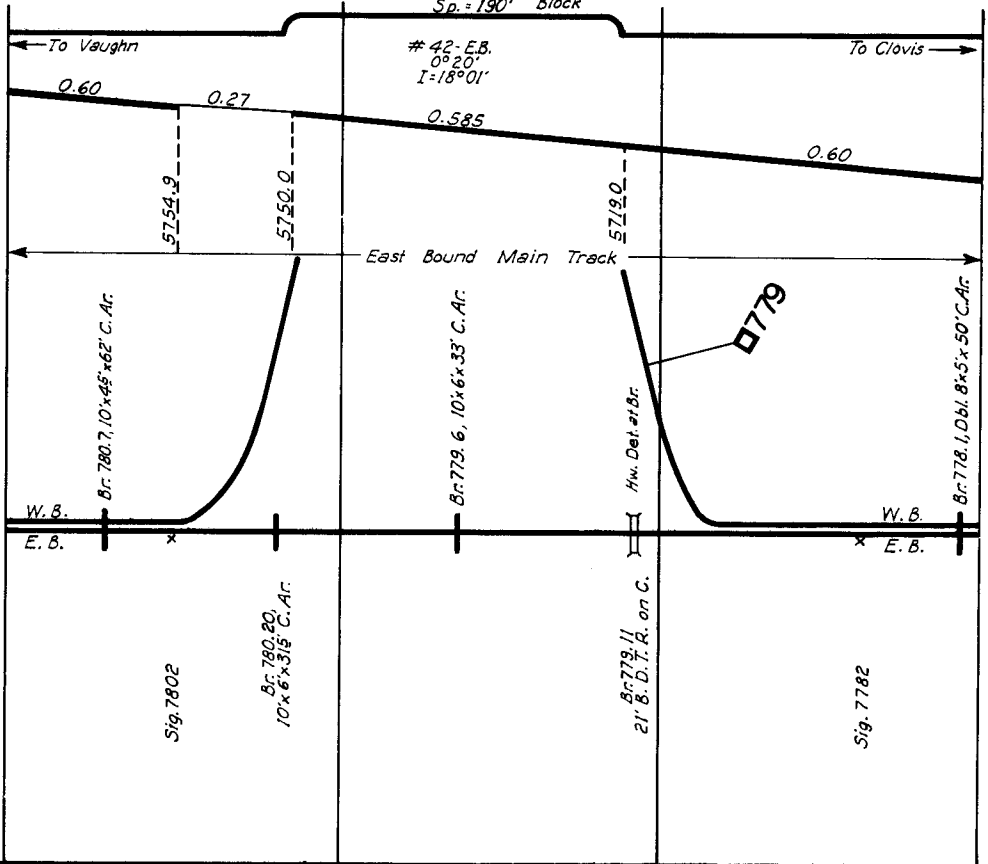

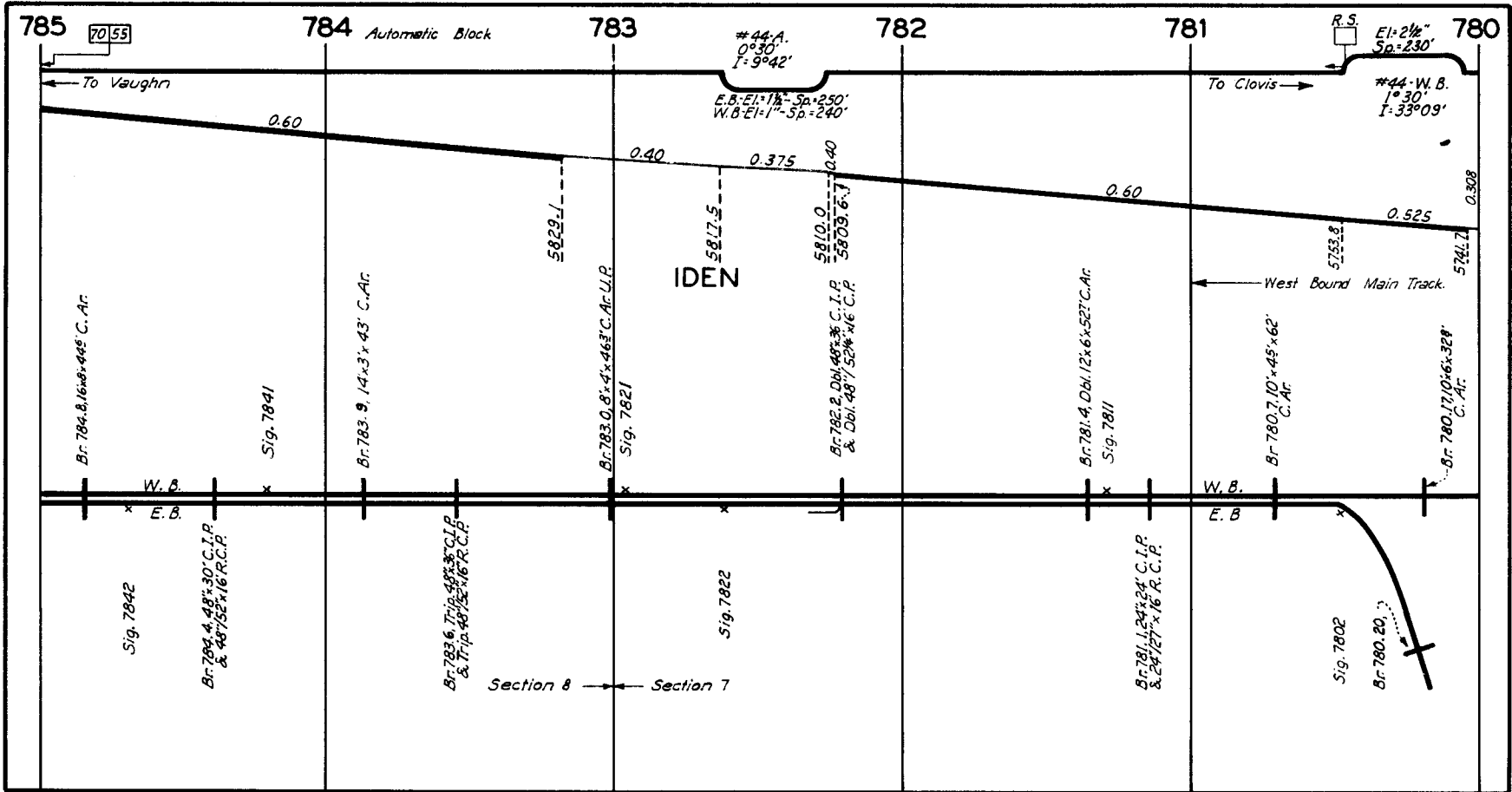

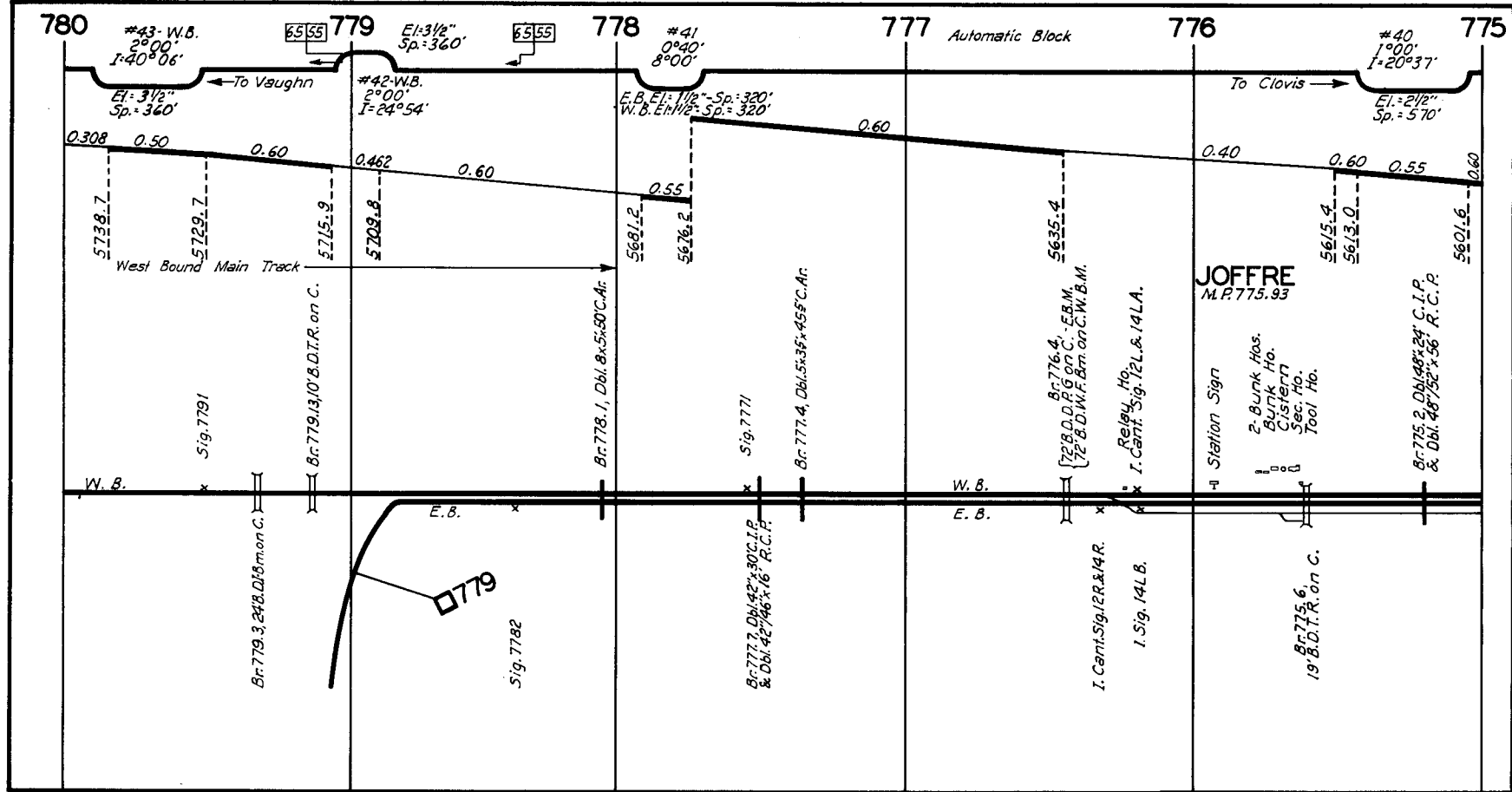

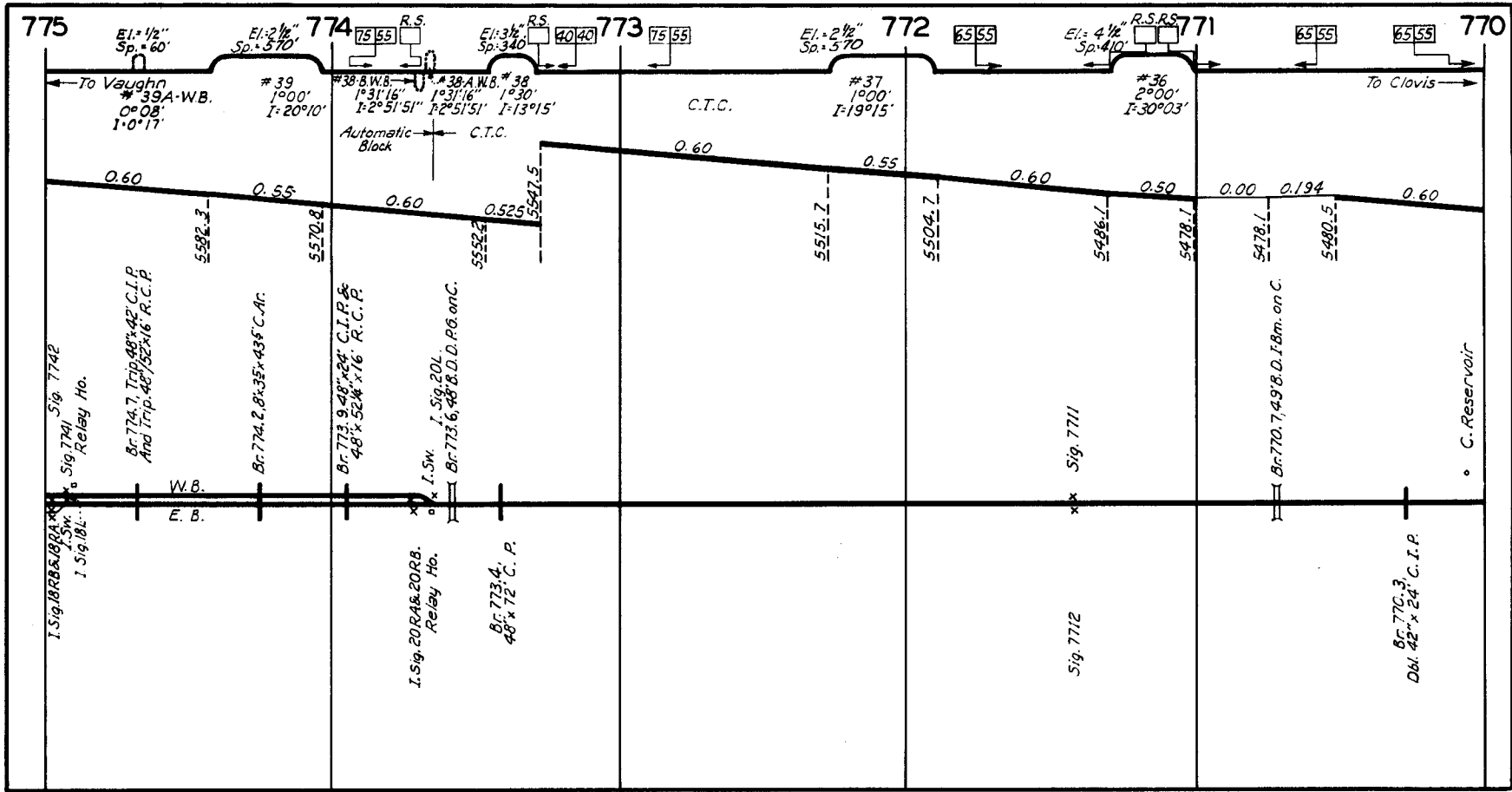



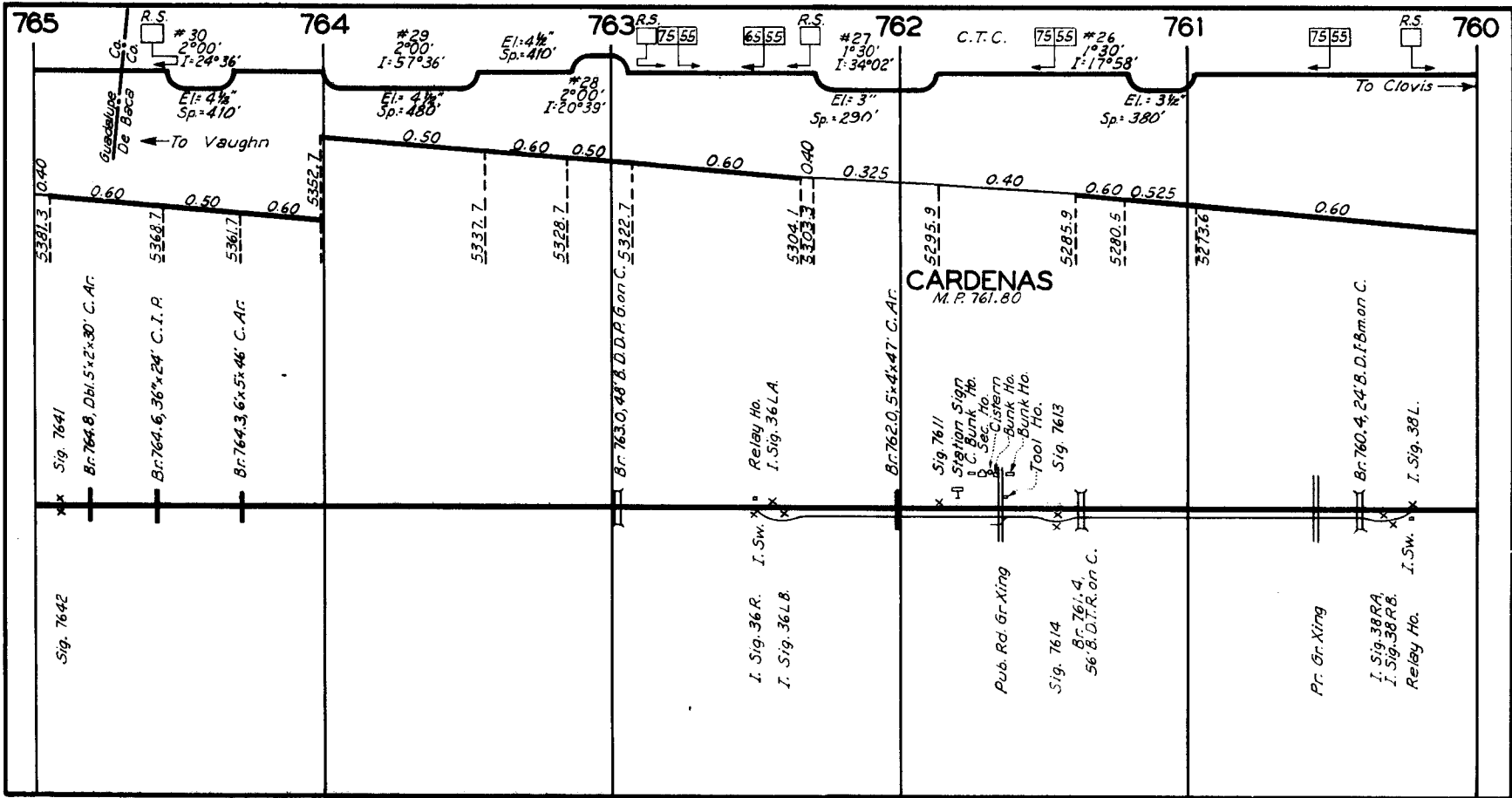

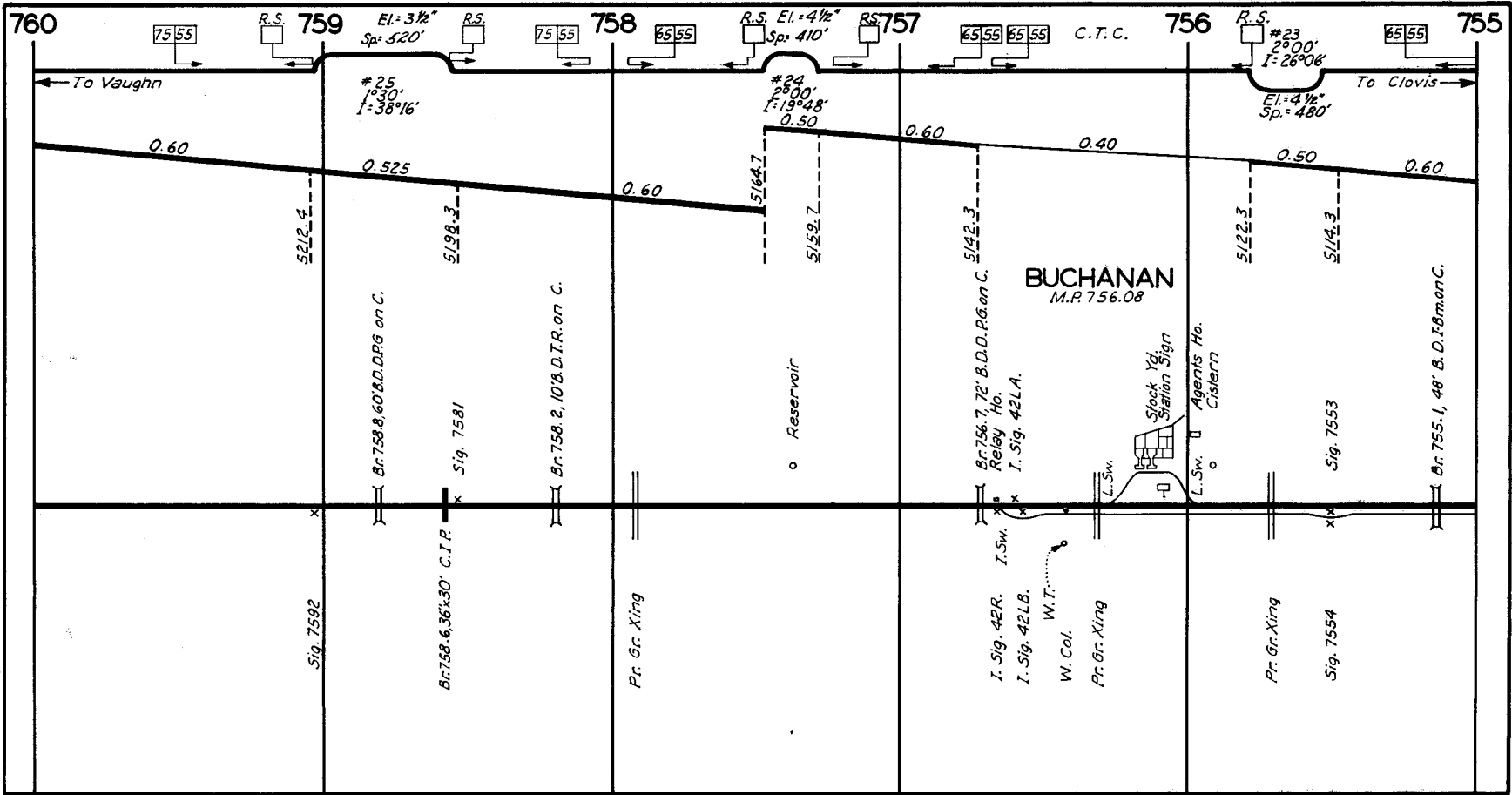



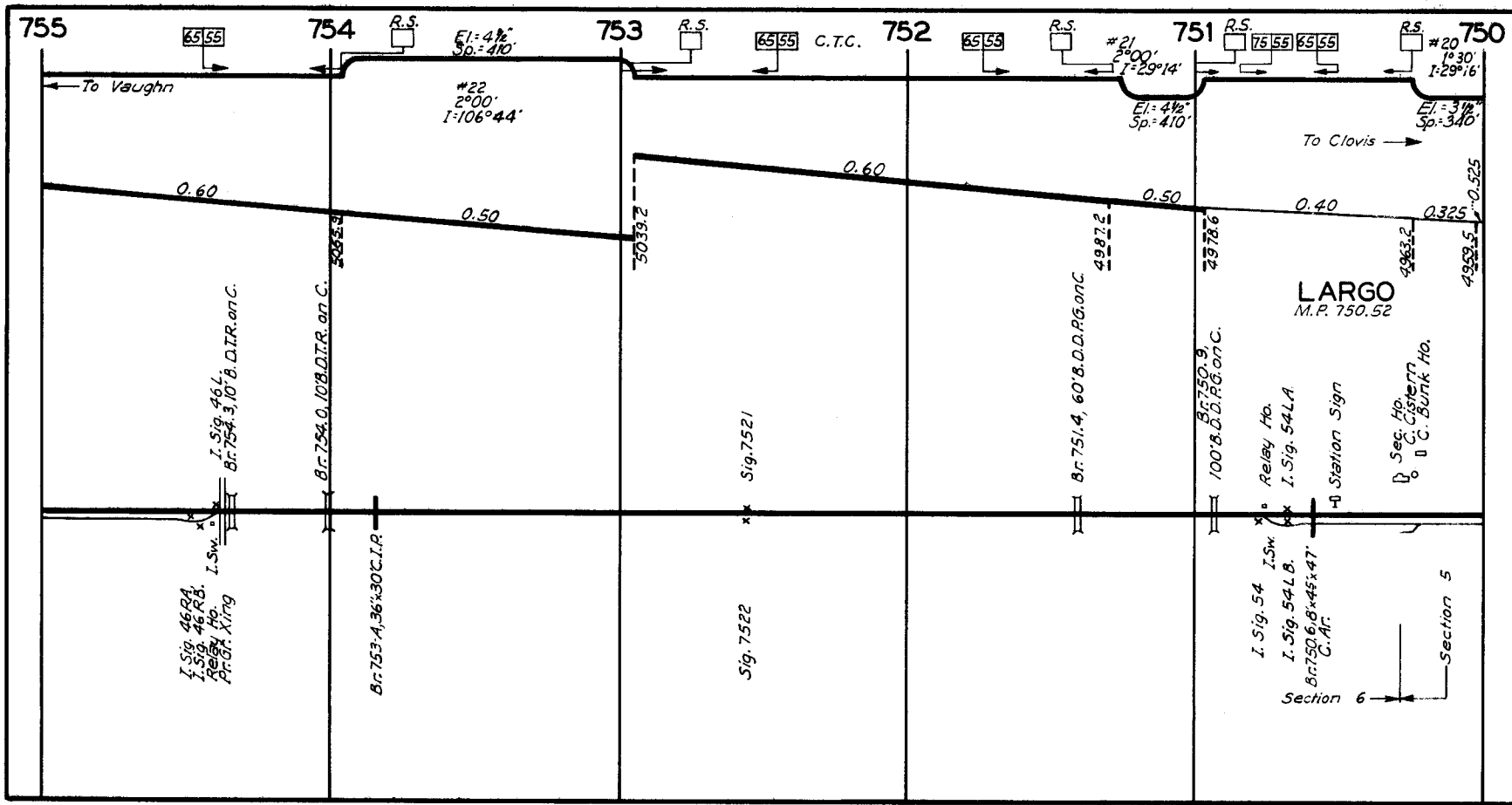

755

754

753

752

751

750

6555

6555

6555

7555

6555

To Vaughn ←

El: 4 1/2'  
Sp: 410'

C.T.C.

El: 4 1/2'  
Sp: 410'

El: 3 1/2'  
Sp: 340'

To Clovis →

0.60

0.50

0.60

0.50

0.40

0.325

0.525

LARGO  
M.P. 750.52

I. Sig. 46 R.A.  
I. Sig. 46 R.B.  
Relay Ho.  
Pr. Gr. Xing  
I. Sw.

Br. 754, 0.10 B.D.I.R. on C.

Br. 753-A, 36x30 C.I.R.

Sig. 7521

Sig. 7522

Br. 751.4, 60' B.D.D.R.G. on C.

Br. 750.9, 100' B.D.D.R.G. on C.

Relay Ho.  
I. Sig. 54 L.A.

Station Sign

Sec. Ho.  
C. Cistern  
C. Bunk Ho.

I. Sig. 54  
I. Sw.

I. Sig. 54 L.B.

Br. 750.6, 8x45x47'

C. Hr.

Section 6

Section 5

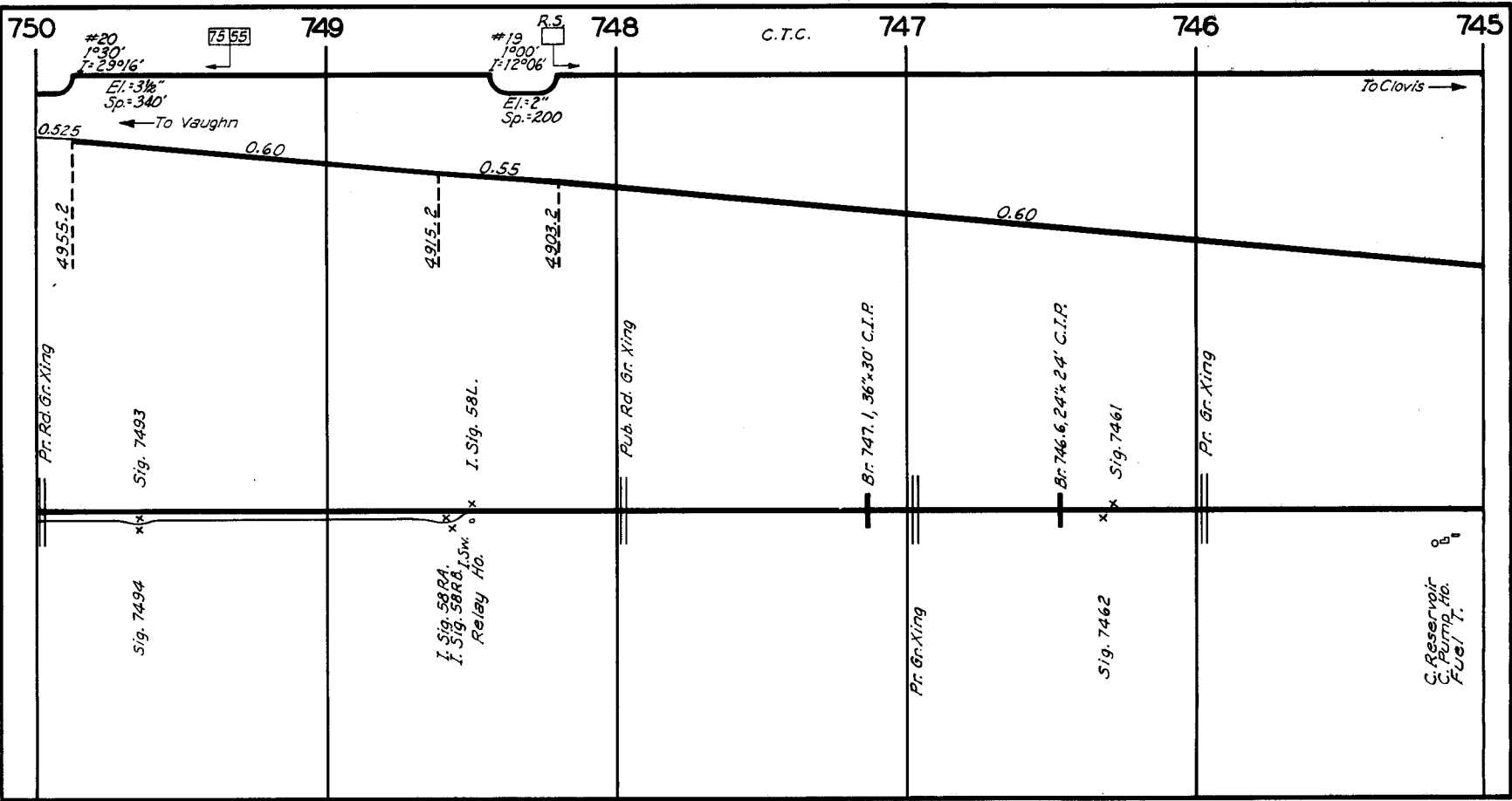

745

744

743

C.T.C.

742

741

740

← To Vaughn

To Clovis →

# 18  
0°30'  
I-6°09'

EI=1"  
Sp=217'

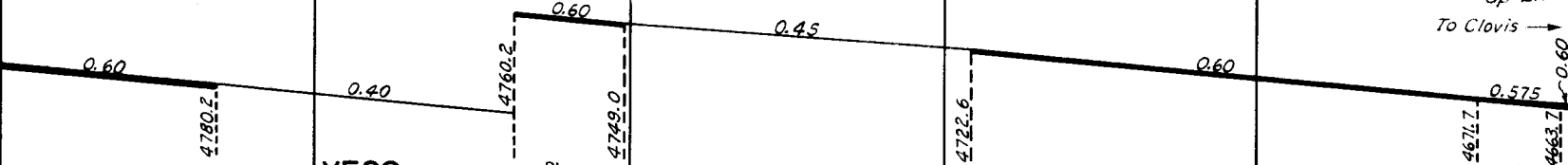

**YESO**  
M. P. 743.88

I. Sig. 64R. I.Sw.  
 I.T. I. Sig. 64LB.  
 W.T. Ho.  
 2-Car Bldgs

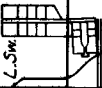

Stock Yd.  
 Depot  
 Pr. Gr. Xing

Sig. Maintainers Ho.  
 Agents Ho.  
 Cistern  
 Sec. Ho.  
 2-Tool Hqs.

Sig. 7434  
 Sig. 7432

Sig. 7433  
 Br. 743.2 Dbl. 42'x60' C.I.P.  
 Br. 42'x46'x16' R.C.P.  
 Sig. 7431

I. Sig. 70RA.  
 Relay Ho.  
 Pr. Gr. Xing

Br. 742.2, 42'x48' C.I.P.  
 I. Sig. 70RB.  
 I. Sig. 70L.

Pr. Gr. Xing

Br. 741.0, 19' B. D.T.R. on C.

Sig. 7402

Br. 740.2, Dbl. 52'x285' C. A.C.  
 Sig. 7401

4671.7

0.575

4663.7

0.60

4722.6

4749.0

4760.2

4780.2

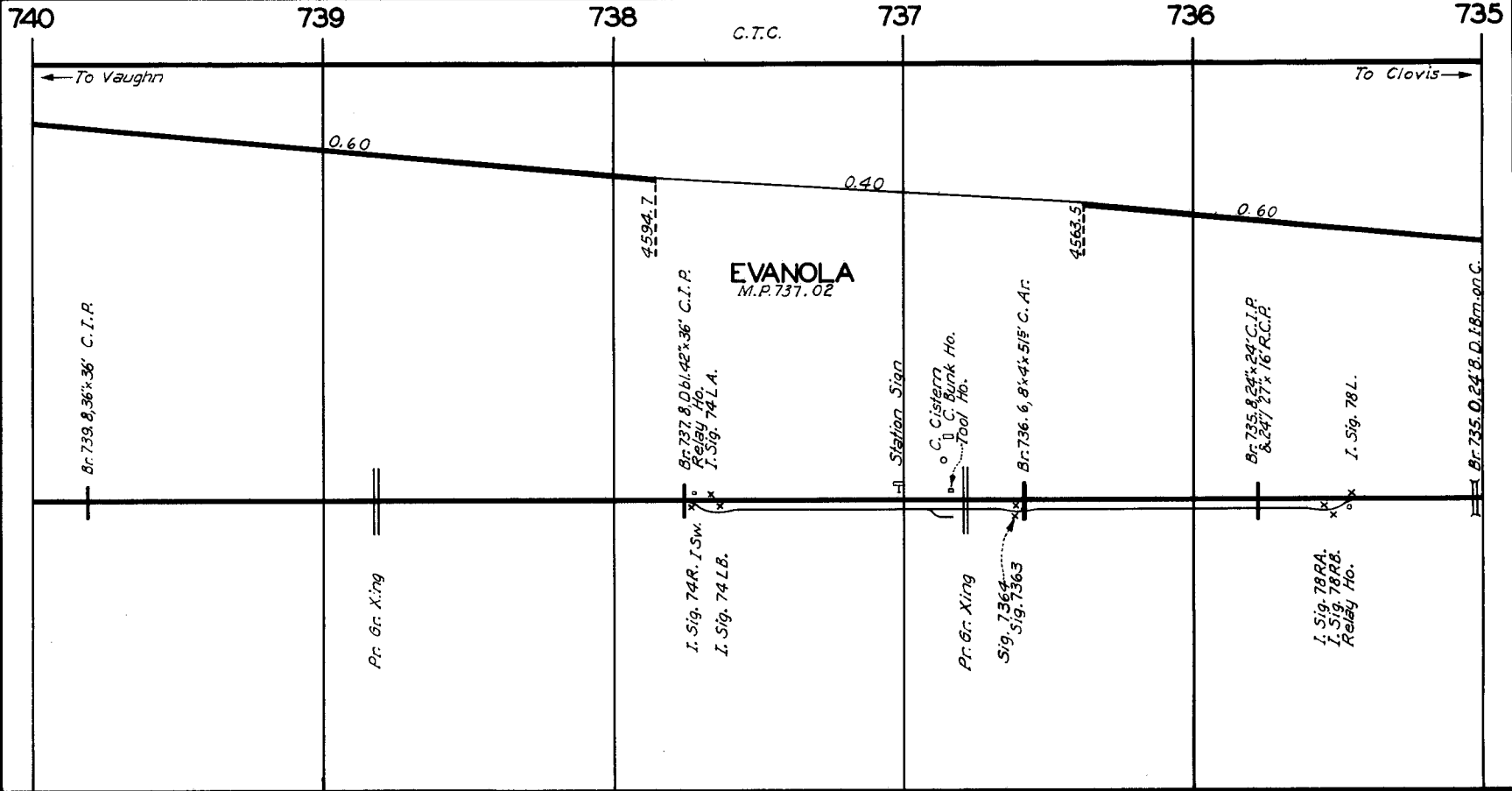

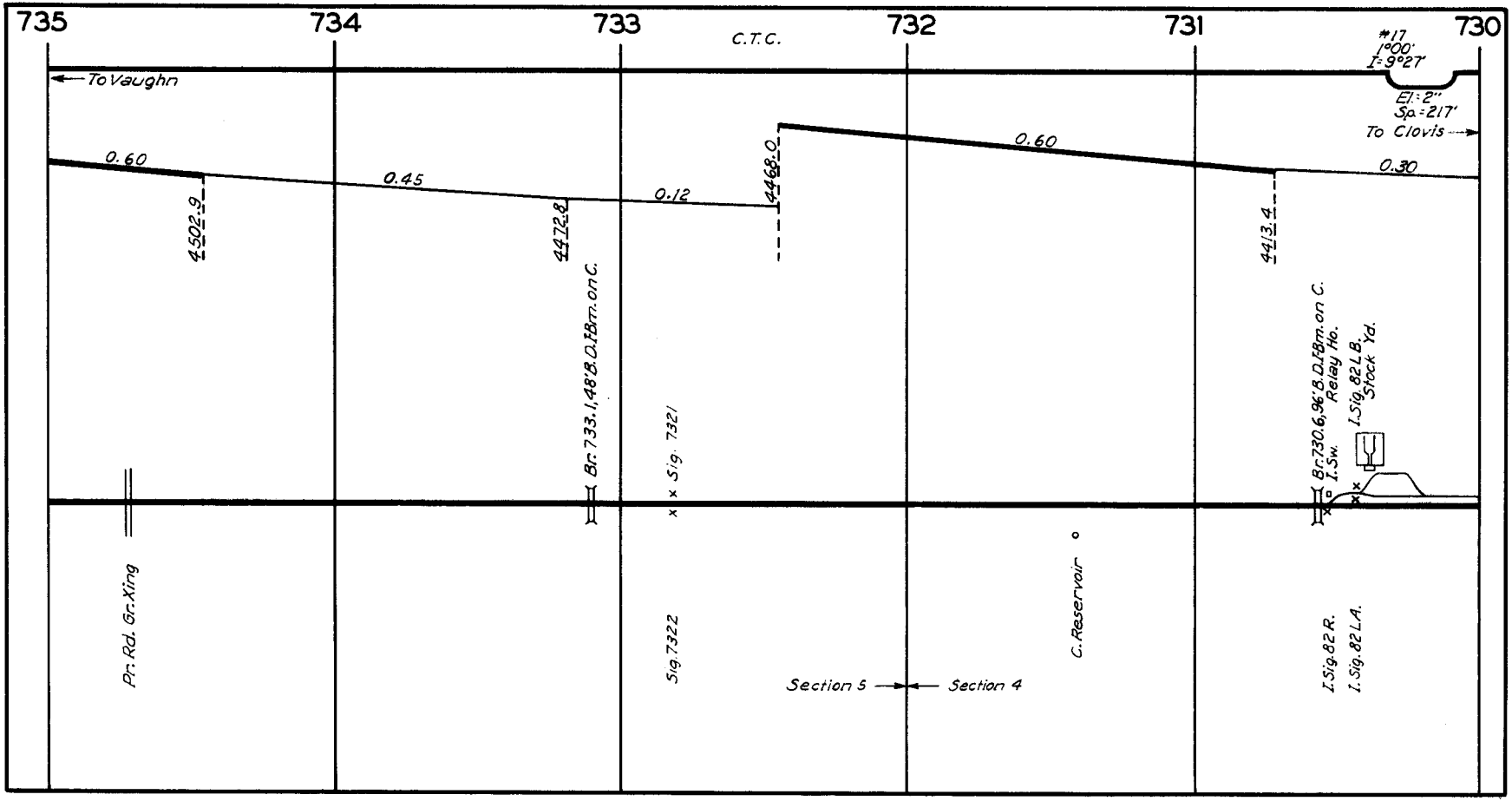

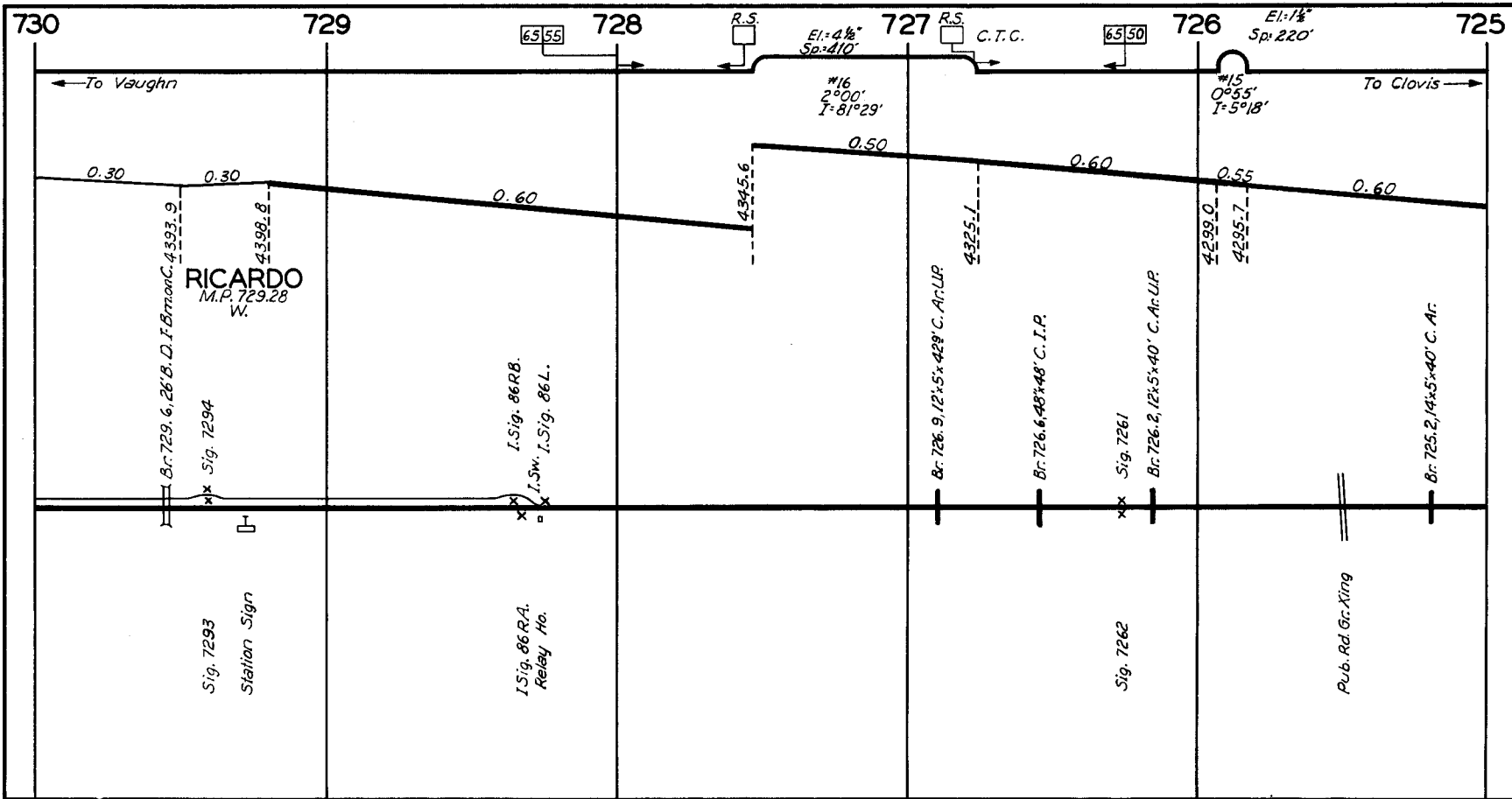

730

729

728

727

726

725

← To Vaughn

To Clovis →

El.: 4 1/2  
Sp.: 410

El.: 1 1/2  
Sp.: 220

65 55

65 50

4345.6

0.50

0.60

0.55

0.60

B.C. 729.6, 26' B.D. F. Bman C. 4393.9

**RICARDO**  
M.P. 729.28  
W.

Sig. 7293

Station Sign

I.Sig. 7294

I.Sig. 86RB.  
I.Sw. I.Sig. 86L.

I.Sig. 86RA.  
Relay Ho.

B.C. 726.9, 12x5x429' C. Ar. U.P.

B.C. 726.6, 48x48' C. I.P.

Sig. 7261

B.C. 726.2, 12x5x40' C. Ar. U.P.

Sig. 7262

B.C. 725.2, 14x5x40' C. Ar.

Pub. Rd. Gr. Xing

#16  
2°00'  
I = 81°29'

#15  
0°35'  
I = 5°18'

R.S.

R.S.

C.T.C.

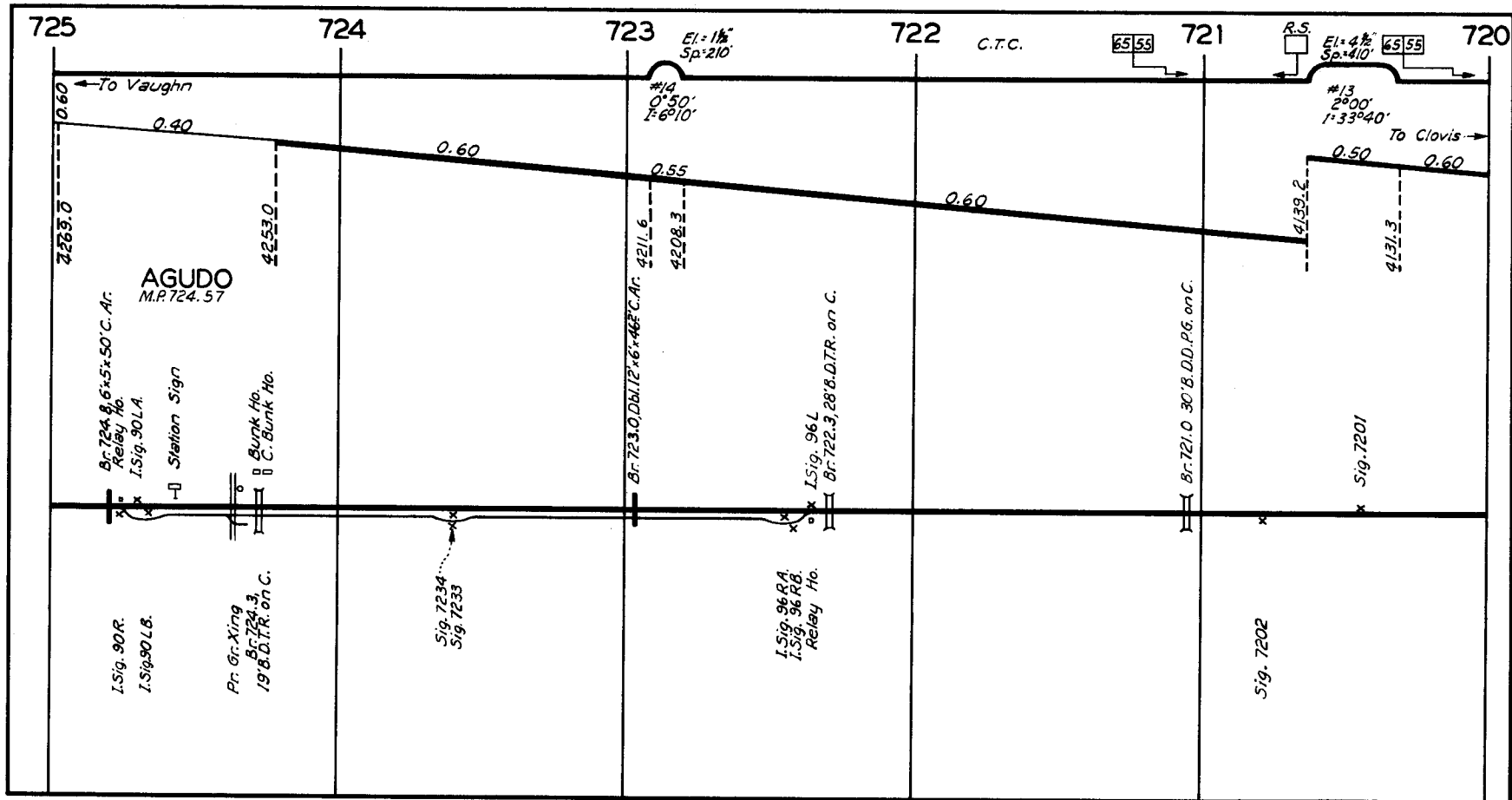

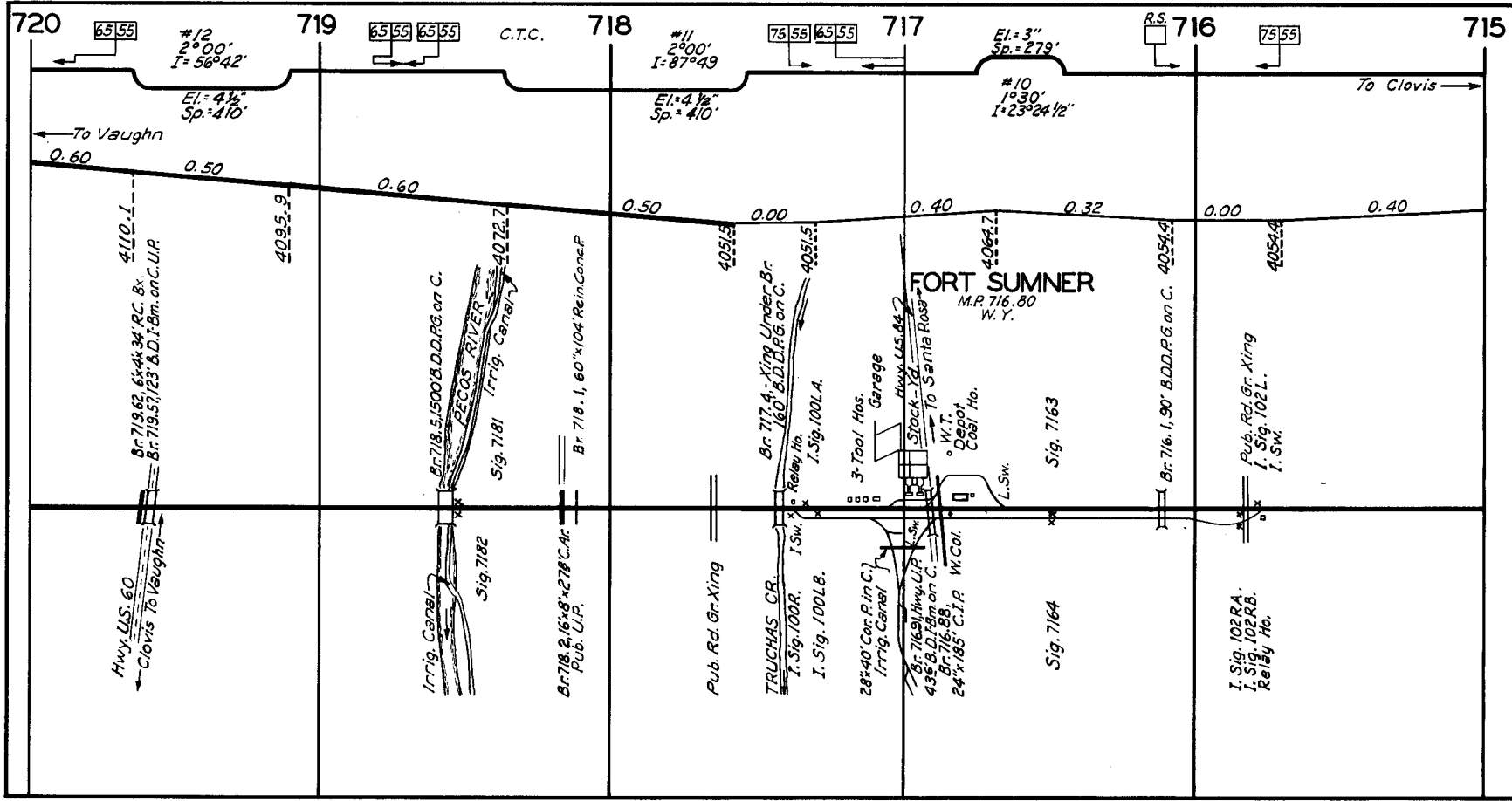

720 65 55 #12 2°00' I=56°42' 719 65 55 65 55 C.T.C. 718 #11 2°00' I=87°49' 717 75 55 65 55 El=3" Sp=279' R.S. 716 75 55 715

To Vaughn 0.60 0.50 0.60 0.50 0.00 0.40 0.32 0.00 0.40 To Clovis

El.=4 1/2' Sp.=410' El.=4 1/2' Sp.=410' El.=3" Sp.=279' #10 1°30' I=23°24 1/2'

4110.1 4095.9 4072.7 4051.5 4031.5 4064.7 4054.9 4054.9

Br. 719.62, 6x4x34' RC. Bx.  
Br. 719.57/23' B.D.I. Bm. on C. U.P.

Br. 718.5, 1500' B.D.D.P.G. on C.

PECOS RIVER

Br. 718.1, 60' x 104' Rein. Conc. P.

Br. 717.4, King Under Br.  
160' B.D.D.P.G. on C.

Br. 716.1, 90' B.D.D.P.G. on C.

Br. 715.1, 90' B.D.D.P.G. on C.

Hwy. U.S. 60  
Clovis To Vaughn

Irrig. Canal

Truchas Cr.

Pub. Rd. Gr. King

28' x 40' Cor. P. in C.

Garage

3 Tool Hqs.

Stock Yd.

To Sarris Road

W.T.

Depot

Coal Ho.

L.S.W.

Pub. Rd. Gr. King

Irrig. Canal

Br. 716.9, Hwy. U.P.

Br. 716.88

24' x 185' C.I.P. W. Col.

**FORT SUMNER**  
M.P. 716.80  
W. Y.

Sig. 7182

Br. 718.2, 16x8' x 278' C. Ac.  
Pub. U.P.

I. Sig. 100R. I Sw.

I. Sig. 100L. B.

Sig. 7163

Sig. 7164

I. Sig. 102RA.  
I. Sig. 102RB.  
Relay Ho.



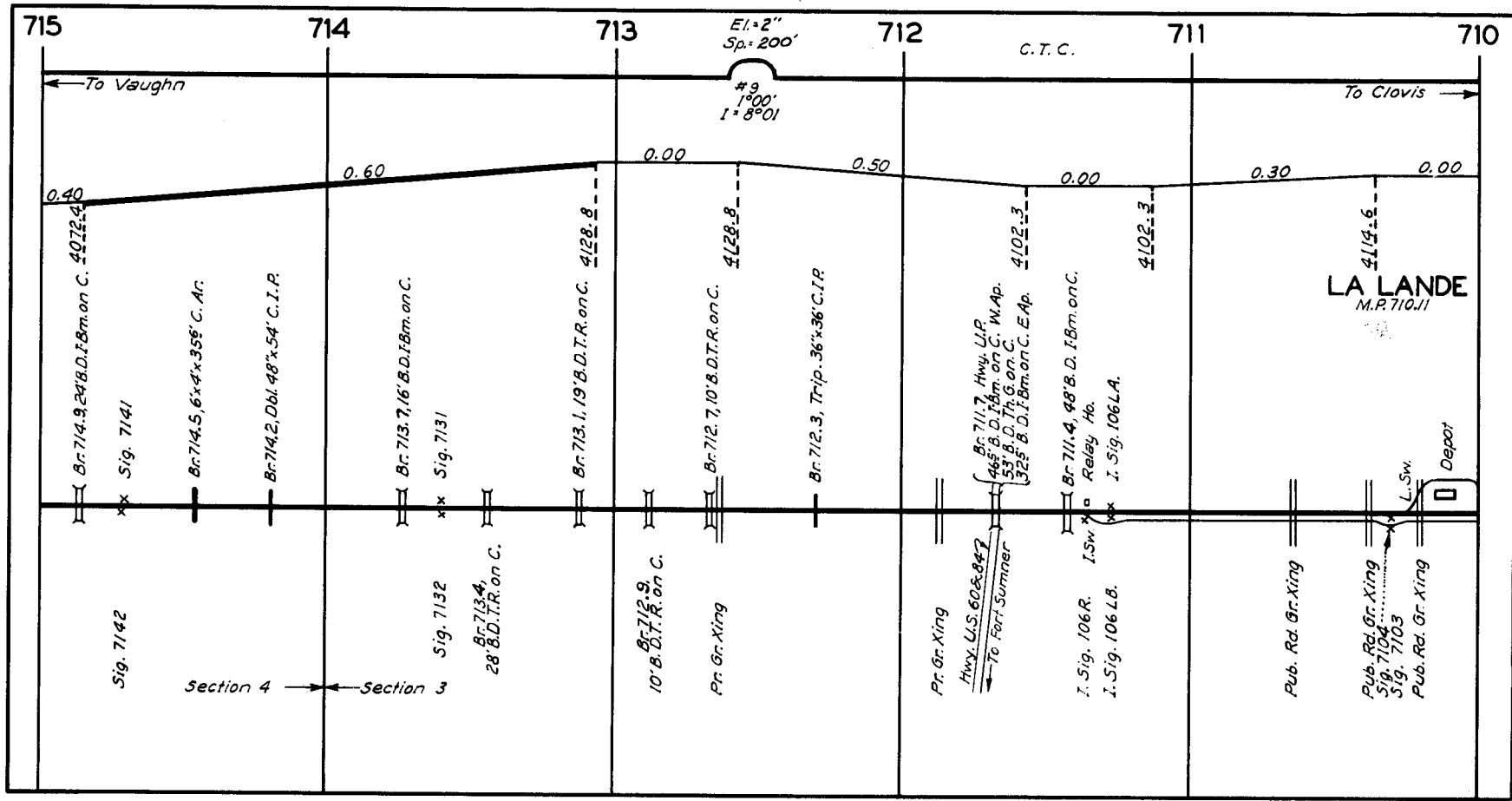

715

714

713

712

711

710

EI = 2"  
Sp = 200'

C.T.C.

← To Vaughn

To Clovis →

#9  
1°00'  
I = 8°01'

0.40

0.60

0.00

0.50

0.00

0.30

0.00

Br 714.9, 24' B.D. IBm. on C. 4072.4

xx Sig. 7141

Br 714.5, 6' x 4' x 356' C. A.C.

Br 714.2, Dbl. 48' x 54' C.I.P.

Br 713.7, 16' B.D. IBm. on C.

xx Sig. 7131

Br 713.4,  
28' B.D. T.R. on C.

Br 713.1, 19' B.D. T.R. on C. 4128.8

Br 712.9,  
10' B.D. T.R. on C.

Br 712.7, 10' B.D. T.R. on C.

4128.8

Br 712.3, Trip. 36' x 36' C.I.P.

Pr. Gr. Xing

Hwy. U.S. 60 & 847  
To Fort Sumner

Br 711.7, Hwy. L.P.  
465' B.D. IBm. on C. W.Ap.  
53' B.D. T.R. on C.  
325' B.D. IBm. on C. E.Ap.

I. Sig. 106R. I.Sw. 7' x 10' Relay Ho.

I. Sig. 106 L.B. xx I. Sig. 106 L.A.

4102.3

Pub. Rd. Gr. Xing

LA LANDE  
M.P. 710.11

Pub. Rd. Gr. Xing  
Sig. 7104

Pub. Rd. Gr. Xing  
Sig. 7103

Pub. Rd. Gr. Xing  
L.Sw.

Depot

Sig. 7142

Section 4

Section 3



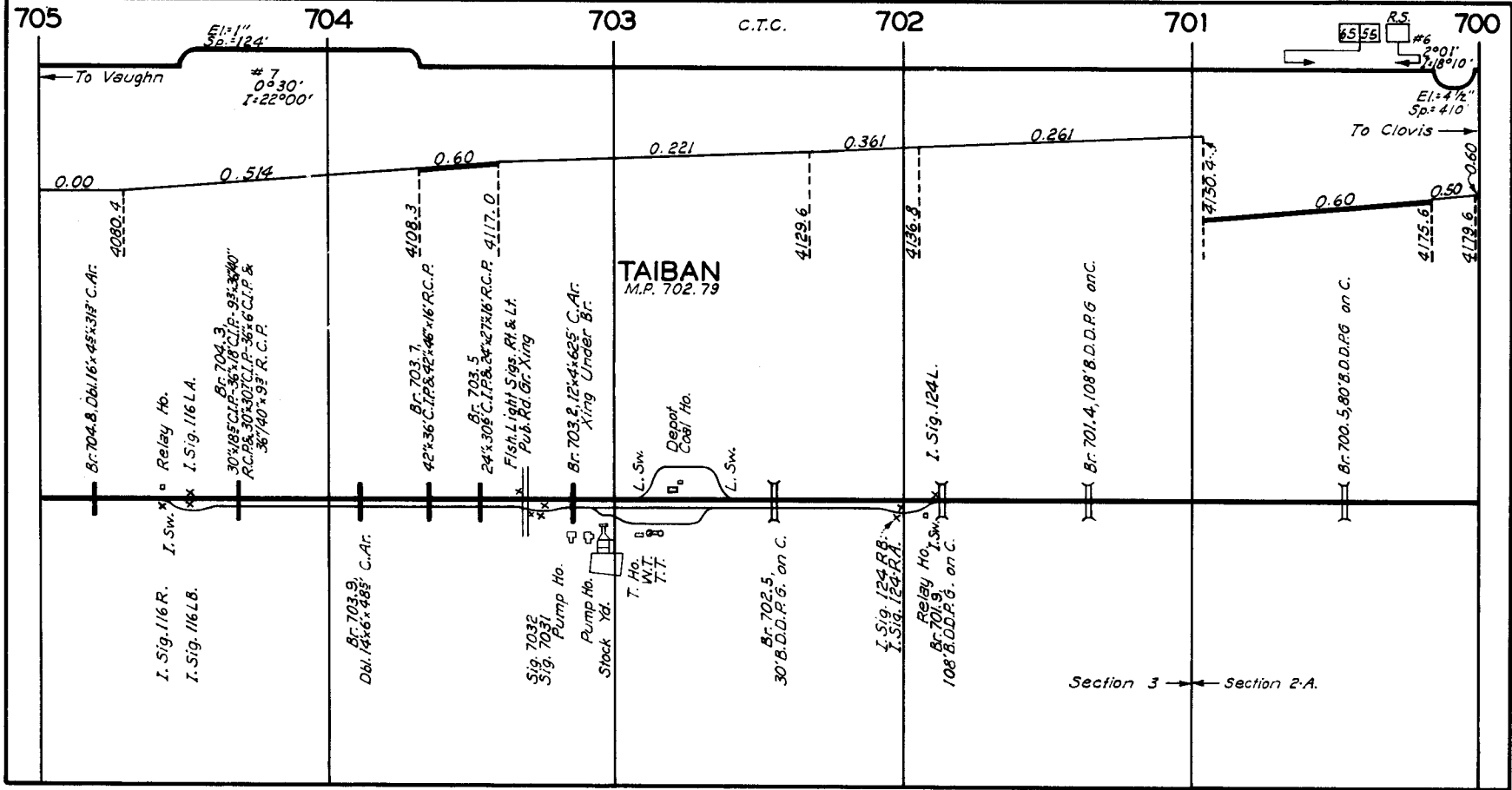

705

704

703

C.T.C.

702

701

700

To Vaughn

To Clovis

El: 1"  
Sp: 124'

# 7  
0°30'  
1:22°00'

6555 R.S. #6  
2°01'  
218°10'

El: 4 1/2"  
Sp: 410'

0.00

0.514

0.60

0.221

0.361

0.261

0.60

0.50

Br. 704.8, Dbl. 16' x 45' x 317' C.A.F.

I. Sw. x I. Sig. 116 R.  
I. Sig. 116 L.B.

Br. 704.3  
30' x 185' C.I.P. - 36' x 18' C.I.P. - 93' x 40'  
R.C.P. 30' x 307' C.I.P. - 36' x 6' C.I.P. &  
36' x 140' x 93' R.C.P.

Br. 703.7  
42' x 36' C.I.P. & 42' x 46' x 16' R.C.P.

Br. 703.5  
24' x 308' C.I.P. & 24' x 27' x 16' R.C.P. 4117.0  
Fish. Light Sigs. Rt. & Lt.  
Pub. Rd. Gr. Xing

Br. 703.2, 12' x 4' x 625' C.A.F.  
Xing Under Br.

TAIBAN  
M.P. 702.79

L. Sw. Depot Coal Ho.  
T. Ho. W.T. T.T.

Br. 702.5  
30' B.D.D.P.G. on C.

I. Sig. 124 R.B.  
I. Sig. 124 R.A.  
Relay Ho. I. Sw.  
Br. 701.9  
108' B.D.D.P.G. on C.

Br. 701.4, 108' B.D.D.P.G. on C.

Br. 700.5, 80' B.D.D.P.G. on C.

4080.4

4108.3

4129.6

4136.3

4175.6

4179.6

Section 3 ← Section 2.A

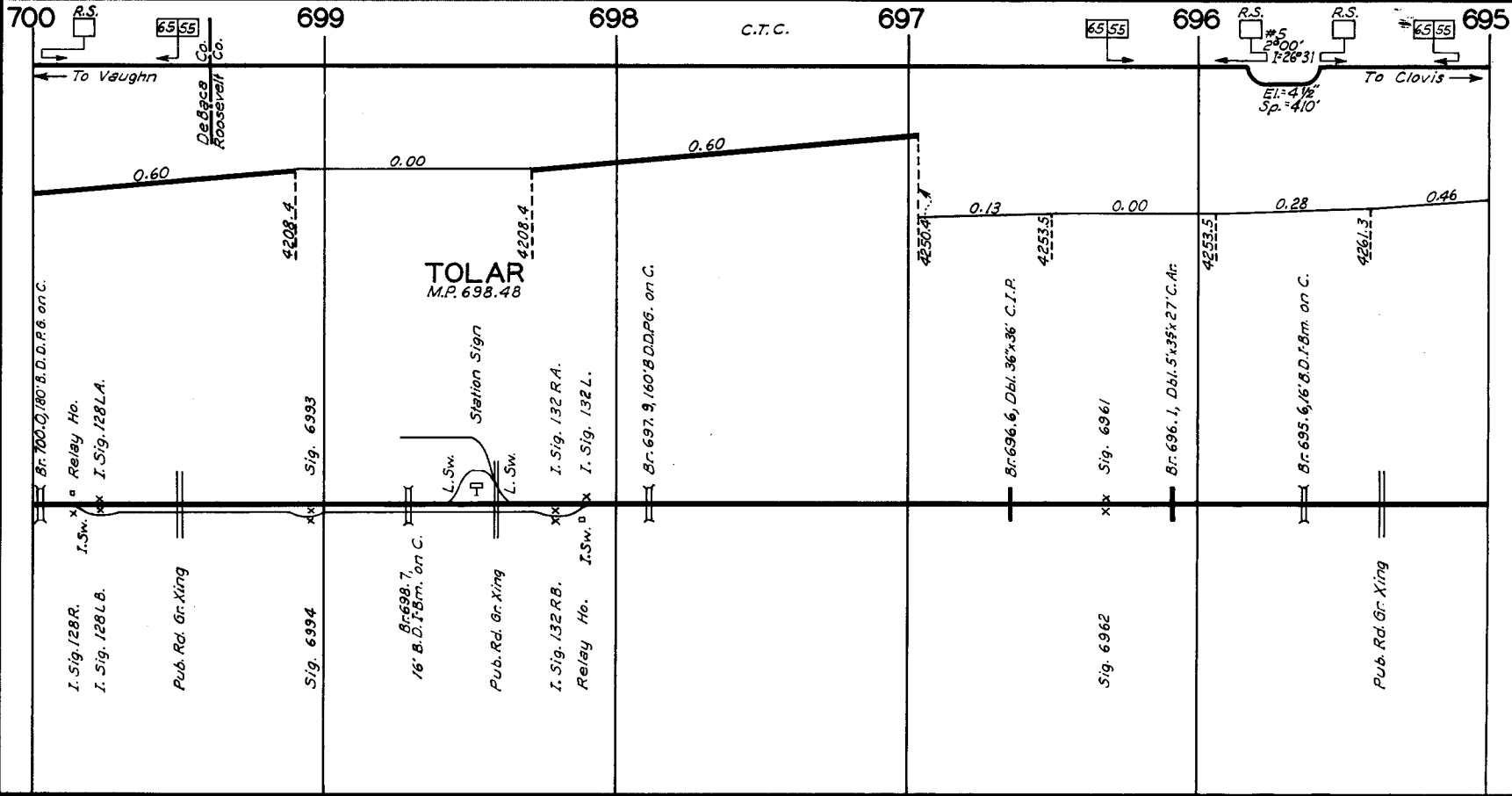

700

R.S.

6555

699

698

C.T.C.

697

6555

696

R.S.

R.S.

6555

695

To Vaughn

De. Bepca  
Roosevelt Co.

To Clovis

EL. = 4 1/2'  
Sp. = 410'

0.60

0.00

0.60

0.13

0.00

0.28

0.46

4208.4

4208.4

4250.4

4253.5

4253.5

4261.3

**TOLAR**  
M.P. 698.48

Station Sign

Br. 698.7, 16' B.D. 15m. on C.

Pub. Rd. Gr. Xing

I. Sig. 132R.B.

Relay Ho. I.Sw. x I. Sig. 132L.

Br. 697.9, 160' B.D.D.P.G. on C.

Br. 696.6, Dbl. 36"x36" C.I.P.

x x Sig. 6961

Br. 696.1, Dbl. 5'x35'x27' C. Ar.

Br. 695.6, 16' B.D. 1.8m. on C.

Pub. Rd. Gr. Xing

I. Sig. 128R.

I. Sig. 128L.B.

x a Relay Ho.

x x I. Sig. 128L.A.

Pub. Rd. Gr. Xing

Sig. 6994

x x Sig. 6993

Sig. 6962

695

694

693

692

691

690

C.T.C.

EI: 2 1/2'  
Sp.: 570'

To Vaughn

To Clovis

0.46

0.60

0.55

0.13

0.05

0.00

0.3915

0.60

4275.2

4302.27  
4305.3

4310.4

4308.4

4308.4

4333.8

**KRIDER**  
M.P. 693.39

Br. 694.6, 36' B.D.I.Bm on C.  
x o Relay Ho.  
x x I. Sig. 136 L.A.

I. Sig. 136 R.  
I. Sw.  
I. Sig. 136 L.B.

Br. 693.8, 11' B.D.I.R. on C.

10' B.D.I.R. on C.

Station Sign  
Pub. Rd. Gr-Xing

Pub. Rd. Gr-Xing

Stock Yd.

Burnk Ho.

Br. 692.4  
28' B.D.I.R. on C.  
I. Sig. 142 R.B.  
I. Sig. 142 R.A.  
Relay Ho.  
Pub. Rd. Gr-Xing  
I. Sw.  
I. Sig. 142 L.

Br. 691.7, 10' B.D.I.R. on C.

Br. 691.3, 10' B.D.I.R. on C.

Br. 690.7, 24' B.D.I.Bm. on C.

Sig. 6902  
x x Sig. 6901

690

689

688

687

686

685

C.T.C.

Roosevelt Co.  
Curry Co.

#3  
1°00'  
I:9°40'  
El.: 2 1/2"  
Sp.: 480'

El.: 2 1/2"  
Sp.: 436'  
#2  
1°00'  
I:16°00'

To Vaughn

To Clovis

4366.2

4373.6

4324.6

4407.5

4407.5

4407.5

4403.4

0.60

0.20

0.50

0.46

0.00

0.20

0.06

0.064

Br. 689.5.24' B.D. 18m. on C.

Br. 689.0.24' B.D. 18m. on C.

Br. 687.6. Dbl. 48' x 45' C.I.R.

CANTARA  
M.P. 687.15

Br. 686.516' B.D. 18m. on C.

I. Sig. 146R.  
I. Sig. 146LB.  
I. Sw. x  
Relay Ho. xx I. Sig. 146LA.

Sig. 6873  
Sig. 6874

Station Sign  
Pub. Rd. Gr. Xing

I. Sig. 148RA.  
I. Sig. 148L.  
Relay Ho. x  
I. Sw. x  
I. Sig. 148RB.

Pr. Gr. Xing

Pr. Gr. Xing

Section 2A. ← Section 2

685

684

683

C.T.C.

682

681

680

To Vaughn

To Clovis

0.064 0.00 0.19 0.32 0.50 0.00 0.50 0.20 0.15

4400.4

4400.4

4390.5

4382.5

4369.5

4369.5

4385.0

4396.2

Br. 685.0, Trip. 48' x 36' C.I.P.

Sig. 6841

Sig. 6842

Pr. Gr. Xing

Pr. Gr. Xing  
Sig. 6831

Sig. 6832

Pr. Gr. Xing

Pump Ho. Boiler Ho.  
Br. 682.2, 60' B.D.D.P.G. on C.  
Pub. Rd. Gr. Xing

Garage  
I. Sig. 152 R. I. Sw.  
I. Sig. 152 L.B. Pub. Rd. Gr. Xing  
Bunk Ho. Sec. Tool Ho. Sig. Mainainers Ho.  
Br. 681.2, 46' B.D.T.R. on C.  
Relay Ho.  
I. Sig. 152 L.A.

MELROSE  
M.P. 680.81

Treating Ho. W.T. W. Col. Sig. 154 R. I. Sw.  
Depot  
I. Sig. 154 L.B.  
Stock Yd.  
Pub. Rd. Gr. Xing  
2-Fish. Sigs.

Pub. Rd. Gr. Xing  
Br. 680.2, 16' B.D.D.P.G. on C.

#1  
0°34'  
I=4°38'30"  
El.=1 1/2"  
Sp.=250'

#OC.W.B.  
0°31'41"  
I=1°11'37"  
#OH.E.B.  
0°31'41"  
I=1°11'37"

#OG.E.B.  
0°20'  
I=1°11'37"  
El.=1/2"  
Sp.=35'  
#OB.W.B.  
0°30'  
I=2°21'30"  
El.=1"  
Sp.=100'

R.S.  
#OE.E.B.  
0°06'  
I=0°21'  
#OF.E.B.  
0°06'  
I=0°21'  
#OA.W.B.  
0°06'  
I=0°20'  
I=1°09'53"  
El.=1/2"  
Sp.=50'

40 40

R.S.

L. Sw.

W.B.

E. B.

680

679

678

677

676

675

← To Vaughn

To Clovis →

C.T.C. → Automatic Block

0.15

0.00

0.151

0.08

0.00

0.21

0.21

4400.4

4400.4

4411.4

4409.4

4409.4

4420.3

C.T.C.: Centralized Traffic Control

I. Cent. Sig. 158RA & 160R.  
Relay Ho.  
I. Sw. I. Cent. Sig. 158L & 160L.  
I. Sw. I. Sig. 158RB.

Br. 679, 3, 24, B, D, I, Bm. on C.

Br. 678, 4, 24, B, D, I, Bm. on C.

Sig. 6771

W.B. →

Br. 676, 8, 48, B, D, I, Bm. on C.

Sig. 6751

Sig. 6772

E.B. →

Sig. 6752

Section 2 ← Section 1-B



675

674

673

672

671

670

Automatic Block

To Vaughn ←

→ To Clovis

4422.3

0.36

0.00

0.15

0.00

0.26

0.00

0.13

4394.3

4394.3

4388.3

4397.4

4397.4

ST. VRAIN  
M.P. 672.84

Pr. Gr. Xing

Sig. 6731

Br. 673.6, 16' B.D. I.B.m.on C.

Pub. Rd. Gr. Xing

Pub. Rd. Gr. Xing

Frt. & Mail Ho.  
Coal Ho.  
Station Sign

Dwarf. Sig. 6724  
Sig. 6722

Dwarf. Sig. 6723  
Sig. 6721

Pub. Rd. Gr. Xing

W.B.  
E.B.

4388.3

Br. 671.8, 48' B.D. I.B.m.on C.

Pub. Rd. Gr. Xing

Br. 670.4, 48' B.D. I.B.m.on C.

Pub. Rd. Gr. Xing  
Sig. 6702

Sig. 6701

670

669

668

667

666

665

Automatic Block

← To Vaughn

To Clovis →

0.13 0.00

0.50

0.17

0.05

0.183

4401.3

4401.3

4368.3

GRIER  
M.P. 667.4

4361.2

4357.4

Pub. Rd. Gr. Xing

Br. 668.1, 16.8 D.I.B. on C.C.P.

Dwarf Sig. 6673  
Sig. 6671

Br. 667.3, 10' B.D.T.R.

Br. 666.3, 7' Sig. 48' 36" C.I.P.  
2' 40' x 32' x 16' R.C.P.

Br. 665.2, 24' B.D.I.B. on C.C.P.

W.B.  
E.B.

Sig. 6682

Dwarf Sig. 6684

Station Sign

Pub. Rd. Gr. Xing

Section 1-B

Section 1-A

Pub. Rd. Gr. Xing

Sig. 6652

Sig. 6651

Pub. Rd. Gr. Xing

