

Interlocking  
Y

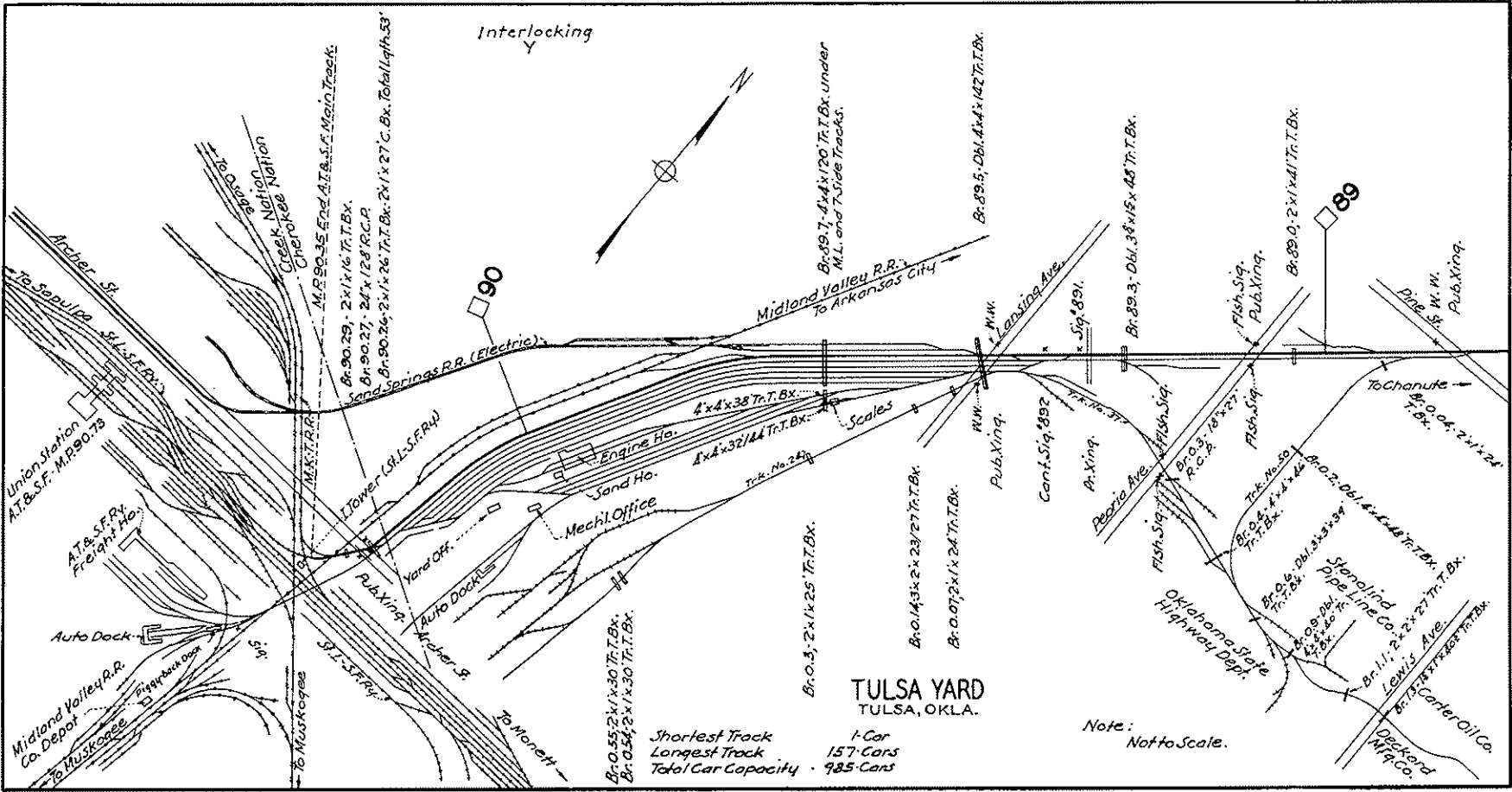
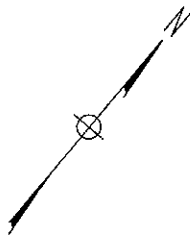

Shortest Track 1-Car  
Longest Track 157-Cars  
Total Car Capacity 985-Cars

**TULSA YARD**  
TULSA, OKLA.

Note:  
Not to Scale.

89

90

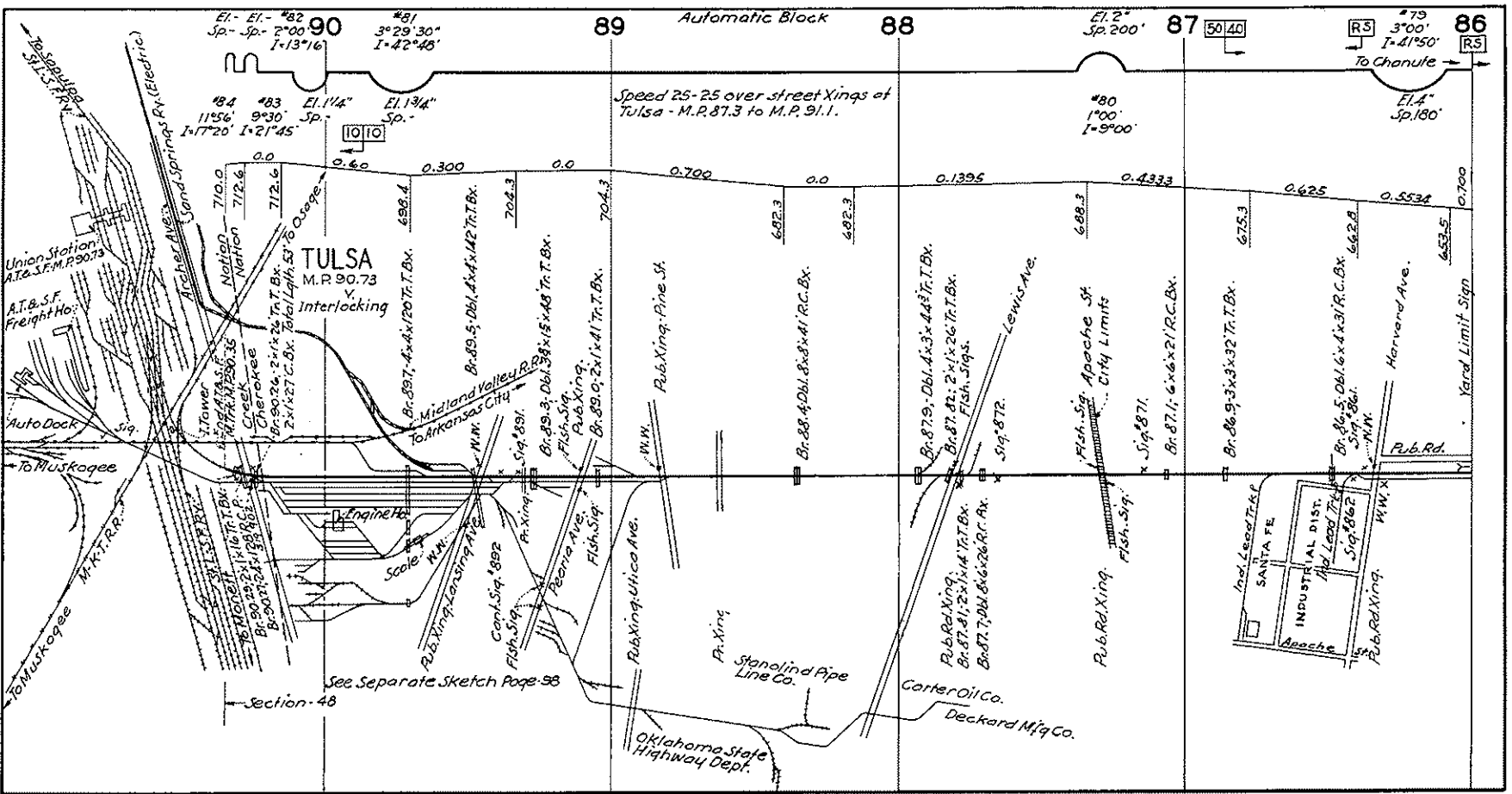

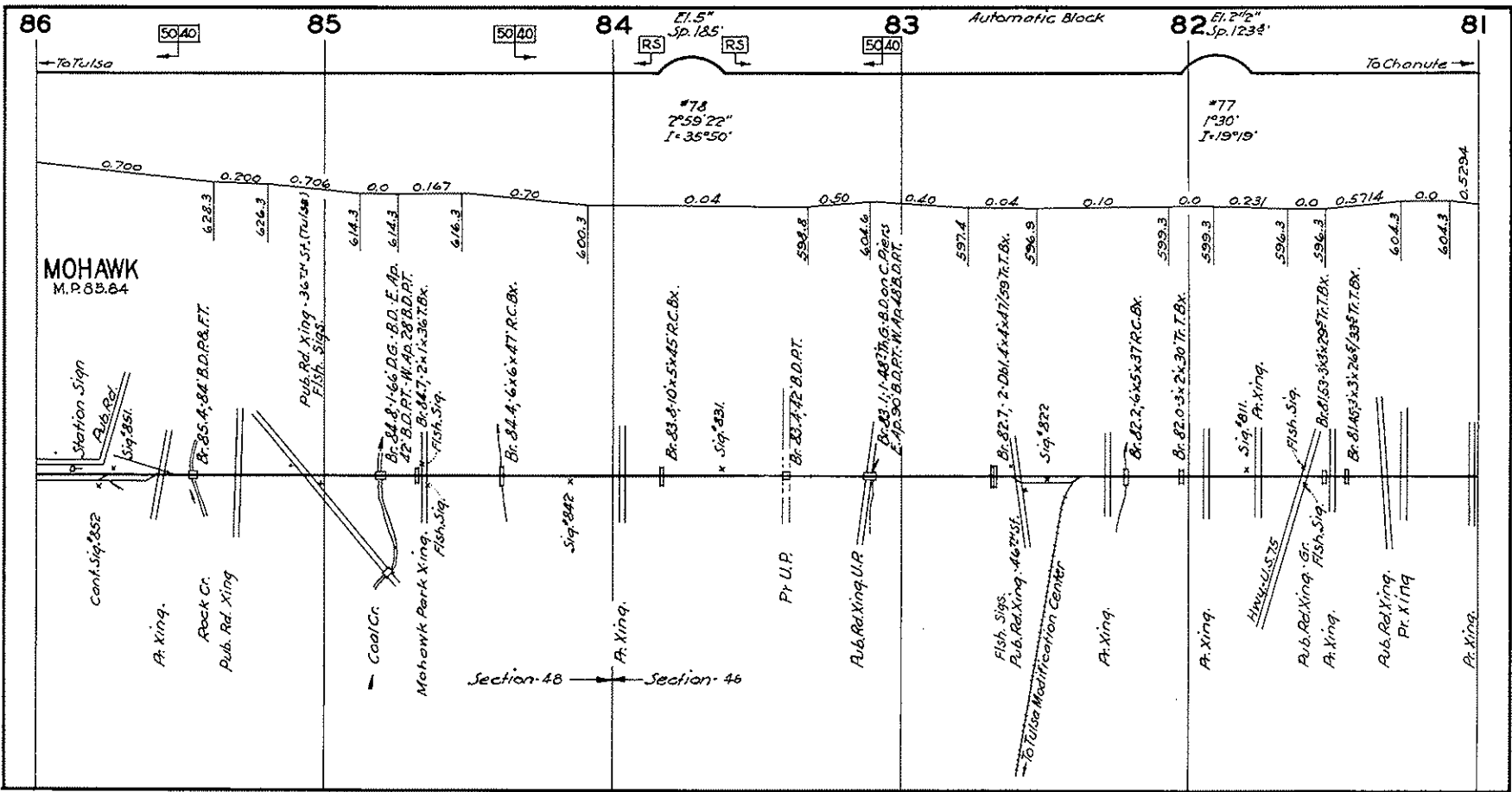

**MOHAWK**  
M.P. 83.84

→ To Tulsa

To Chanute →

#78  
7°59'22"  
I=36°50'

#77  
1°30'  
I=19°19'

Automatic Block

Section 48 ←      → Section 46

→ To Tulsa Modification Center

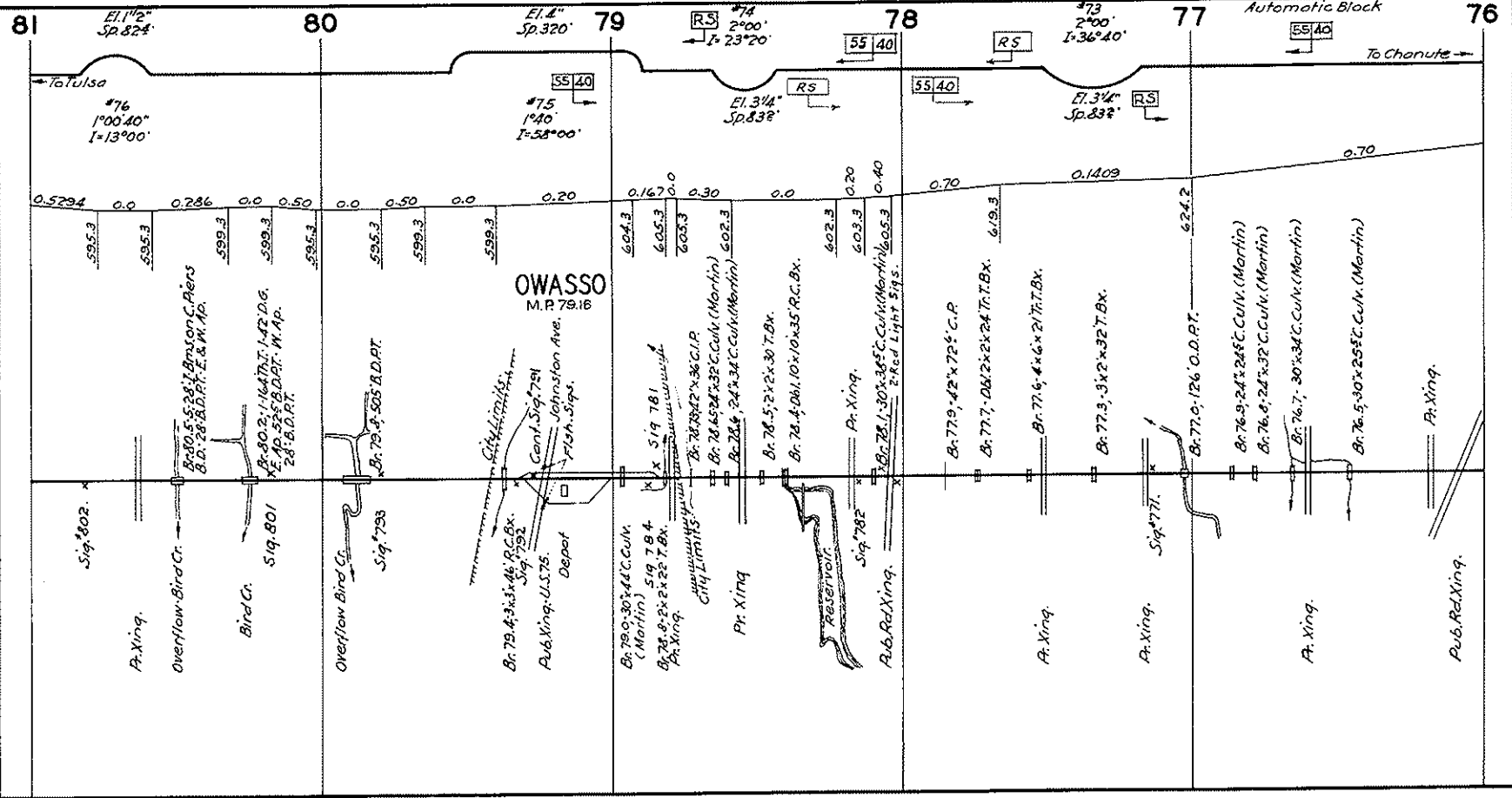

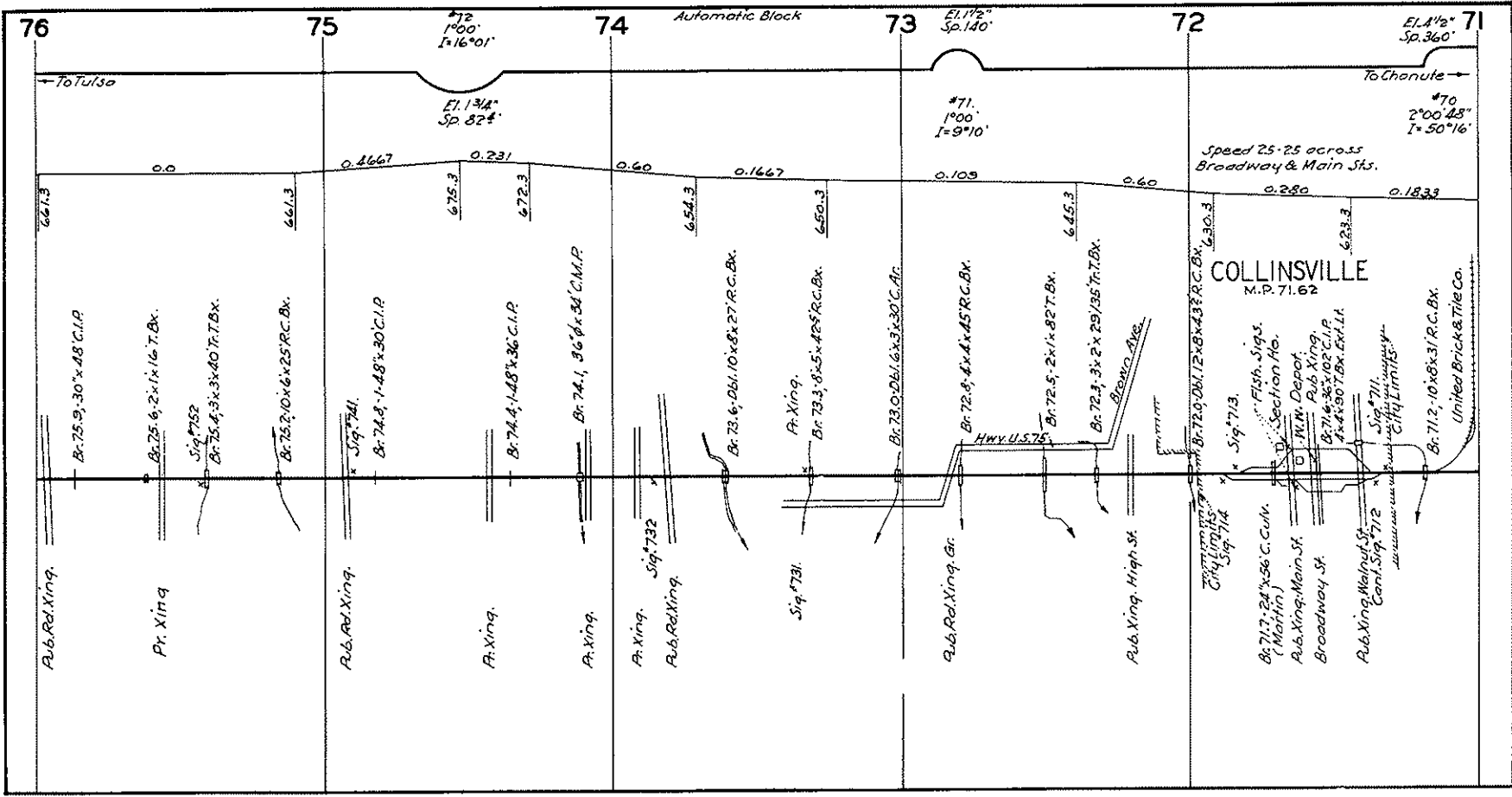

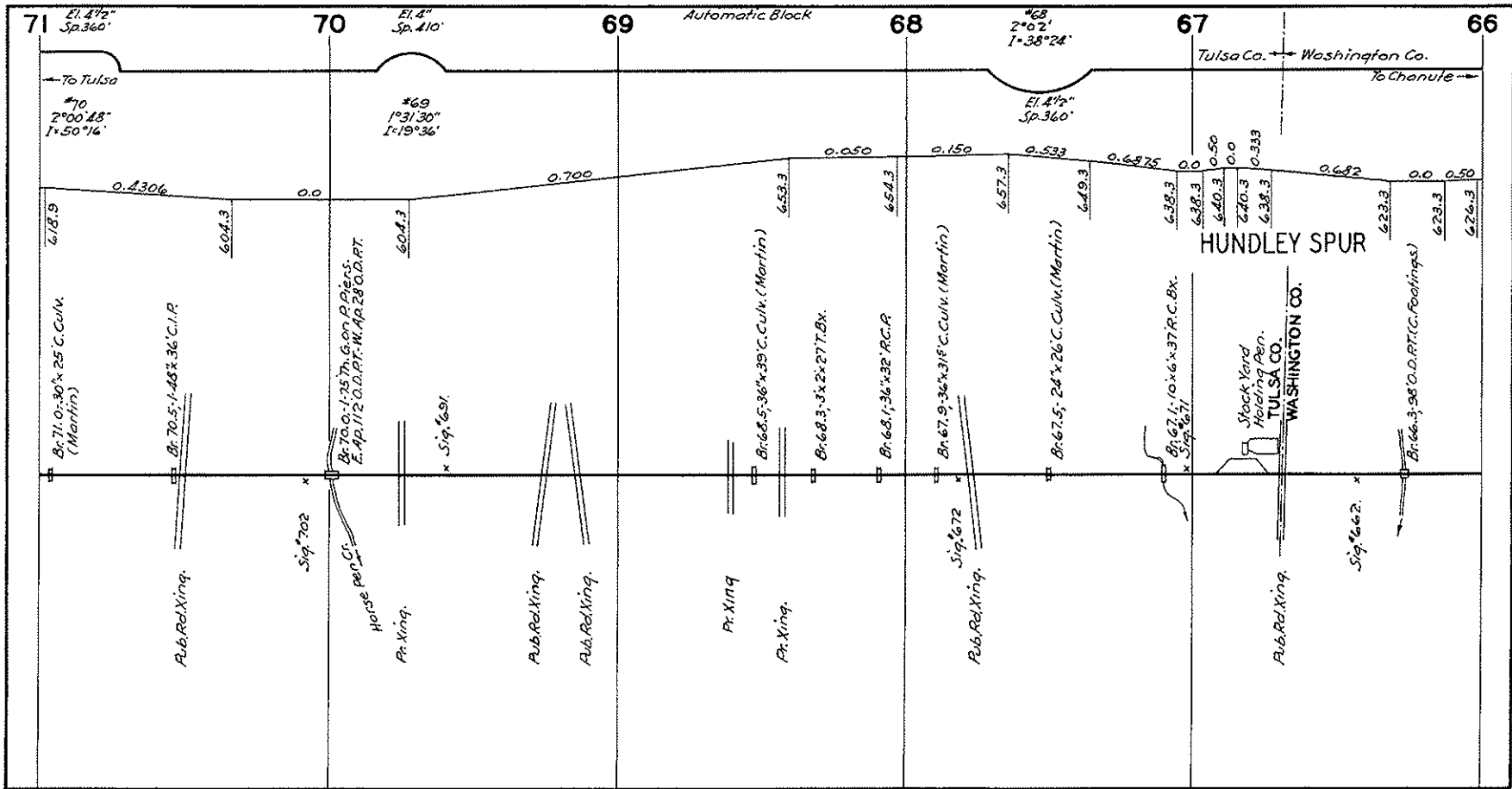

71  
El. 472  
Sp. 360  
To Tulsa  
70  
2° 00' 18"  
1-50° 14"

70  
El. 4  
Sp. 410  
69  
1° 31' 30"  
1-19° 36"

Automatic Block

68  
68  
2° 02'  
1-38° 28"  
El. 472  
Sp. 360

67  
Tulsa Co. → Washington Co.  
To Cherokee

HUNDLEY SPUR

WASHINGTON CO.

Stock Yard  
Wading Pen.  
TULSA CO.

Sig. 662

Sig. 702

Sub. Red Xing.

Horse Pen. C.

Pr. Xing.

Sub. Red Xing.

Sub. Red Xing.

Pr. Xing

Pr. Xing.

Sub. Red Xing.

Sig. 672

Sub. Red Xing.

Br. 66.3-98 O.D. RT. (C. Footings)

618.9 0.4306 604.3 0.0 604.3 0.700 653.3 0.050 654.3 0.150 657.3 0.533 649.3 0.6475 638.3 0.0 638.3 0.50 640.3 0.0 640.3 0.333 638.3 0.682 623.3 0.0 623.3 0.50 676.3

Br. 71.0-30 x 25 C. CULV. (Martin)  
Br. 70.5-1.48 x 36 C.I.P.  
Br. 70.0-1.25 TH. G. ON P. PILES. E. AP. 1/2 O.D. RT. W. AP. 2 1/2 O.D. RT.  
Br. 68.5-36 x 39 C. CULV. (Martin)  
Br. 68.3-3 x 2 x 27 T. BX.  
Br. 68.1-36 x 32 R.C.R.  
Br. 67.9-36 x 31 1/2 C. CULV. (Martin)  
Br. 67.5-24 x 26 C. CULV. (Martin)  
Br. 67.1-10 x 6 x 37 R.C. BX.  
Br. 66.3-98 O.D. RT. (C. Footings)

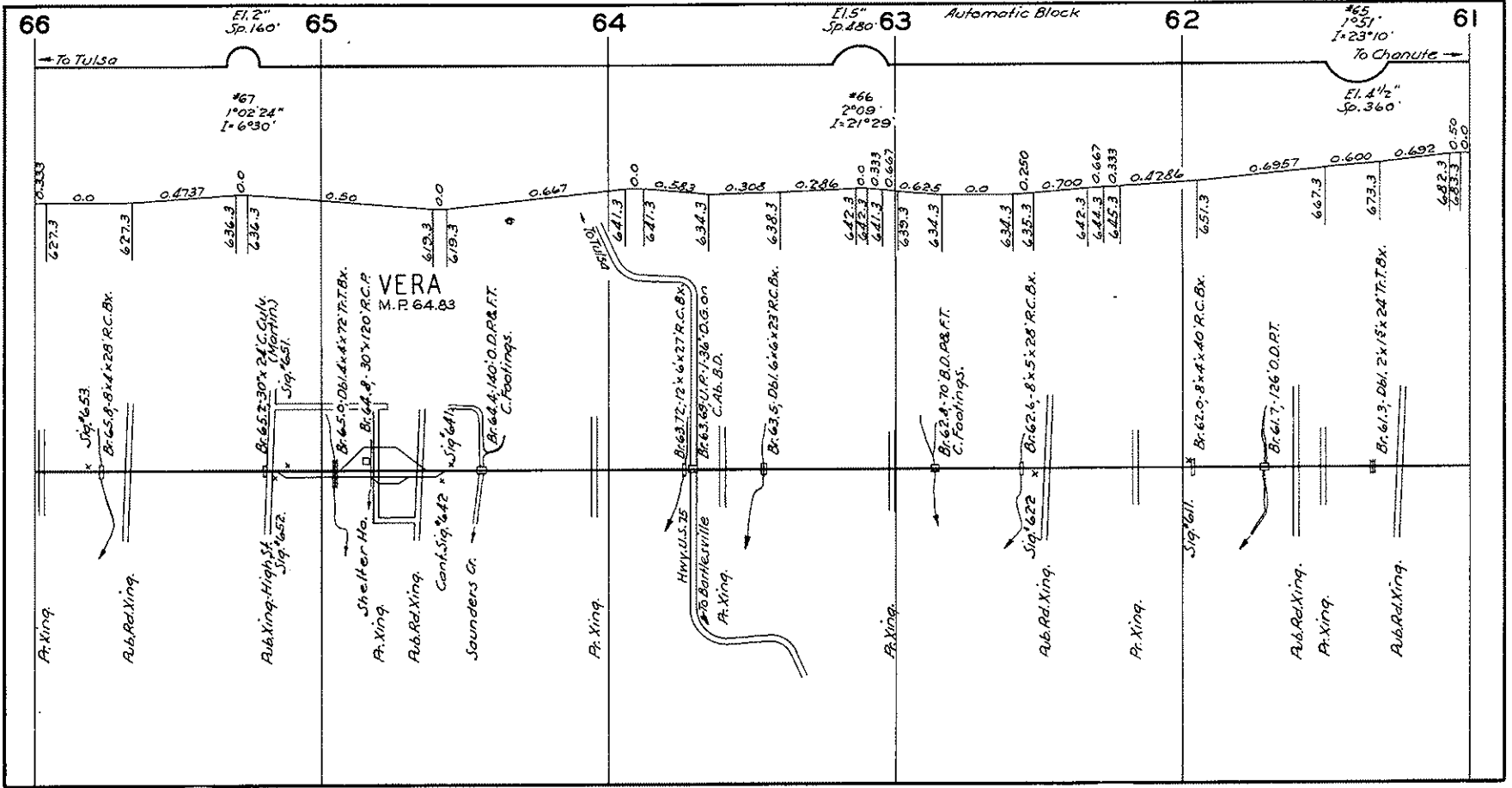

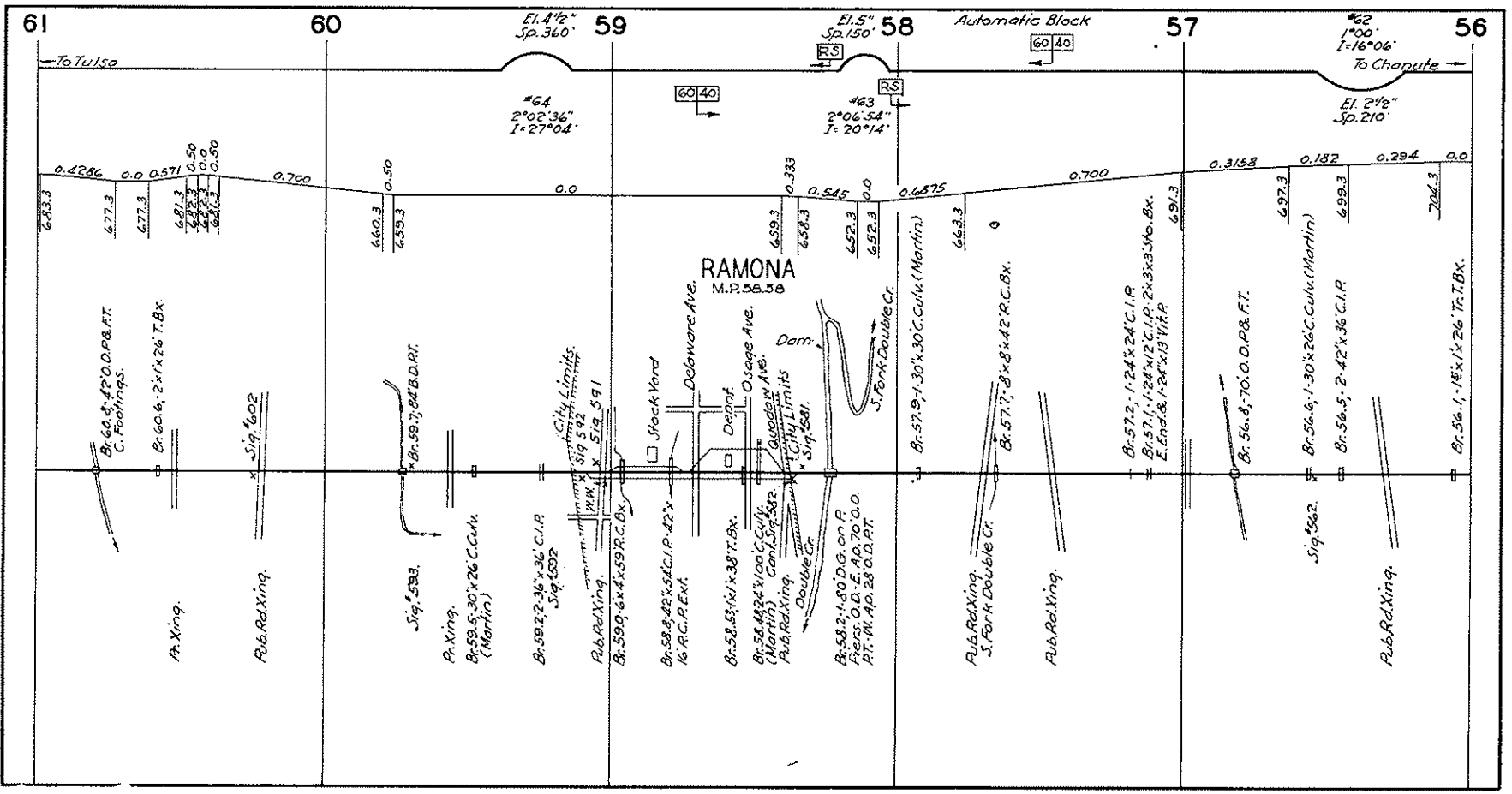

RAMONA  
M. 258.50

Automatic Block  
60 40

62  
1'00"  
I=16'06"

To Tulso

To Chopute

#64  
 $2^{\circ}02'36''$   
 $I=27^{\circ}04'$

#63  
 $2^{\circ}06'54''$   
 $I=20^{\circ}14'$

#62  
 $2^{\circ}12''$   
 $I=16^{\circ}06''$

283.3  
477.3  
477.3  
491.3  
491.3  
505.3  
505.3

660.3  
659.3

659.3  
658.3  
652.3  
652.3

697.3  
699.3

704.3

Br. 60.8-42'0.0 P.&T.  
C. Footings.

Pr. Xing.  
Br. 60.6-2'x1'26' T.B.K.

Pub. Rd. Xing.  
Sig. 602

Sig. 583  
Pr. Xing.  
Br. 59.7-84' B.D.R.T.

Br. 59.2-2'36'x36' C.I.P.  
Sig. 502

City Limits  
City Limits  
W.W. X. Sig. 542  
W.W. X. Sig. 591

Br. 59.0-6'4'x59' R.C. Bx.

Stock Yard  
Br. 58.8-45'x54' C.I.P. 42'x  
16' R.C. P. Ext.

Depot  
Osage Ave.  
Br. 58.48'x100' C. Culv.  
(Martin) Cant. Sig. 582  
Pub. Rd. Xing.  
City Limits  
City Limits  
Sig. 581

Br. 58.2-1'80' D.G. on P.  
Piers O.D.-E. 40.70' O.O.  
Pt.-W. Ap. 28' O.D.P.T.

J. For K Double Cr.  
Br. 57.9-130'x30' C. Culv. (Martin)

Pub. Rd. Xing.  
J. For K Double Cr.  
Br. 57.7-8'x8'x42' R.C. Bx.

Pub. Rd. Xing.

Br. 57.2-1'24'x24' C.I.P.  
Br. 57.1-1'24'x12' C.I.P. 2'x3'x36' Bx.  
E. End. & 1'24'x13' Vitr.

Br. 56.8-70'0.0 P.&T.

Sig. 562  
Br. 56.6-1'30'x26' C. Culv. (Martin)

Br. 56.5-2'42'x36' C.I.P.

Pub. Rd. Xing.

Br. 56.1-1'5'x1'26' Tr. T.B.K.



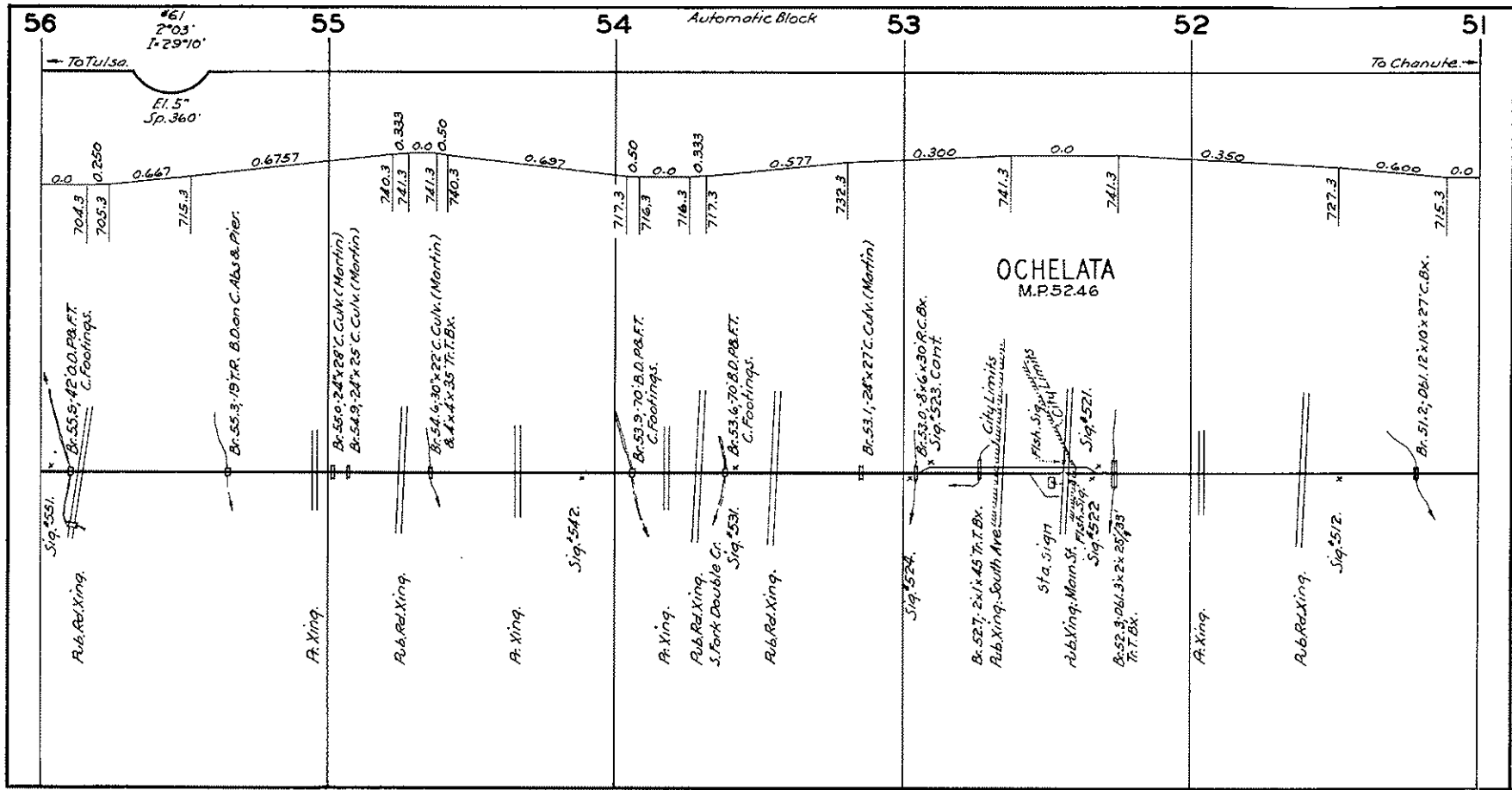

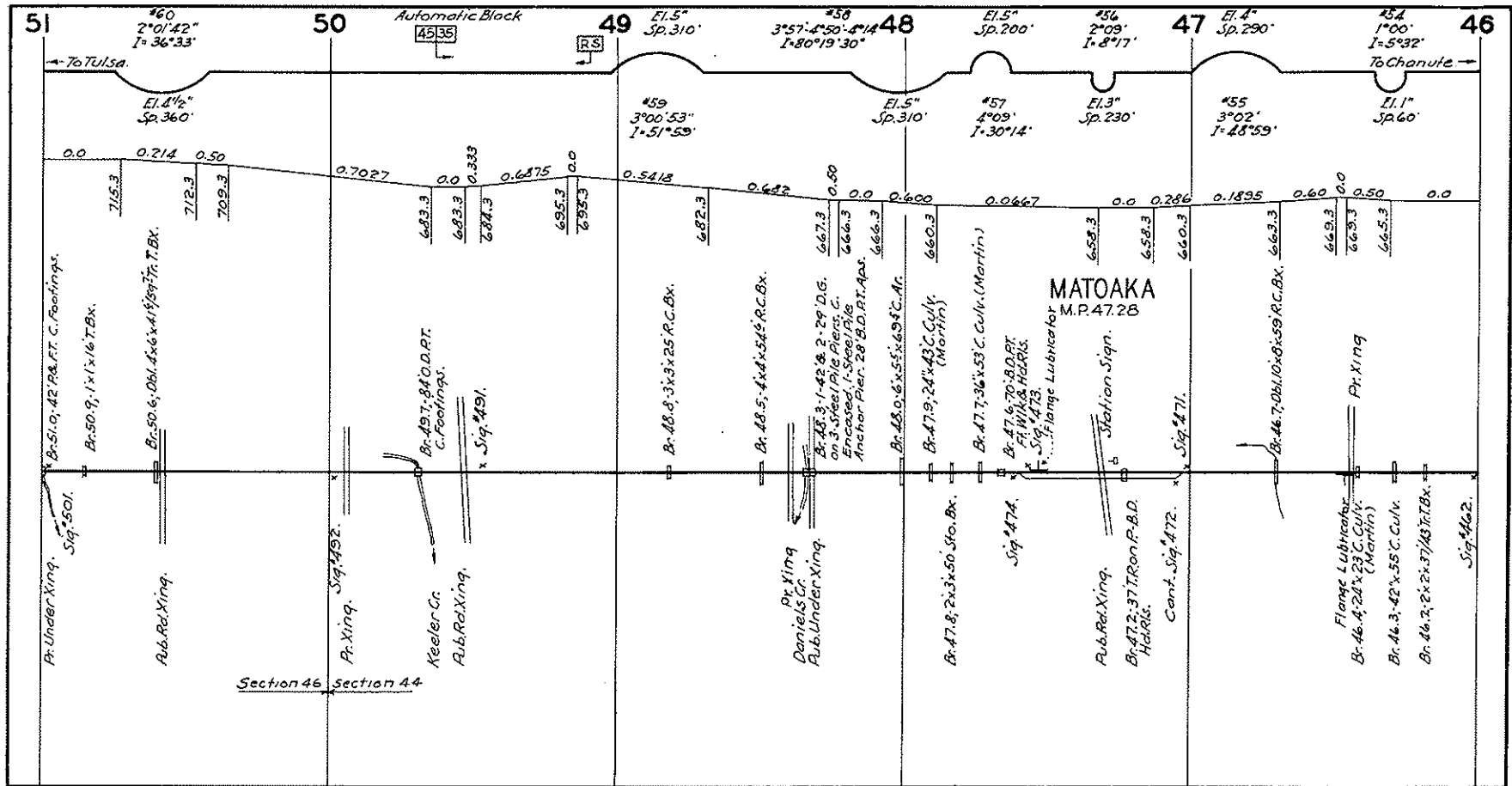

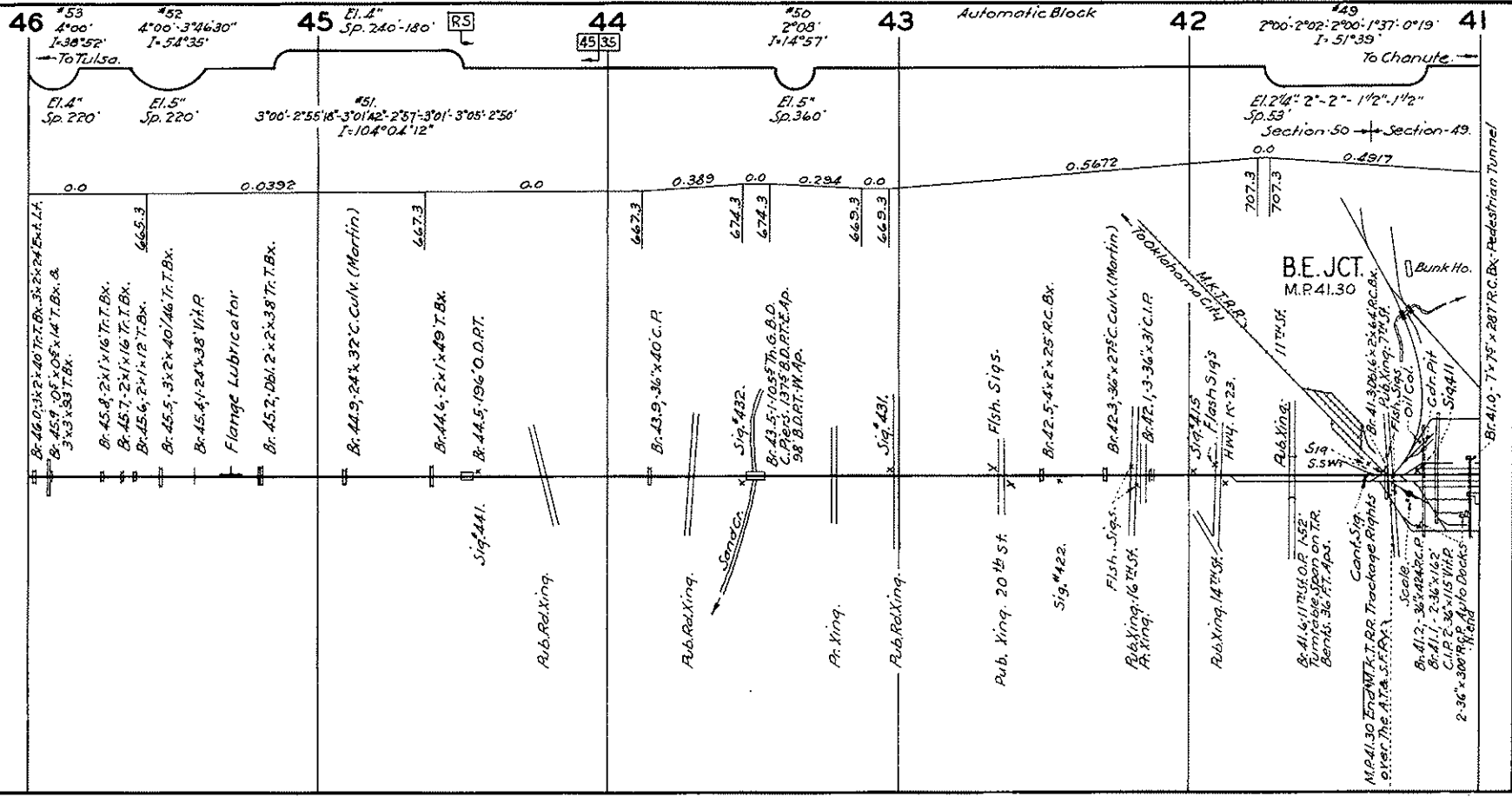

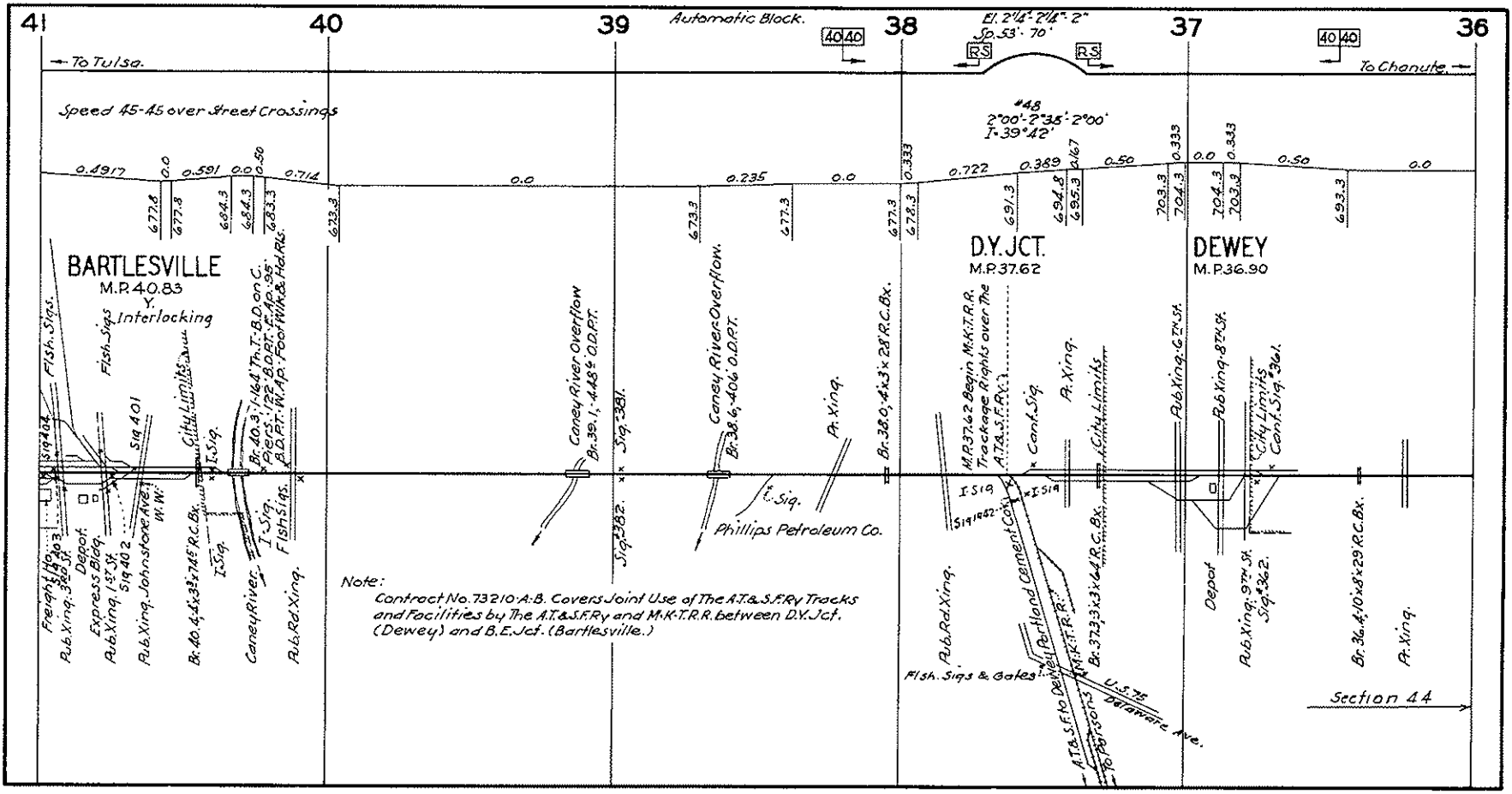

Note:  
 Contract No. 73210 A-B. Covers Joint Use of The A.T.&S.F.Ry Tracks  
 and Facilities by The A.T.&S.F.Ry and M.K.T.R.R. between D.Y. Jct.  
 (Dewey) and B.E. Jct. (Bartlesville.)

Section 44

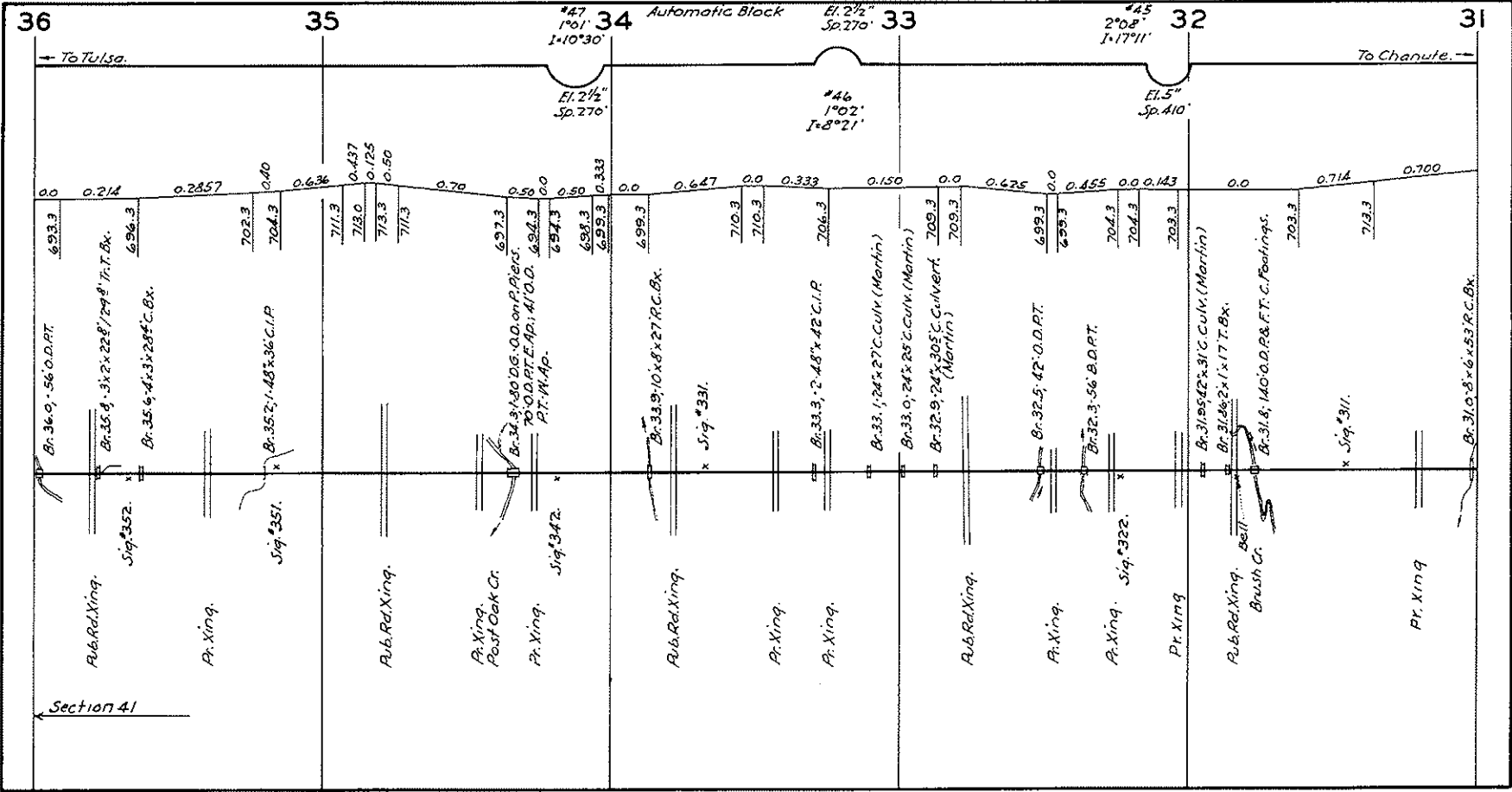

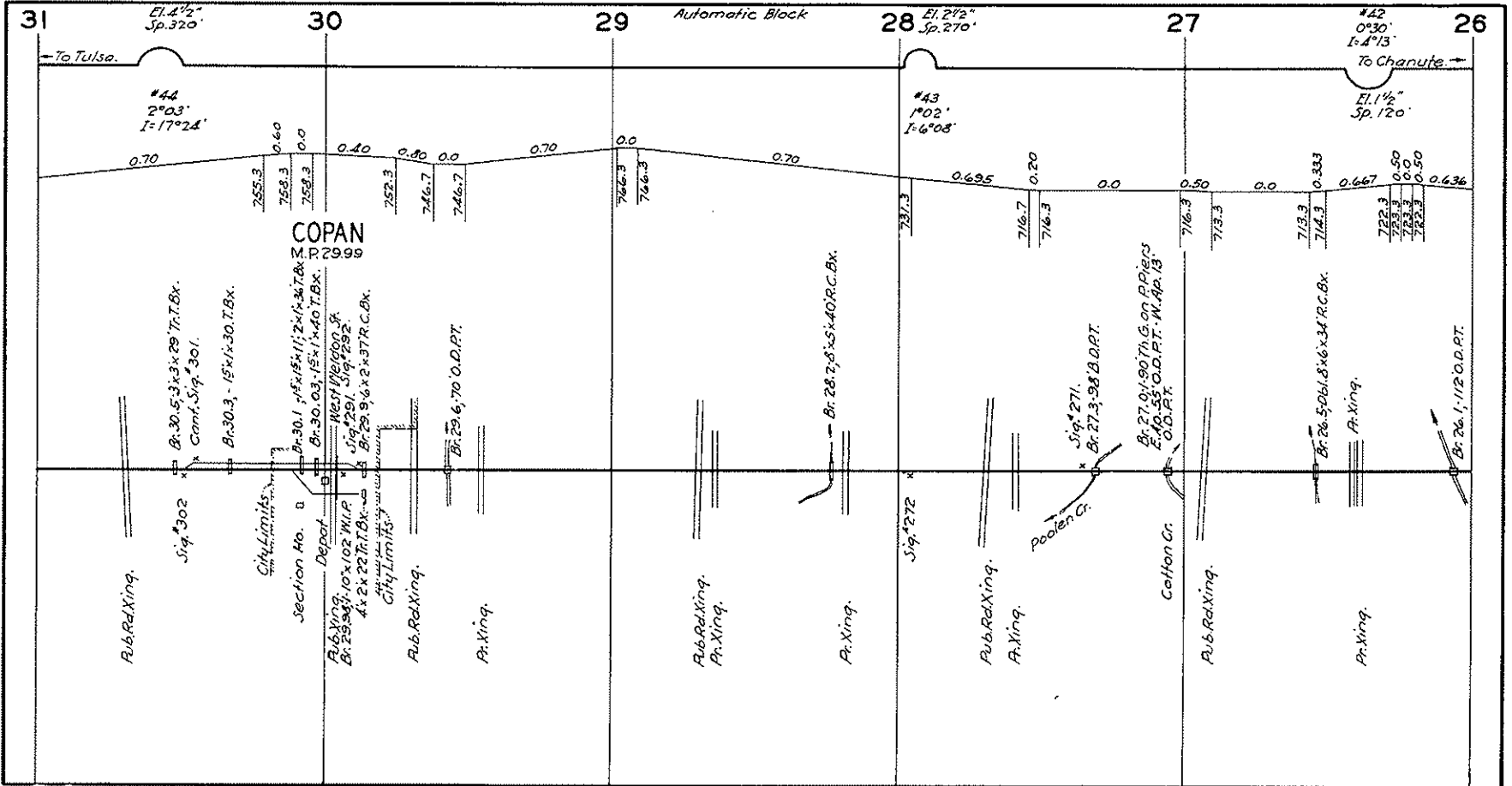

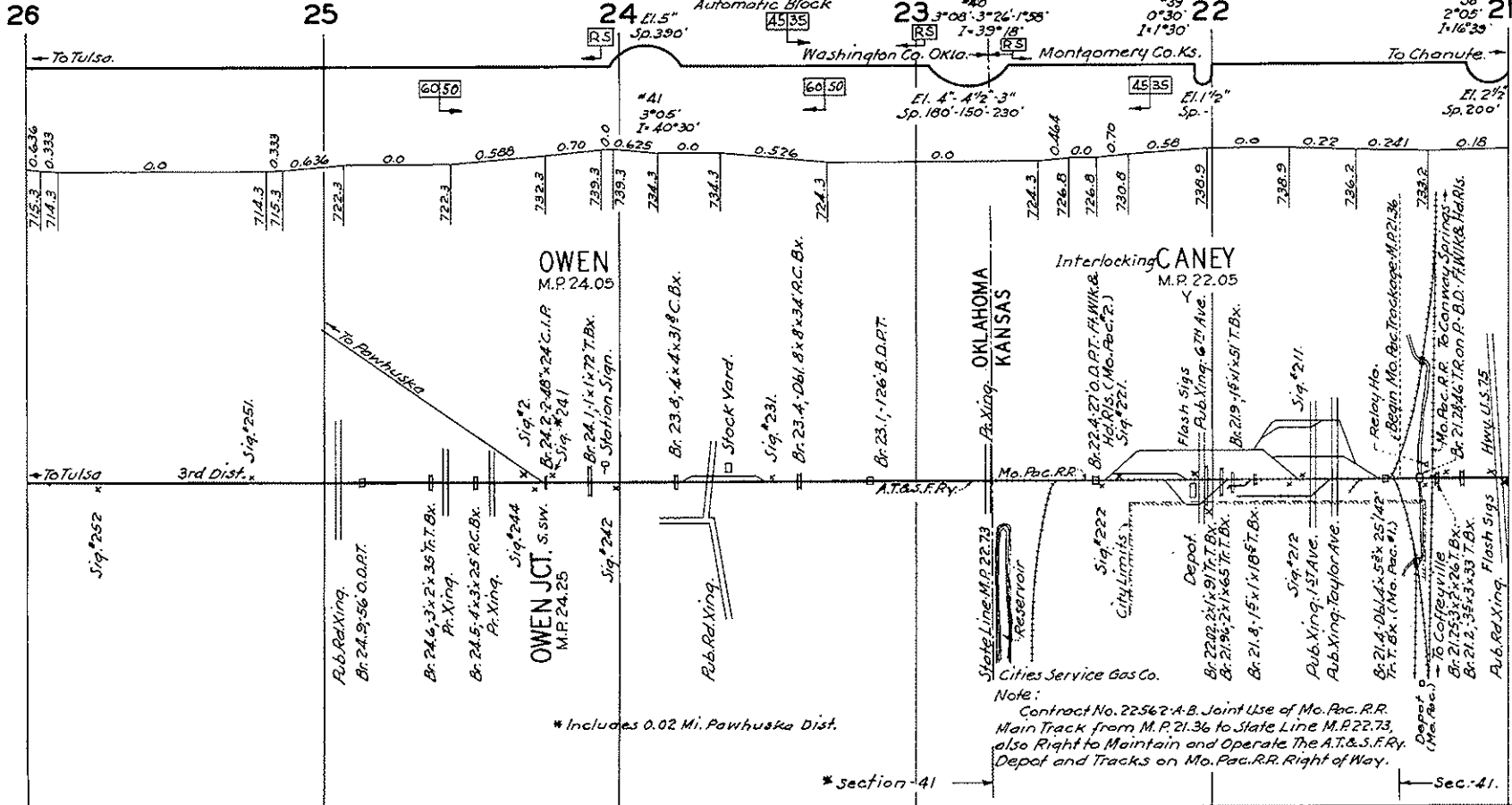

\* Includes 0.02 Mi. Pawhuska Dist.

Note:  
Contract No. 22562-A-B. Joint Use of Mo. Pac. RR. Main Track from M.P. 21.36 to State Line M.P. 22.73, also Right to Maintain and Operate The A.T. & S.F. Ry. Depot and Tracks on Mo. Pac. RR. Right of Way.

\* Section -41

Sec. -41.

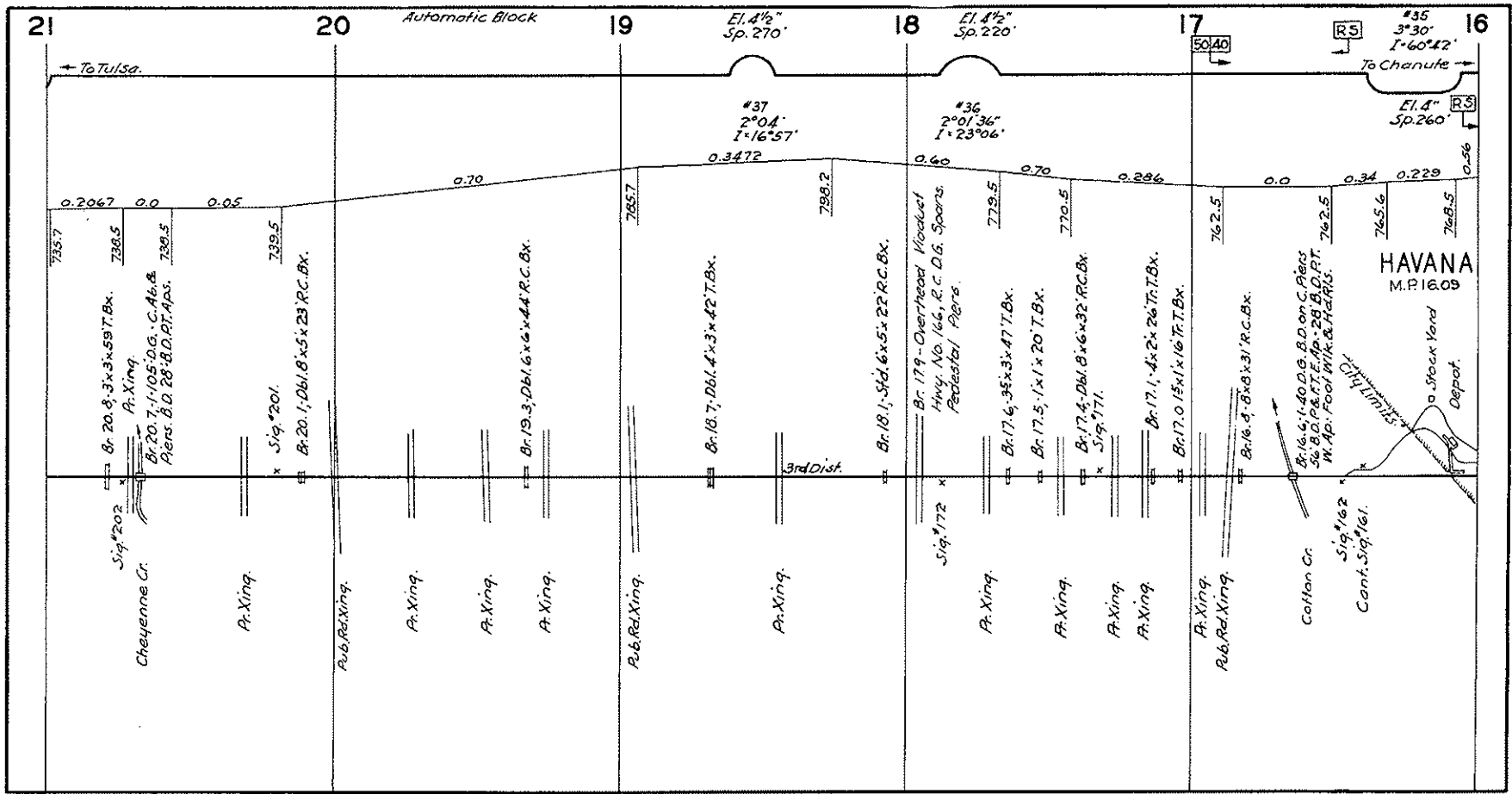



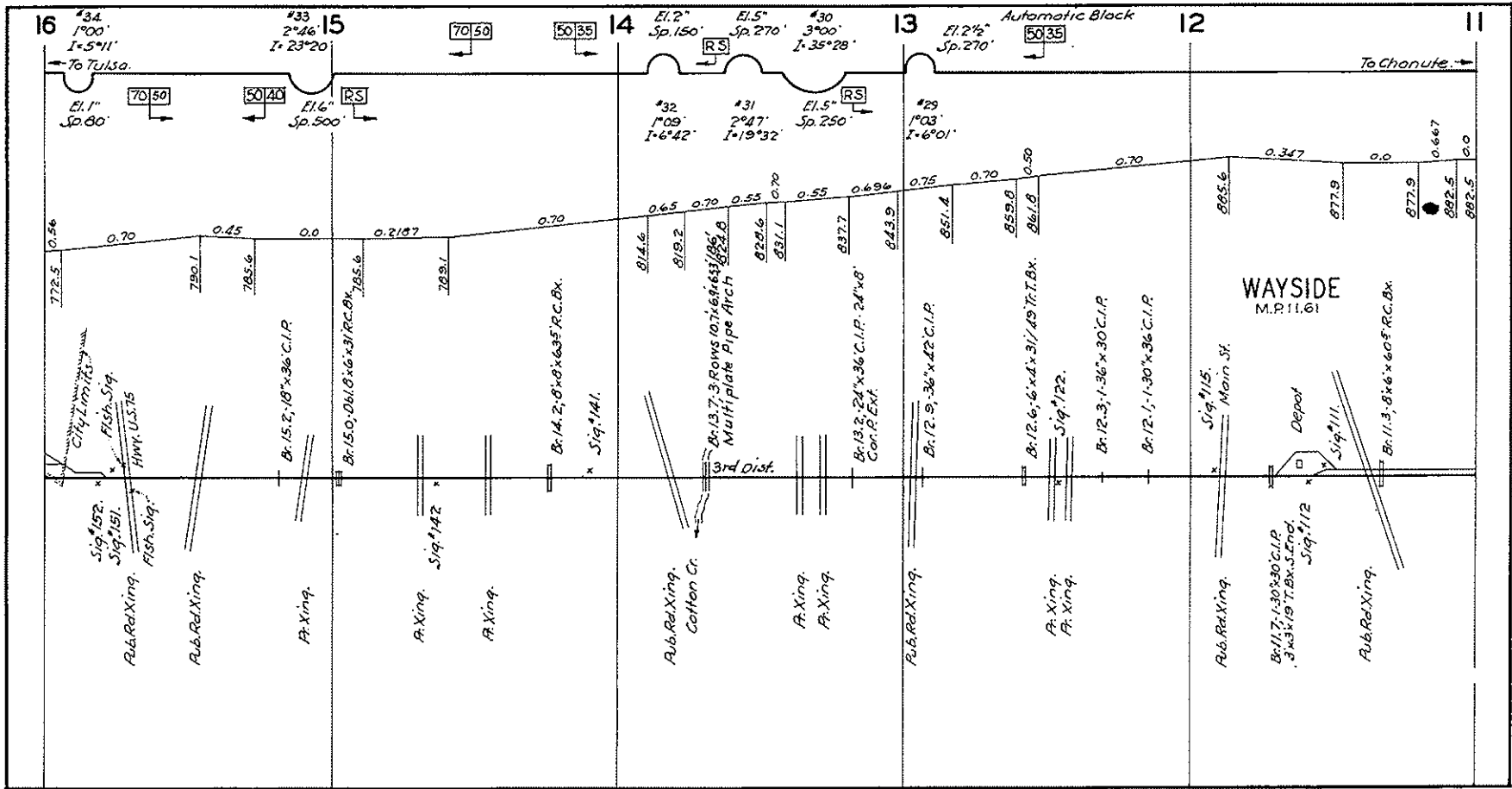

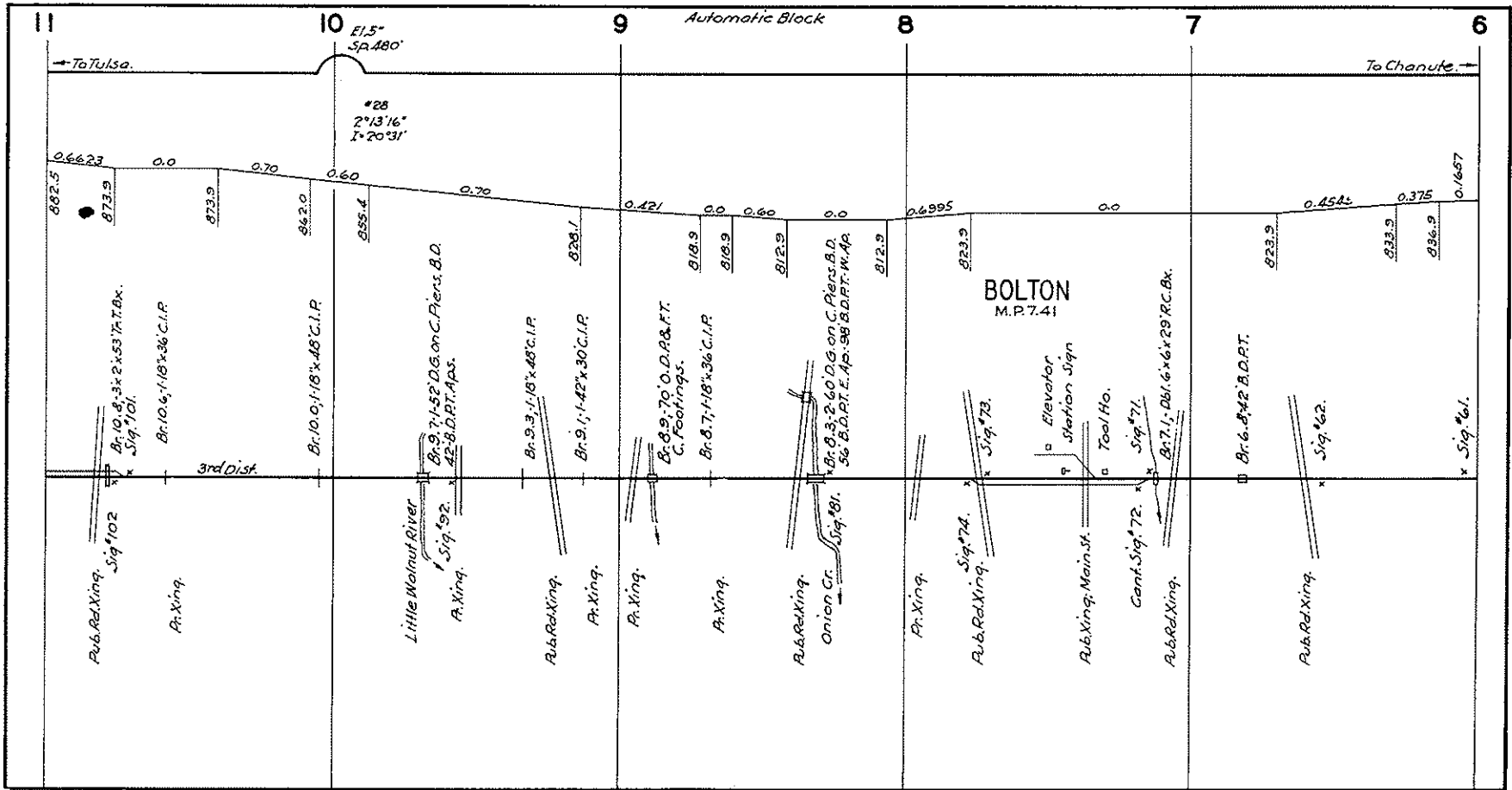

Automatic Block.

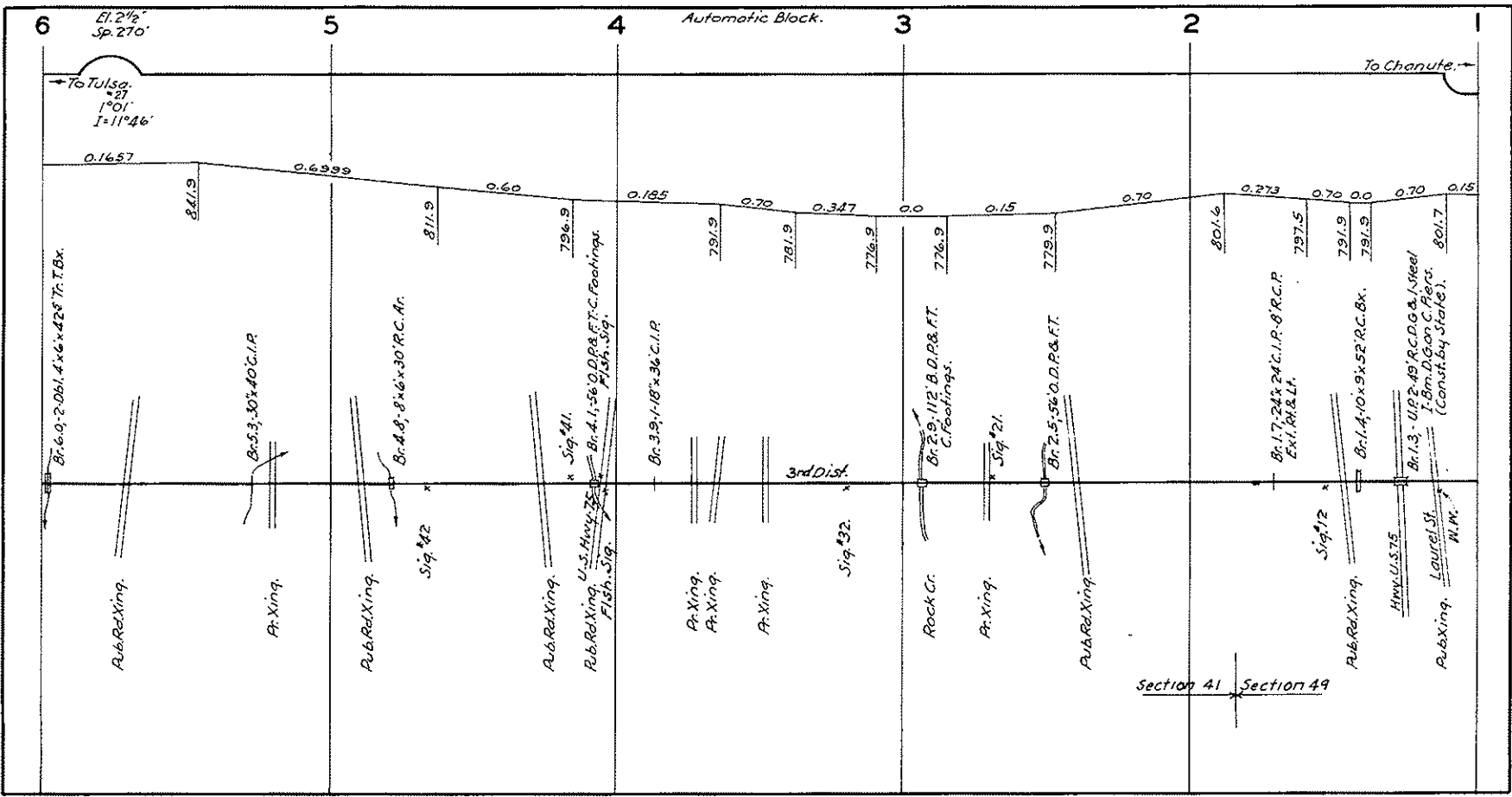

6  
El. 2 1/2"  
Sp. 270'

5

4

3

2

1

→ To Tulsa.  
• 21° 01'  
I = 11° 46'

To Chanute. →

0.1657 0.6999 0.60 0.7969 0.70 0.7969 0.70 0.7799 0.0 0.15 0.70 0.7919 0.0 0.70 0.15

Br. 6.0-2.061.4x6x428 Tr. T.Bx.  
 Rub. Rd. Xing.  
 Ar. Xing.  
 Br. 5.3-3.0x40 C.I.R.  
 Rub. Rd. Xing.  
 Sig. #42  
 Br. 4.8-8x6x30 R.C. Ar.  
 Ar. Xing.  
 Ar. Xing.  
 Ar. Xing.  
 3rd Dist.  
 Sig. #32  
 Br. 3.9-1.18x36 C.I.R.  
 Rock Cr.  
 Ar. Xing.  
 Ar. Rd. Xing.  
 Br. 2.5-56x0 D.P.&F.T.  
 Ar. Rd. Xing.  
 Br. 1.7-24x24 C.I.R. & R.C.P. Ext. R.H. & L.L.  
 Rub. Rd. Xing.  
 Hwy. U.S. 75  
 Br. 1.4-10x9x52 R.C. Bx.  
 Br. 1.3-UP 2-49 R.C.D.G. & 1-Steel I-8m. D.Gon C. Piers. (Const. by State).  
 Rub. Xing.  
 Laurel St.  
 N.W.

Section 41 Section 49