

625

624

623

622

621

620

C.T.C.

#142
0°30'
I=5°44'

#141
1°00'
I=6°20'

#140
0°30'
I=4°46'

To Clovis

To Amarillo

7087.3

0.396

0.60

0.18

0.34

0.08

0.20

0.15

Sig. 6241

Hwy. U.S. 60

Sig. 6242

County Rd.

Channel
FRIO DRAW
Dyke

I. Sw. Tool Hb.

I. Sig. 74R.

I. Sig. 74L.B.

B.C. 622.7196' B.D.P.T.

33x2.73/79
Tr. Bx.

64x19 B.
Dbl. 2x15/53
Tr. Bx.

Sig. 6214
Sig. 6213

Relay Hb.

I. Sw.

Pub. Rd. Gr. Xing

Sig. 6211 - M.C. Ho. & Garage

C. BUNK. Hb.

Depot

B.C. 621.96x3x428' R.C.P.

Sig. Maint. Hb.

B.C. 621. B. 2x18x58' Tr. Bx.

Main St. Gr. Xing & Fish Sig.

Platform

2x18x32' Bx.

Stock Yd.

L. Sw. B.C. 621.219' B.D.P.T.R.

FRIONA
M.P. 621.84

4010.0

4004.3

3997.5

3995.9

I. Sig. 78L.

Hwy. U.S. 60

I. Sig. 78R.A.

I. Sw.

I. Sig. 78R.B.

Relay Hb.

Pub. Rd. Gr. Xing

3989.6

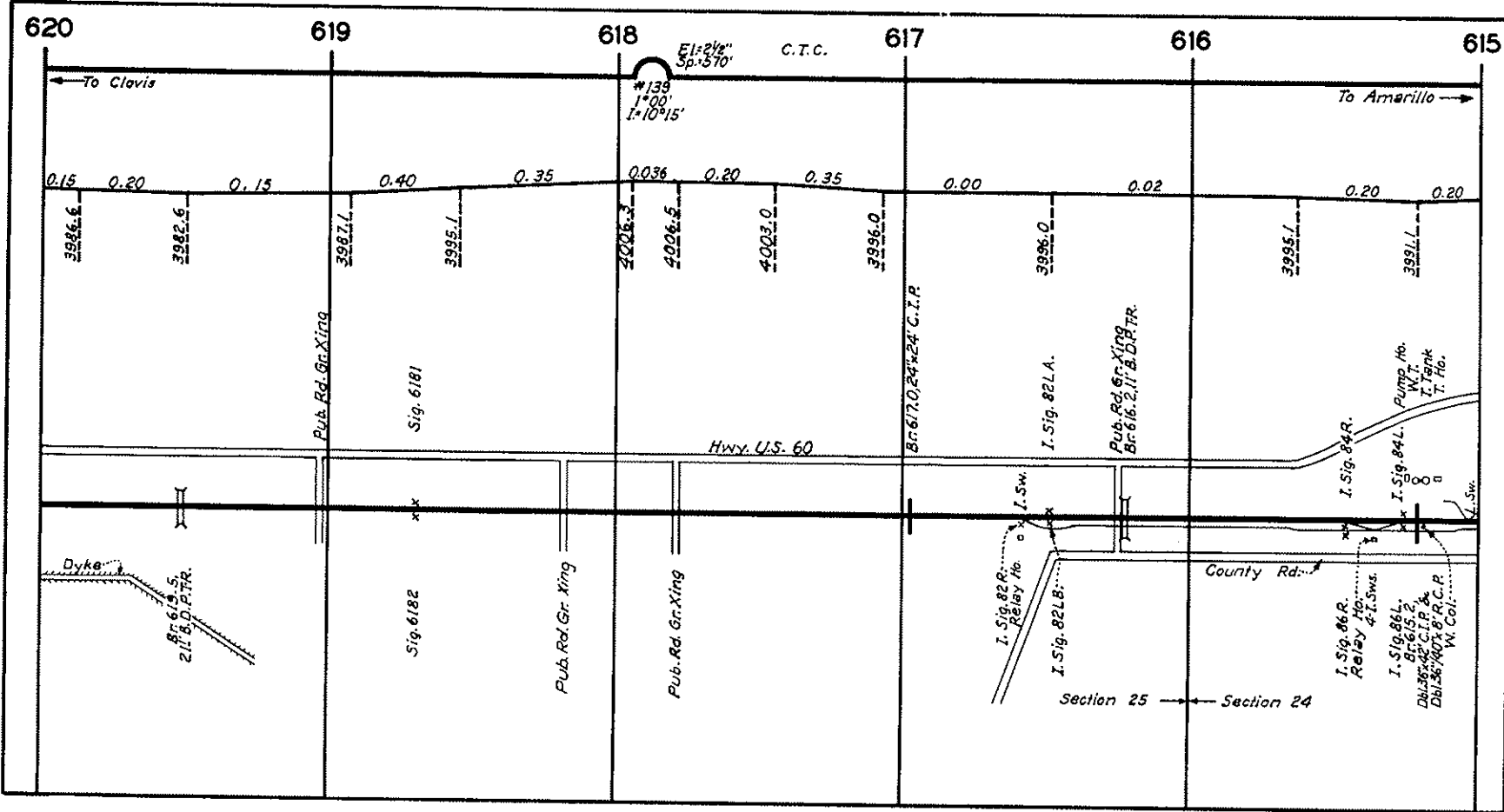

615 614 613 C.T.C. 612 611 610

0.20 ← To Clovis 0.20 0.30 0.55 0.80 0.233 0.40 0.05 0.40 0.15 0.45 0.40 → To Amarillo

3994.5
BLACK
M.P. 614.66
W.

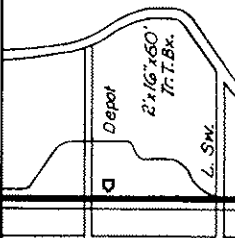

I. Sig. 88 RA.
I. Sig. 88 L.
I. Sw.

Gr. 613.2
197' B. D. P. FR.

Hwy. U.S. 60

Gr. 612.1
Del. 36' x 24' C.I.P.
Sig. 6121

Gr. 611.2, 11' B. D. P. FR.
3944.8

Pub. Rd. Gr. Xing
Sig. 6101

Pub. Rd. Gr. Xing
Pub. Rd. Gr. Xing
I. Sig. 88 RB.
Relay Hb.

Pub. Rd. Gr. Xing

Sig. 6122

County Rd.
Pub. Rd. Gr. Xing

Pr. Gr. Xing

Sig. 6102



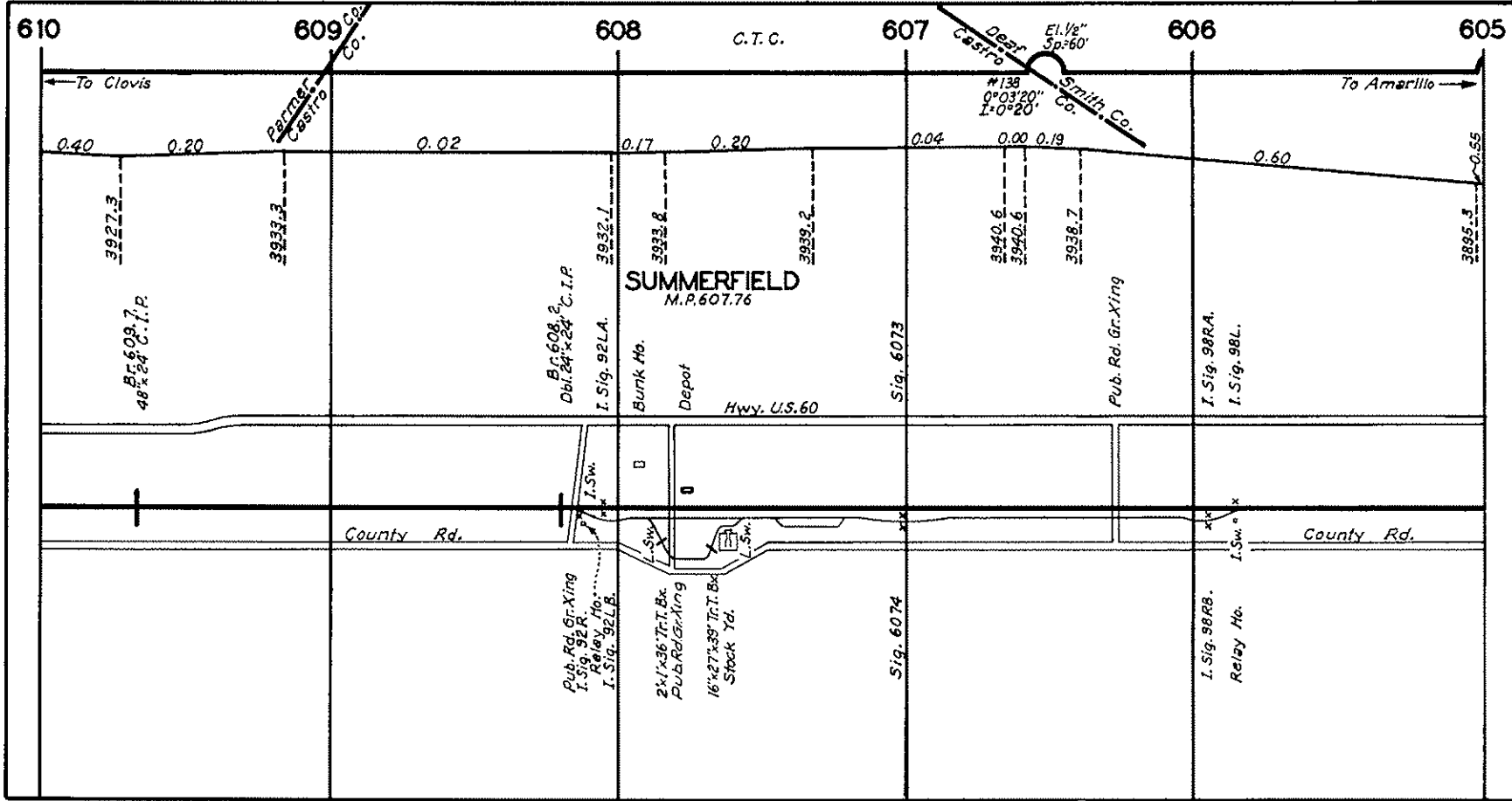

610

609

608

C.T.C.

607

606

605

To Clovis

To Amarillo

0.40

0.20

0.02

0.17

0.20

0.04

0.00

0.19

0.60

0.55

3927.3

3933.3

3932.1

3933.8

3939.2

3940.6

3940.6

3938.7

3895.3

B.C. 608.7
48°24' C.I.P.

B.C. 608.2
Dist. 24' x 24' C.I.P.

SUMMERFIELD
M.P. 607.76

I. Sig. 92LA.

Bunk Ho.

Depot

Hwy. U.S. 60

Sig. 6073

Pub. Rd. Gr. Xing

I. Sig. 98RA.

I. Sig. 98L.

County Rd.

County Rd.

Pub. Rd. Gr. Xing
I. Sig. 92R.
Relay Ho.
I. Sig. 92L.B.

2x1'x36" Tr. Bx
Pub. Rd. Gr. Xing
16'x27'x39" Tr. Bx
Stock Yd.

Sig. 6074

I. Sig. 9868.

Relay Ho.

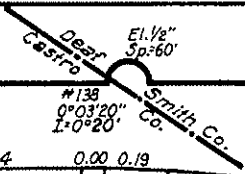

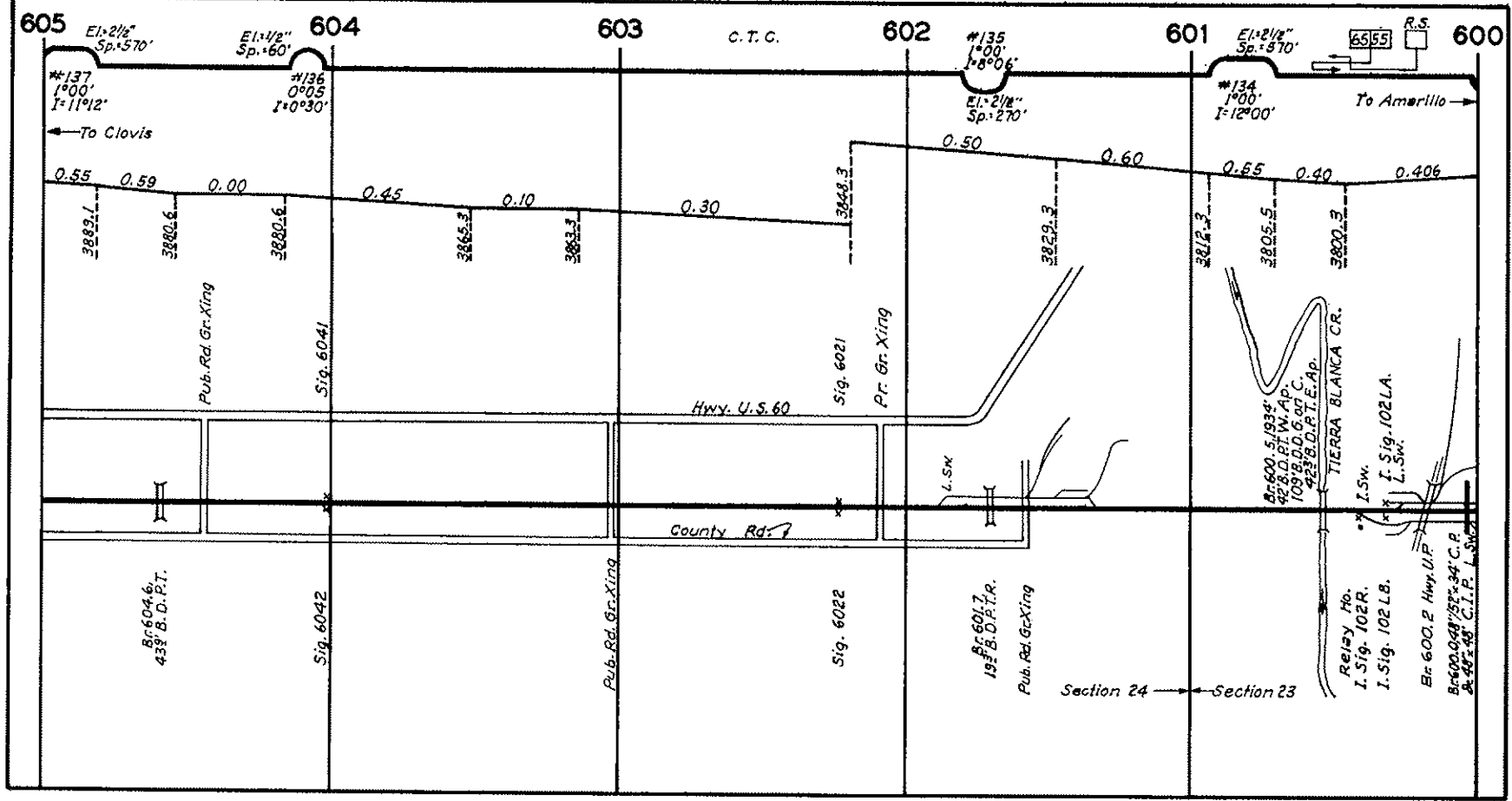

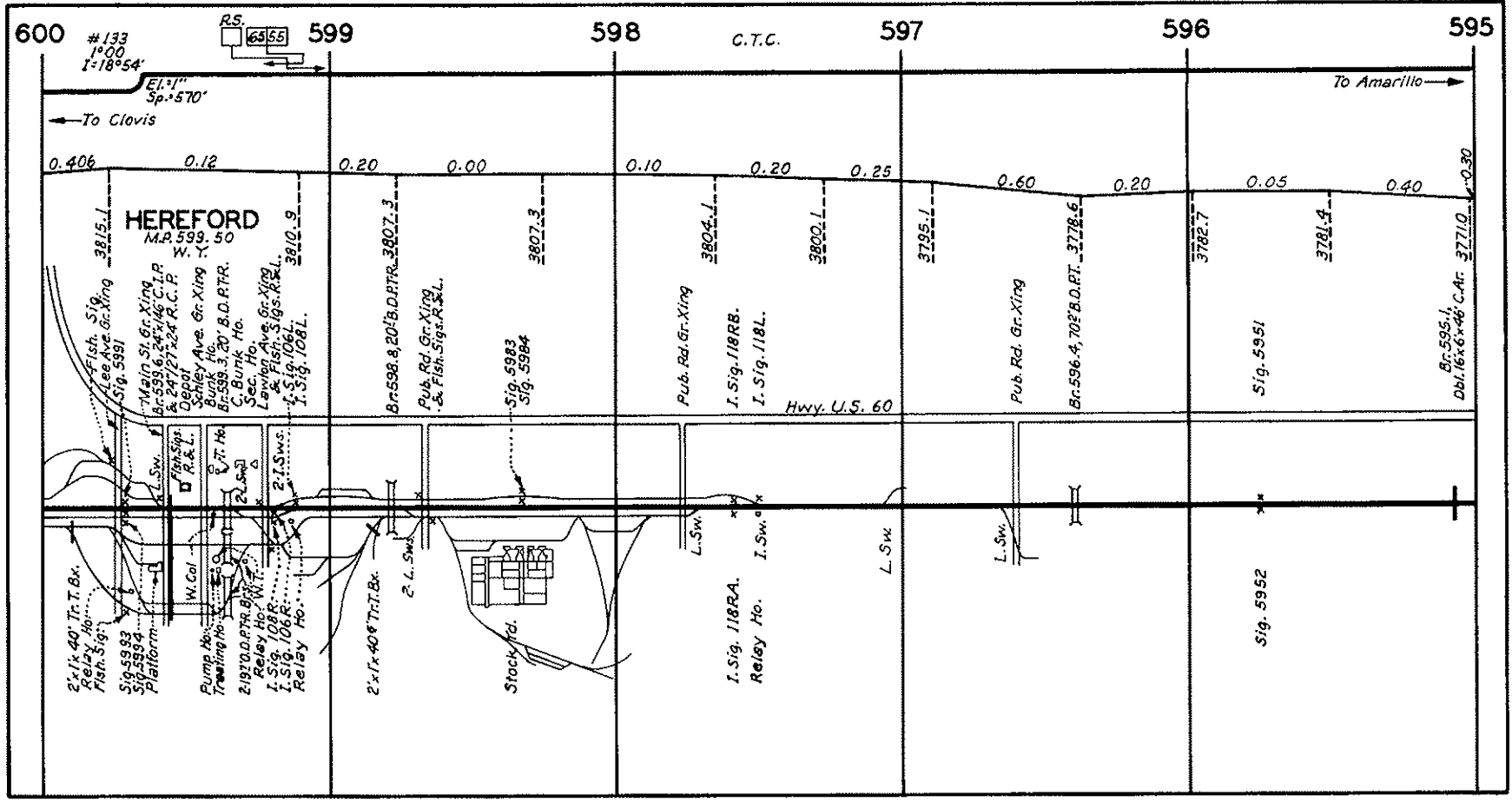

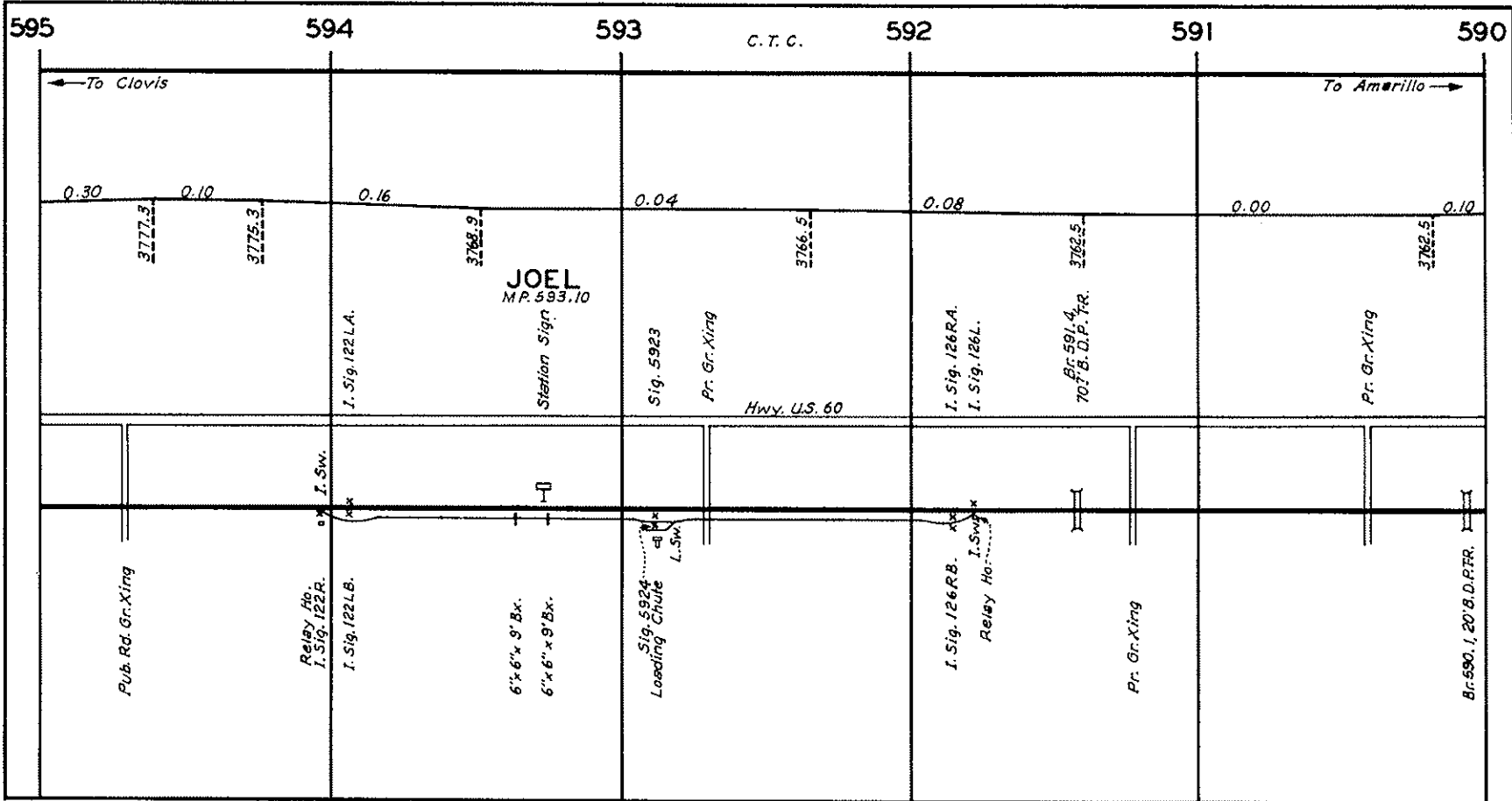

590 589 588 587 586 585

C.T.C.

To Clovis

To Amarillo

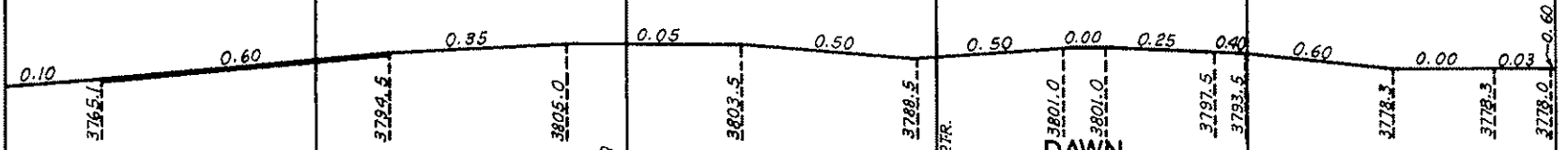

Sig. 5891

Pr. Gr. Xing

Pub. Rd. Gr. Xing

Sig. 130LA.

Hwy. U.S. 60

Gr. 587.0, 3718.0, P.T.R.

Sig. 5863

Bunk. Ho.
W.T. & Tower
Sec. Ho.
M.C. Ho. & Truck Garage

DAWN
M.P. 586.53

Shelter Ho.

Sig. 134L.

Sig. 5892

Br. 589.6, 19 B.D.P.T.R.

Pr. Gr. Xing

Br. 588.5, 48*30 C.I.R.

Sig. 130R.

Relay Ho.
Sig. 130LB.

Section 23

Section 22

Pub. Rd. Gr. Xing

Sig. 5864

2 1/2 x 40" Tr. T. Bx.

8 1/2 x 8" Tr. T. Bx.

Pub. Rd. Gr. Xing

Ex. 1 x 24" Tr. T. Bx.

6" x 10" x 8" Tr. T. Bx.

2 x 1 x 16" Tr. T. Bx.

Sig. 134R.

Sig. 134A.

Relay Ho.

Br. 585.4, 20 B.D.P.T.R.

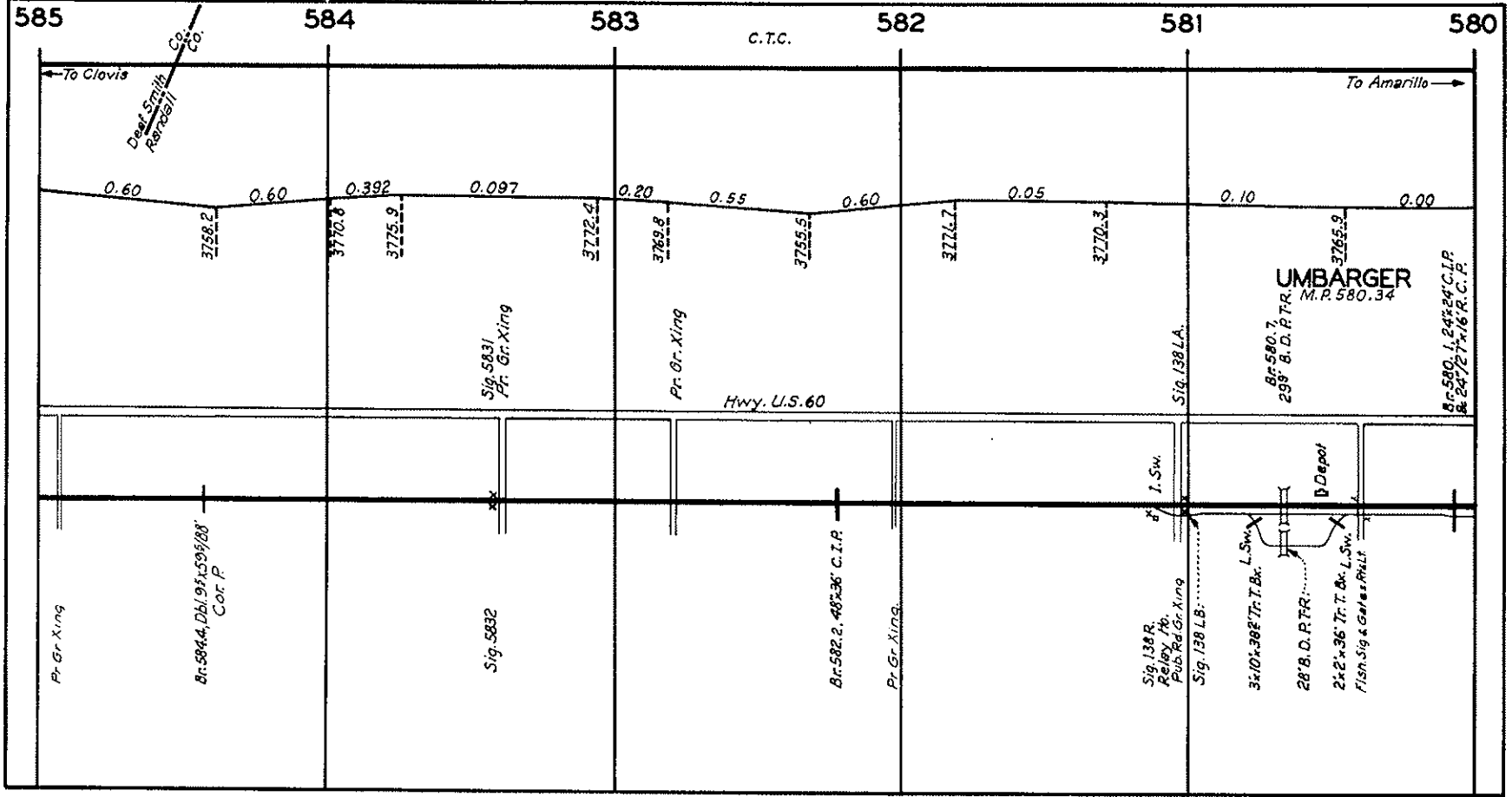

585

584

583

c.t.c.

582

581

580

To Clovis

To Amarillo

Co. Co.
Deaf Smith
Randall

0.60

0.60

0.392

0.097

0.20

0.55

0.60

0.05

0.10

0.00

3758.2

3770.8

3775.9

3772.4

3769.8

3755.5

3776.7

3770.3

3765.9

UMBARGER
M.P. 580.34

Sig. 5831
Pr. Gr. Xing

Pr. Gr. Xing

Hwy. U.S. 60

Sig. 138 LA.

B.C. 580.7
299' B. D. P. T.R.

B.C. 580.1, 24x24 C.I.P.
B. 24/27x16 R. C. P.

Pr. Gr. Xing

B.C. 584.4, Dbl. 9x159' 188'
Cor. P.

Sig. 5832

B.C. 582.2, 48x36' C.I.P.

Pr. Gr. Xing

Sig. 138 R.
Reley Ho.
Pub. Rd. Gr. Xing

Sig. 138 LB.

3x10x38' Tr. T. Bx.
L.S.W.

D Depot
28' B. D. P. T.R.

2x2x36' Tr. T. Bx. L.S.W.
Fish Sig & Garlas Rail

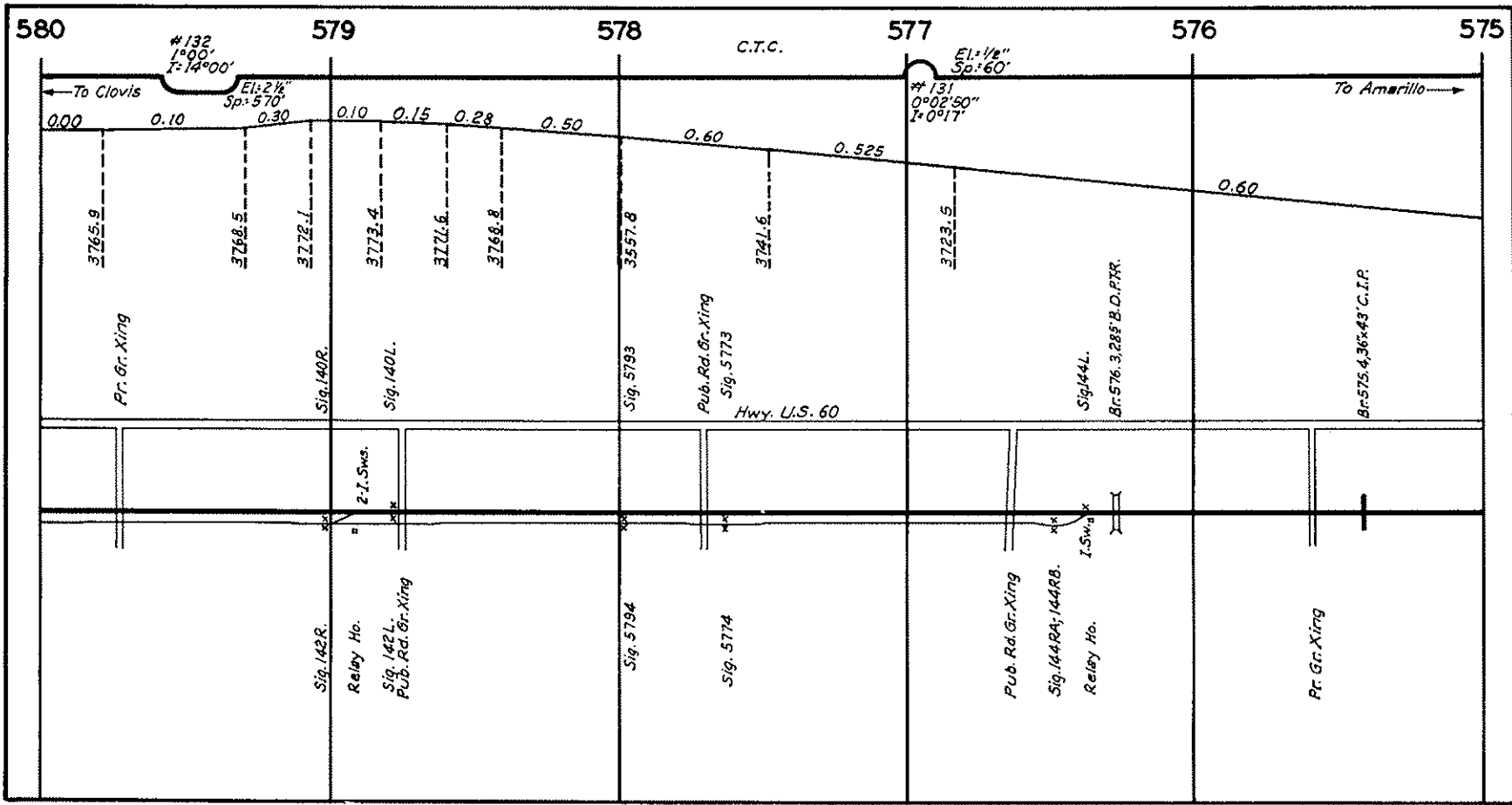

575 574 573 572 571 570

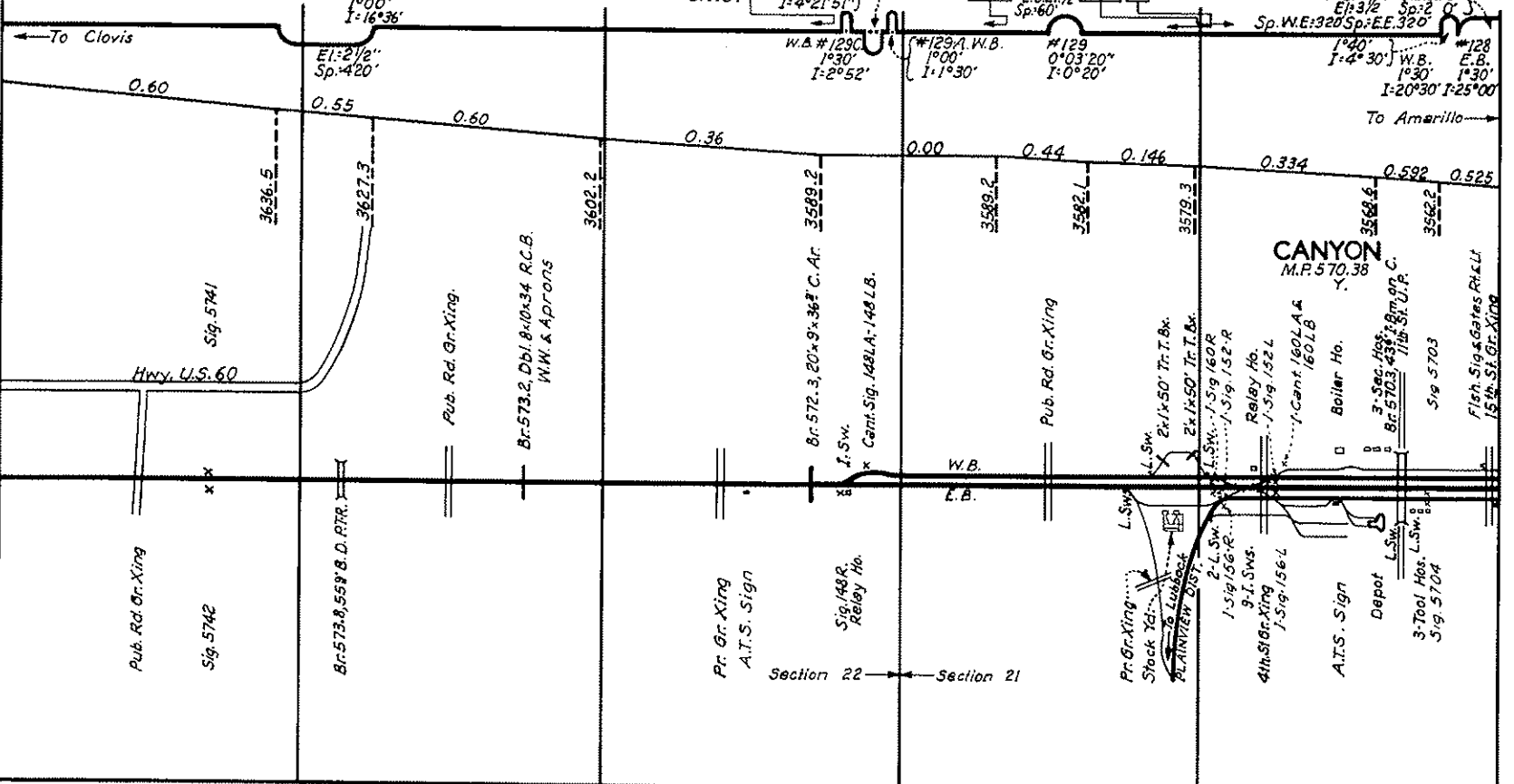

Section 22 ← Section 21

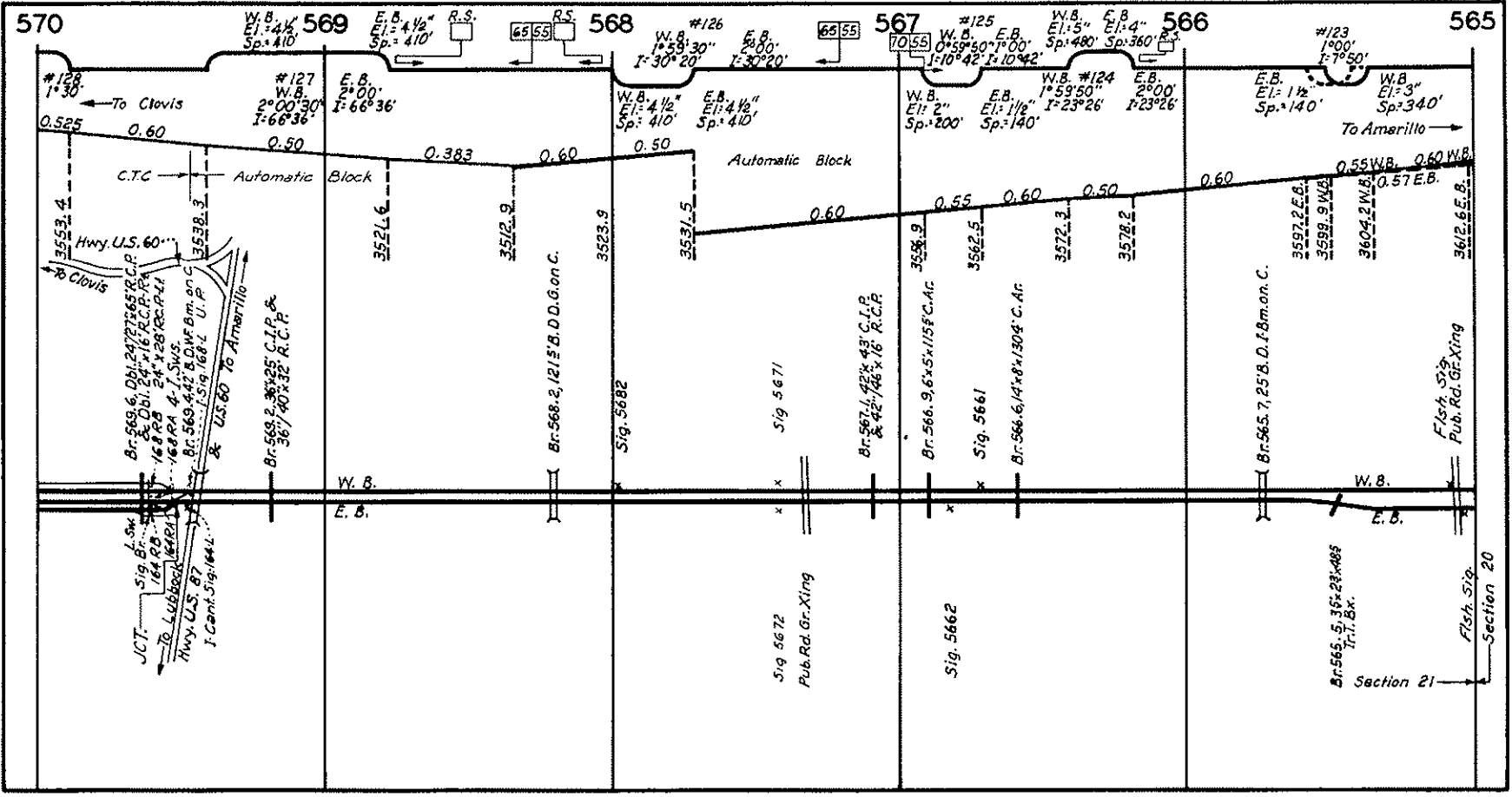

570

W.B. #127
E.I.: 4 1/2"
Sp.: 410'

E.B. #127
E.I.: 4 1/2"
Sp.: 410'

R.S. #126
W.B. #126
E.I.: 30"
Sp.: 410'

6555 568
W.B. #126
E.I.: 30"
Sp.: 410'

6555 567
W.B. #125
E.I.: 50"
Sp.: 400'

7055 566
W.B. #124
E.I.: 50"
Sp.: 400'

W.B. #124
E.I.: 50"
Sp.: 400'

E.B. #123
E.I.: 100"
Sp.: 140'

W.B. #123
E.I.: 30"
Sp.: 340'

565

#128
1°30'
0.525
0.60
To Clovis

#127
W.B. 2°00'30"
I: 66°36'

E.B. 2°00'
I: 66°36'

W.B. #126
E.I.: 4 1/2"
Sp.: 410'

E.B. #126
E.I.: 4 1/2"
Sp.: 410'

W.B. #125
E.I.: 50"
Sp.: 400'

E.B. #125
E.I.: 1 1/8"
Sp.: 140'

W.B. #124
E.I.: 59'50"
I: 23°26'

E.B. #124
E.I.: 2'00"
I: 23°26'

E.B. #123
E.I.: 1 1/2"
Sp.: 140'

W.B. #123
E.I.: 3"
Sp.: 340'

To Amarillo

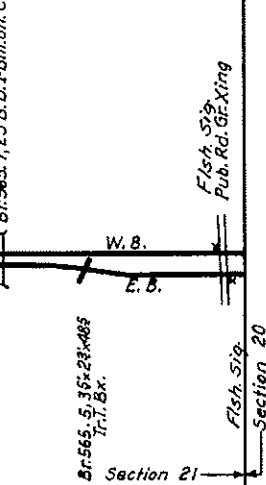
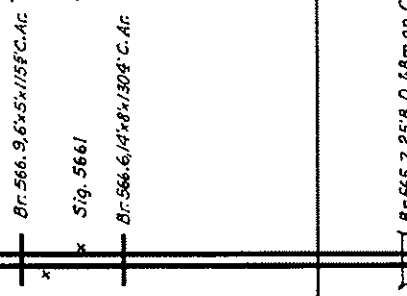
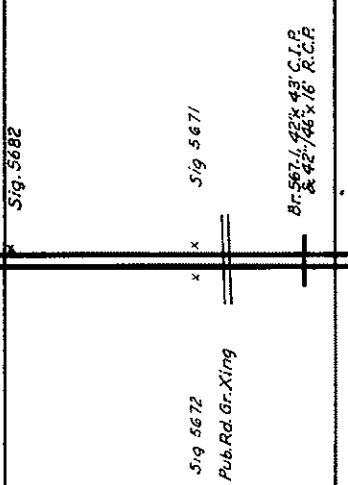
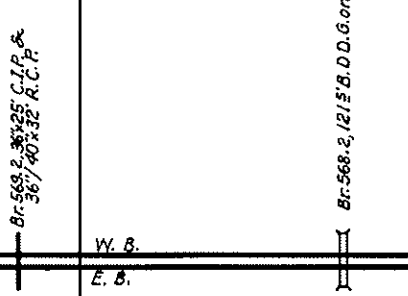
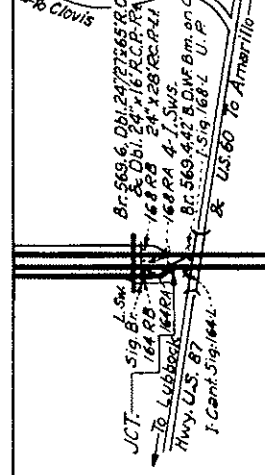
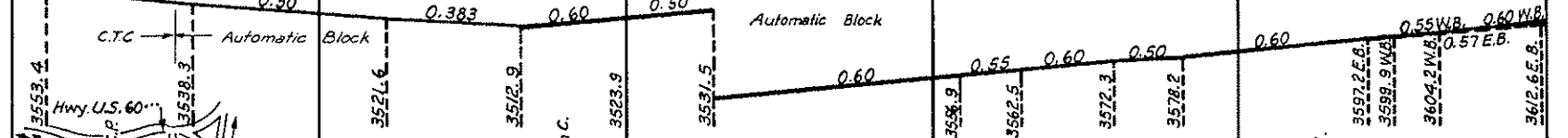

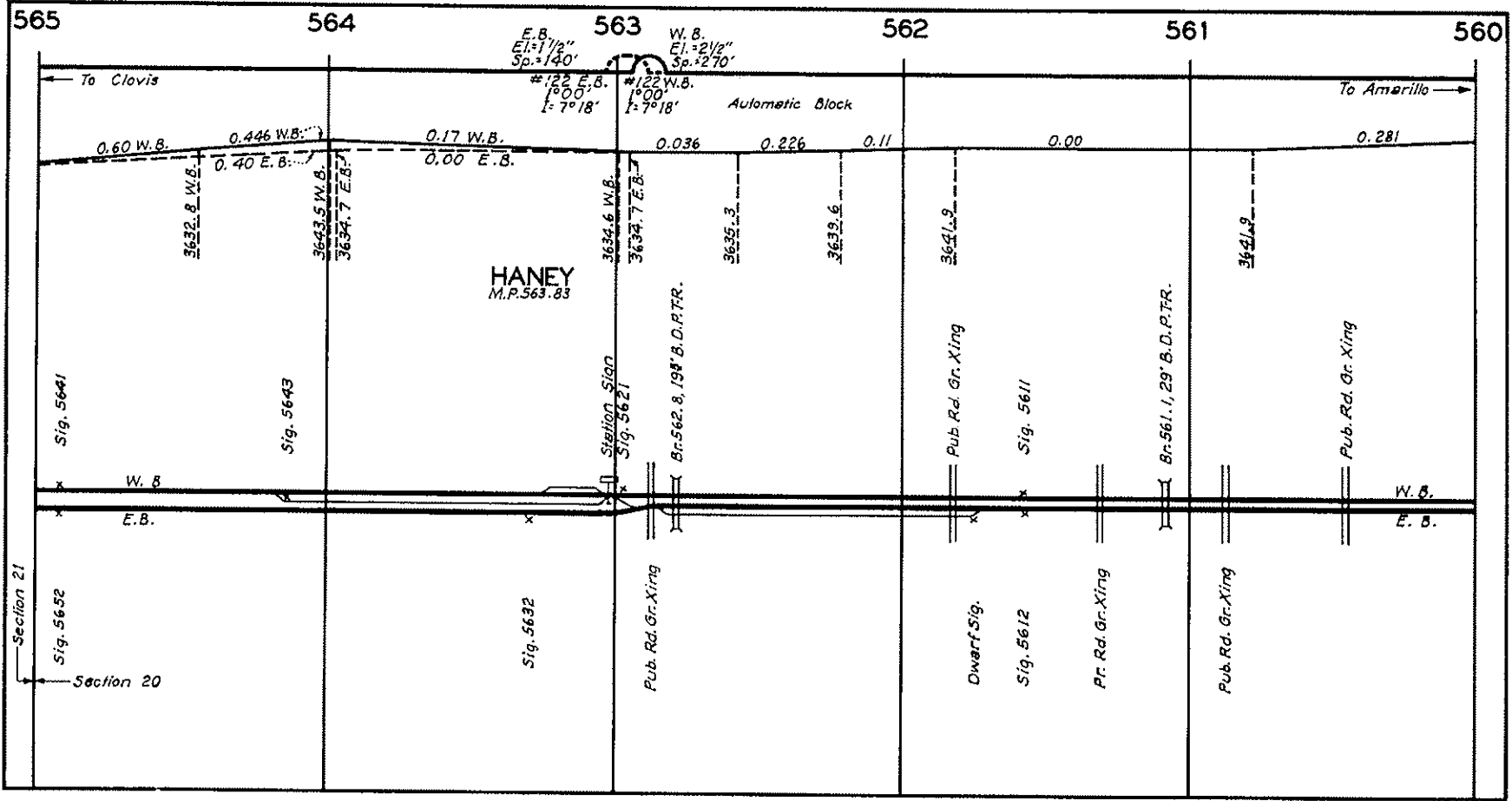

560 559 558 Automatic Block 557 556 555

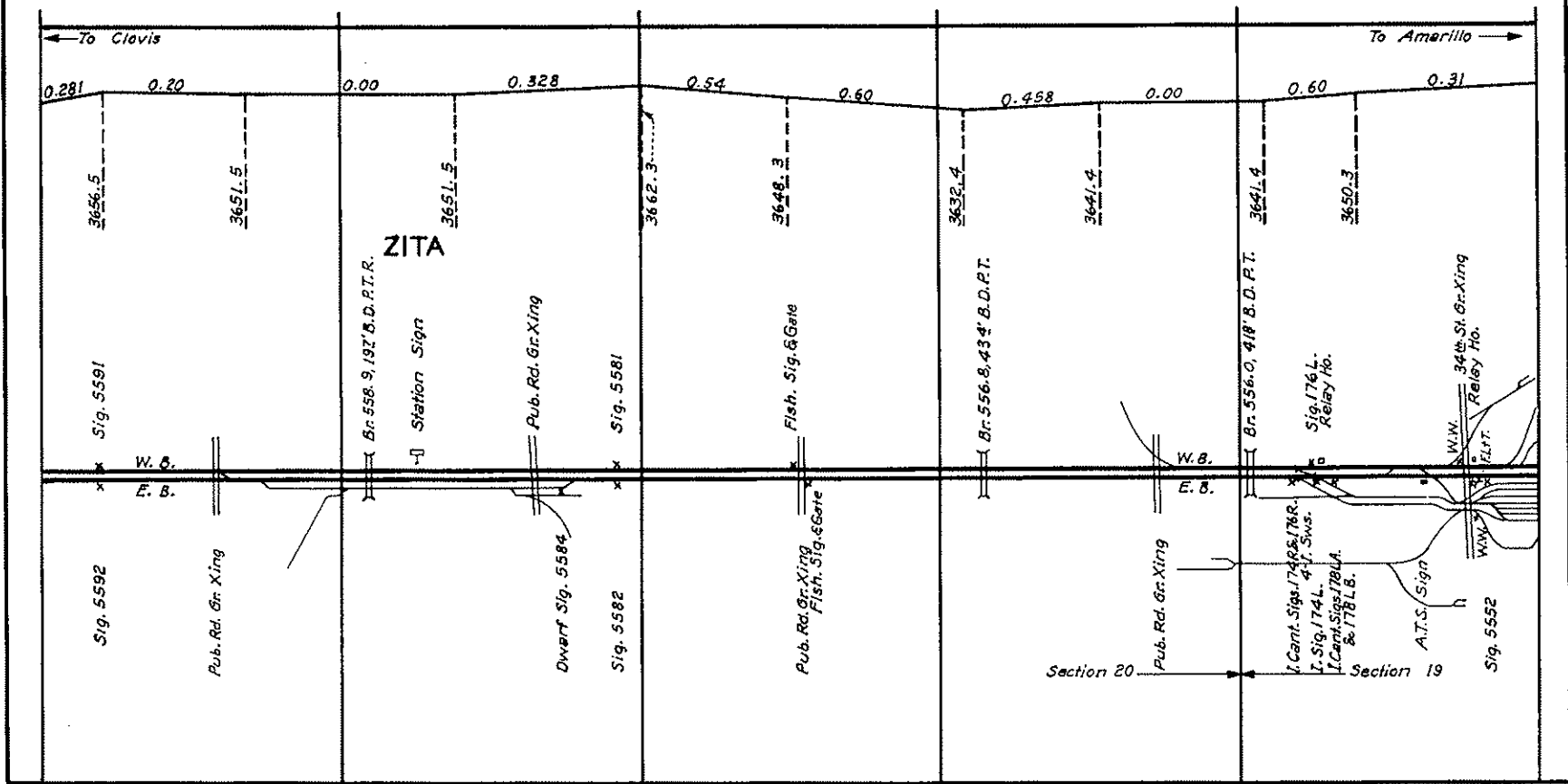

To Clovis

Automatic Block
AMARILLO YARD
 AMARILLO, TEXAS. **JUNIOR**
 M.P. 554.25
 Interlocked



Section 20 Section 19

Sig. 5561

D556

2 I. Sigs.
 I. Sig. 176L
 Relay Ho.

2 1/2 x 4 1/2 C.W.B.

Relay Ho.

D555

Sig. 5541

Tool Ho.
 Rep. Rack
 Yard Office
 F.L.T.

2-2 1/2 x 18 Tr. T. Bks.
 2-2 1/2 x 18 Tr. T. Bks.

D554

2 x 1 1/2 Tr. T. Bk.

Br. 553.918" B.D.P.T.R. & 1970 D.P.T.R.
 (Walkway Under Br.)
 Br. 0A, 2 1/2 x 22 1/2 Tr. T. Bk.

Br. 0A, 2 1/2 x 102 Tr. T. Bk.
 Br. 0B, 1 1/2 x 9 Tr. T. Bk.
 Br. 0C, 10 1/2 x 2 1/2 Tr. T. Bk.
 Carrt. Sig. 5554 & 5536

10th St. Yard Off.
 Train Sig. F.L.T.

Br. 0D, 10 1/2 x 16 Tr. T. Bk.
 Br. 0E, 10 1/2 x 2 1/2 Tr. T. Bk.
 Br. 0F, 2 1/2 x 18 Tr. T. Bk.
 Br. 0G, 2 1/2 x 18 Tr. T. Bk.

Sig. 5562

Pub. Rd. Gr. Xing

W. B.
E. B.

Br. 556.0.418" B.D.P.T.

I. Cant. Sigs. 174R & 176R.

2 I. Sigs. 174L

I. Cant. Sigs. 174L A & 176L B.

A.T.S. Sign

34th St. Gr. Xing
Sig. 5552

FL.T.
 Br. 556.7.27th St. U.P.
 Set B.D. Fm. on C. & S.

Carbody

Coal Ho.
 Sand Ho. & Tanks
 Diesel Service Unit
 Eng. Wash. Plfm.
 Diesel A.T.

FL.T.
 Scales
 Car Rep. Shed
 Motor Car Shop
 Car Wash

2-6 Cols.
 Work
 Lumber Shop
 Wheel Shop
 The Car Ho. & Plfm.
 2-6 Cols.
 1600 R.R. Bldg.

Gas Ho.
 Changing Ho.
 2 Tool Hrs.

3-Bunk Hqs.
 Switchmans Ho.

Brick Iron Garage
 Store Ho. & Plfm.
 19'0. D. P. T.
 Machine Shop
 Lav. & Locker Ho.

Cinder Pits
 Rd. Ho. Formans Off.
 W. Cols.
 O. Trough
 O. Pump Ho.
 O. T.

Arch Brick Ho.
 B. Washing Plant
 2-W. Tanks

2-M. Tanks
 T. Ho.
 W.S.T.
 Power Ho.
 Paint Ho.
 2-C. Cisterns
 Carbody
 Foundry

Brick Iron Garage
 Store Ho. & Plfm.
 19'0. D. P. T.
 Machine Shop
 Lav. & Locker Ho.

Automatic Block

LEGEND
 The A.T. & S.F. Ry. Co. ————
 F.W. & D.C. Ry. Co. ————
 C.R.I. & P.R.R. Co. ————

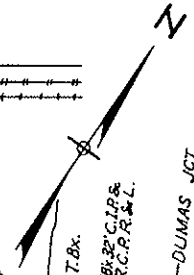

To Canadian →

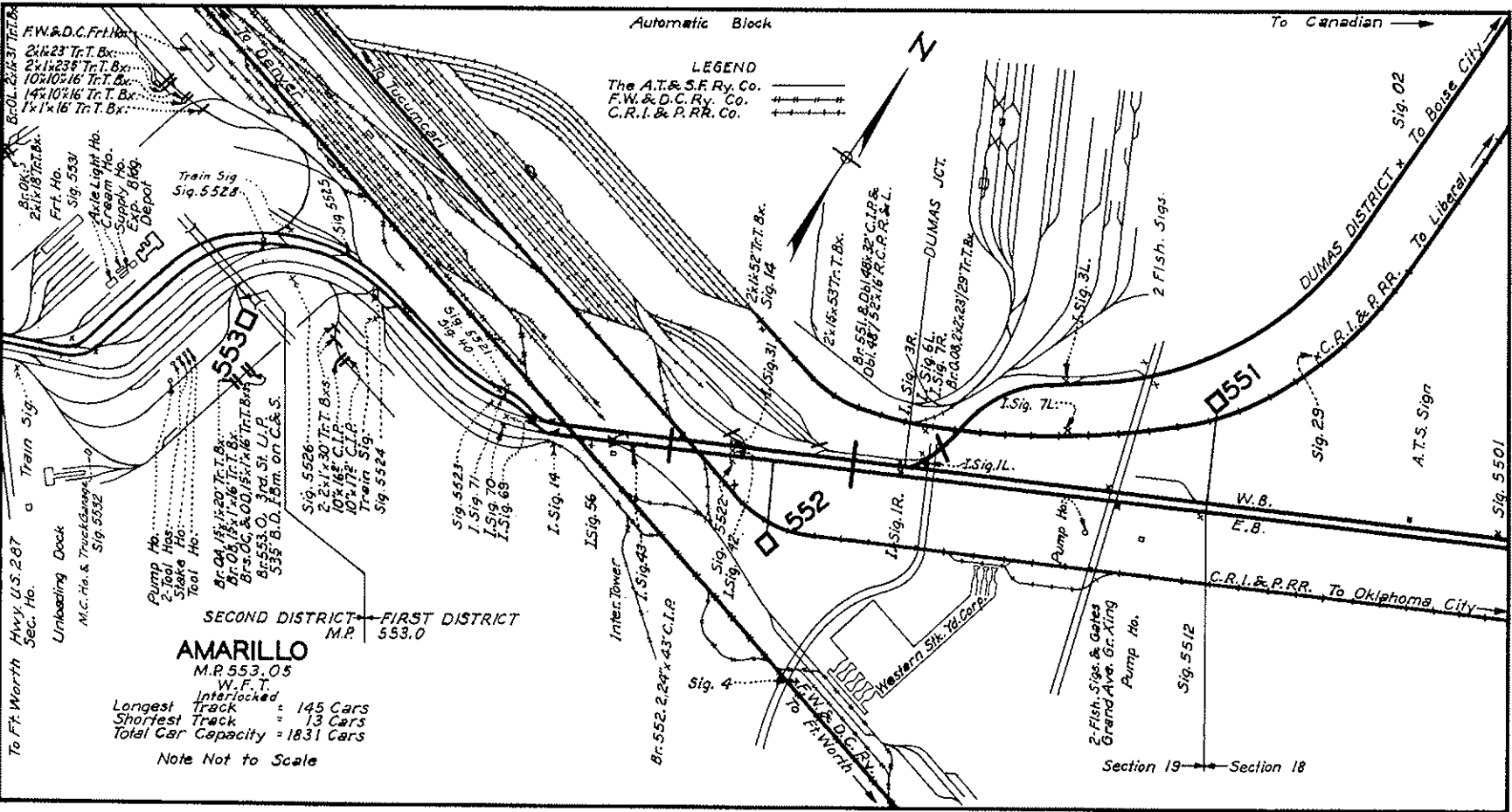

F.W. & D.C. Fr. Ho.
 2x14x23 Tr. T. Bx.
 2x1x23 Tr. T. Bx.
 10x10x16 Tr. T. Bx.
 14x10x16 Tr. T. Bx.
 1x1x16 Tr. T. Bx.

8x0K5
 2x1x18 Tr. T. Bx.
 Frt. Ho.
 Sig. 5531
 Axle Light Ho.
 Cream Ho.
 Supply Ho.
 Exp. Bldg.
 Depot

Train Sig.
 Sig. 5528

To Ft. Worth Hwy. U.S. 287
 Sec. Ho.
 Unloading Dock
 M.C. Ho. & Truck Garage
 Sig. 5532

5530

8x0A 15x15x20 Tr. T. Bx.
 2x1x30 Tr. T. Bx.
 2x1x18 Tr. T. Bx.
 10x10x16 Tr. T. Bx.
 10x17x16 C.I.P.
 10x17x16 C.I.P.
 8x5530 3rd St. U.L.P.
 5535 B.O. 12m. on C.A.S.

Sig. 5526
 2x1x30 Tr. T. Bx.
 10x10x16 C.I.P.
 10x17x16 C.I.P.
 Train Sig.
 Sig. 5524

Sig. 5623
 I.Sig. 70
 I.Sig. 70
 I.Sig. 69

SECOND DISTRICT — FIRST DISTRICT
 M.P. 553.0

AMARILLO

M.P. 553.05
 W.F.T.
 Interlocked
 Longest Track = 145 Cars
 Shortest Track = 13 Cars
 Total Car Capacity = 1831 Cars

Note Not to Scale

Inter. Tower
 I.Sig. 43

8x552 2.24' x 43' C.I.P.

Sig. 4

2x14x52 Tr. T. Bx.
 Sig. 14

2x14x53 Tr. T. Bx.
 8x551 8xDb1 48x32' C.I.P.
 Db1 48' 52x16' R.C.P.R.R.L.

DUMAS JCT.
 I.Sig. 3R
 I.Sig. 4R
 I.Sig. 5R
 I.Sig. 6R
 8x0A 08x22x23/29 Tr. T. Bx.

I.Sig. 7L

Pump Ho.

2 Fish. Sigs. & Gates
 Grand Ave. Gr. King
 Pump Ho.

Sig. 5512

Section 19 — Section 18

DUMAS DISTRICT x Sig. 02
 To Boise City

C.R.I. & P.R.R. To Liberal
 A.T.S. Sign

C.R.I. & P.R.R. To Oklahoma City

Sig. 5501

W.B.
 E.B.