

Intentionally Blank

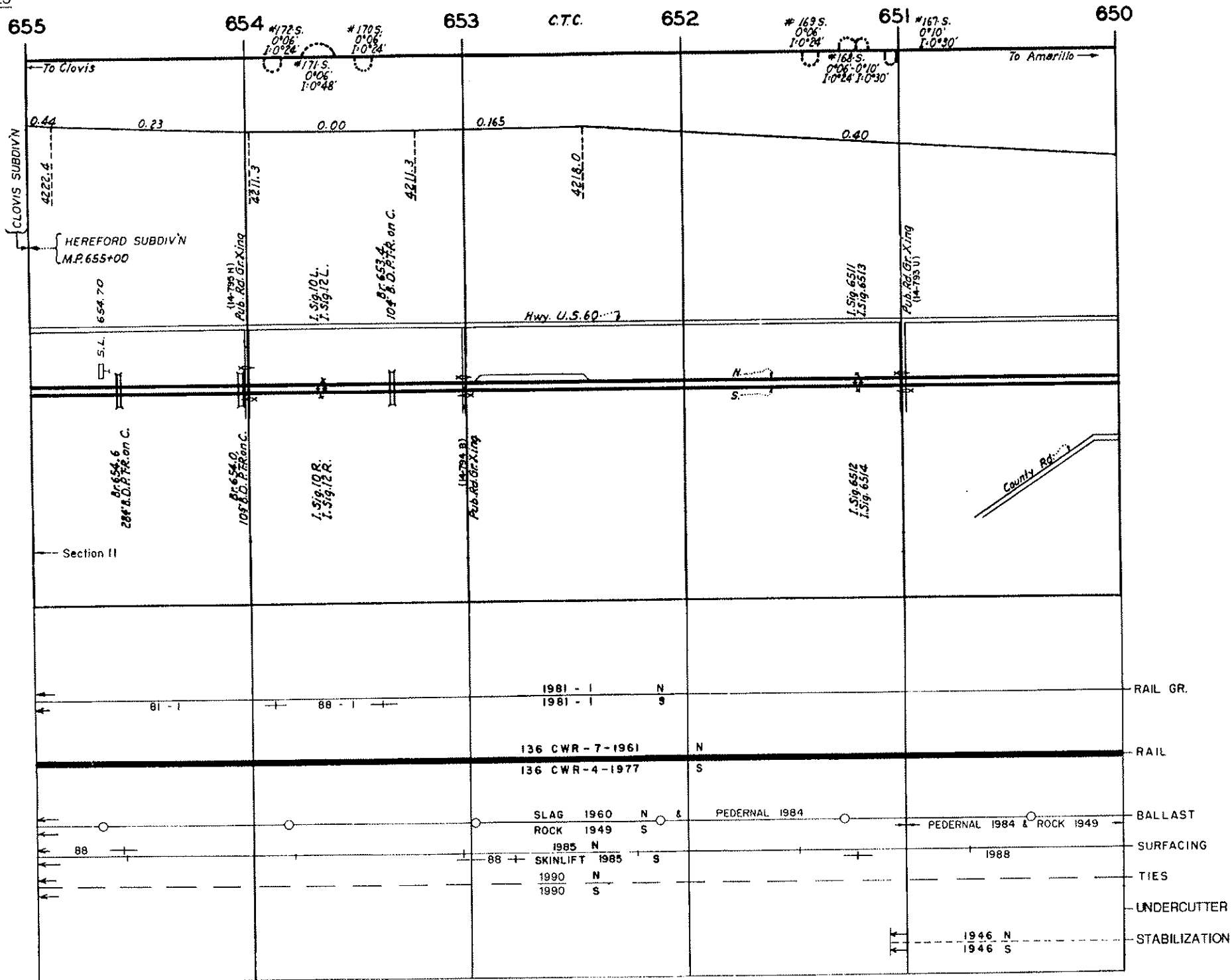

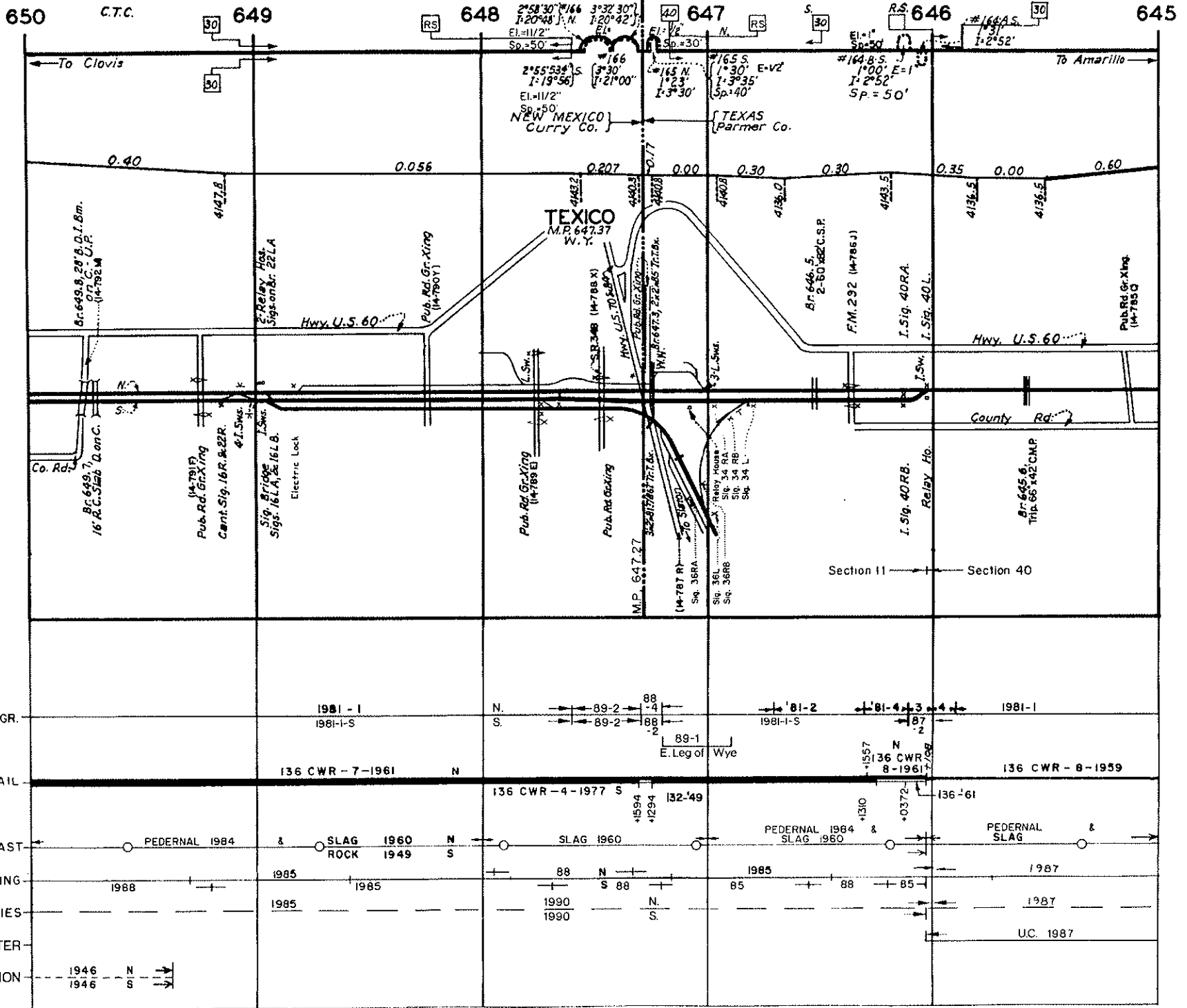

RAIL GR.	1981-1 1981-I-S	N. 89-2 S. 89-2	88 88 88	1981-1-S	81-2 81-4 81-3 87	1981-1		
RAIL	136 CWR - 7 - 1961	N			136 CWR 8-1961	136 CWR - 8 - 1959		
BALLAST	PEDERNAL 1984	&	SLAG 1960 ROCK 1949	N S	SLAG 1960	PEDERNAL 1984 & SLAG 1960	PEDERNAL & SLAG	
SURFACING	1988	1985	1985	88 S 88	85	88	85	1987
TIES	1985	1990 1990	N S					1987
UNDERCUTTER								UC. 1987
STABILIZATION	1946 1946							

645

644

643

642

C.T.C.

641

640

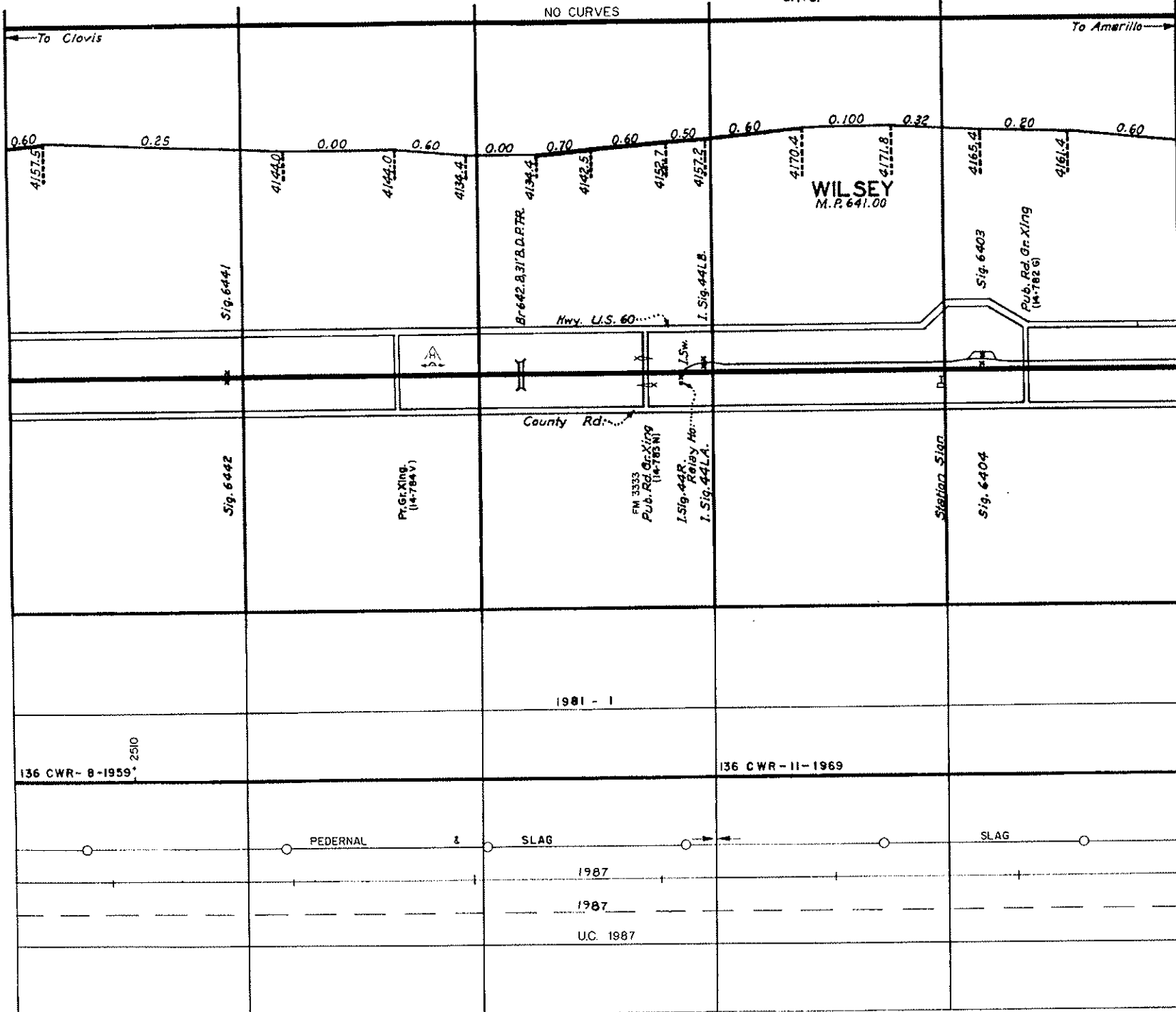

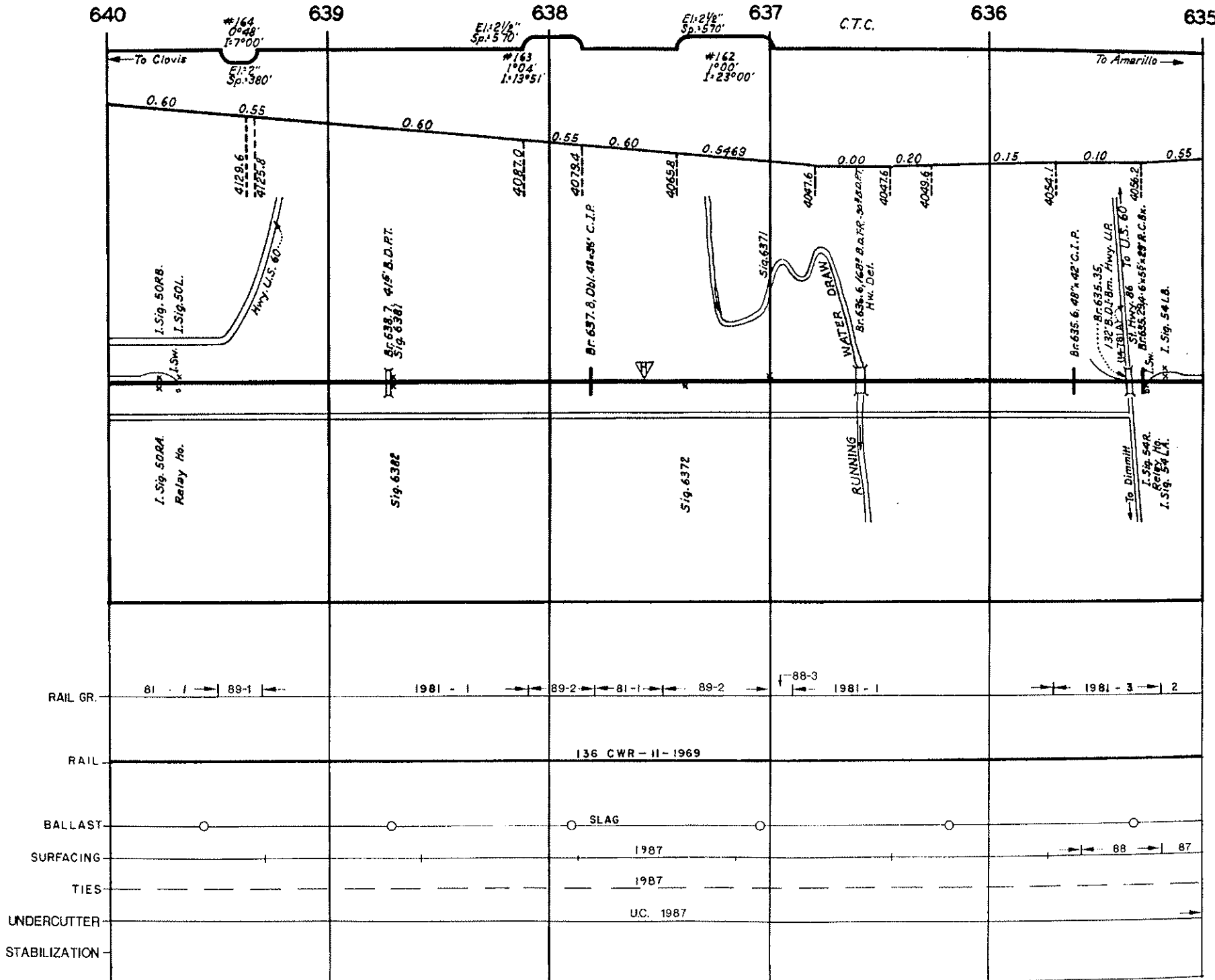

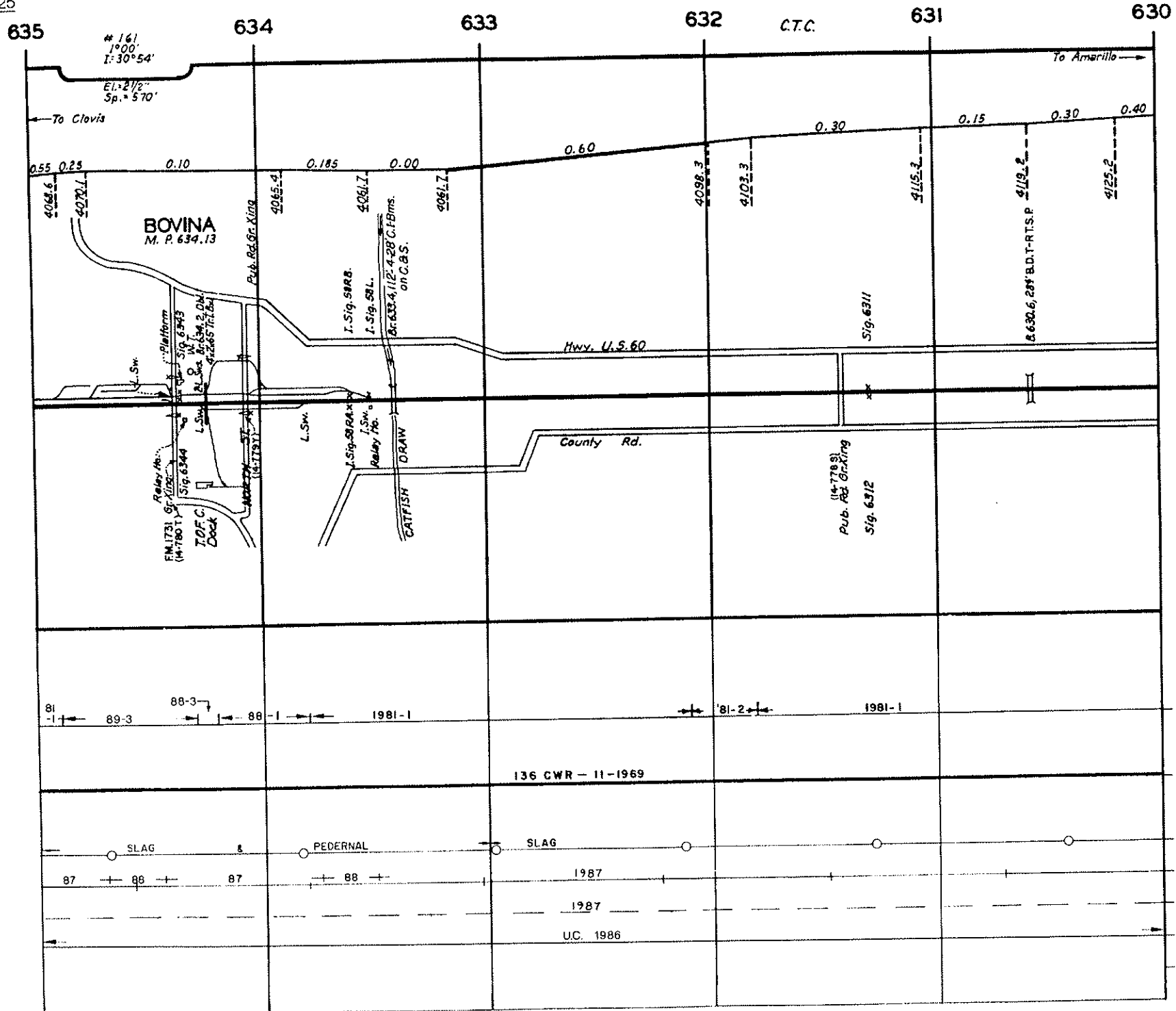

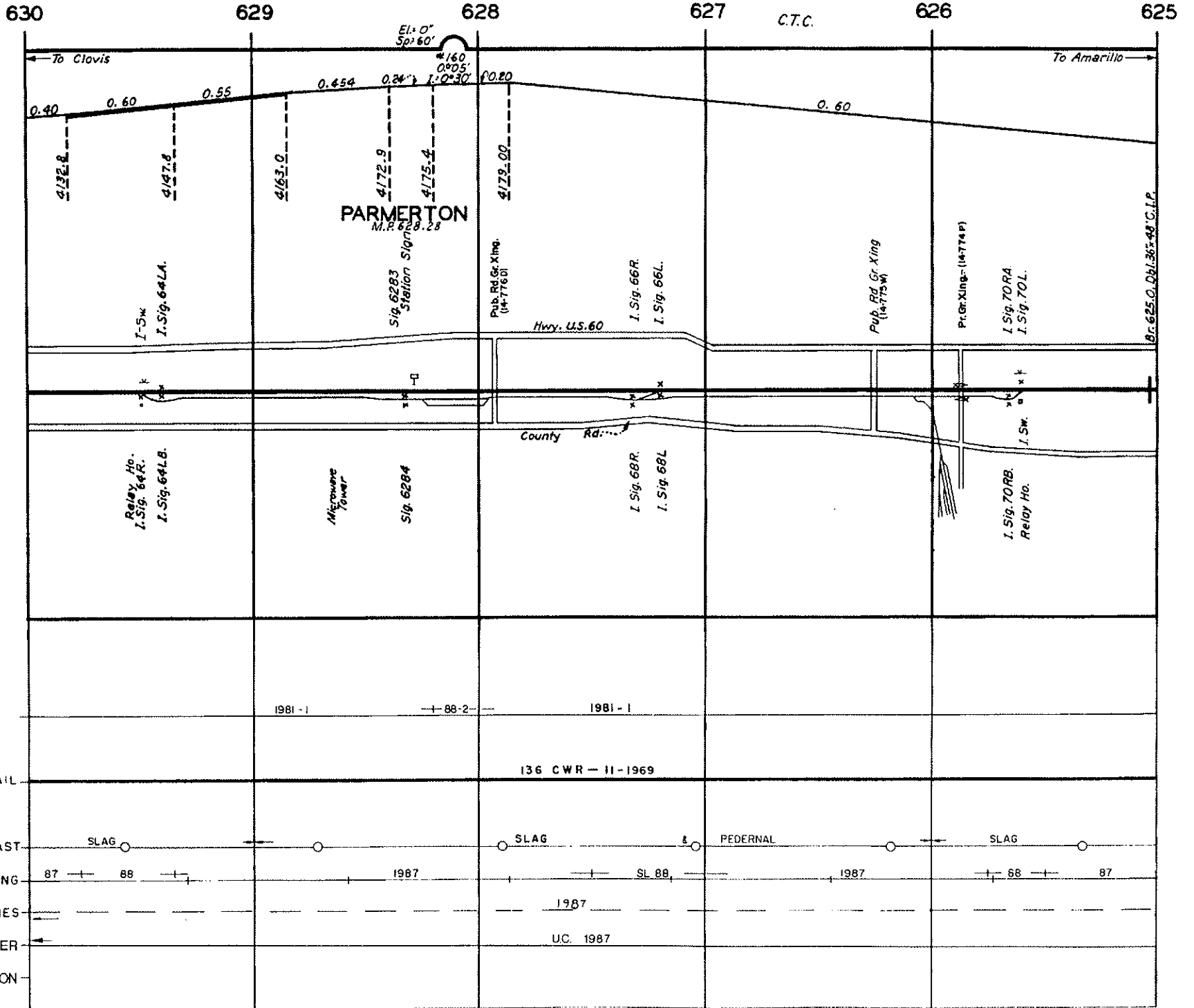

REVISED 1-91

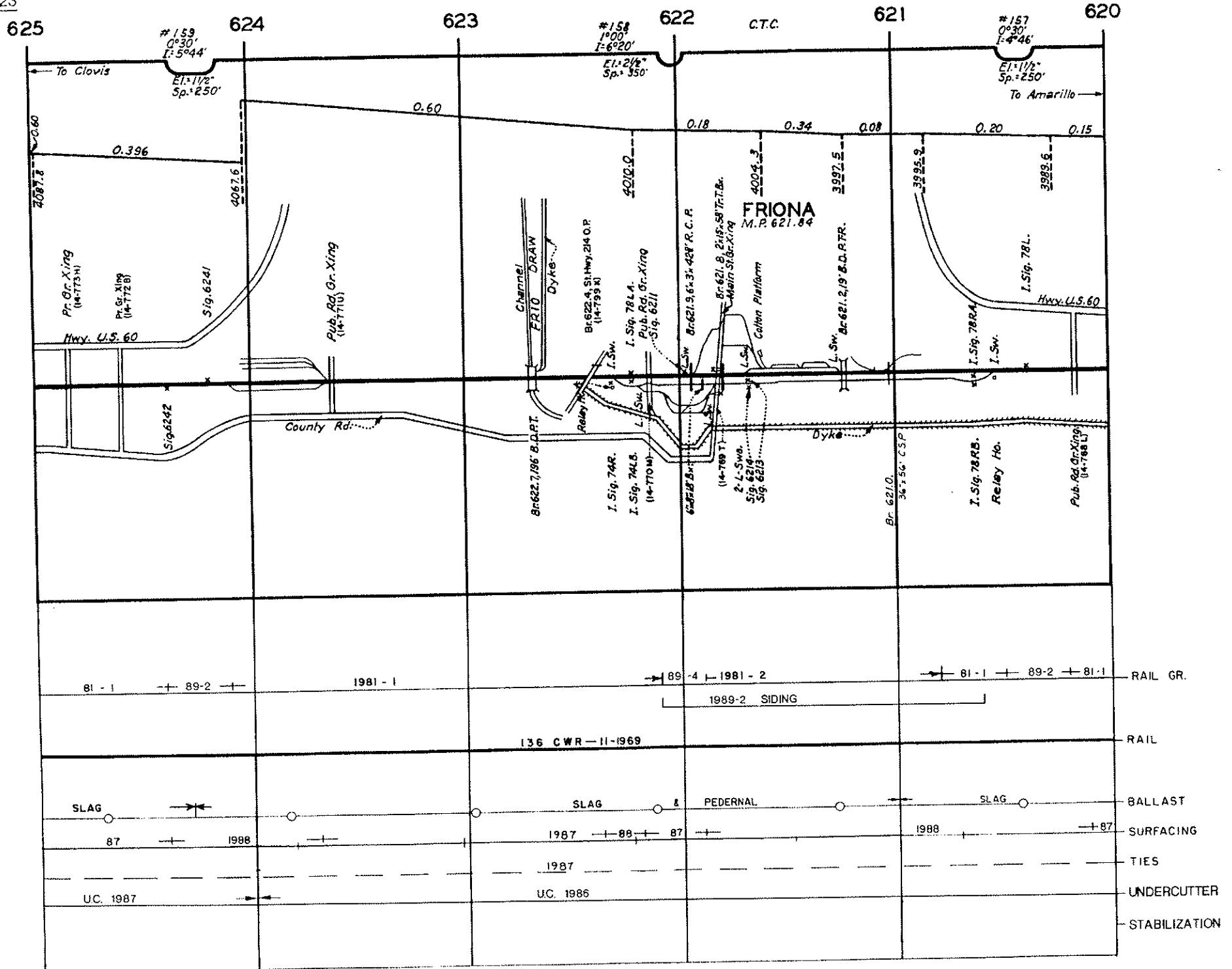

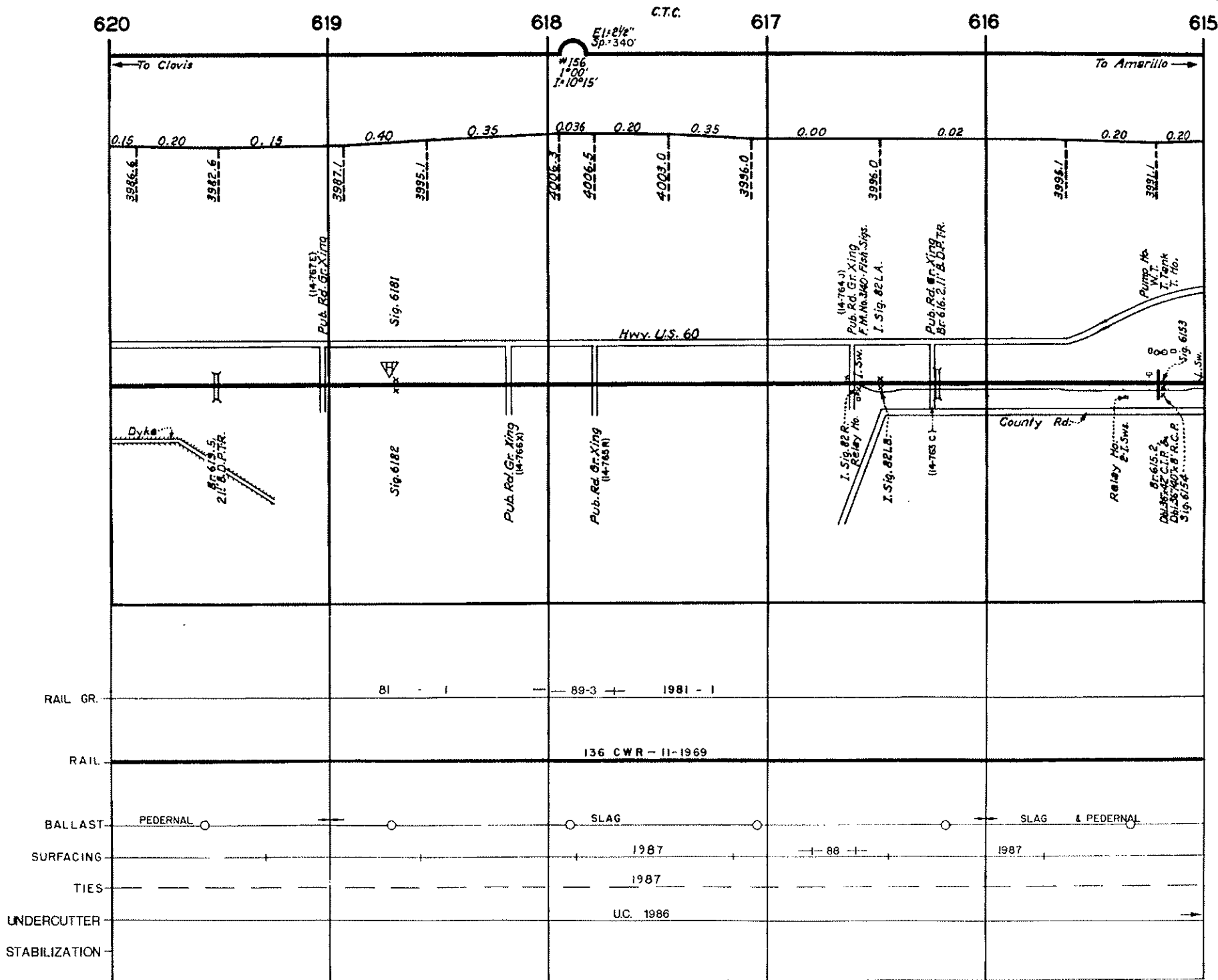

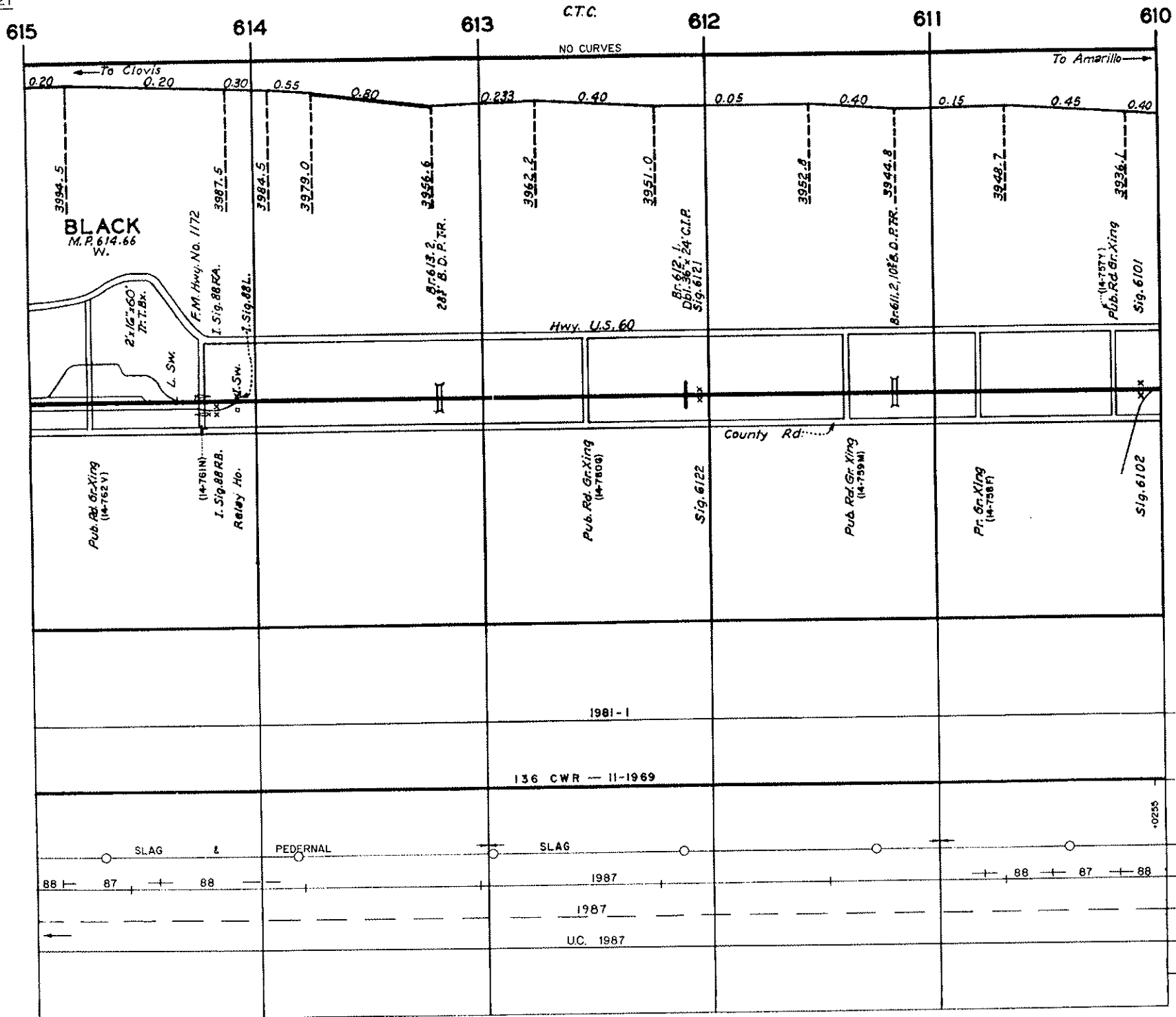

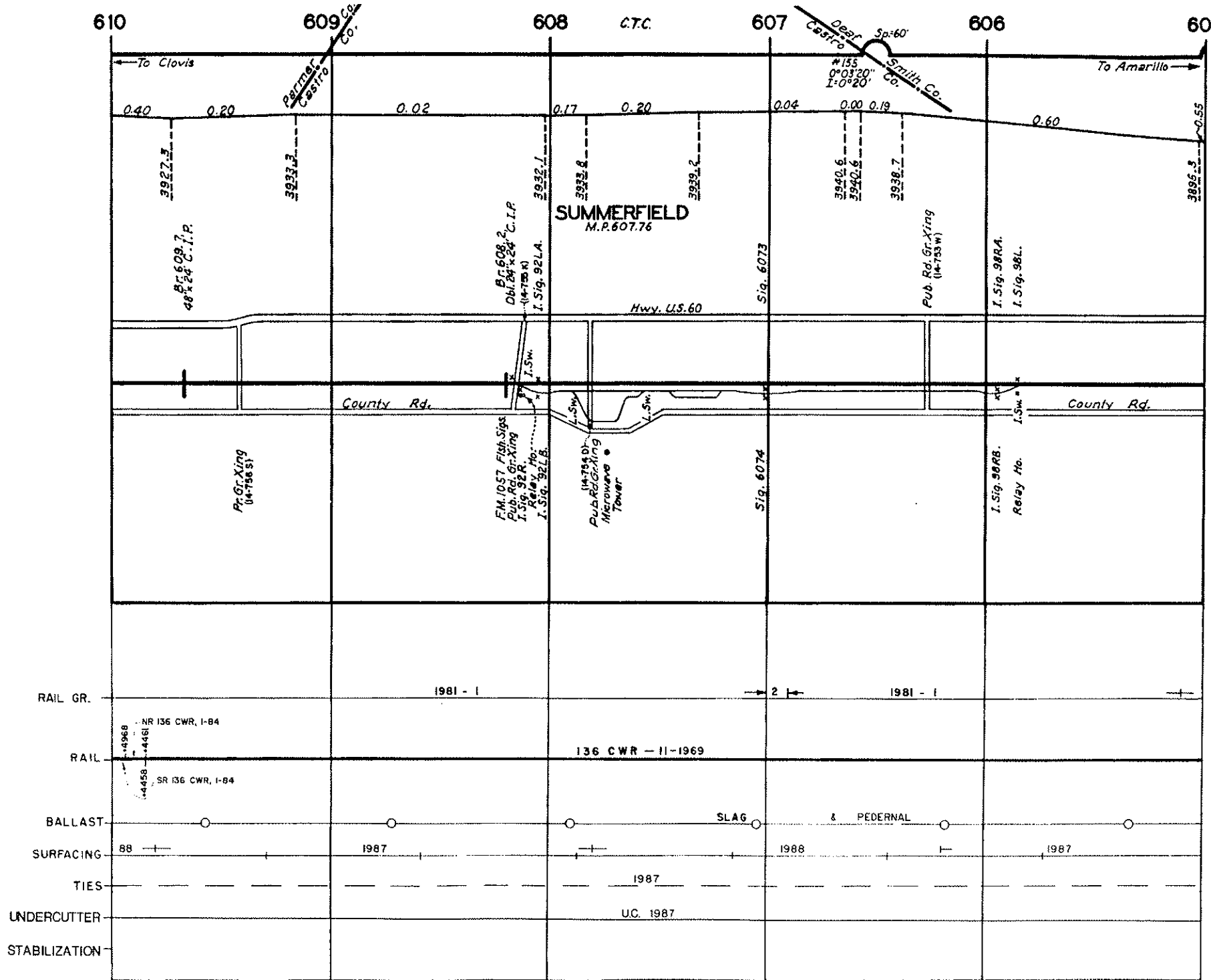

REVISED 1-91

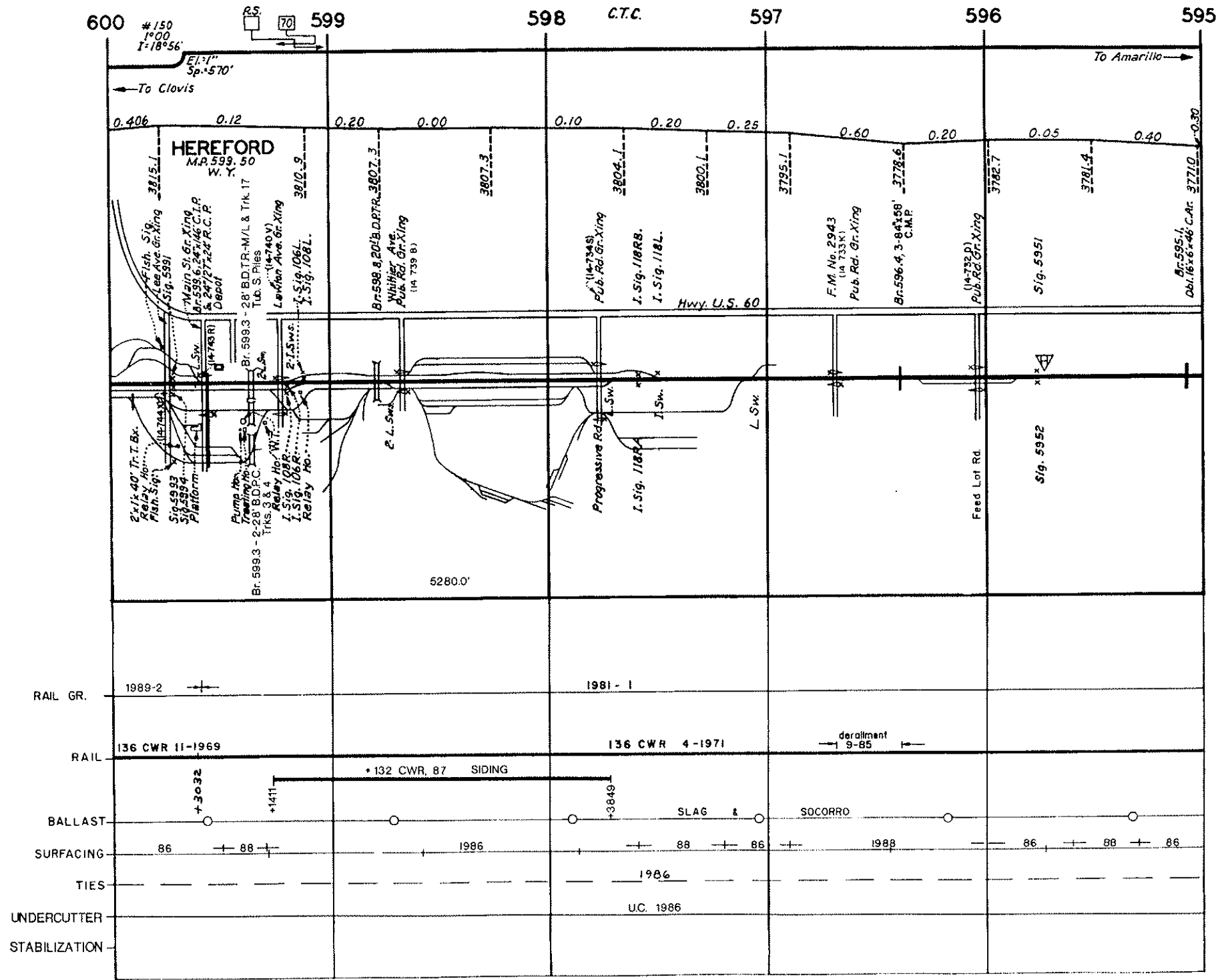

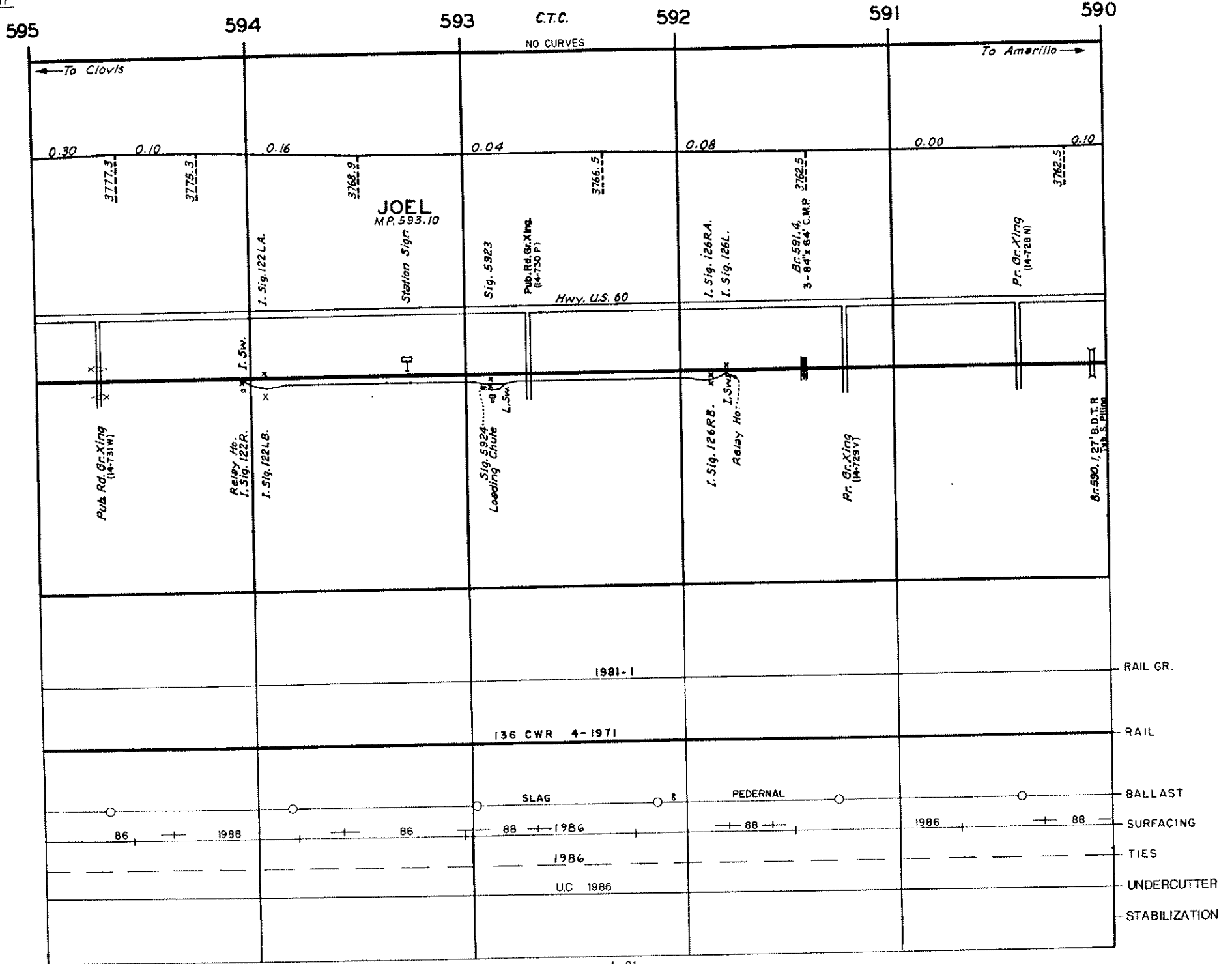

590

589

588

C.T.C.

587

586

585

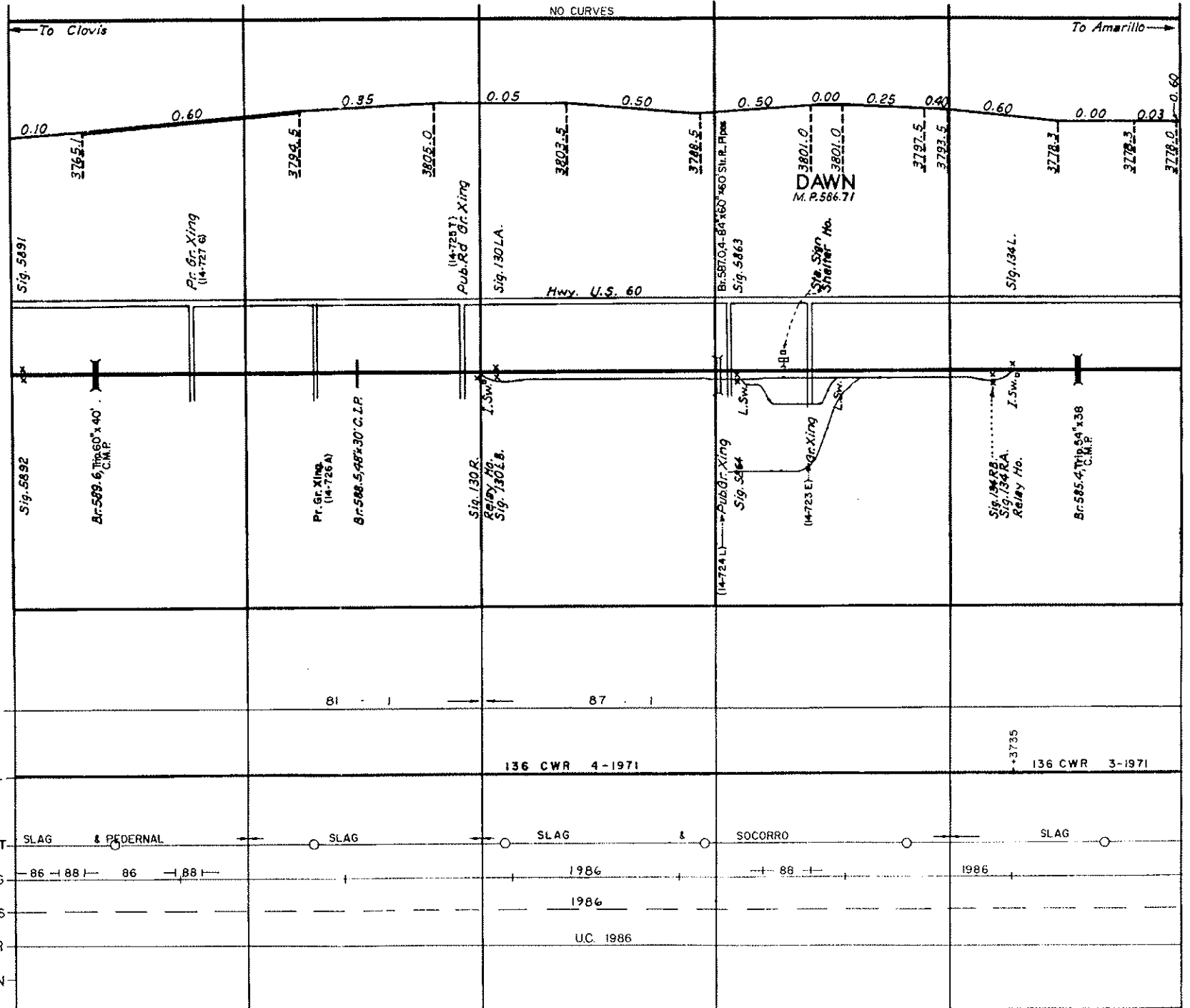

585

584

583

C.T.C.

582

581

580

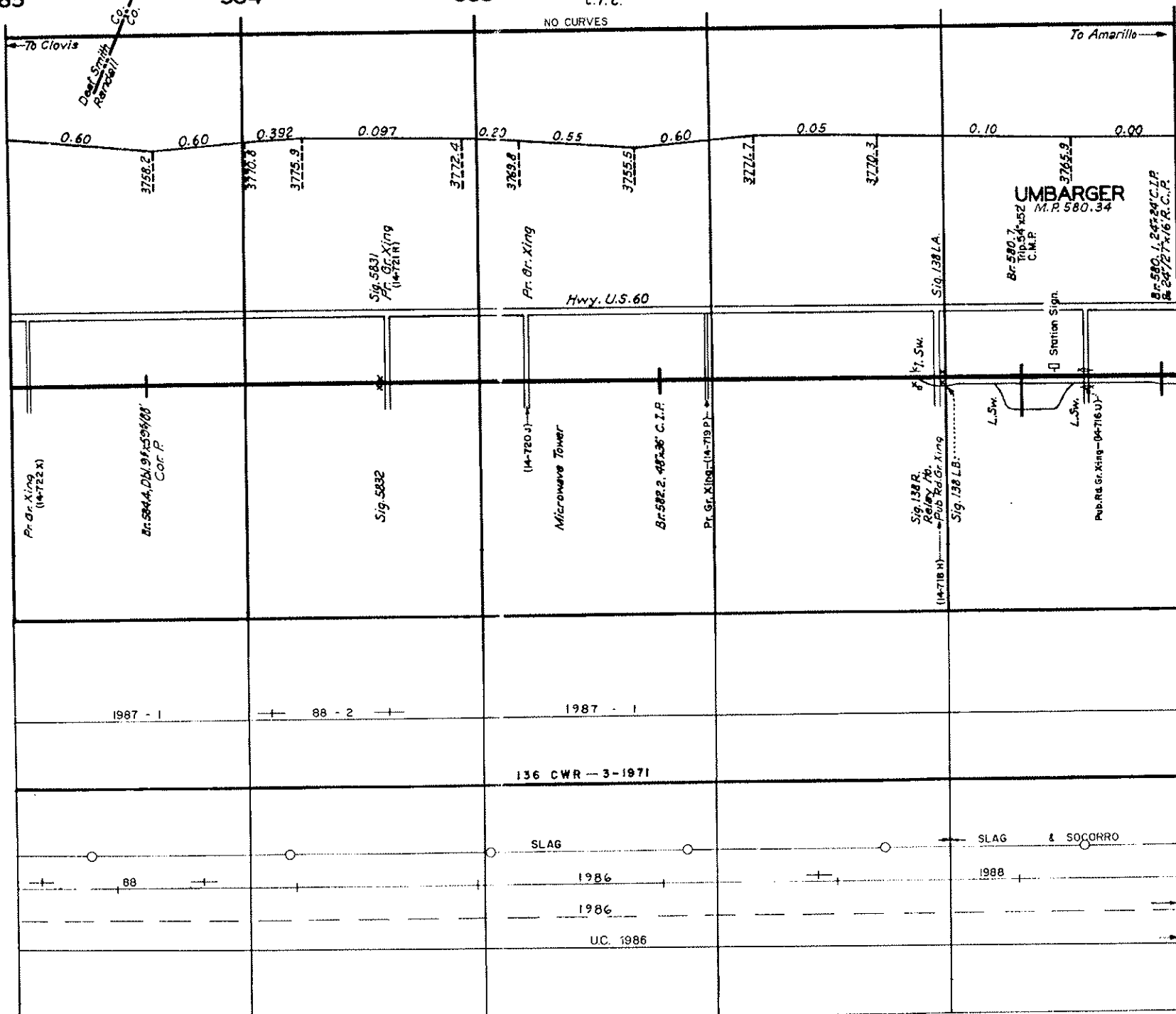

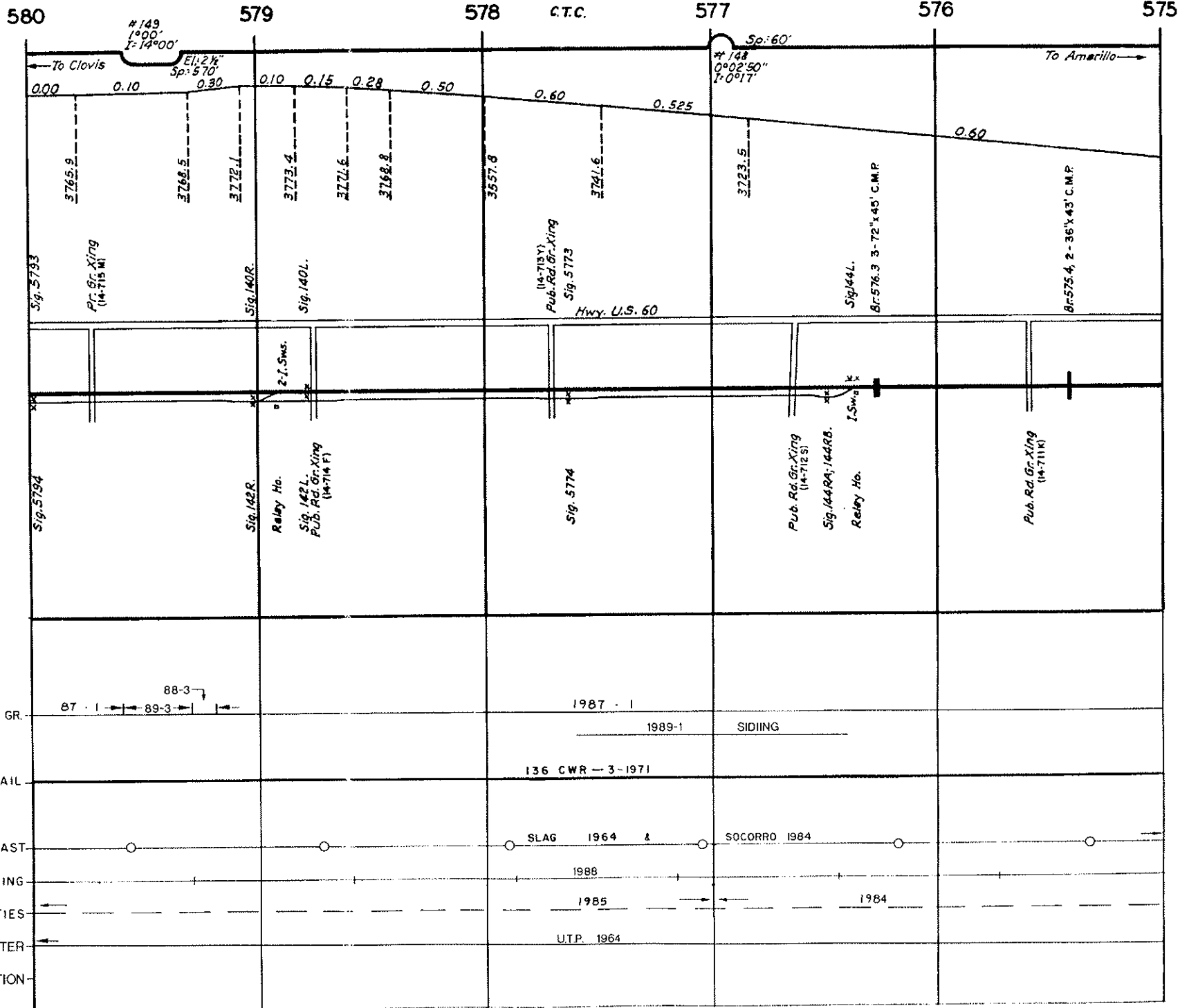

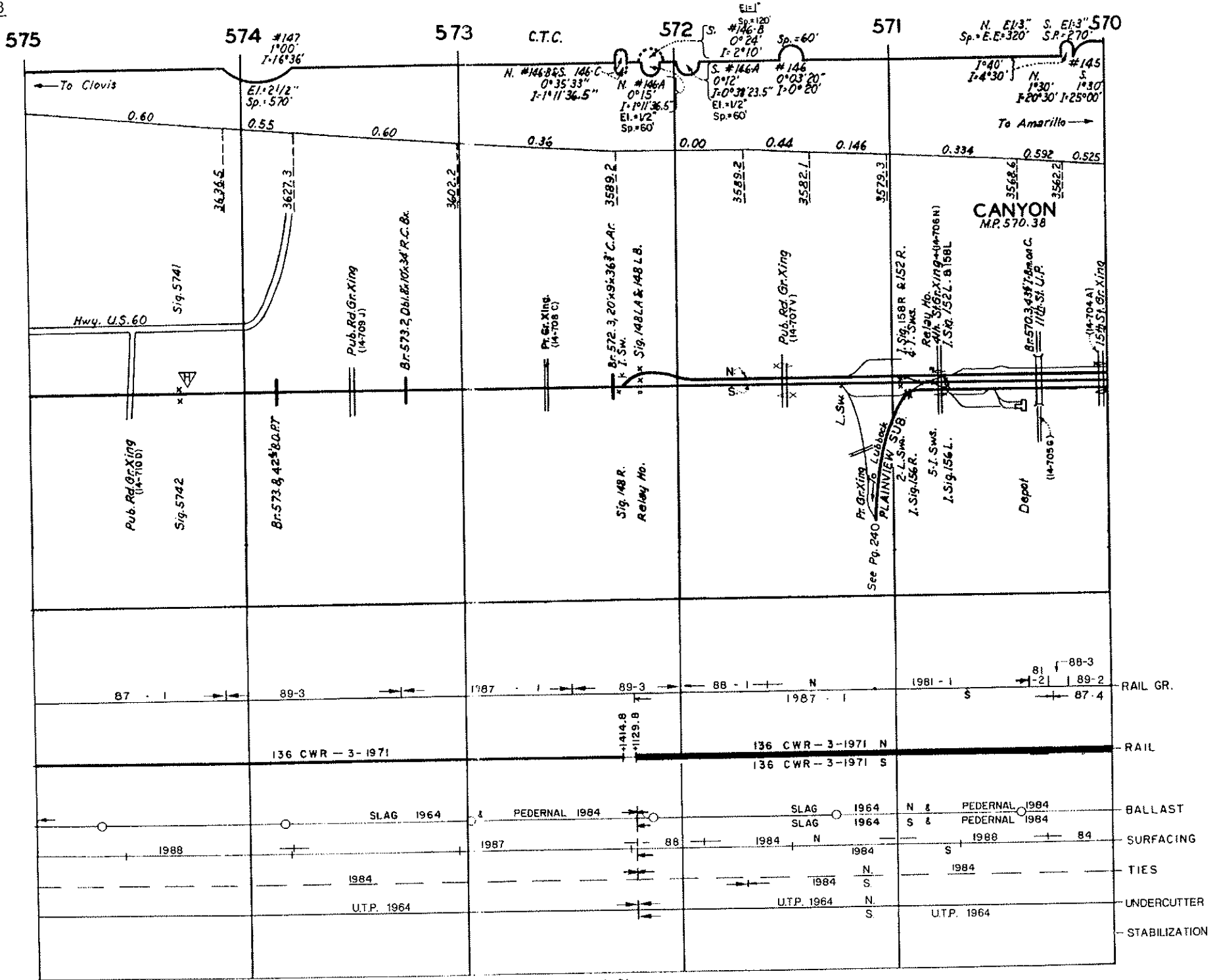

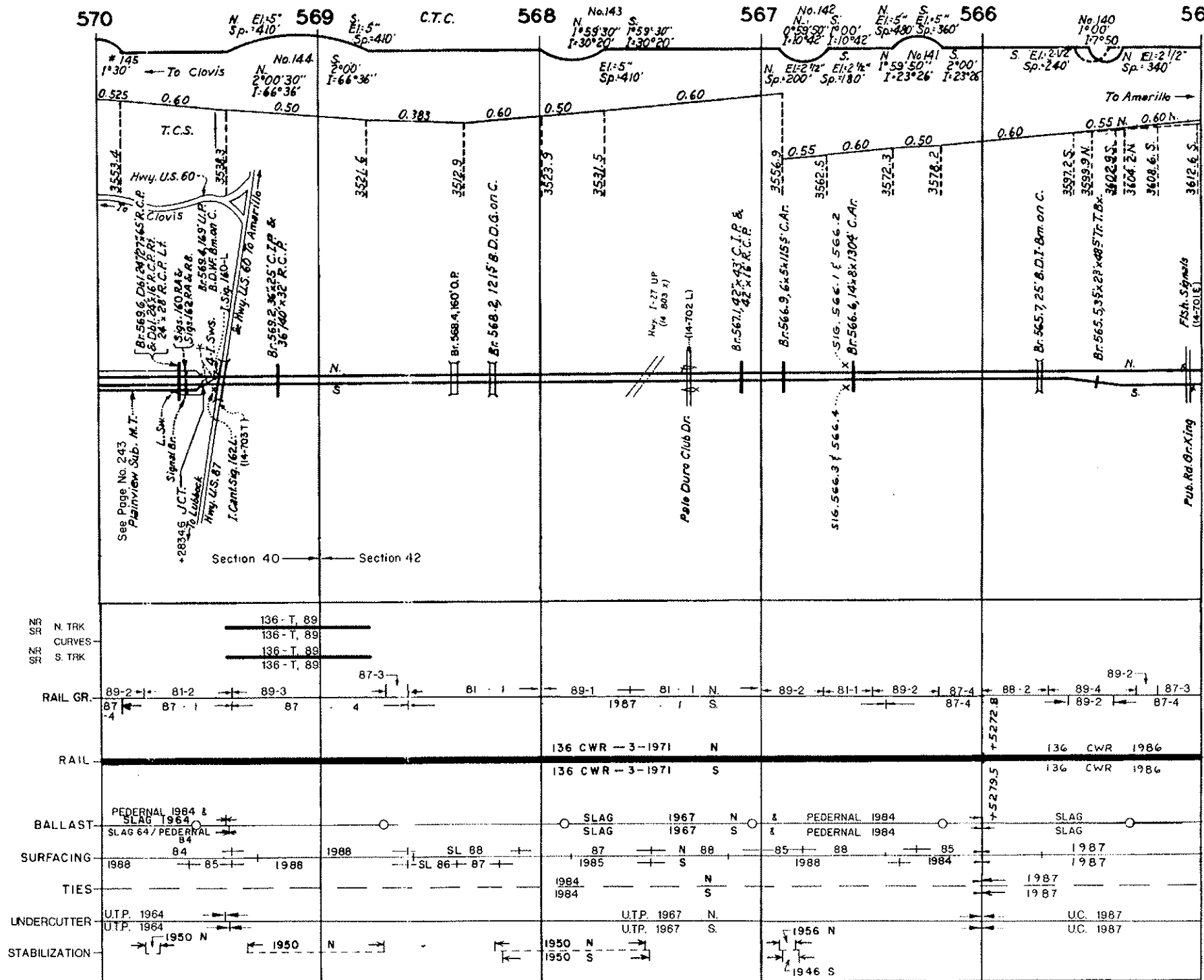

565

564

563

562

561

560

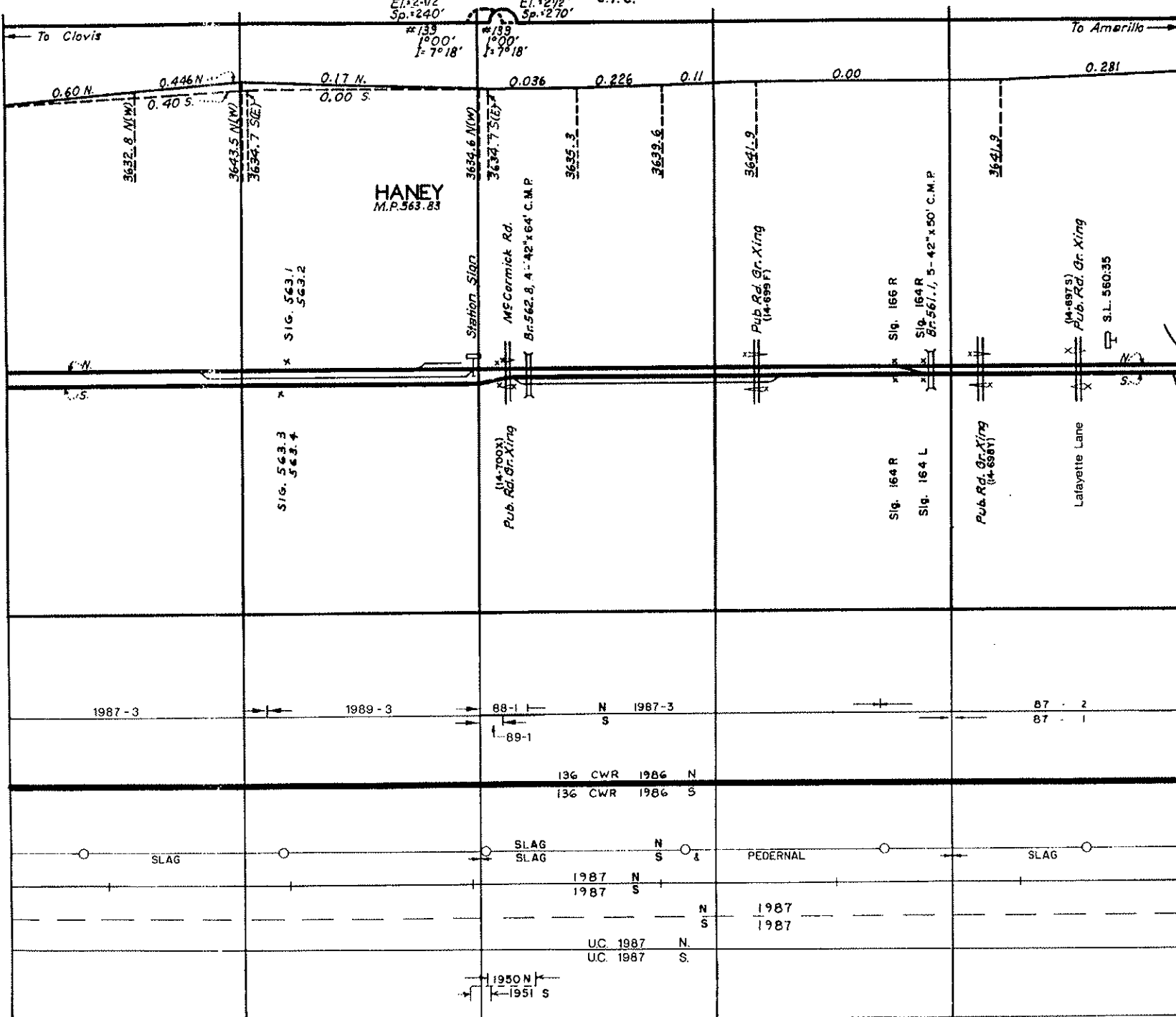

560

559

558

557

556

555

C.T.C.

A.B.S.

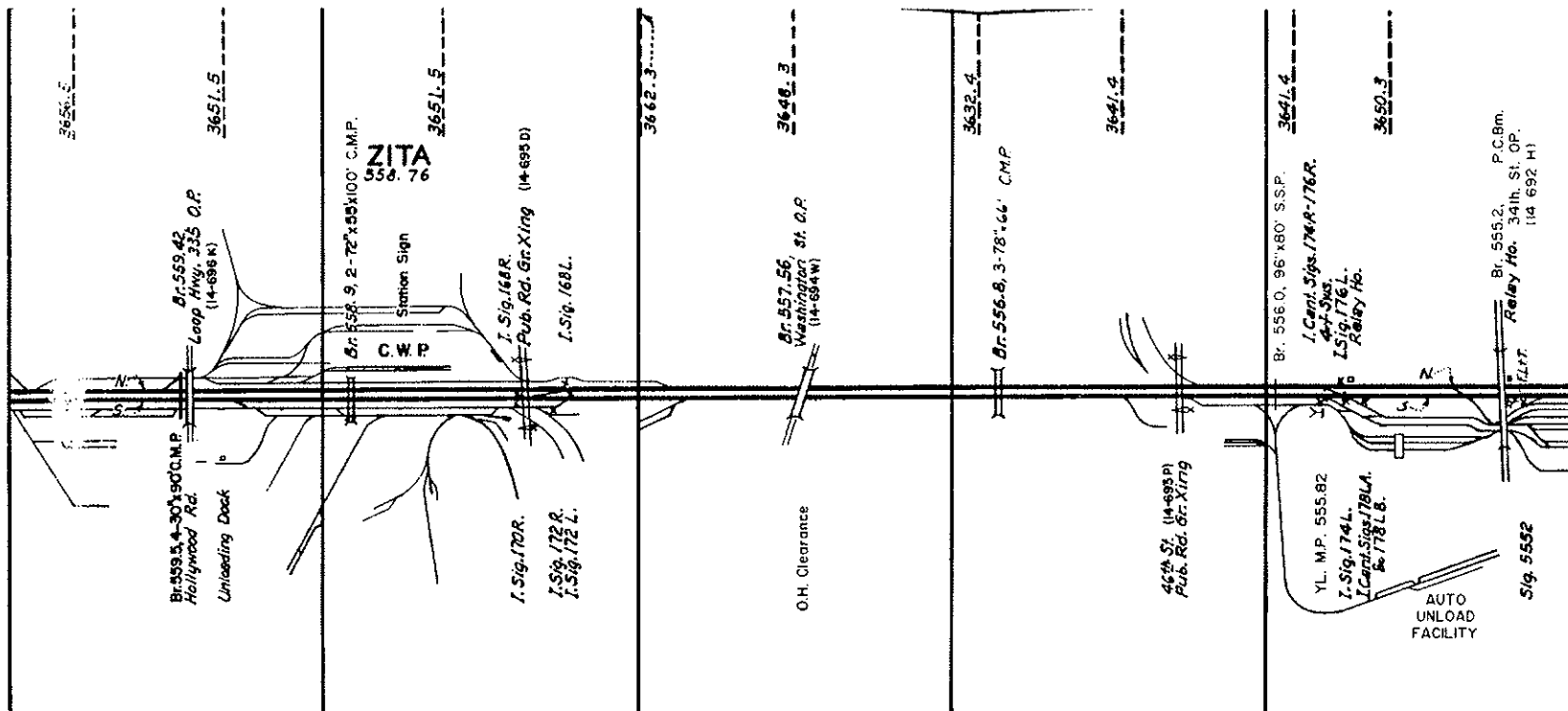
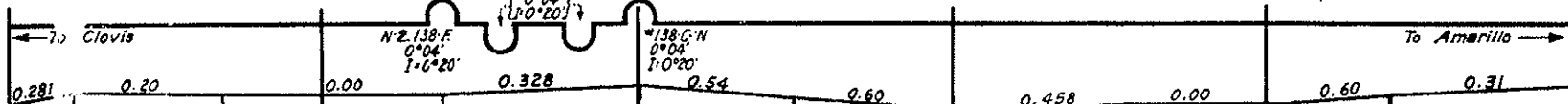

RAIL GR.

RAIL

BALLAST

SURFACING

TIES

UNDERCUTTER

STABILIZATION

1987 . 1
 -N 1987 . 2
 S 1987 . 2

136 CWR 1986 N
 136 CWR 1986 S
 +4392
 136 1985 N
 136 1985 S

SLAG SLAG
 PEDERNAL PEDERNAL
 & &
 SLAG SLAG
 N S
 SLAG SLAG
 & &
 PEDERNAL PEDERNAL

1987 N
 1987 S
 1989 N
 1989 S

1987 N
 1987 S

U.C. 1987 N
 U.C. 1987 S
 UTP. 1967

Hereford Subdivision

Amarillo (M.P. 553.0) to Clovis (M.P. 655.0)