

Intentionally Blank

← To Clovis

Automatic Block

AMARILLO YARD AMARILLO, TEXAS.

JUNIOR
M.P. 554.25
Interlocked

Microwave Tower
on top Santa Fe O.D.B.

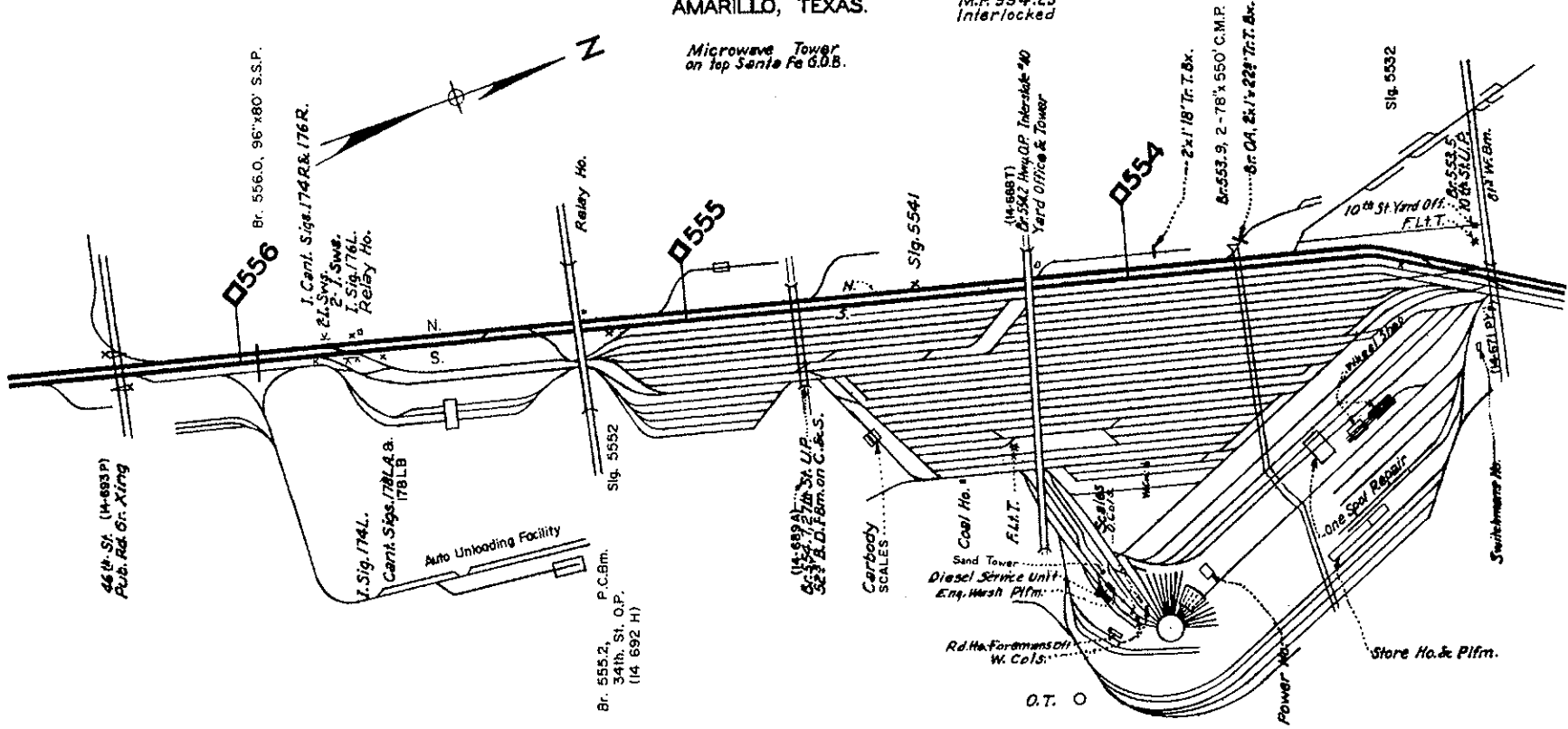

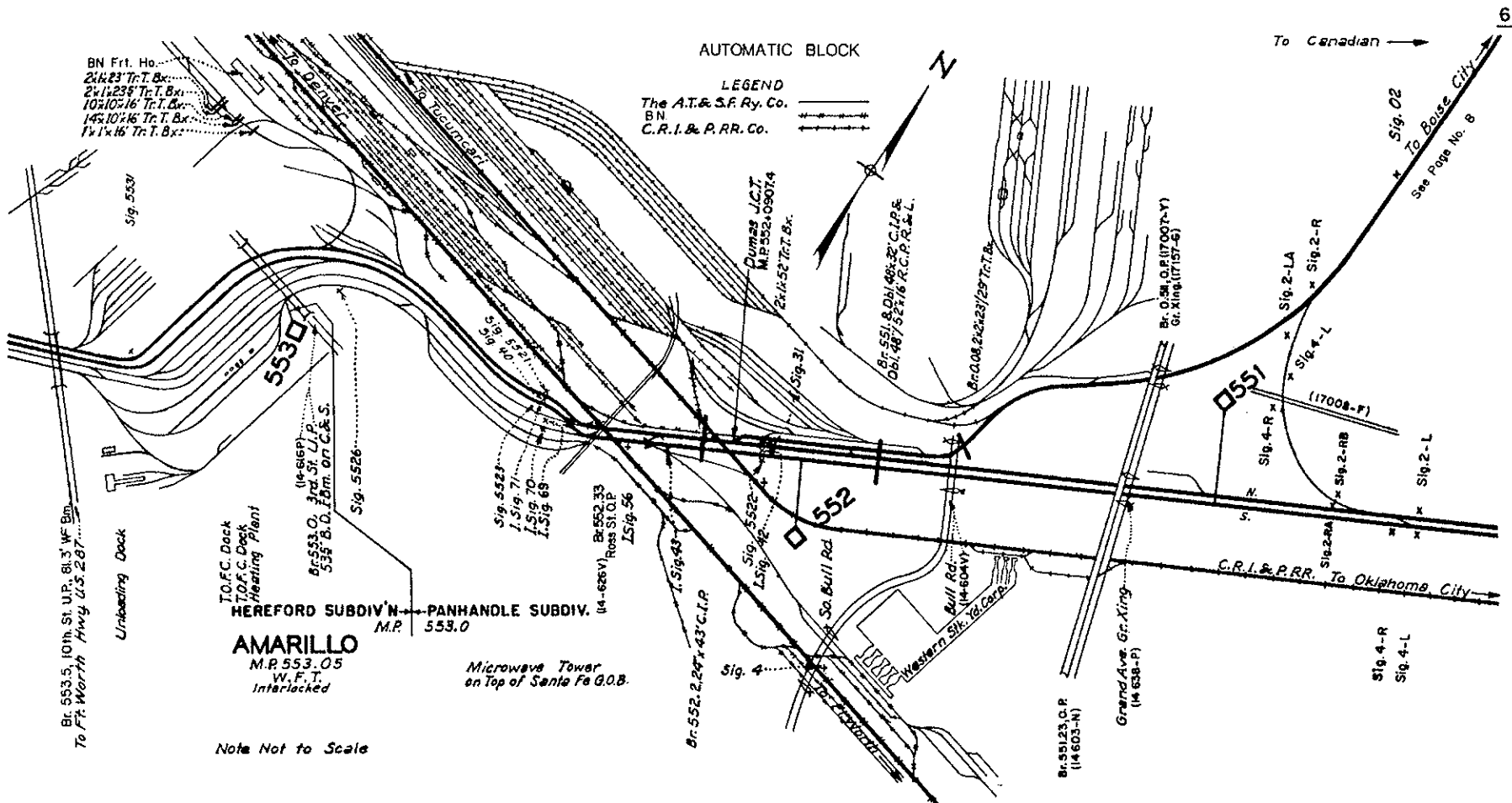

BN Frt. Ho.
 2x1x23 Tr.T. Bx
 2x1x23 Tr.T. Bx
 10x10x16 Tr.T. Bx
 14x10x16 Tr.T. Bx
 1x1x16 Tr.T. Bx

AUTOMATIC BLOCK

LEGEND
 The A.T. & S.F. Ry. Co. ———
 BN ———
 C.R.I. & P. RR. Co. ———

To Canadian →

To Boise City →
 See Page No. 8

Br. 553.5, 10th St. U.P. 81.3' WF Bm.
 To Ft. Worth Hwy U.S. 267

Unloading Dock

T.O.F.C. Dock
 T.O.F.C. Dock
 Heating Plant

AMARILLO
 M.P. 553.05
 W.F.T.
 Interlocked

HEREFORD SUBDIV'N — PANHANDLE SUBDIV.
 M.P. 553.0

Microwave Tower
 on Top of Santa Fe G.O.B.

Note Not to Scale

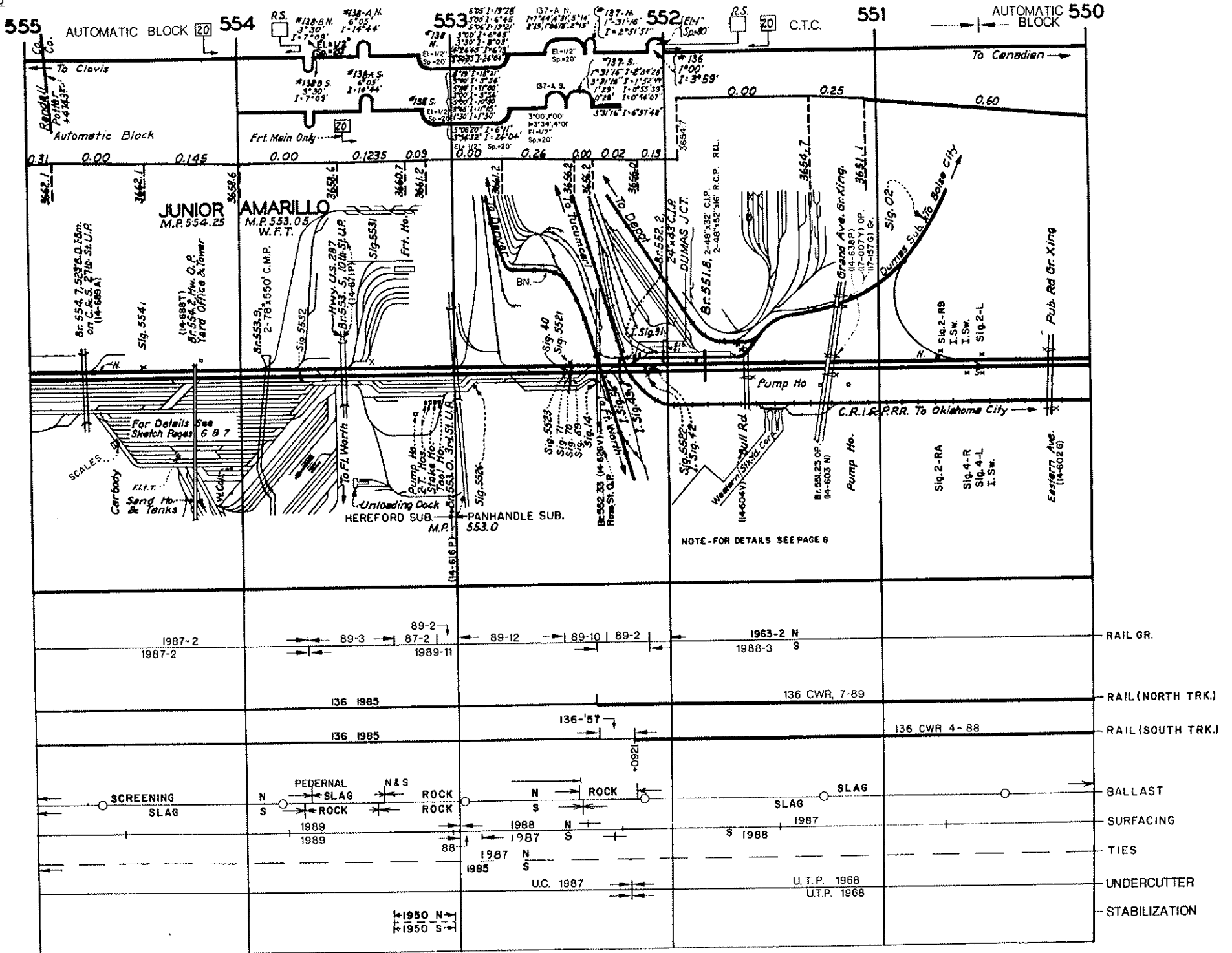

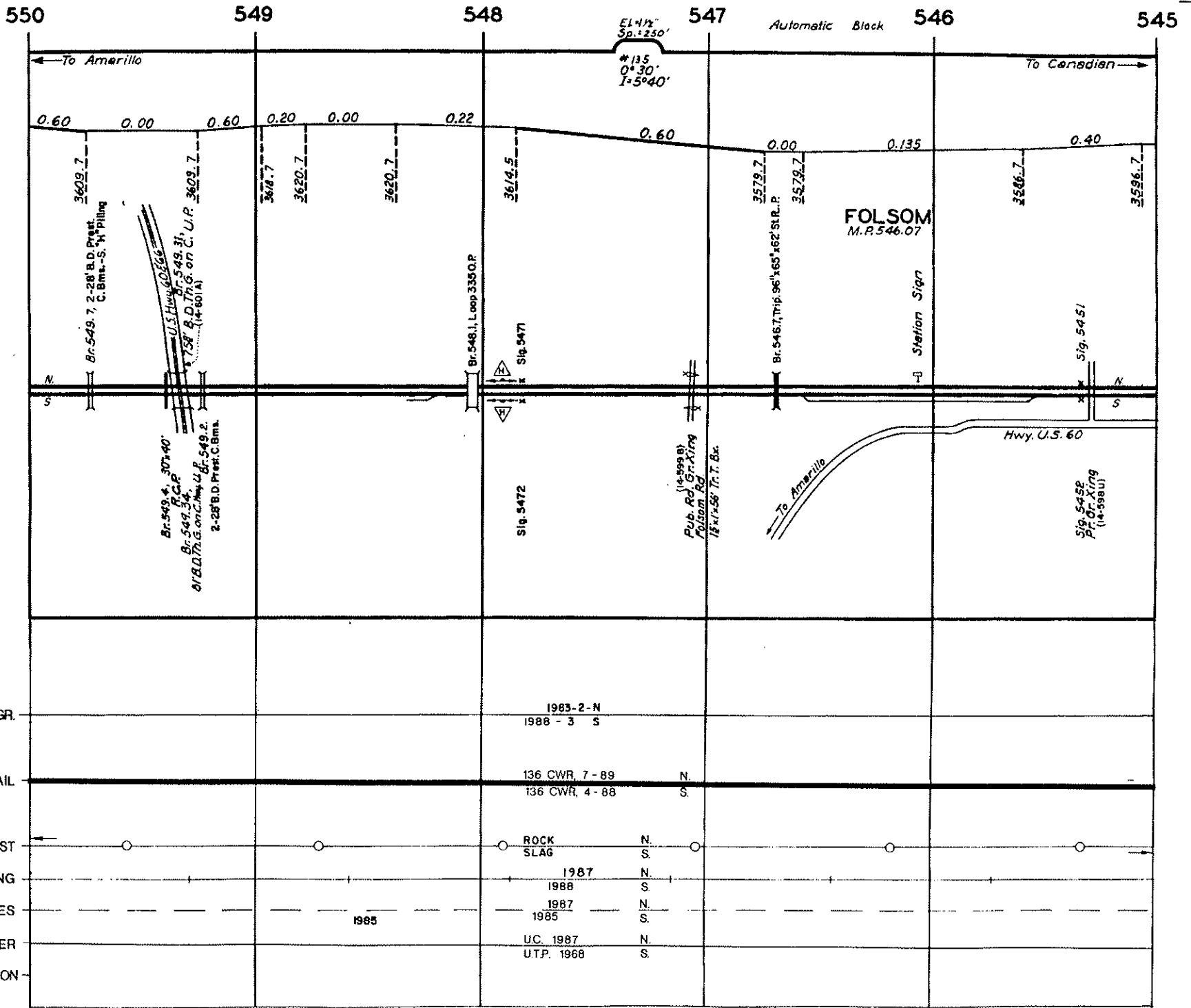

RAIL GR.

RAIL

BALLAST

SURFACING

TIES

UNDERCUTTER

STABILIZATION

1983-2-N

1988-3-S

136 CWR, 7-89 N.

136 CWR, 4-88 S.

ROCK SLAG N. S.

1987 N. S.

1988 N. S.

1985 N. S.

1985 N. S.

UC. 1987 N.

UTP. 1968 S.

545

544

543

Automatic Block
NO CURVES

542

541

540

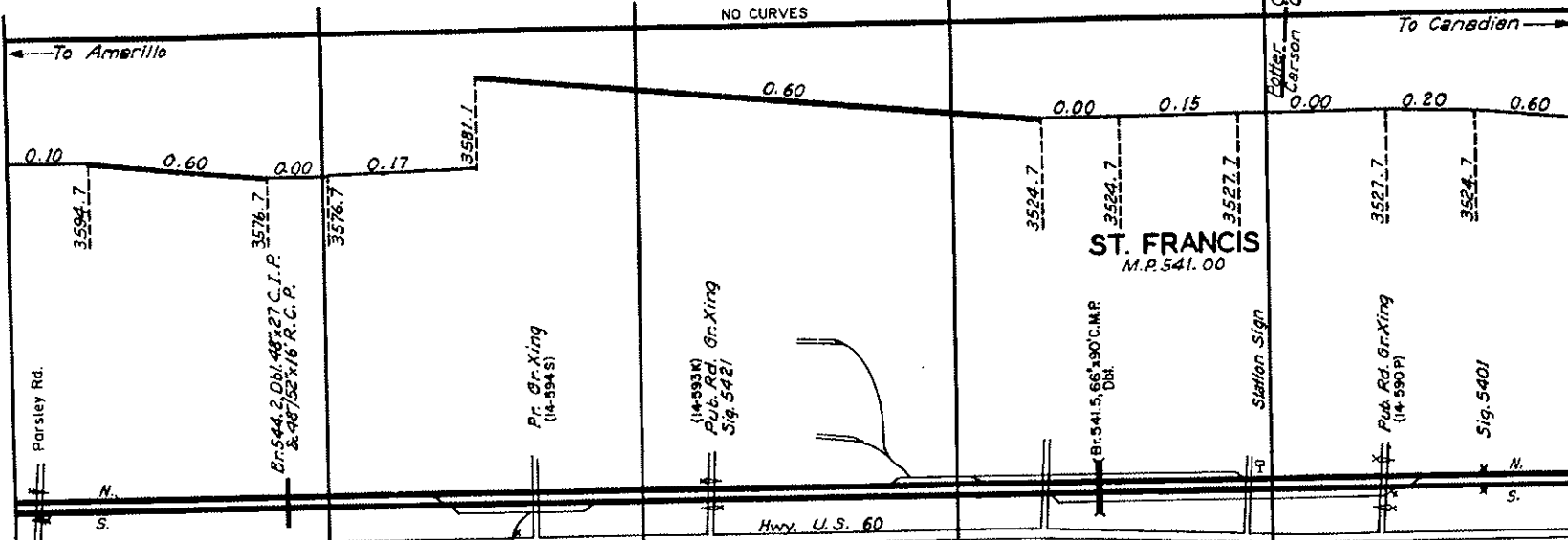

Potter
Carson
Co.

ST. FRANCIS
M.P. 541.00

Hwy. U.S. 60

Pub. Rd. Gr. Xing
(14-597M)

Br. 544.2 Dbl. 48' 27 C.I.P.
& 48' 52' 16 R.C.P.

Pr. Gr. Xing
(14-594S)

(14-593M)
Pub. Rd. Gr. Xing
Sig. 542/

Br. 541.5, 66' 190 C.M.P.
Dbl.

Station Sign

Pub. Rd. Gr. Xing
(14-590P)

Sig. 540/

2 Fish. Sigs.
(14-595T) PUB REG. XING

Sig. 5422

136*
new 84
14-422
T-4055
Pub. Rd. Gr. Xing
(14-592D)

Pub. Rd. Gr. Xing
(14-591M)

Dwarf Sig. 5404

Sig. 5402

1963-2-N
1988-3-S

136 CWR, 7-89 N
136 CWR, 4-88 S

ROCK 1950 N
SLAG 1968 S

1987 N
1988 S

1989 N
S

U.C. 1987 N
U.T.P. 1968 S

FEDERAL 1984

1985

RAIL GR.

RAIL

BALLAST

SURFACING

TIES

UNDERCUTTER

STABILIZATION

540 539 538 AUTOMATIC BLOCKS 537 536 535

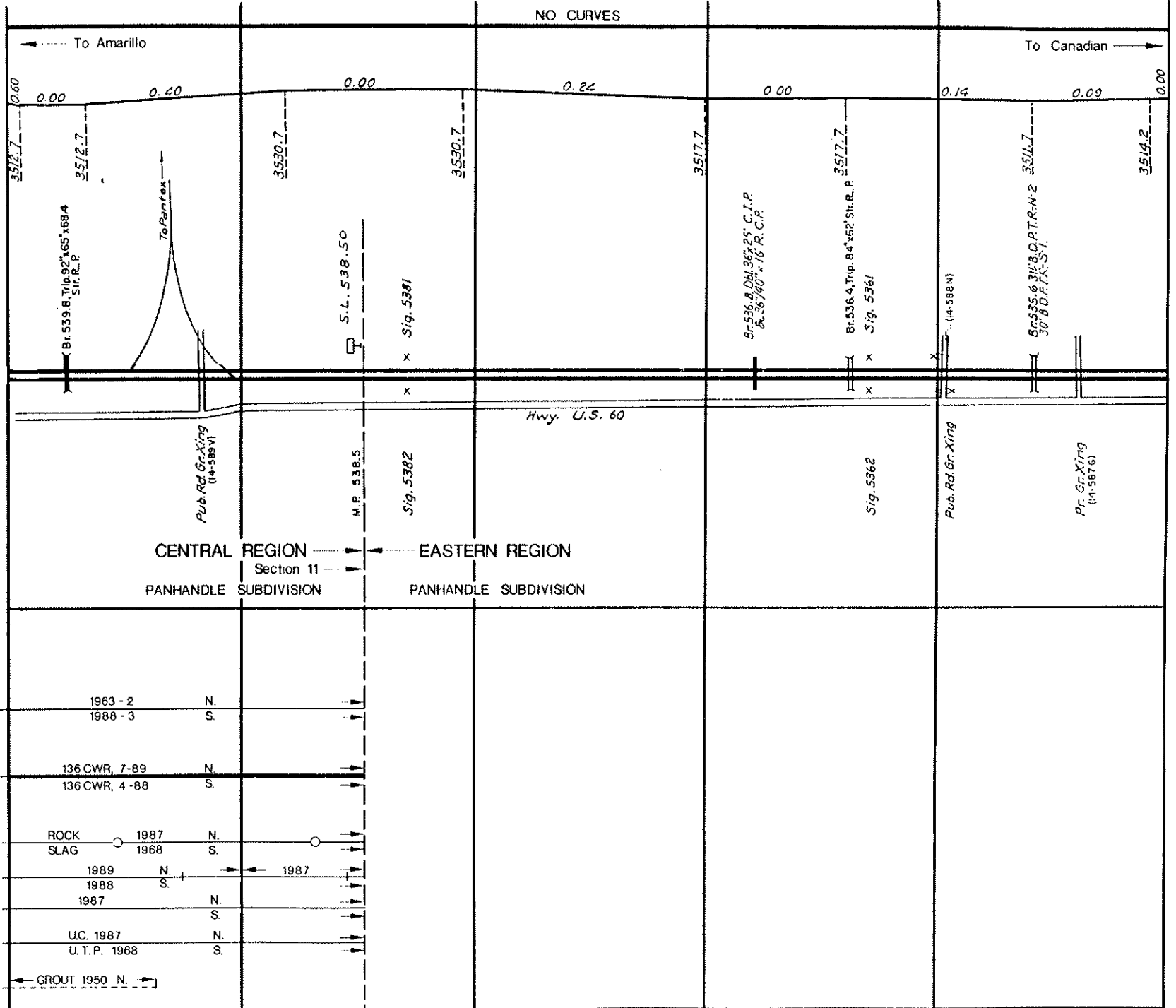

Panhandle Subdivision

St. Francis (M.P. 538.5) to Amarillo (M.P. 553.0)