

TYPE OF CAR	CLASS	SERIES	CONVERTED BY	YEAR
STOCK (SINGLE DECK)	SK-2	25000-26749	A.T.S.F.RY.	1942 TO 1946
UNDERFRAME FROM Bx-3 & Bx-6			NUMBER OF CARS-894	
Bx-3 BLT 1923&24, Bx-6 BLT. 1925			(ONLY ONE CAR BUILT)	

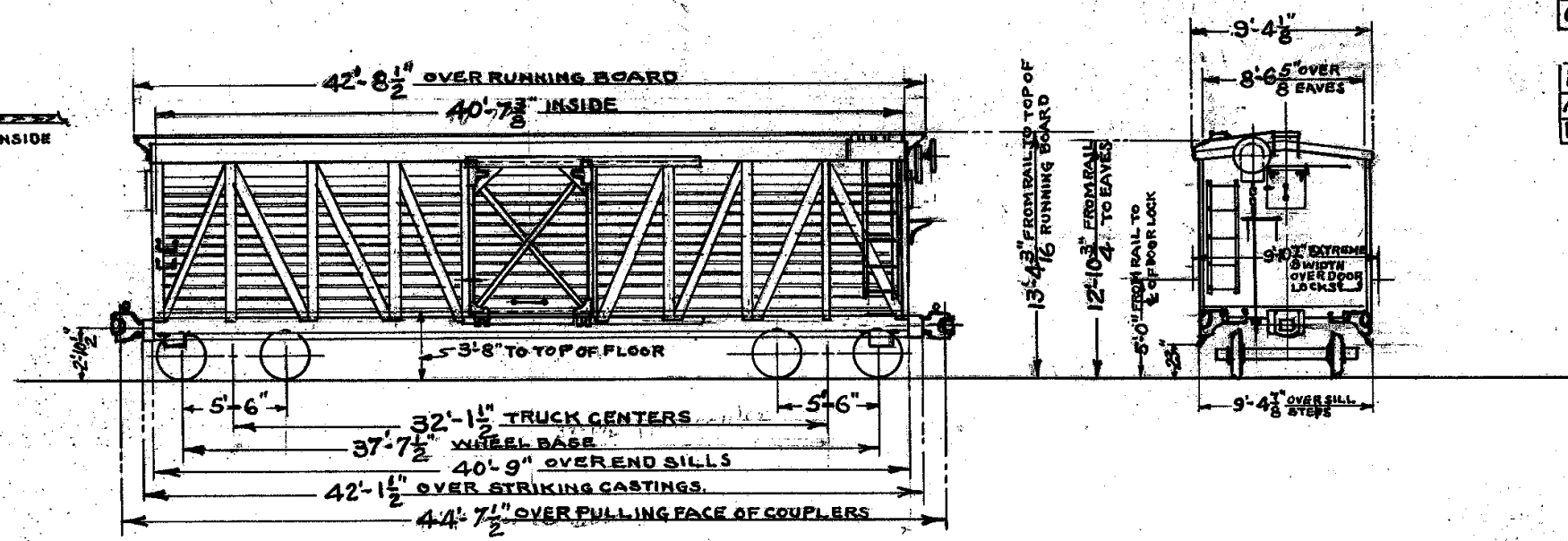
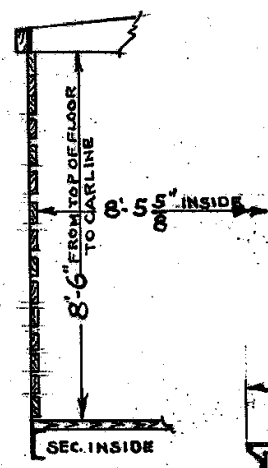

DRAWN	RAH
TRACED	RAH
CHECKED	

REVISIONS.	
A-8-17-45	RAH
B-7-14-50	RAH

DESCRIPTION

CAPACITY	80,000 LBS	CENTER TO CENTER OF TRUCKS	32'-1 1/2"	KIND OF COUPLERS	"E" HEAD
LOAD LIMIT	90,500 LBS	WHEEL BASE OF CAR	37'-7 1/2"	SIZE OF SHANK	6 1/4" x 8"
CUBICAL CONTENT	2926 CU FT	WIDTH OVER SIDE SILLS	8'-7 5/8"	DRAWBAR YOKE	CAST STEEL
LIGHT WEIGHT OF CAR	45500 LBS	WIDTH OVER SIDE PLATES	8'-7 5/8"	DRAWBAR ATTACHMENT	HORIZ. KEY
WEIGHT OF BODY	30100 LBS	WIDTH OVER EAVES	8'-6 5/8"	UNCOUPLING ARRANGEMENT	IMPERIAL TYPE A
WEIGHT OF TRUCKS	15400 LBS	EXTREME WIDTH (OVER DOOR LOCK)	9'-10 1/4"	HAND BRAKE	AJAX
INSIDE LENGTH	40'-7 3/8"	HEIGHT FROM RAIL TO EXTREME WIDTH TOE OF LOCK	5'-0"	DRAFT GEAR	MINER A-18-S
INSIDE WIDTH	8'-5 5/8"	EXTREME HEIGHT (TOP OF RUNNING BOARD)	13'-4 3/16"	DRAFT GEAR CARRIER	STEEL
INSIDE HEIGHT	8'-6"	UNDERFRAME	STEEL	KIND OF TRUCKS	CAST STEEL
HEIGHT FROM RAIL TO TOP OF FLOOR	3'-8"	SUPERSTRUCTURE	STEEL	WHEEL BASE OF TRUCK	5'-6"
HEIGHT FROM RAIL TO TOP OF RUNNING BOARD	13'-4 3/16"	DOORS, SIDE	STEEL BOND	TRUCK FRAME	ANDREWS C.S. SIDE
HEIGHT FROM RAIL TO EAVES	12'-10 3/4"	DOOR CLEAR OPENING	6'-0" W x 8'-0 1/4" H	JOURNAL BOX LID	NATIONAL
LENGTH OVER END SILLS	40'-9"	DOORS, END	STEEL PLATE	SIZE OF JOURNAL	5" x 9"
LENGTH OVER RUNNING BOARD	42'-8 1/2"	DOOR CLEAR OPENING	21 3/4" W x 24" H	WHEELS	33"-700# CAST IRON
LENGTH OVER STRIKING CASTINGS	42'-1 1/2"	ENDS	CORRUGATED	BRAKE BEAM	CRECO NO 3
LENGTH OVER PULLING FACE OF COUPLERS	44'-7 1/2"	ROOF (FROM Bx-3 & Bx-6)	OUTSIDE FLEXIBLE METAL	BRAKE	"AB" EQUIPMENT
		BODY LIST	1787		

TRUCKS FROM Bx-3

NOTE: ALL DIMENSIONS TAKEN FROM TOP OF RAIL.

TOPEKA, KANSAS. NOV. 10, 1942.

